

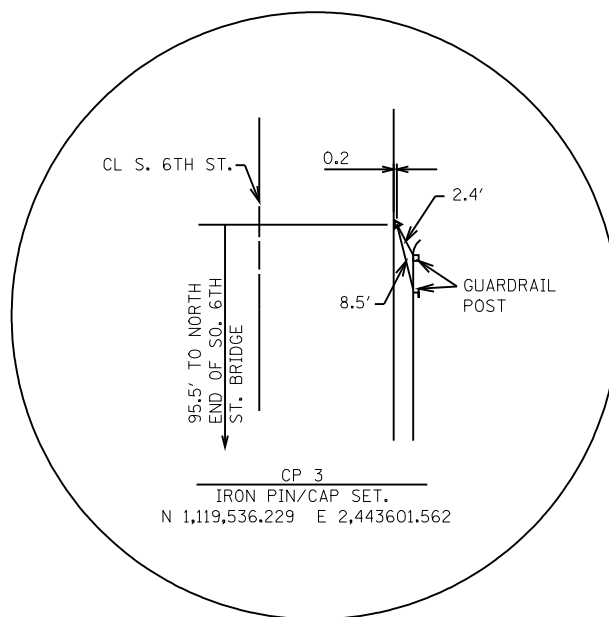

CURVE 373  
 P.I. STA. 49+08.25  
 DELTA = 10°-52'-22"  
 D = 01°-28'-26"  
 T = 369.99'  
 L = 737.76'  
 R = 3,887.72'  
 E = 17.57'  
 CH. = 736.65'  
 MID ORD = 17.49'  
 P.C. STA. 45+38.26  
 P.T. STA. 52+76.02

CURVE 372  
 P.I. STA. 35+96.32  
 DELTA = 21°-59'-35"  
 D = 03°-00'-18"  
 T = 370.50'  
 L = 731.88'  
 R = 1,906.67'  
 E = 35.66'  
 CH. = 727.39'  
 MID ORD = 35.01'  
 P.C. STA. 32+25.82  
 P.T. STA. 39+57.70

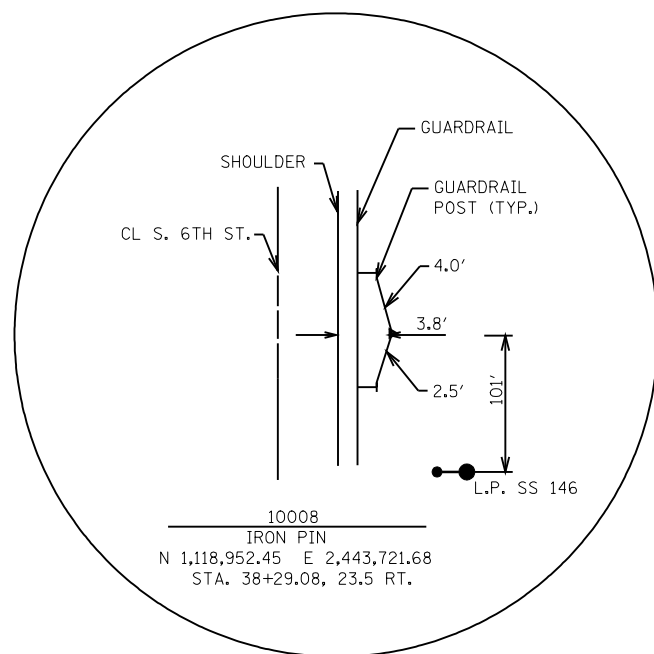
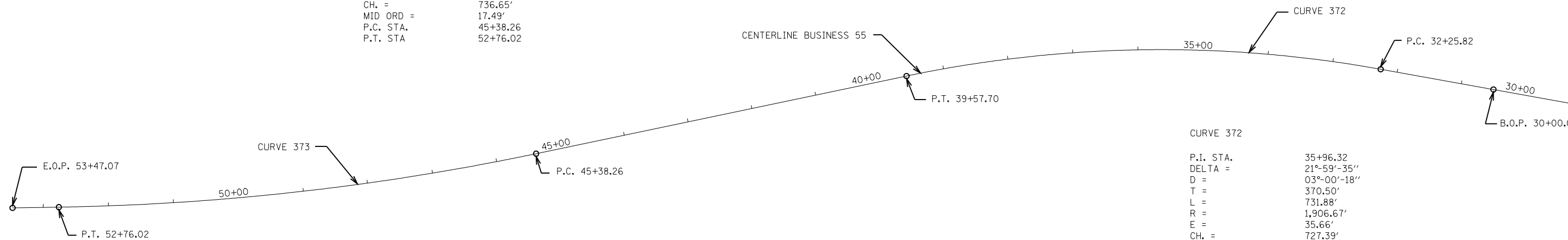

B.O.P. STA.	30+00.00	N 1,118,126.29	E 2,443,646.88
CURVE 372			
P.I. STA.	35+96.32	N 1,118,713.24	E 2,443,752.22
P.C. STA.	32+25.82	N 1,118,348.56	E 2,443,686.77
P.T. STA.	39+57.70	N 1,119,075.88	E 2,443,676.33
CURVE 373			
P.I. STA.	49+08.25	N 1,120,006.28	E 2,443,481.65
P.C. STA.	45+38.26	N 1,119,644.13	E 2,443,557.43
P.T. STA.	52+76.02	N 1,120,376.22	E 2,443,475.55
E.O.P. STA.	53+47.07	N 1,120,447.26	E 2,443,474.37

BM TA17 CHISELED SQUARE IN SOUTHWEST WINGWALL OF HUBGUARD OF SOUTH SIXTH STREET. BRIDGE S.N. 084-0028, ST 40+00.06/16.68' RT. ELEV. = 616.53'

BM 102 CHISELED SQUARE ON THE SOUTHWEST CORNER OF THE SOUTH PIER OF BUSINESS 55 BRIDGE OVER S.B. I-55. ELEV. = 594.86'

NOTE: VERT. CONTROL NAVD 88

FILE NAME =	USER NAME = laughlinr1	DESIGNED - WAK	REVISED -
et:\pwork\pwork\LAUGHLINRL\0131883\0672464_09_ATB.dgn		DRAWN - WAK	REVISED -
PLOT SCALE = 40.0000' / IN.		CHECKED - LLQ	REVISED -
PLOT DATE = Mar-19-2009 11:06:04AM		DATE - MARCH 5, 2009	REVISED -

STATE OF ILLINOIS  
 DEPARTMENT OF TRANSPORTATION

EXISTING ALIGNMENTS, TIES AND BENCHMARKS OF BUSINESS I-55

SCALE: 1IN. = 20FT. SHEET NO. 1 OF 1 SHEETS STA. 38+74.37 TO STA. 44+55.27

F.A.I. RTE.	SECTION	COUNTY	TOTAL SHEETS	SHEET NO.
55	(84-3HB-6)BR	SANGAMON	90	9
S.N. 084-0028		CONTRACT NO. 72A64		
FED. ROAD DIST. NO. 6 ILLINOIS FED. AID PROJECT				