

BL-55 SOUTH BOUND

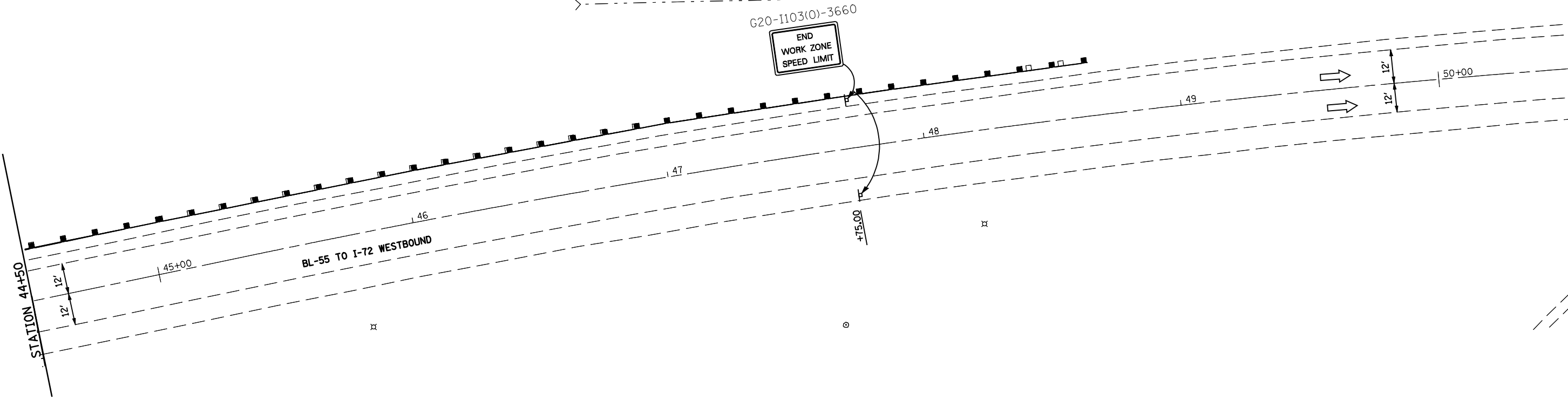

G20-1103(0)-3660

END WORK ZONE SPEED LIMIT



SYMBOLS

- DIRECTION OF TRAFFIC
- ARROW BOARD
- WORK AREA
- SIGN
- DIRECTION INDICATOR BARRICADE WITH STEADY BURN MONODIRECTIONAL LIGHT
- TYPE II BARRICADE, DRUM, OR VERTICAL BARRICADE WITH STEADY BURN MONODIRECTIONAL LIGHT
- TEMPORARY CONCRETE BARRIER
- MONODIRECTIONAL BARRIER WALL/GUARDRAIL MARKER
- IMPACT ATTENUATORS, (FULLY REDIRECTIVE, NARROW), TEST LEVEL 3
- FLEXIBLE DELINEATOR (50' SPACING)

- ① TEMPORARY PAVEMENT MARKING TAPE, TYPE 3, SHALL BE PLACED THROUGHOUT THE TAPER AND ALONG-SIDE THE WORK AREA. THE RIGHT EDGE LINE SHALL BE TEMPORARY PAVEMENT MARKING TAPE TYPE 3, WHITE AND THE LEFT EDGE LINE SHALL BE YELLOW.
- ② BARRIER WALL/GUARDRAIL MARKERS AT 25'. MARKERS ON RIGHT SHALL BE CRYSTAL AND MARKERS ON LEFT SHALL BE AMBER.

STAGE CONSTRUCTION TRAFFIC CONTROL NOTES

1. THE ADVISORY SPEED TO BE SHOWN ON THE SIGNS IN THE STAGE CONSTRUCTION TRAFFIC CONTROL SHALL BE DETERMINED AT THE SITE AND APPROVED BY THE ENGINEER.
2. STAGE I PAVEMENT MARKINGS THAT APPLY IN STAGE II WILL BE RESTRIPE AS DIRECTED BY THE ENGINEER.
3. EXISTING PAVEMENT MARKINGS THAT CONFLICT WITH STAGE I PAVEMENT MARKING SHALL BE REMOVED.
4. PAVEMENT MARKINGS THAT CONFLICT WITH THE PRESENT STAGE PAVEMENT MARKINGS SHALL BE REMOVED.
5. WITHIN THE PROJECT LIMITS, STA. 38+75 TO STA. 44+50, THE PROPOSED HMA SURFACE COURSE, MIX "C", N30 SHALL BE PLACED AT THE PRESCRIBED THICKNESS AND LEVEL WITH THE EXISTING EDGE OF PAVEMENT.
6. THE PLACEMENT OF THE FINAL LIFT ON THE SHOULDERS WILL BE PLACED DURING STAGE III.

SUGGESTED SEQUENCE FOR STAGE CONSTRUCTION AND TRAFFIC CONTROL STAGE I:

1. REMOVE EXISTING SHOULDERS AND PAVE BASE COURSE WIDENING FROM STA. 38+75 TO STA. 44+50.
2. PLACE ALL TRAFFIC CONTROL ITEMS AS REQUIRED BY STANDARD 701400 AND AS SHOWN ON THE STAGE I CONSTRUCTION AND TRAFFIC CONTROL SHEET.
3. COMPLETE STAGE I REMOVAL AND CONSTRUCTION OF THE EXISTING PROPOSED BRIDGE SUPERSTRUCTURE AND APPROACH PAVEMENT AS DESCRIBED IN THE STRUCTURAL PLANS.
4. COMPLETE ALL STAGE I CONSTRUCTION ACTIVITIES; REMOVE ALL PRESCRIBED BASE COURSE WIDENING AND EXISTING GUARDRAIL; COMPLETE REMAINING EARTHWORK AND TEMPORARY SEEDING; CONSTRUCT THE PROPOSED HOT-MIX ASPHALT SURFACE COURSE MIX "C", N30; AND REMOVE AND INSTALL PROPOSED GUARDRAIL.
5. CONSTRUCT TEMPORARY BITUMINOUS RAMPS TO CREATE A TRANSITION BETWEEN THE NEW BRIDGE APPROACH PAVEMENT DOWN TO THE EXISTING PAVEMENT.

STAGE II:

1. PLACE ALL TRAFFIC CONTROL ITEMS FOR STAGE II CONSTRUCTION AS REQUIRED BY STANDARD 701400 AND AS SHOWN ON THE STAGE II CONSTRUCTION TRAFFIC CONTROL.
2. COMPLETE STAGE II REMOVAL AND CONSTRUCTION OF EXISTING/PROPOSED BRIDGE SUPERSTRUCTURE AND APPROACH PAVEMENT AS DESCRIBED IN THE STRUCTURE PLANS.
3. COMPLETE ALL STAGE II CONSTRUCTION ACTIVITIES; REMOVE EXISTING GUARDRAIL; COMPLETE EARTHWORK AND TEMPORARY SEEDING; REMOVE AND INSTALL PROPOSED GUARDRAIL.
4. CONSTRUCT THE REMAINING PORTION OF THE TEMPORARY RAMPS TO TRANSITION BETWEEN THE NEW BRIDGE APPROACH PAVEMENT DOWN TO THE EXISTING PAVEMENT.

STAGE III:

1. REMOVE ALL STAGED TRAFFIC CONTROL ITEMS (CONCRETE BARRIER, IMPACT ATTENUATORS, TRAFFIC SIGNALS, ETC.)
2. CONSTRUCT BUTT JOINTS IN THE EXISTING PAVEMENTS AT STA. 38+75 AND STA. 44+50
3. PLACE PROPOSED BITUMINOUS PRIME COAT, LEVELING BINDER, AND SURFACE COURSE. ALSO PLACE THE FINAL LIFT ON THE HMA SURFACE COURSE, MIX "C", N50. THE EXTRA MATERIAL NEEDED FOR THE FINAL LIFT ON THE HMA SURFACE COURSE, MIX "C", N50 SHALL BE INCLUDED IN THE UNIT PRICE FOR HMA SURFACE COURSE, MIX "C", N50.
4. COMPLETE ALL SEEDING OPERATIONS, SPREAD ALL SOIL AMENITIES, SEED AND MULCH.
5. INSTALL ALL PERMANENT PAVEMENT MARKINGS TO MATCH THE ROADWAY'S ORIGINAL STATE.

NOTE:
ALL SIGNS AND TRAFFIC CONTROLS NOT SHOWN SHALL BE ACCORDING TO STANDARD 701400.

FILE NAME =	USER NAME = laughlinr1	DESIGNED - LLO	REVISED -	STATE OF ILLINOIS DEPARTMENT OF TRANSPORTATION	BL-55 STAGE 2 CONSTRUCTION (701402)			F.A.I. RTE.	SECTION	COUNTY	TOTAL SHEETS	SHEET NO.
et:\pwork\pwork\LAUGHLINRL\0131883\0672464.13-23_STAGES.dgn	DRAWN - JJS	REVISED -	55					(84-3HB-6)BR	SANGAMON	90	23	
PLOT SCALE = 40.0000' / IN.	CHECKED - MTM	REVISED -	S.N. 084-0028		CONTRACT NO. 72A64							
PLOT DATE = May-09-2009 11:31:46AM	DATE - MARCH 5, 2009	REVISED -	FED. ROAD DIST. NO. 6 ILLINOIS FED. AID PROJECT									
				SCALE: 1 = 20'	SHEET NO. 11 OF 11 SHEETS	STA. 44+50 TO STA.						