

STATE OF ILLINOIS
DEPARTMENT OF TRANSPORTATION

Plan dimensions and details relative to existing plans are subject to nominal construction variations. The Contractor shall field verify existing dimensions and details affecting new construction and make necessary approved adjustments prior to construction or ordering of materials. Such variations shall not be cause for additional compensation for a change in scope of the work, however, the Contractor will be paid for the quantity actually furnished at the unit price bid for the work.

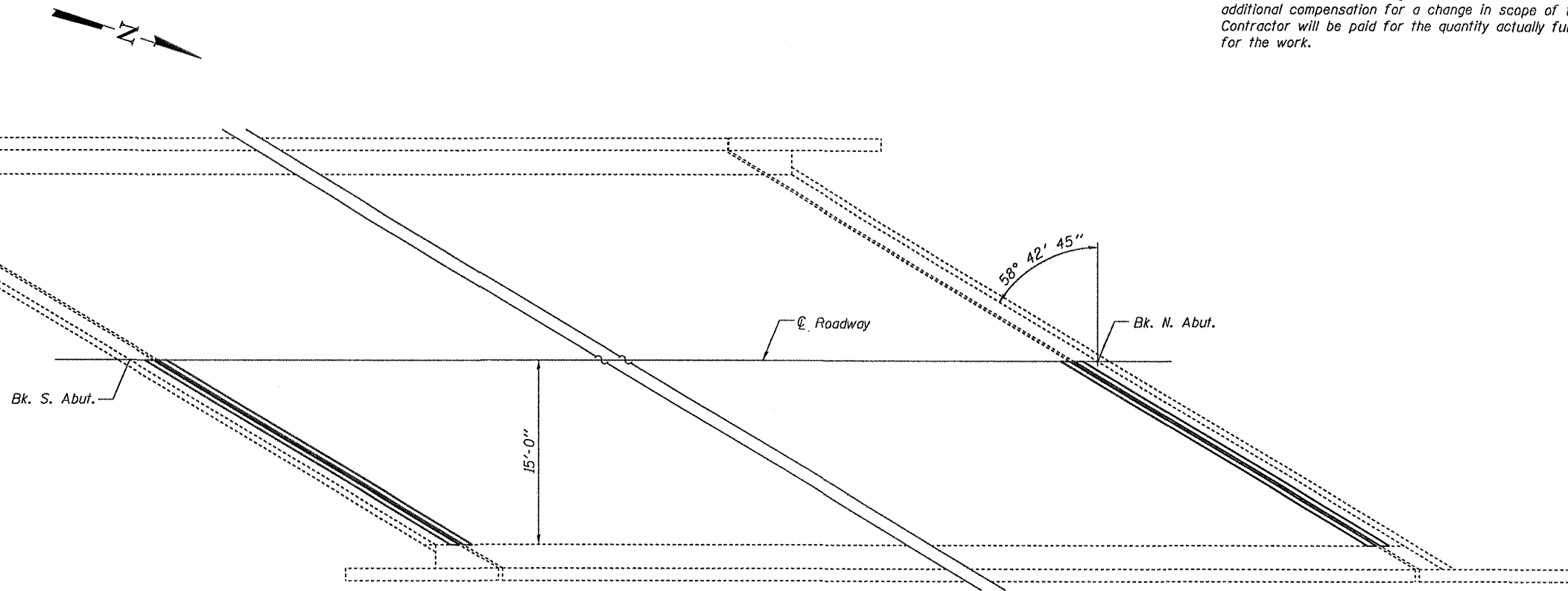

PLAN

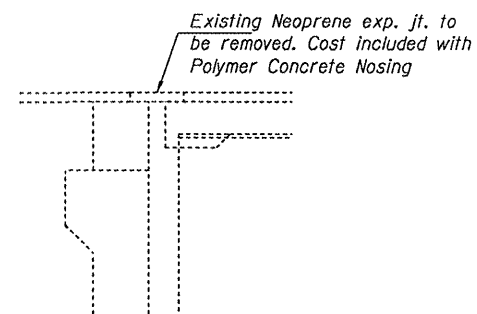

REMOVAL SECTION

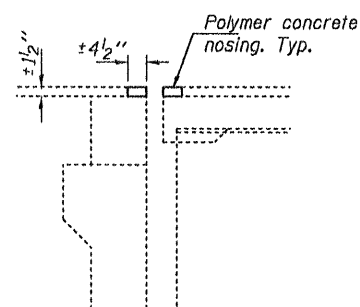

REPLACEMENT SECTION
(Dimensions are at right angles)

BILL OF MATERIAL

Item	Unit	Quantity
Polymer Concrete Nosing	Cu. Ft.	5.4

REPAIR DETAILS
PRE STAGE I TRAFFIC REPAIRS
BUSINESS LOOP 55 OVER FAI 55
SN 084-0028

DESIGNED	VHV
CHECKED	DAB
DRAWN	baliva
CHECKED	VHV DAB

SHEET NO. 1	F.A.I. RTE.	SECTION	COUNTY	TOTAL SHEETS	SHEET NO.
	55	(84-3HB-6)BR	SANGAMON	90	34A
1 SHEETS	CONTRACT NO. 72A64				
FED. ROAD DIST. NO.		ILLINOIS	FED. AID PROJECT		