

TEMPORARY RAMP LOCATIONS
 (SEE DETAIL SHEET 24)
 STA. 398+18.00 TO STA. 398+23.00
 STA. 400+38.50 TO STA. 400+43.50
 STA. 402+75.00 TO STA. 402+82.50

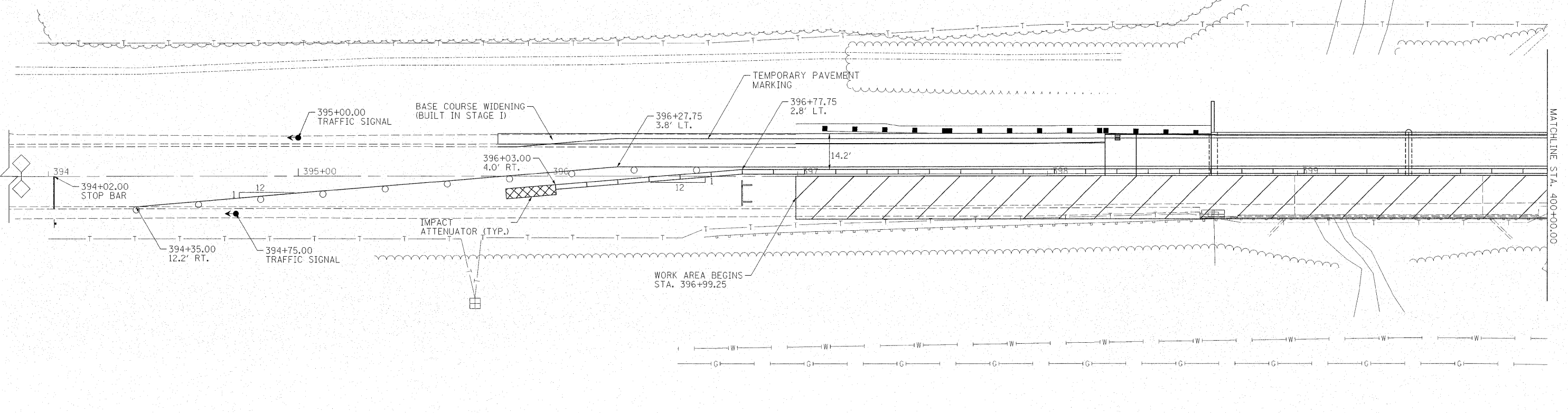

STAGING LEGEND

- TEMPORARY RUMBLE STRIPS
- TYPE III BARRICADE WITH FLASHING LIGHTS
- TEMPORARY CONCRETE BARRIER
- BARRICADE, OR DRUM WITH STEADY BURNING LIGHTS
- WORK ZONE
- TRAFFIC SIGNAL
- INDUCTION LOOP DETECTOR
- SIGN

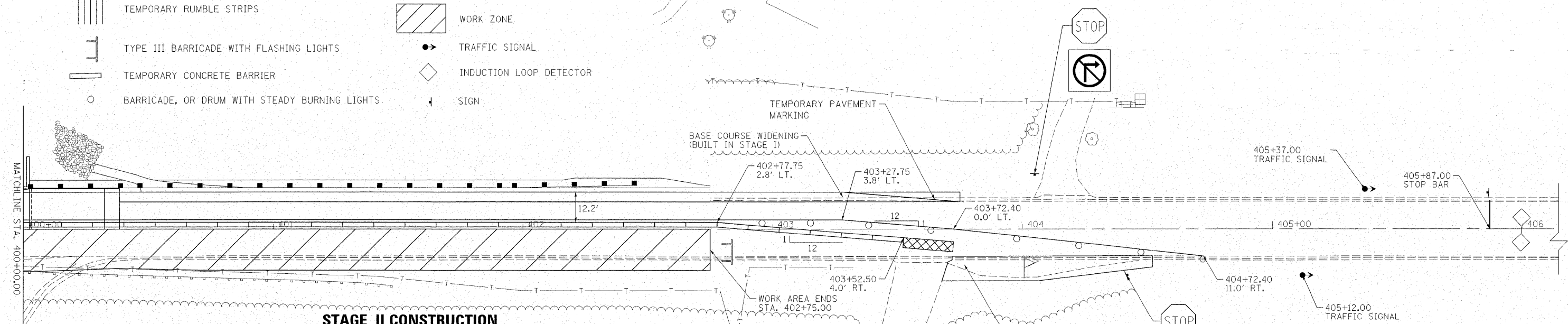

STAGE II CONSTRUCTION

1. RELOCATE TEMPORARY CONCRETE BARRIER, SIGNS, IMPACT ATTENUATORS, ETC. ACCORDING TO STANDARD 701321.
2. USE STANDARD 701321 FOR BRIDGE WORK.
3. REMOVE STAGE 2 PORTION OF THE EXISTING BRIDGE, PAVEMENT, AND GUARDRAIL, INCLUDING BASE COURSE WIDENING FROM STA. 397+65.00 TO STA. 398+60.96 RT, STA. 399+96.28 TO STA 400+38.50 RT, AND STA. 402+60.00 TO STA. 404+52.00 RT.
4. CONSTRUCT STAGE 2 PORTION OF THE PROPOSED BRIDGE INCLUDING APPROACH PAVEMENT, RIP-RAP, AND EARTHWORK.
5. COMPLETE PAVEMENT BRAKING FROM STA. 400+38.50 TO STA. 402+75.00, RT.
6. CONSTRUCT SUB-BASE GRANULAR MATERIAL AND UP TO 6" OF HMA BINDER COURSE FROM STA. 397+65.00 TO STA. 398+23.00, RT. AND STA. 400+38.50 TO STA. 402+75.00, RT.
7. COMPLETE HMA BINDER COURSE FROM STA. 396+99.25 TO STA. 398+23.00, RT. AND STA. 400+38.50 TO STA. 402+75.00, RT.
8. CONSTRUCT HMA SHOULDERS, GUARDRAIL AND ANY NECESSARY EARTHWORK FROM STA. 396+99.25 TO STA. 398+65.00 AND STA. 400+02.50 TO STA. 402+75.00, RT.
9. CONSTRUCT TEMPORARY RAMPS FROM STA. 398+18.00 TO STA. 398+23.00 AND STA. 400+38.50 TO STA. 400+43.50, RT.
10. REMOVE TEMPORARY CONCRETE BARRIER AND CONSTRUCT TAPER WITH TEMPORARY RAMP FROM STA. 402+75.00 TO STA. 402+82.50, RT.
11. REMOVE BARRELS, SIGNALS, SIGNS, ETC.
12. USE STANDARD 701306 TO REMOVE BASE COURSE WIDENING FROM STA. 402+75.00 TO STA. 403+65.00, LT.
13. CONSTRUCT REMAINING HMA BINDER COURSE, REMAINING HMA SHOULDERS, AND ALL HMA SURFACE COURSE USING STANDARD 701306.

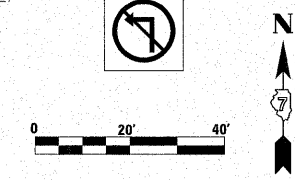

NOTE:
 1. SEE STANDARD 701321 FOR INDUCTION LOOP DETECTOR AND TEMPORARY RUMBLE STRIP LOCATIONS.
 2. SEE SHEET 29 FOR STAGING TYPICAL SECTIONS.

FILE NAME =	USER NAME = #USER#	DESIGNED - JDS 04/08/08	REVISED -	STATE OF ILLINOIS DEPARTMENT OF TRANSPORTATION	IL 121 OVER MULE CREEK STAGING PLAN - STAGE 2 CONSTRUCTION	F.A.P. RTE. 773	SECTION 108BR3, 109B1B-1	COUNTY CUMBERLAND	TOTAL SHEETS 96	SHEET NO. 26	
#FILEL#		DRAWN - WLL 09/23/08	REVISED -			SCALE: 1"=20'		SHEET NO. OF SHEETS STA. TO STA.		CONTRACT NO. 74237	
		CHECKED - RJA 09/17/08	REVISED -			FED. ROAD DIST. NO. ILLINOIS FED. AID PROJECT					
		DATE - 09/26/08	REVISED -								