

STATE OF ILLINOIS  
DEPARTMENT OF TRANSPORTATION

ROUTE NO. FA 773 IL 121	SECTION (109B) B-1	COUNTY CUMBERLAND	TOTAL SHEETS 96	SHEET NO. 66	SHEET NO. 9 25 SHEETS
FED. ROAD DIST. NO.		ILLINOIS	FED. AID PROJECT		

Contract # 74237

NORTH CURB LINE

Location	Station	Offset	Theoretical Grade Elevations
Back of East Abut.	575+85.98	-16.42	562.01
R	575+95.98	-16.42	561.91
S	576+05.98	-16.42	561.82
End of East Appr. Pavt.	576+15.98	-16.42	561.73

NORTH EDGE OF PAVEMENT

Location	Station	Offset	Theoretical Grade Elevations
Back of East Abut.	575+84.37	-12.00	562.12
R	575+94.37	-12.00	562.02
S	576+04.37	-12.00	561.92
End of East Appr. Pavt.	576+14.37	-12.00	561.83

☉ ROADWAY & P.G.

Location	Station	Offset	Theoretical Grade Elevations
Back of East Abut.	575+80.00	0.00	562.35
R	575+90.00	0.00	562.25
S	576+00.00	0.00	562.15
End of East Appr. Pavt.	576+10.00	0.00	562.06

SOUTH EDGE OF PAVEMENT

Location	Station	Offset	Theoretical Grade Elevations
Back of East Abut.	575+75.63	12.00	562.21
R	575+85.63	12.00	562.11
S	575+95.63	12.00	562.01
End of East Appr. Pavt.	576+05.63	12.00	561.91

SOUTH CURB LINE

Location	Station	Offset	Theoretical Grade Elevations
Back of East Abut.	575+74.02	16.42	562.14
R	575+84.02	16.42	562.03
S	575+94.02	16.42	561.93
End of East Appr. Pavt.	576+04.02	16.42	561.83

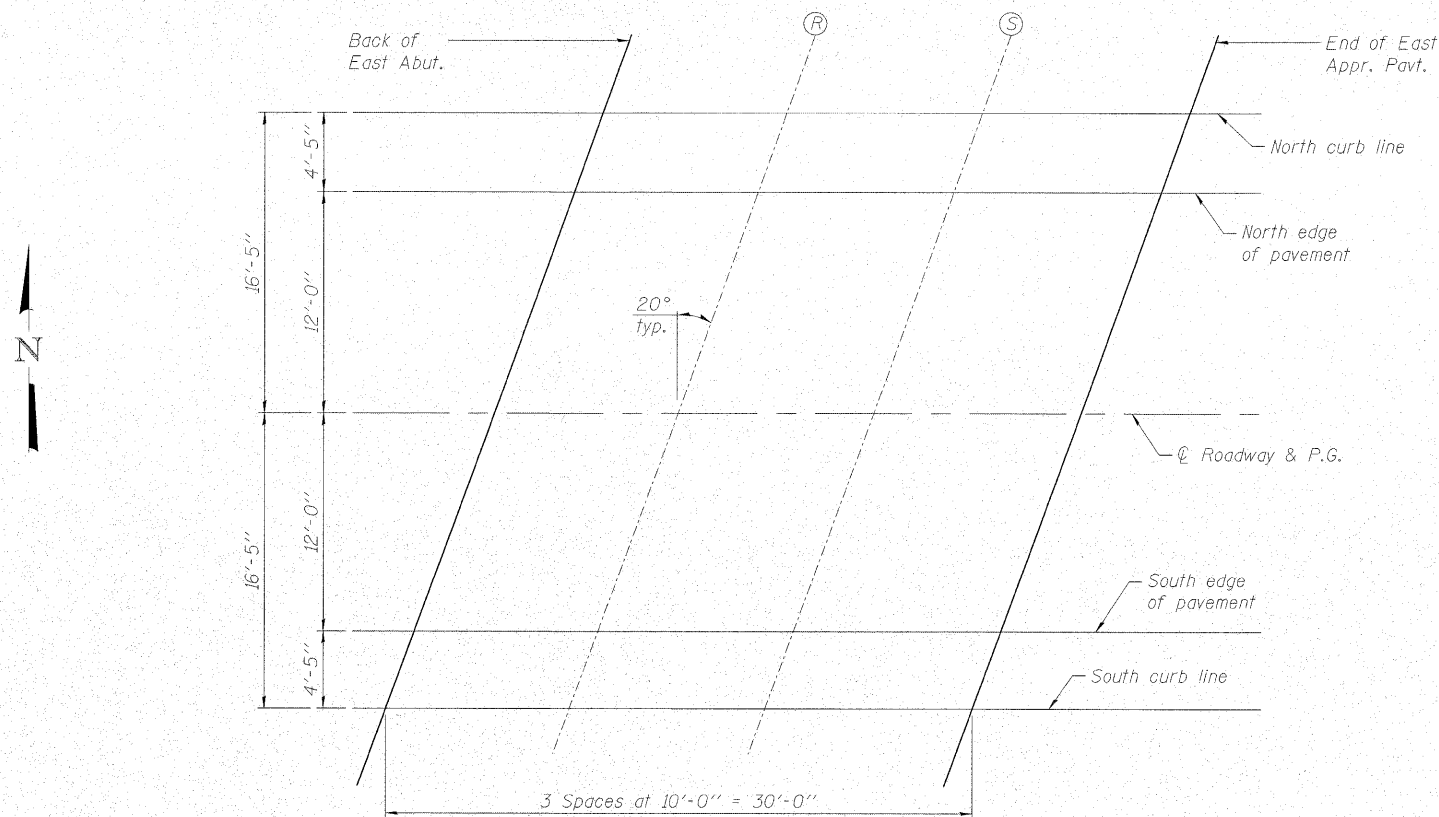

PLAN



DESIGNED - BAS
CHECKED - KEF
DRAWN - LAD
CHECKED - RJA

TOP OF EAST APPROACH  
SLAB ELEVATIONS  
IL ROUTE 121 OVER BIG MUDDY CREEK  
F.A.P. RTE. 773 - SECTION (109B)B-1  
CUMBERLAND COUNTY  
STATION 574+84.00  
STRUCTURE NO. 018-0063