

NOTE:
SEE SCHEDULE OF QUANTITIES, SHEET NO. 17, FOR TREE
REMOVAL SIZE AND LOCATION.

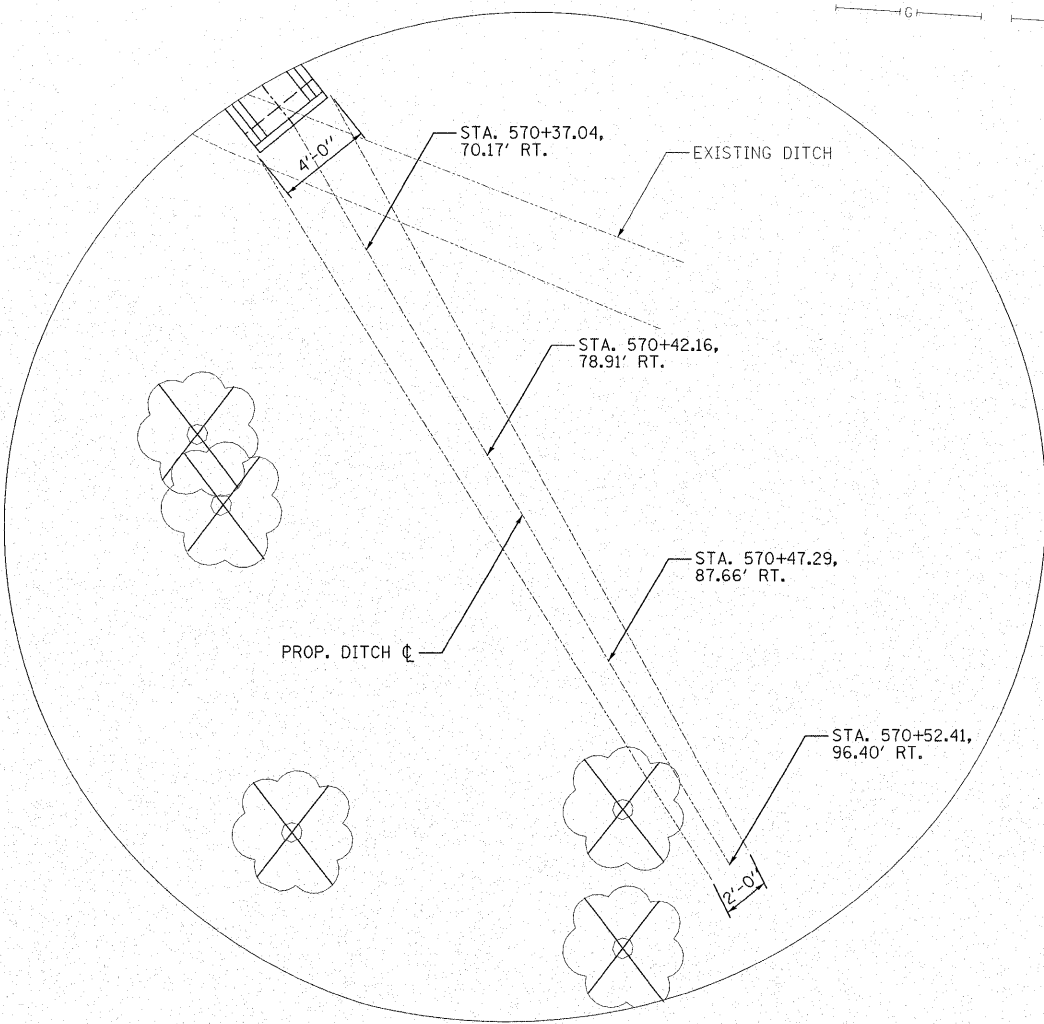

DITCH DETAIL

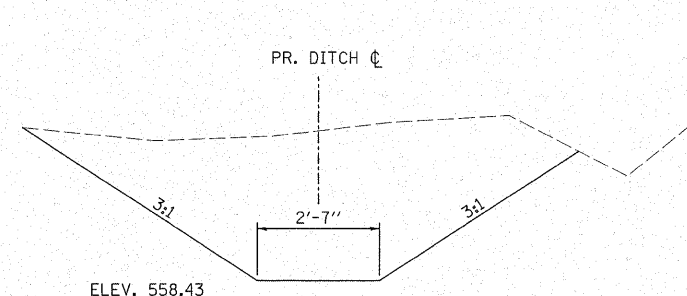
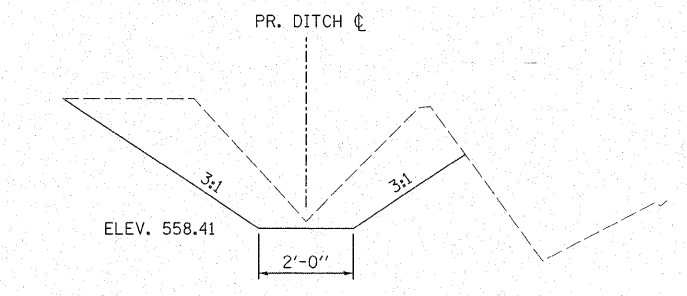
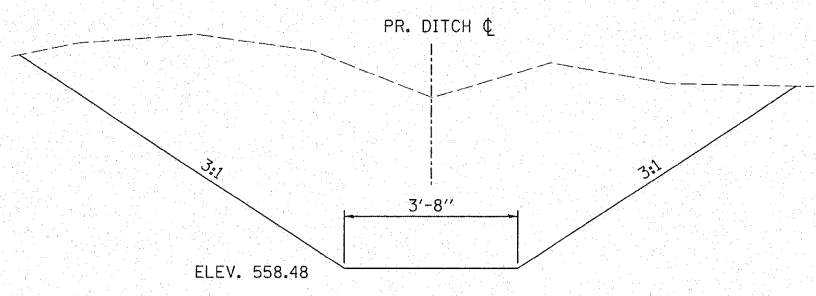
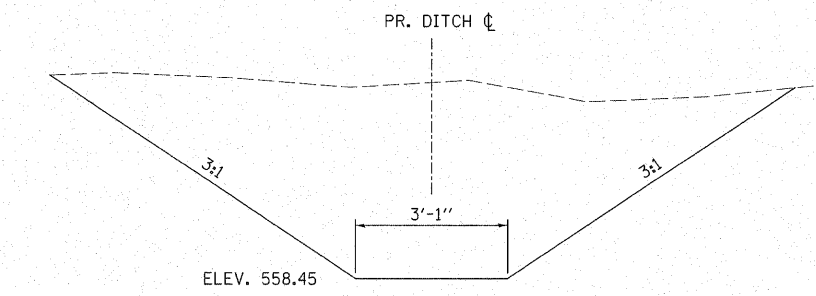

| | | | |
|---------------------|--------------------|-------------------------|-----------|
| FILE NAME = #FILEL# | USER NAME = #USER# | DESIGNED - SEM 07/08/08 | REVISED - |
| | | DRAWN - SEM 07/08/08 | REVISED - |
| | | CHECKED - RJA 09/17/08 | REVISED - |
| | | DATE - 09/26/08 | REVISED - |

**STATE OF ILLINOIS
DEPARTMENT OF TRANSPORTATION**

**IL 121 OVER BIG MUDDY CREEK
DITCH GRADING DETAIL**

| | | | | |
|-----------------------------------------------|----------------------------|-------------------|-----------------|--------------|
| F.A.P. RTE. 773 | SECTION (108BR-3, 109B)B-1 | COUNTY CUMBERLAND | TOTAL SHEETS 96 | SHEET NO. 85 |
| CONTRACT NO. 74237 | | | | |
| FED. ROAD DIST. NO. ILLINOIS FED. AID PROJECT | | | | |