

STATE OF ILLINOIS  
DEPARTMENT OF TRANSPORTATION

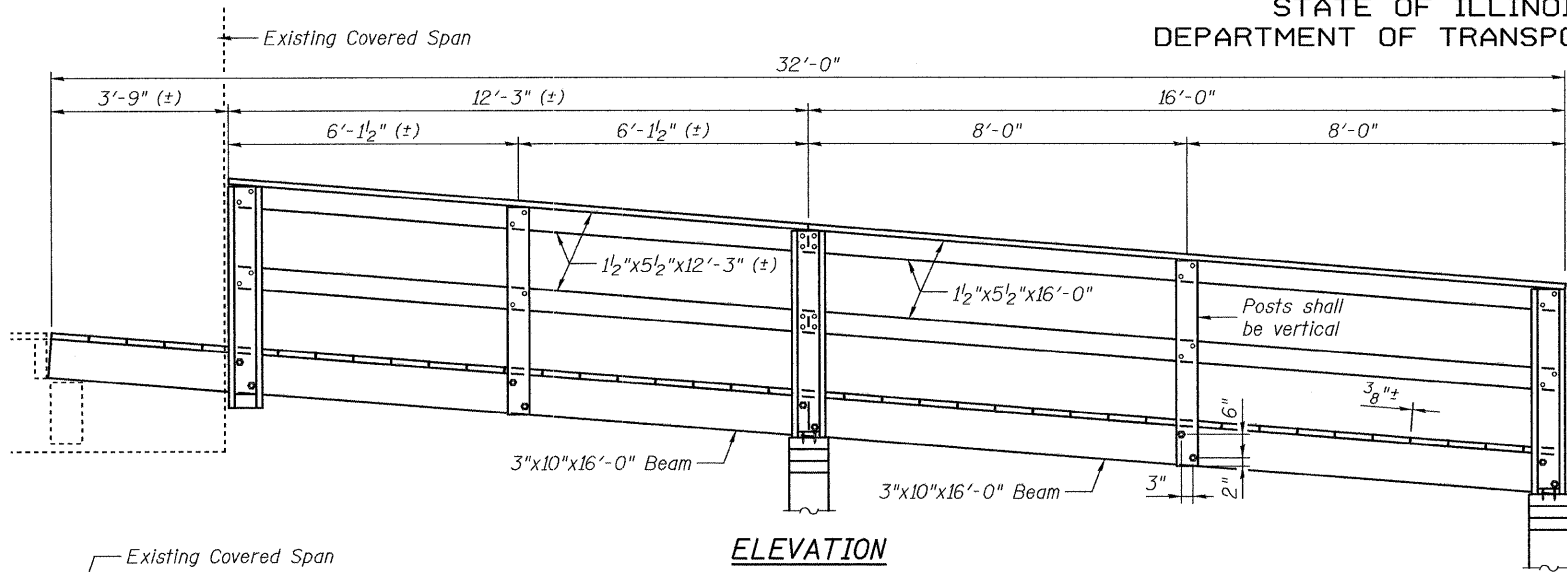

ELEVATION

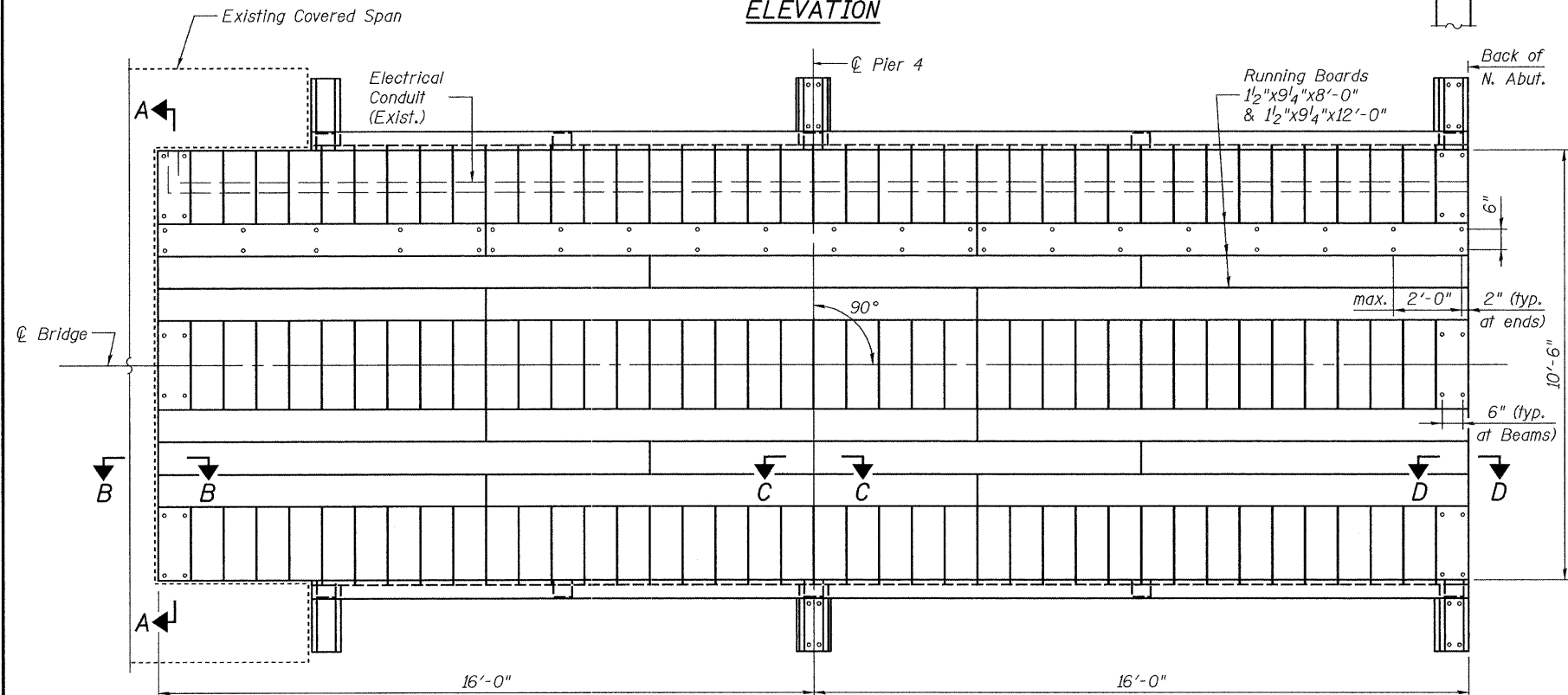

PLAN-NORTH APPROACH

NOTE:  
For additional Details and Sections,  
see sheet 2 of 12.

BILL OF MATERIAL

Item	Unit	Total
Treated Timber	F.B.M.	1614
Hardware	Pound	58



DESIGNED: JDQ	DRAWN: SJS/PTR
CHECKED: DCD	CHECKED: DCD

SUPERSTRUCTURE - NORTH APPROACH  
THOMPSON MILL COVERED BRIDGE OVER  
KASKASKIA RIVER  
STRUCTURE NO. 087-0019

SHEET 3 OF 12	T.R. RTE.	SECTION	COUNTY	TOTAL SHEETS	SHEET NO.
	389A	D-7 Bridge Appr. 2009-1	SHELBY	14	5
	STA. 50+00		CONTRACT NO. 74337		
FED. ROAD DIST. NO.		ILLINOIS FED. AID PROJECT			

FILE: J:\J00\10161L-D7V44 Thompson Mill Covered Bridge\ThompsonMill\03superstr2.dgn  
 USER: DCD  
 DATE: 02/04/2009 16:38:44