

RAMPS SLOPE TRANSITION TABLE

| STATION TO STATION | SIDE             | LOCATION  | TRANSITION  |
|--------------------|------------------|-----------|-------------|
| 17-18              | 0+049.0 0+167.0  | LT RAMP A | 1:4         |
| 18-19              | 0+167.0 0+227.0  | LT RAMP A | 1:4 to 1:6  |
| 19-9               | 0+227.0 0+322.4  | LT RAMP A | 1:6         |
| 1-20               | 0+200.1 0+258.5  | LT RAMP B | 1:20        |
| 20-21              | 0+258.5 0+287.5  | LT RAMP B | 1:20 to 1:6 |
| 21-22              | 0+287.5 0+335.0  | LT RAMP B | 1:6         |
| 22-23              | 0+335.0 0+410.0  | LT RAMP B | 1:6 to 1:4  |
| 23-24              | 0+410.0 0+546.0  | LT RAMP B | 1:4         |
| 25-26              | 0+044.0 0+278.0  | RT RAMP C | 1:6 to 1:3  |
| 26-27              | 0+278.0 0+350.0  | RT RAMP C | 1:3         |
| 27-                | 0+350.0 39+460.0 | RT RAMP C | 1:3 to 1:6  |
| 28-29              | 0+139.0 0+164.0  | LT RAMP C | 1:3 to 1:4  |
| 29-8               | 0+164.0 0+274.0  | LT RAMP C | 1:4         |
| 30-31              | 0+007.4 0+085.0  | RT RAMP D | 1:3         |
| 31-32              | 0+085.0 0+378.0  | RT RAMP D | 1:3 to 1:6  |
| 16-33              | 0+089.2 0+109.5  | LT RAMP D | 1:20        |
| 33-34              | 0+109.5 0+141.0  | LT RAMP D | 1:20 to 1:6 |
| 34-35              | 0+141.0 0+184.5  | LT RAMP D | 1:6         |
| 35-36              | 0+184.5 0+274.5  | LT RAMP D | 1:6 to 1:4  |
| 36-37              | 0+274.5 0+324.5  | LT RAMP D | 1:4 to 1:3  |

\* TRANSITION BEYOND CLEAR ZONE

| F.A.P. RTE.         | SECTION       | COUNTY           | TOTAL SHEETS | SHEET NO. |
|---------------------|---------------|------------------|--------------|-----------|
| 310                 | 60-15VB-1 & 2 | MADISON          | 144          | 29        |
| STA.                | TO STA.       |                  |              |           |
| FED. ROAD DIST. NO. | ILLINOIS      | FED. AID PROJECT |              |           |
| CONTRACT NO. 768A   |               |                  |              |           |

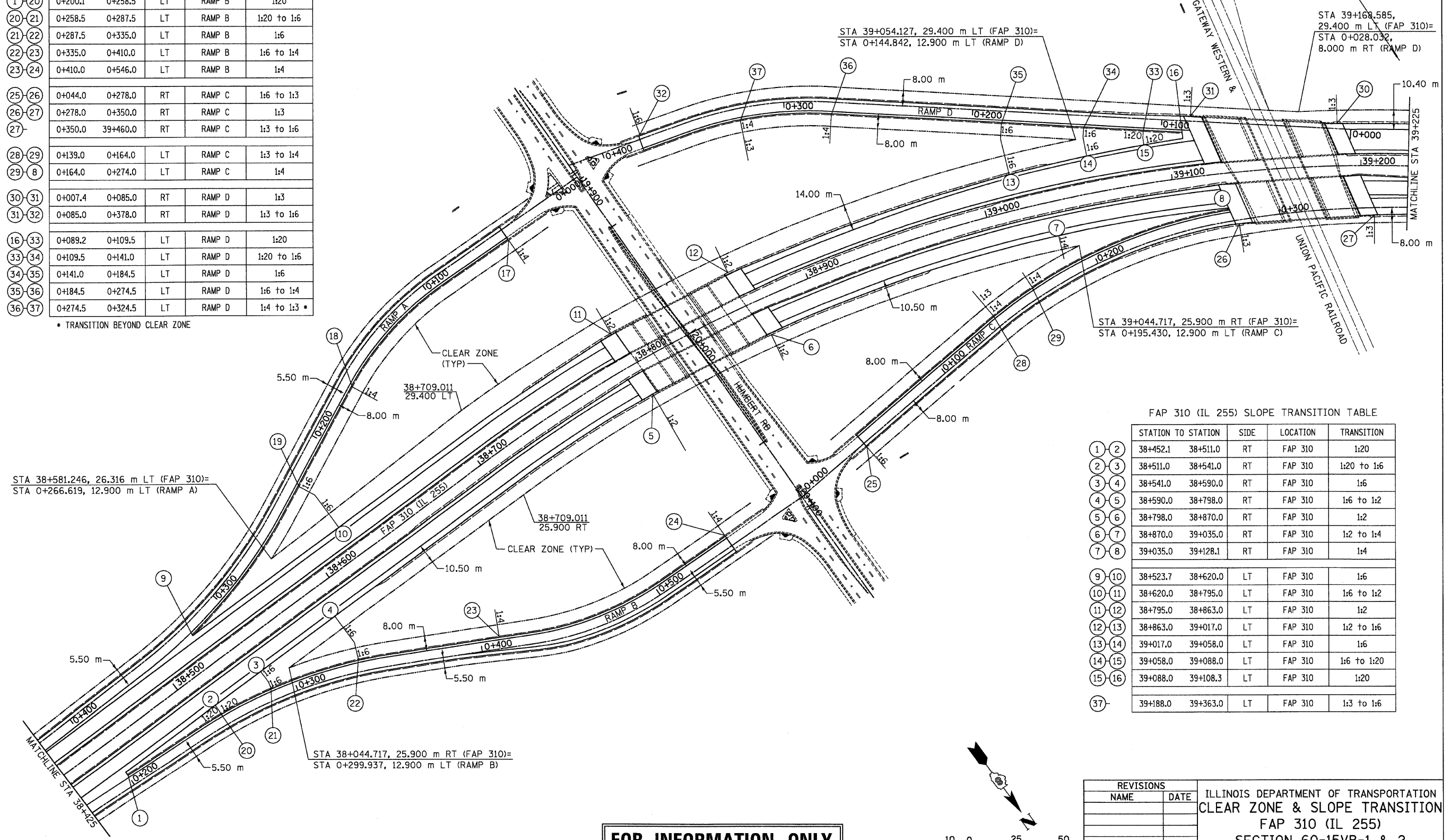

STA 38+581.246, 26.316 m LT (FAP 310)=  
STA 0+266.619, 12.900 m LT (RAMP A)

STA 38+044.717, 25.900 m RT (FAP 310)=  
STA 0+299.937, 12.900 m LT (RAMP B)

FAP 310 (IL 255) SLOPE TRANSITION TABLE

| STATION TO STATION | SIDE              | LOCATION   | TRANSITION  |
|--------------------|-------------------|------------|-------------|
| 1-2                | 38+452.1 38+511.0 | RT FAP 310 | 1:20        |
| 2-3                | 38+511.0 38+541.0 | RT FAP 310 | 1:20 to 1:6 |
| 3-4                | 38+541.0 38+590.0 | RT FAP 310 | 1:6         |
| 4-5                | 38+590.0 38+798.0 | RT FAP 310 | 1:6 to 1:2  |
| 5-6                | 38+798.0 38+870.0 | RT FAP 310 | 1:2         |
| 6-7                | 38+870.0 39+035.0 | RT FAP 310 | 1:2 to 1:4  |
| 7-8                | 39+035.0 39+128.1 | RT FAP 310 | 1:4         |
| 9-10               | 38+523.7 38+620.0 | LT FAP 310 | 1:6         |
| 10-11              | 38+620.0 38+795.0 | LT FAP 310 | 1:6 to 1:2  |
| 11-12              | 38+795.0 38+863.0 | LT FAP 310 | 1:2         |
| 12-13              | 38+863.0 39+017.0 | LT FAP 310 | 1:2 to 1:6  |
| 13-14              | 39+017.0 39+058.0 | LT FAP 310 | 1:6         |
| 14-15              | 39+058.0 39+088.0 | LT FAP 310 | 1:6 to 1:20 |
| 15-16              | 39+088.0 39+108.3 | LT FAP 310 | 1:20        |
| 37-                | 39+188.0 39+363.0 | LT FAP 310 | 1:3 to 1:6  |

**FOR INFORMATION ONLY**

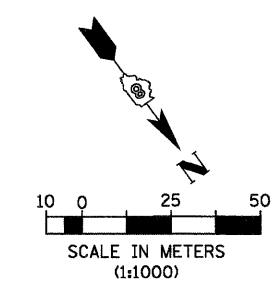

| REVISIONS |      | ILLINOIS DEPARTMENT OF TRANSPORTATION<br>CLEAR ZONE & SLOPE TRANSITION<br>FAP 310 (IL 255)<br>SECTION 60-15VB-1 & 2<br>MADISON COUNTY |
|-----------|------|---|
| NAME      | DATE |   |
|           |      | DRAWN BY BGJ<br>CHECKED BY<br>DATE  |
|           |      |   |
|           |      |   |
|           |      |   |
|           |      |   |