

10:27:42 AM
5/7/2009

p:\001\es\000024\rd\ra\road\bridge\SN060-0310\Plans\060-0310\01&2.dgn

ROUTE NO.	SECTION	COUNTY	TOTAL SHEETS	SHEET NO.	SHEET NO. 5
S. B. I.		MADISON	149	36	36 SHEETS
F. A. R. 310					
FED. ROAD DIST. NO. 7	ILLINOIS	FED. AID PROJECT			

Contract #76634 * 60-15VB-1 & 2

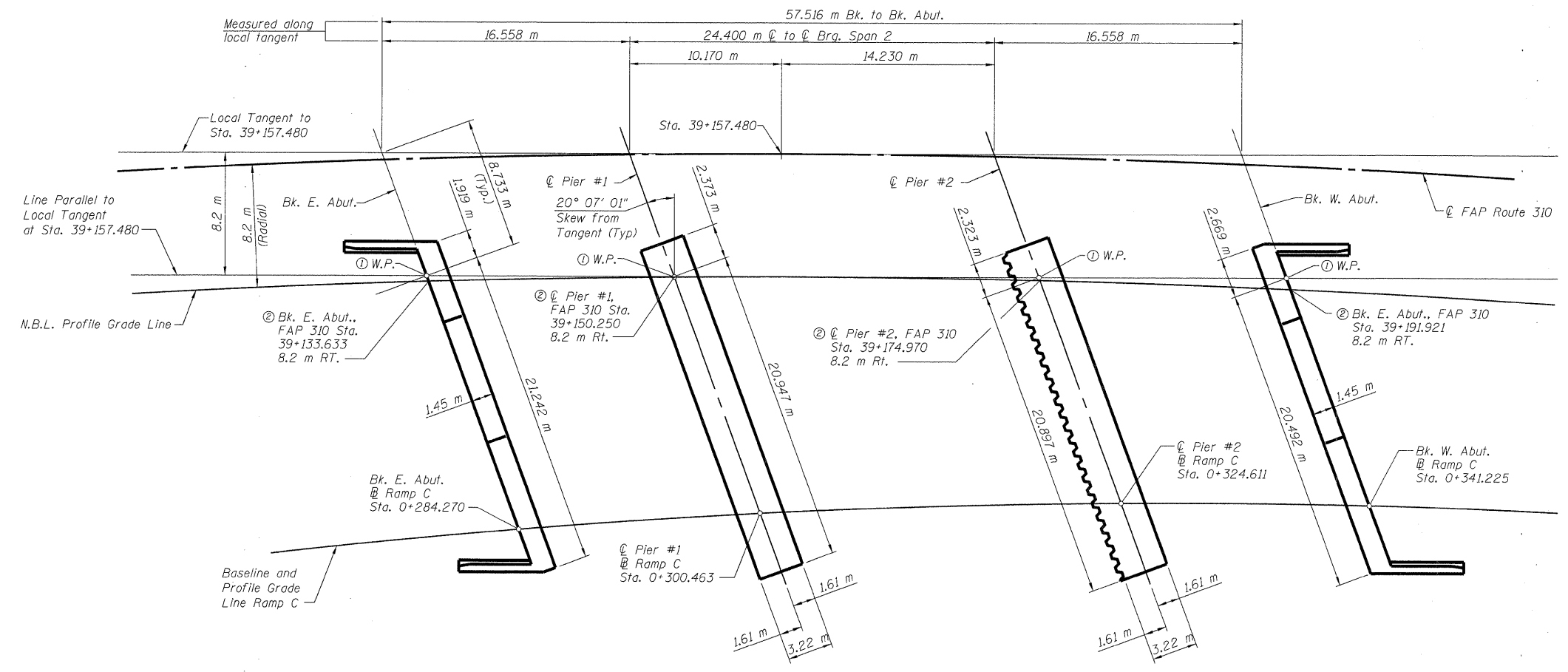

Notes:
 ① W.P.'s are from line parallel to Local Tangent at Sta. 39+157.480. Footings are dimensioned from W.P.'s.
 ② Sta./offset on N.B.L. Profile Grade Line

FOOTING PLAN



DESIGNED	ADL
CHECKED	WLW
DRAWN	RLW/ADL
CHECKED	WLW

FOOTING PLAN
 FAP RTE 310 (IL RTE 255) NB & RAMP C OVER
 UNION PACIFIC & KANSAS CITY SOUTHERN R.R.
 SECTION 60-15VB-1 & 2
 MADISON COUNTY
 STATION 39+160.297
 STRUCTURE NUMBER 060-0310