

SECTION A-A

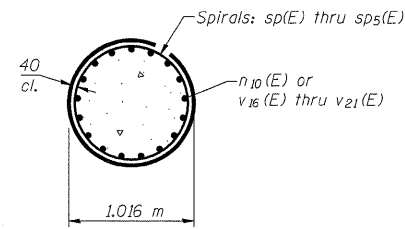

SECTION B-B

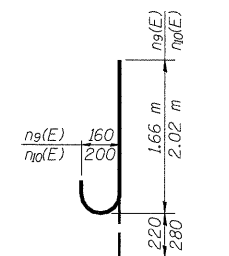

BAR n9(E) & n10(E)

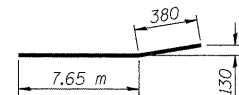

BAR p18(E)

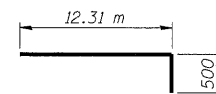

BAR p20(E)

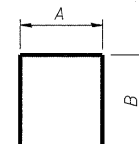

BARS s18(E), s19(E), s20(E)

A & B DIMENSIONS

Bar	A	B
s18(E)	1.21 m	1.73 m
s19(E)	1.21 m	3.870 m
s20(E)	1.21 m	870

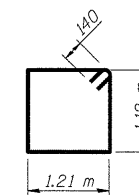

BARS s21(E)

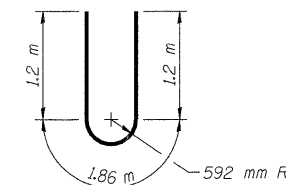

BAR u2(E)

PIER #1 BILL OF MATERIAL

Bar	No.	Size	Length (m)	Shape
h6(E)	52	#20	11.18	—
h7(E)	6	#25	11.55	—
n9(E)	6	#20	1.88	U
n10(E)	102	#25	2.30	U
p18(E)	12	#25	8.03	—
p19(E)	6	#25	9.80	—
p20(E)	12	#30	12.81	—
p21(E)	8	#20	11.57	—
p22(E)	28	#15	3.40	—
p23(E)	4	#15	1.49	—
s18(E)	102	#20	4.67	□
s19(E)	102	#20	8.95	□
s20(E)	74	#15	2.95	□
s21(E)	71	#15	4.94	□
* sp(E)	1	#15	5.12	W
* sp1(E)	1	#15	4.91	W
* sp2(E)	1	#15	4.71	W
* sp3(E)	1	#15	4.51	W
* sp4(E)	1	#15	4.31	W
* sp5(E)	1	#15	4.10	W
t(E)	106	#20	3.12	—
u2(E)	36	#20	4.26	U
v15(E)	6	#20	3.87	—
v16(E)	17	#25	5.80	—
v17(E)	17	#25	5.60	—
v18(E)	17	#25	5.40	—
v19(E)	17	#25	5.20	—
v20(E)	17	#25	5.00	—
v21(E)	17	#25	4.80	—
w(E)	22	#15	12.06	—
Concrete Structures		m ³	247.1	
Reinforcement Bars (Epoxy Coated)		kg	13,830	
Structure Excavation		m ³	365	
Furnishing Metal Pile Shell 356mmX6.35mm		m	512.0	
Driving Piles		m	512.0	

*Length is height of spiral

PIER #1 DETAILS
FAP RTE. 310 (IL RTE. 255) NB & RAMP C OVER
UNION PACIFIC & KANSAS CITY SOUTHERN R.R.
SECTION 60-15VB-1 & 2
MADISON COUNTY
STATION 39+160.297
STRUCTURE NUMBER 060-0310

Klingner & Assoc., P.C.

ps:\007\files\000024\Fat1.Road-Bridge\SN060-0310.Plan\060-0310F.er-No.1.dgn

DESIGNED	ADL
CHECKED	WLW
DRAWN	RLW/ADL
CHECKED	WLW