

STAGE II DESCRIPTION OF WORK

TRAFFIC CONTROL SHALL BE INSTALLED AS SHOWN IN THE PLANS. THE COST OF THIS TRAFFIC CONTROL SHALL BE INCLUDED IN THE PAY ITEM "TRAFFIC CONTROL AND PROTECTION, STANDARD 701402 (SPECIAL)."

TWO LANES OF THE ROADWAY SHALL BE OPENED ON THE LEFT SIDE OF THE DIRECTION OF TRAFFIC.

SEQUENCE OF CONSTRUCTION, STAGE II

REMOVE SKIP-DASH AND CONFLICTING SOLID EDGE PAVEMENT MARKINGS.

PLACE TRAFFIC CONTROL DETAILS ACCORDING TO PLANS.

RELOCATE TEMPORARY CONCRETE BARRIER AND IMPACT ATTENUATORS, TEMPORARY.

PERFORM ALL NECESSARY BRIDGE WORK IN STAGE II WORK ZONE.

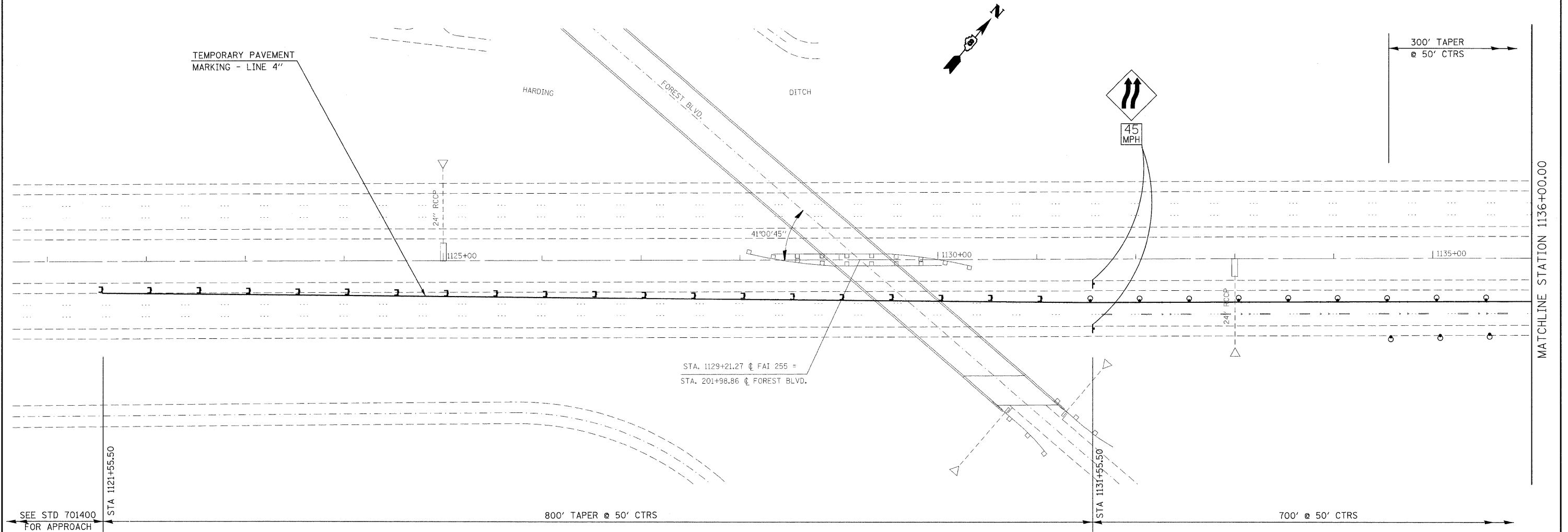

LEGEND

- W1-4b-(0)-48
(NO. OF ARROW SHALL MATCH THE NO. OF LANES OPEN TO TRAFFIC AND THE DIRECTION OF TRAVEL.)
- W13-1-(0) -24
- 4' x 8'; 1" BORDER WITH 10" CAPITAL LETTERS
BACKGROUND SHEETING SHALL BE THE SAME AS ALL DIAMOND SHAPED CONSTRUCTION SIGNS. (STATE OWNED)
- W1-6(0) 7236 ATOP TYPE III BARRICADE
(DIRECTION OF ARROW SHALL MATCH DIRECTION OF TRAVEL.)
- G20-I103(0)-4830

LEGEND

- DRUM WITH STEADY BURNING LIGHT
- DIRECTION INDICATOR BARRICADE WITH STEADY BURNING LIGHT
- TYPE III BARRICADE WITH STEADY BURNING LIGHTS
- TEMPORARY CONCRETE BARRIER
- IMPACT ATTENUATORS
- WORK AREA

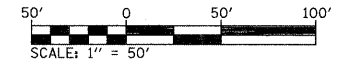

FILE NAME =	USER NAME = gselnh	DESIGNED -	REVISED -	STATE OF ILLINOIS DEPARTMENT OF TRANSPORTATION	SUGGESTED STAGE II CONSTRUCTION & TRAFFIC CONTROL	F.A.I. RTE. 255	SECTION 82-1B-3-I	COUNTY ST CLAIR	TOTAL SHEETS 21	SHEET NO. 8		
CONTRACT NO. 76C67	SCALE: _____ SHEET NO. ____ OF ____ SHEETS		STA. _____ TO STA. _____			ILLINOIS FED. AID PROJECT						
ILLINOIS FED. AID PROJECT												
ILLINOIS FED. AID PROJECT												