

IL 127 NORTHBOUND DETOUR

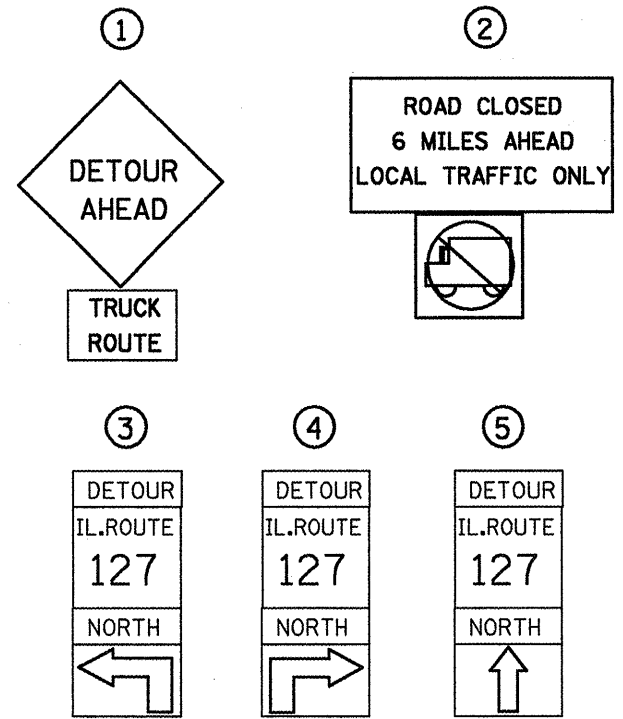
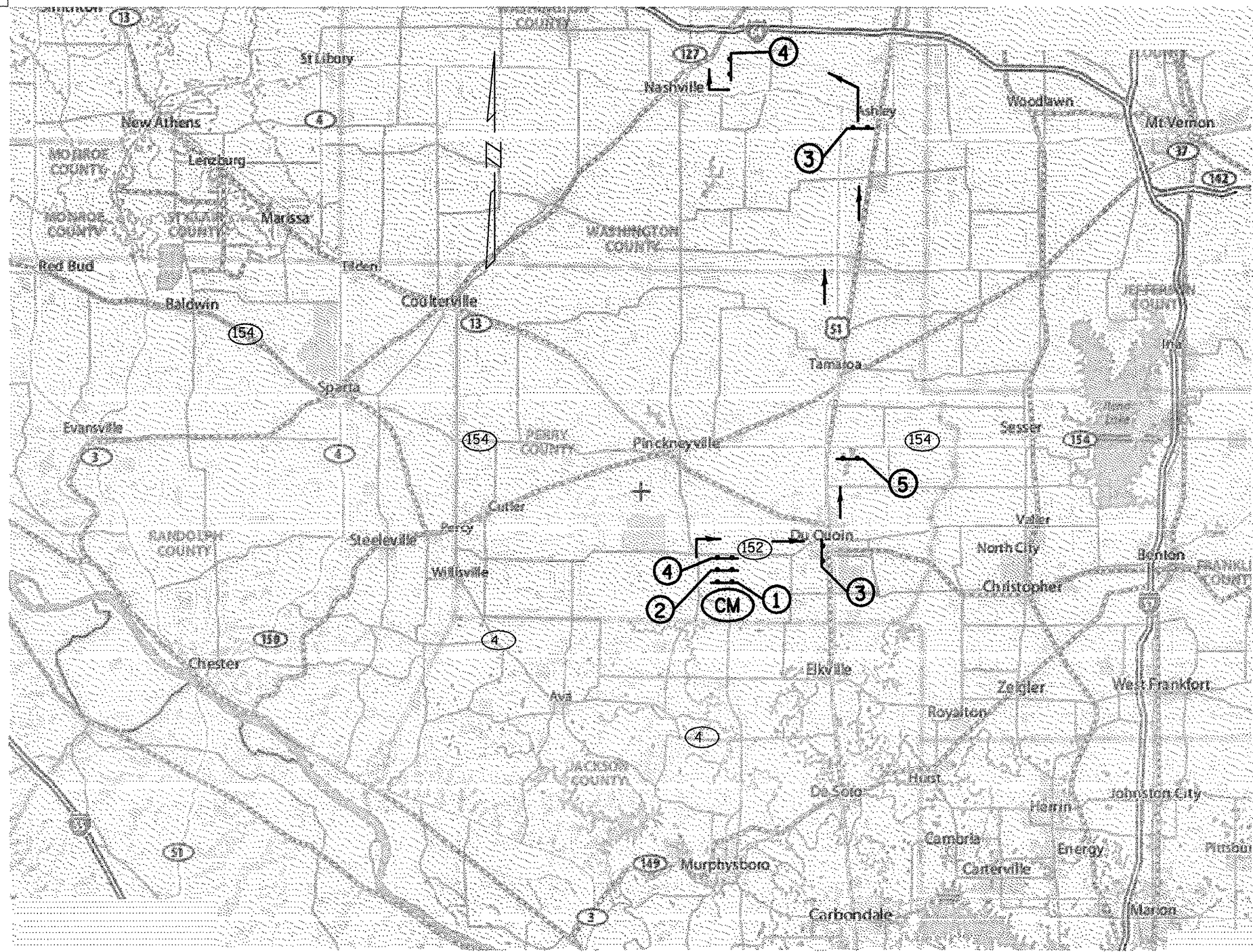

CM CHANGEABLE MESSAGE SIGN LOCATION

DETOUR ROUTE GOES THROUGH
DUQUOIN, TAMAROA AND NASHVILLE.

*FAP 42/841

FILE NAME =	USER NAME = mccordkr	DESIGNED -	REVISED -	STATE OF ILLINOIS DEPARTMENT OF TRANSPORTATION	DETOUR SIGNING NORTHBOUND IL 127	F.A. RTE.	SECTION	COUNTY	TOTAL SHEETS	SHEET NO.
01\pw_work\PWIDOT\MCCORDKR\0120164\781	7-ahf-m150.dgn	DRAWN -	REVISED -				08.103.108N-1	PERBY	24	20
	PLOT SCALE = 100.0000 / IN.	CHECKED -	REVISED -							
	PLOT DATE = 3/23/2009	DATE -	REVISED -							
					SCALE: _____	SHEET NO. _____ OF _____ SHEETS		STA. _____ TO STA. _____		ILLINOIS FED. AID PROJECT
										CONTRACT NO. 78117