

IL 13 EASTBOUND DETOUR

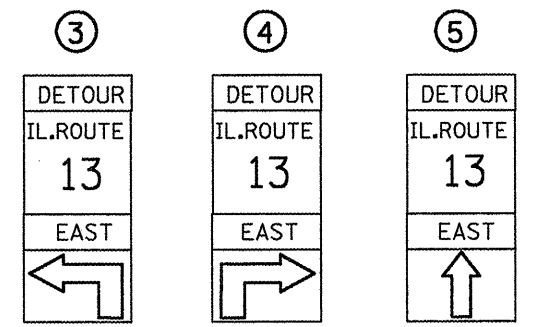
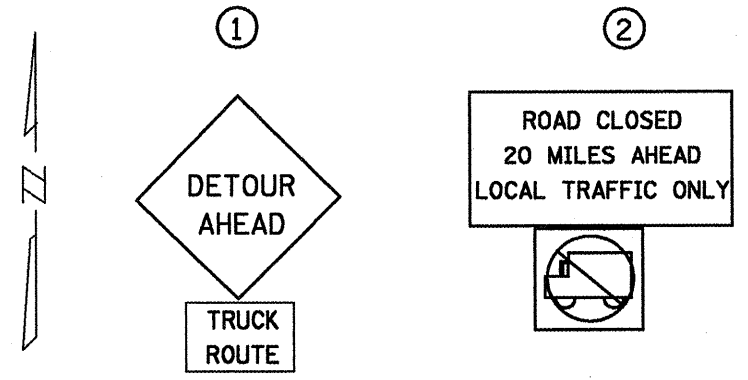
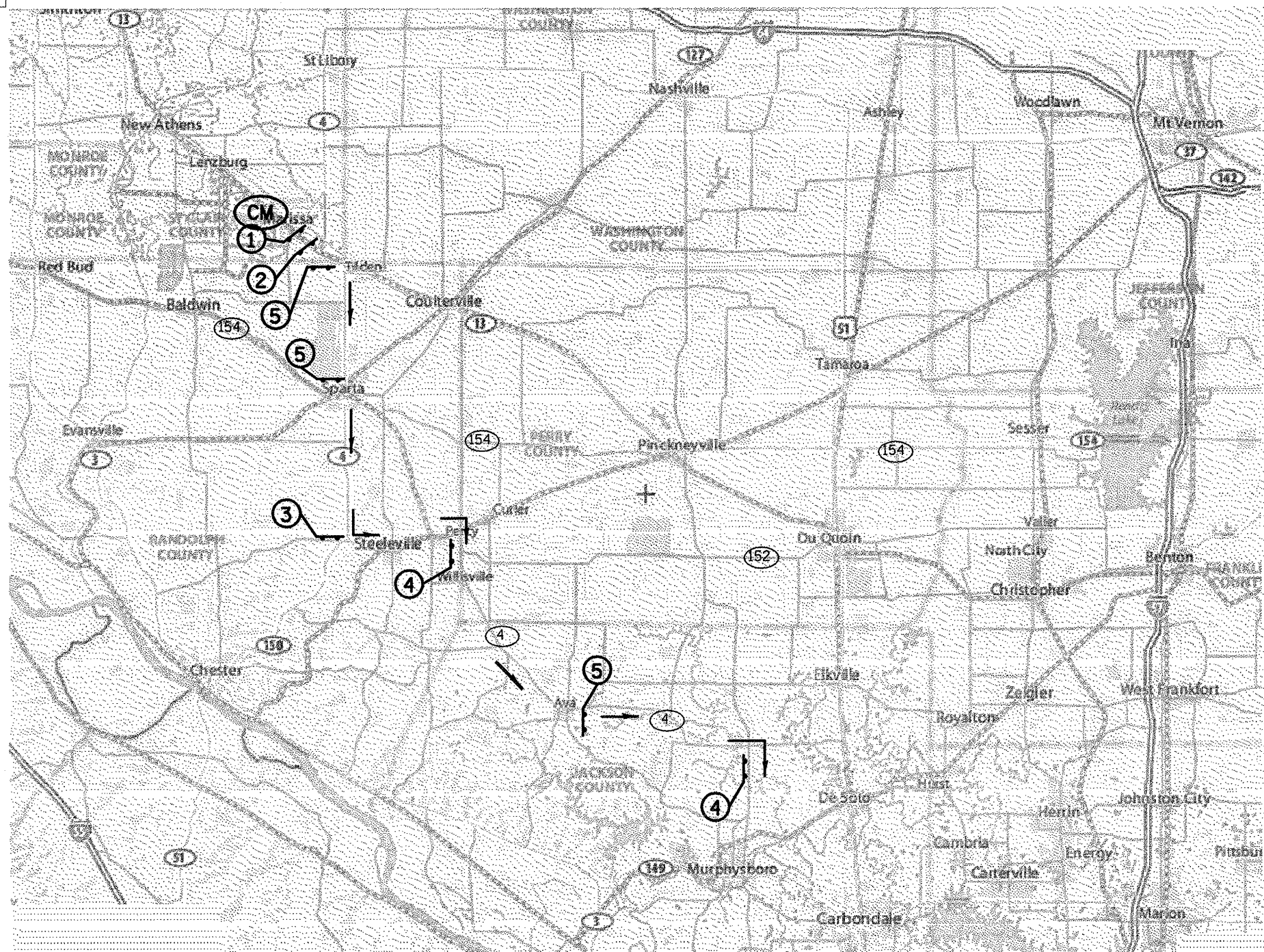

CM CHANGEABLE MESSAGE SIGN LOCATION

DETOUR ROUTE GOES THROUGH TILDEN, SPARTA, STEELEVILLE, PERCY AND AVA.

*FAP 42/841

FILE NAME = c:\pwork\pvidot\mccordkr\d8128164\781	USER NAME = mcoordkr 7-shv-misc.dgn	DESIGNED - DRAWN -	REVISED - REVISED -	STATE OF ILLINOIS DEPARTMENT OF TRANSPORTATION	DETOUR SIGNING EASTBOUND IL 13	F.A. RTE. = SECTION = (8,103,108)1-1 COUNTY = PERRY TOTAL SHEETS = 24 SHEET NO. = 22
PLOT SCALE = 1/88,000" / IN. PLOT DATE = 3/23/2009		CHECKED - DATE -	REVISED - REVISED -	SCALE: _____ SHEET NO. ____ OF ____ SHEETS STA. _____ TO STA. _____		CONTRACT NO. 78117 <small>ILLINOIS FED. AID PROJECT</small>