

F.A.U. RTE.	SECTION	COUNTY	TOTAL SHEETS	SHEET NO.
99-00109-01-BT	DU PAGE	74	18	
STA. 115+00		TO STA. 130+00		
FED. ROAD DIST. NO. 1		ILLINOIS FED. AID PROJECT		

CONTRACT No. 83728

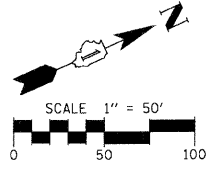

- NOTES:
1. DETECTABLE WARNINGS AND CONCRETE PAD ARE TO BE INSTALLED AT ALL CROSS WALKS ALONG THE BIKE PATH.
 2. TEMPORARY FENCE SHALL BE REMOVED ONLY AFTER CONSTRUCTION WORK IS COMPLETE.
 3. TRAIL TREE ROOT BARRIER SHALL BE INSTALLED ON BOTH SIDES OF THE PATH FROM STA. 115+00 TO 120+00.

DATE	BY
DATE	BY
DATE	BY

DATE	BY
DATE	BY
DATE	BY

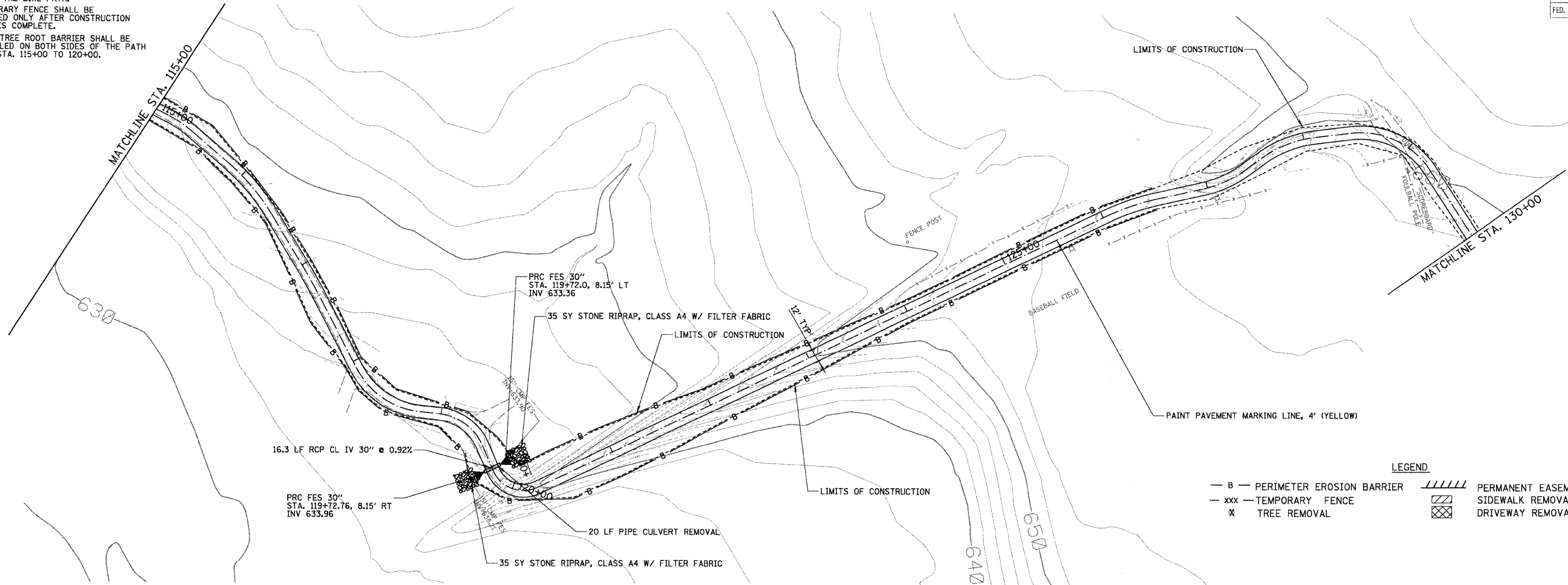

LEGEND

- B -	PERIMETER EROSION BARRIER	////	PERMANENT EASEMENT
- xxx -	TEMPORARY FENCE		SIDEWALK REMOVAL
x	TREE REMOVAL	XXXX	DRIVEWAY REMOVAL AND REPLACEMENT

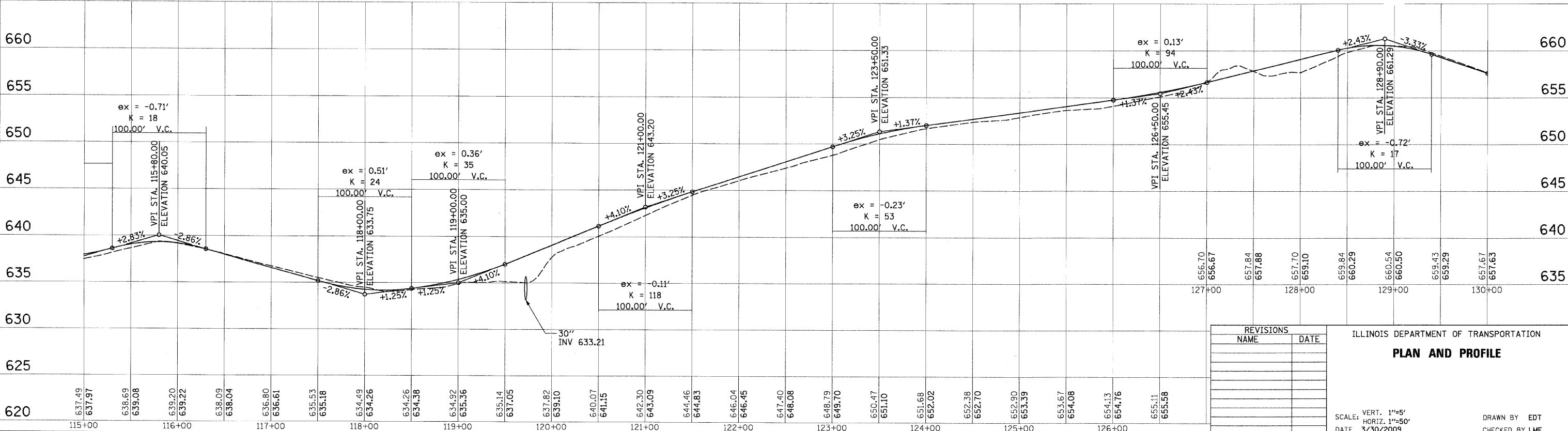

REVISIONS	
NAME	DATE

ILLINOIS DEPARTMENT OF TRANSPORTATION
PLAN AND PROFILE
 SCALE: VERT. 1"=5'
 HORIZ. 1"=50'
 DATE 3/30/2009
 DRAWN BY EDT
 CHECKED BY LMF