

INDEX OF SHEETS

- 1 COVER SHEET
- 2 GENERAL NOTES
- 3 SUMMARY OF QUANTITIES
- 4-6 SCHEDULE OF QUANTITIES
- 7 TYPICAL SECTIONS
- 8-31 PLAN AND PROFILES
- 32-65 CROSS SECTIONS
- 66-70 CROSS SECTIONS @ POLES
- 71-74 SIGNAGE AND STRIPING
- 75-78 STAGING PLANS
- 79 MEDIAN CROSSOVER DETAILS
- 80-82 ROUTE 20 CROSSING HEADWALL
- 83 TEMPORARY SOIL RETENTION SYSTEM
- 84-96 BRIDGES
- 97-98 MISCELLANEOUS DETAILS/TEMPORARY ROADWAY LIGHTING

STANDARDS

- 280001-04 TEMPORARY EROSION CONTROL SYSTEMS
- 420001-07 PAVEMENT JOINTS
- 420801-05 7.2m (24") PCC PAVEMENT
- 420701-02 PAVEMENT FABRIC
- 542301-02 PRECAST REINFORCED CONCRETE FLARED END SECTIONS
- 542306-02 PRECAST REINFORCED CONCRETE ELLIPTICAL FLARED END SECTIONS
- 542401-01 METAL END SECTION FOR PIPE CULVERTS
- 542406-01 METAL END SECTION FOR PIPE ARCHES
- 630001-08 STEEL PLATE BEAM GUARDRAIL
- 631011-05 TRAFFIC BARRIER TERMINAL, TYPE 2
- 701901-01 TRAFFIC CONTROL DEVICES
- 701001-01 OFF-RD OPERATIONS, 2L, 2W, MORE THAN 4.5 m (15') AWAY
- 701006-03 OFF-RD OPERATIONS, 2L 2W, 4.5m (15') TO 600mm (24") AWAY, FOR SPEEDS ≥ 45 MPH
- 701101-02 OFF-RD OPERATIONS, MULTILANE, 4.5 m (15') TO 600 mm (24") FROM PAVEMENT EDGE
- 701106-02 OFF-RD OPERATIONS, MULTILANE, MORE THAN 4.5 m (15') AWAY
- 701201-03 LANE CLOSURE, 2L 2W, DAY ONLY, ON-ROAD TO 600mm (24") OFF-ROAD, FOR SPEEDS ≥ 45 MPH
- 701301-03 LANE CLOSURE, 2L 2W, SHORT TIME OPERATIONS, FOR SPEEDS ≥ 45 MPH
- 701400-03 APPROACH TO LANE CLOSURE, FREEWAY/EXPRESSWAY
- 701401-05 LANE CLOSURE, FREEWAY / EXPRESSWAY
- 701416-06 LANE CLOSURE, MULTILANE, DIVIDED, WITH CROSSOVER, FOR SPEEDS ≥ 45 MPH
- 701426-03 LANE CLOSURE, MULTILANE, INTERMITTENT OR MOVING OPER., FOR SPEEDS ≥ 45 MPH
- 701501-05 URBAN LANE CLOSURE, 2L, 2W UNDIVIDED
- 701701-06 URBAN LANE CLOSURE, MULTILANE INTERSECTION
- 701801-04 LANE CLOSURE, MULTILANE, 1W OR 2W CROSSWALK OR SIDEWALK CLOSURE, FOR SPEEDS ≤ 45 MPH
- 704001-05 TEMPORARY CONCRETE BARRIER
- 720001-01 SIGN PANEL MOUNTING DETAILS
- 720006-02 SIGN PANEL ERECTION DETAILS
- 720011-01 METAL POSTS (SIGNS, MARKERS, AND DELINEATORS)
- 728001-01 TELESCOPING STEEL SIGN SUPPORT
- 729001-01 APPLICATION OF TYPE A AND B METAL POSTS
- 780001-02 TYPICAL PAVEMENT MARKINGS
- BLR-17-4 TRAFFIC CONTROL DEVICES - DAY LABOR CONSTRUCTION TEMPORARY LIGHTING SYSTEM
- BLR-21-3 TYPICAL APPLICATION OF TRAFFIC CONTROL DEVICES FOR CONSTRUCTION ON RURAL LOCAL HIGHWAY
- BLR-22-6 TYPICAL APPLICATION OF TRAFFIC CONTROL DEVICES FOR CONSTRUCTION ON RURAL LOCAL HIGHWAY (TWO-LANE TWO WAY RURAL TRAFFIC)(ROAD CLOSED TO THRU TRAFFIC)

UTILITIES:

- ELECTRIC:**
ComEd
MIKE LENNOX
123 ENERGY AVENUE
ROCKFORD, ILLINOIS 61109
(815) 490-2869
- GAS:**
NICOR
CONSTANCE LANE
UTILITY CONSULTANT
1844 FERRY ROAD
NAPERVILLE, ILLINOIS 60563-9600
(630) 388-3830
- TELEPHONE:**
ATT
STEVE STULL
2404 8th AVENUE
ROCKFORD, ILLINOIS 61108
(815) 394-7276
- VERIZON
WINDY BOCKO
104 W. MULBERRY
NORMAL, ILLINOIS 61761
(309) 454-1511
- SEWER:**
ROCK RIVER WATER RECLAMATION DISTRICT
3333 KISHWAUKEE STREET
ROCKFORD, ILLINOIS 61109
(815) 387-7400
- VILLAGE OF WINNEBAGO
108 WEST MAIN
WINNEBAGO, ILLINOIS 61088
(815) 335-2020
- WATER:**
CITY OF ROCKFORD WATER DIVISION
425 EAST STATE STREET
ROCKFORD, ILLINOIS 61104
(815) 987-5570
- VILLAGE OF WINNEBAGO
108 WEST MAIN
WINNEBAGO, ILLINOIS 61088
(815) 335-2020
- CITY:**
CITY OF ROCKFORD
DEPARTMENT OF PUBLIC WORKS
425 EAST STATE STREET
ROCKFORD, ILLINOIS 61104
(815) 987-5570

C.A.T.V.:
COMCAST
MICHAEL OWENS
4450 KISHWAUKEE STREET
ROCKFORD, ILLINOIS 611098
(815) 395-8977



CALL J.U.L.I.E. BEFORE YOU DIG
1-800-892-0123
TOLL FREE

SCALES:

PLAN & PROFILE: 1:1000 HORIZONTAL - 1:50 VERTICAL (RURAL)
1:250 HORIZONTAL - 1:50 VERTICAL (URBAN)
CROSS SECTIONS: 1:50 HORIZONTAL - 1:50 VERTICAL

PLANS FOR PROPOSED TEA21 ENHANCEMENT FUND PROJECT

PECATONICA PRAIRIE PATH SECTION 94-00267-00-BT PROJECT No. TE-D2(94) WINNEBAGO COUNTY JOB NO. C-92-129-00

CONTRACT NO. 85443
ITEP #201013

PATH/BRIDGES STA. 34+820 - STA. 47+757

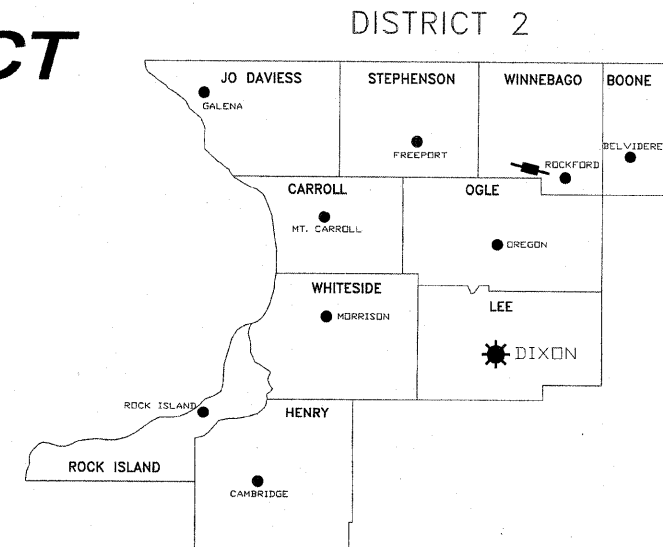
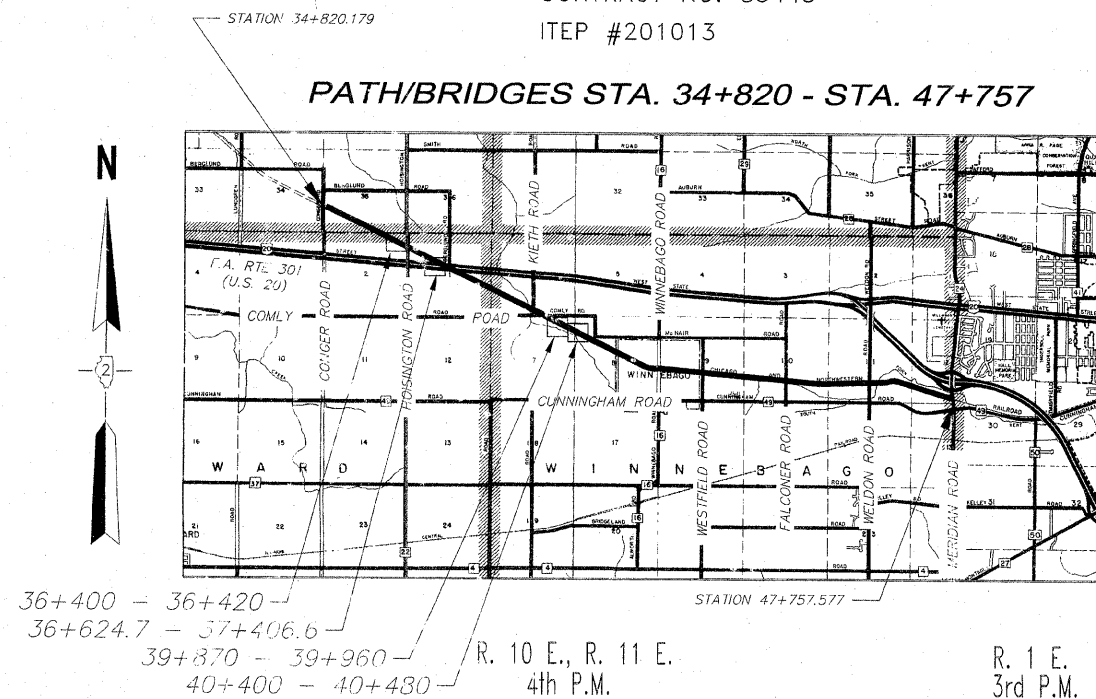

☀ DISTRICT HEADQUARTERS
➡ PROJECT LOCATION

LEGEND

- DECIDUOUS TREE
- EVERGREEN TREE
- SIGN
- UTILITY POLE
- TELEPHONE PEDESTAL
- ELECTRIC TRANSFORMER
- EXISTING CABLE TELEVISION LINE
- EXISTING OVERHEAD ELECTRIC LINE
- EXISTING GAS MAIN
- EXISTING UNDERGROUND TELEPHONE LINE
- EXISTING OVERHEAD ELECTRIC/TELEVISION
- EXISTING WATER MAIN
- EXISTING VALVE AND VAULT
- EXISTING VALVE AND BOX
- EXISTING FIRE HYDRANT ASSEMBLY
- EXISTING ELECTRIC HANDHOLE
- EXISTING BUILDING
- EXISTING EASEMENT LINE
- PROPOSED EASEMENT LINE
- RIGHT-OF-WAY
- SECTION LINE
- CENTER LINE
- WET LAND
- BARBED WIRE FENCE
- LANDSCAPE LIMITS
- EXISTING MANHOLE
- EXISTING STORM SEWER
- PROPOSED STORM SEWER
- EXISTING SANITARY SEWER
- EXISTING INLET TYPE 700
- EXISTING INLET TYPE 6-A
- EXISTING INLET SPECIAL

DATE SIGNED 2/23/09
EXPIRES 11/30/09

DATE SIGNED 2/24/09
EXPIRES 11/30/2010

PASSED March 9 2009
DISTRICT ENGINEER OF LOCAL ROADS & STREETS

RELEASED FOR BID March 9 2009
BASED ON LIMITED REVIEW
DEPUTY DIRECTOR OF HIGHWAYS, REGIONAL ENGINEER

APPROVED February 26 2009
WINNEBAGO COUNTY HIGHWAY ENGINEER

REVISIONS		
NO.	ITEM	DATE
1	ADDITIONAL REINFORCEMENT TO ABUTMENTS	1/19/09
2	REVIEW COMMENTS	1/22/09

PLOTTING SCALE: 1 : 1

DRAWN BY: REK

CHECKED BY:

DATE: DECEMBER, 2008

McClure
Engineering Associates, Inc.
7282 Argus Drive
Rockford, Illinois 61107-5837
(815) 398-2332
FAX (815) 398-2496
Design Firm License: Illinois 184-000816

COVER SHEET
Contract 85443
PECATONICA PRAIRIE PATH
WINNEBAGO COUNTY HIGHWAY DEPARTMENT SECTION 94-00267-00-BT
G:\surveys\PECPATH\1ST RELEASE\98-037 COVER.dwg
JOB NUMBER: 04-28-98-037

SHEET NO. 1 OF 98+1099