

Centerline Curve Data
P.I. = 41+766.872
 $\Delta = 21^{\circ}53'57''$ (5729.65')
 $R = 1746.397m$ (1108.50')
 $T = 337.871m$ (2189.94')
 $L = 667.495m$ (106.24')
 $E = 32.383m$
P.C. = 41+429.001
P.T. = 41+675.970

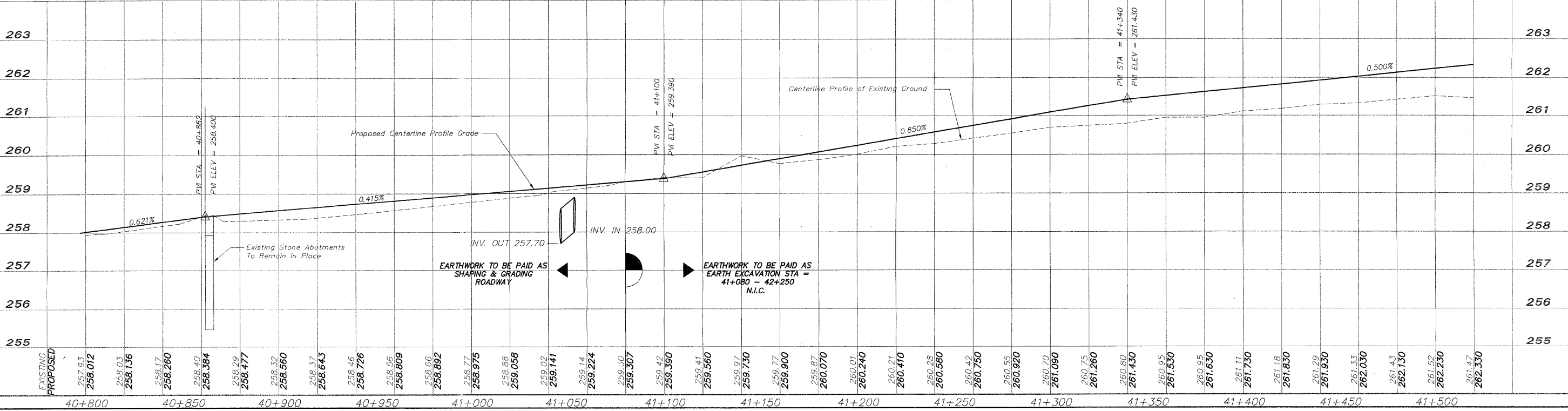
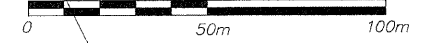
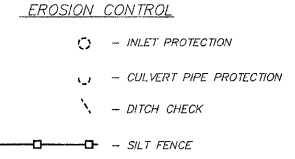

NO.	ITEM	DATE
2	REVIEW COMMENTS	1/22/09

PLOTTING SCALE: 1 : 1

DRAWN BY: REK

CHECKED BY:

DATE: DECEMBER, 2008

McClure
Engineering Associates, Inc.

7282 Argus Drive
Rockford, Illinois 61107-5837
(815) 398-2332 FAX (815) 398-2496
Design Firm License: Illinois 184-000816
Copyright 2006 By McClure Engineering Associates, Inc.

PLAN AND PROFILE 40+800/41+500

PECATONICA PRAIRIE PATH Contract 85443

WINNEBAGO COUNTY HIGHWAY DEPARTMENT SECTION 94-00267-00-BT

FILE NAME: G:\surveys\PECPATH\1ST RELEASE\98-037 pp40+800-41+500.dwg JOB NUMBER: 04-28-98-037

SHEET NO.
17
OF
98