

- PAVEMENT MARKING LEGEND**
- 1 PAINT PAVEMENT MARKING - LINE 6" (CROSSWALK EDGE LINE)
 - 2 PAINT PAVEMENT MARKING - LINE 12" (CROSSWALK)
 - 3 PAINT PAVEMENT MARKING - LINE 24" (STOP BAR)

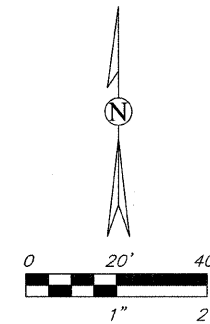

Tilton School

1050 Tilton School

PERIMETER EROSION BARRIER (SLT FENCE) TO BE PLACED AS DIRECTED BY THE ENGINEER

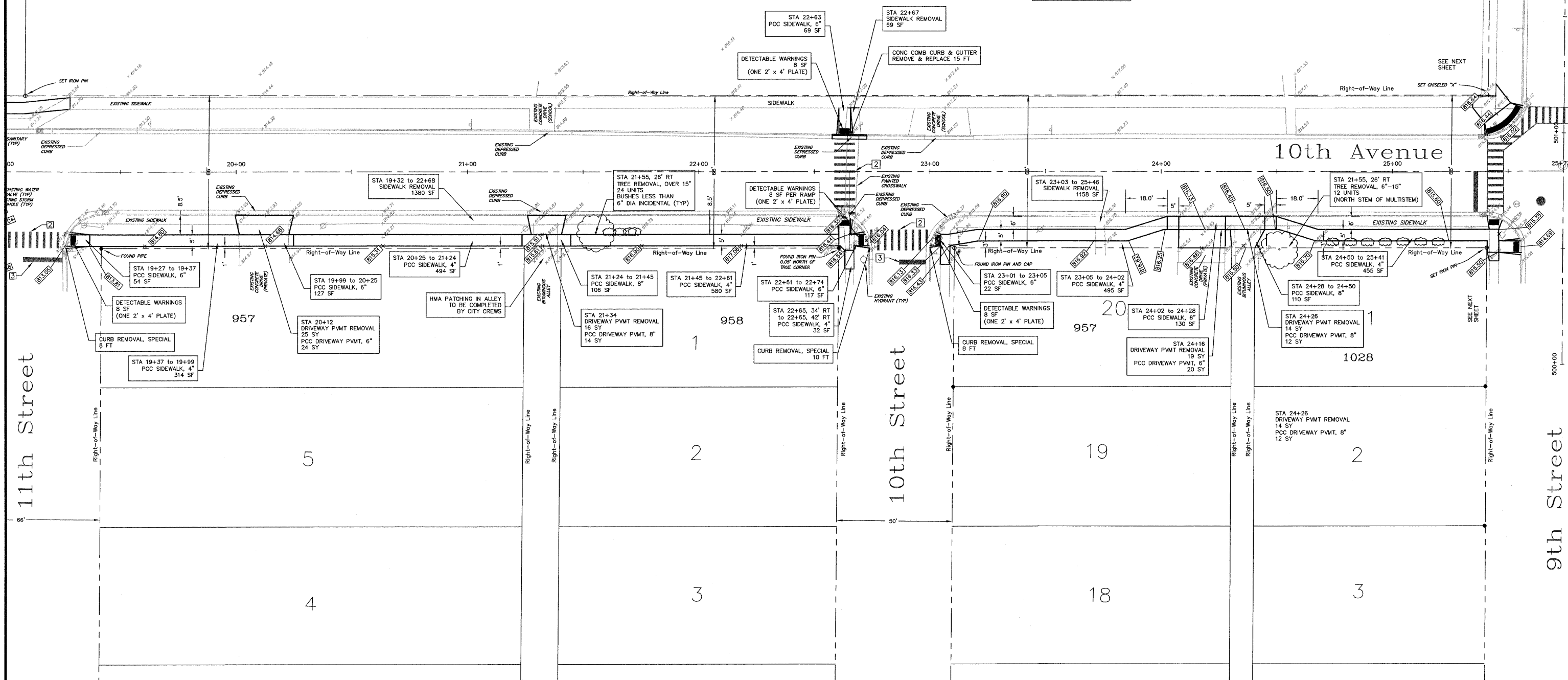

11th Street

10th Street

9th Street

City of Rochelle
Engineering Division
417 N. 6th St. Rochelle, IL 61068

PROJECT: **Safe Routes to School**
10th Avenue Sidewalk Improvements
9th Street to Atwood & Cooper Parks
Section No 08-00104-00-SW

REVISIONS			
REV	DESCRIPTION	DATE	APPROVED
1	Per IDOT Review	3/23/09	SCT
2	Per IDOT Review	3/30/09	SCT

DRAWING: **10th Avenue - 11th St. to 9th St.**

SCALE: HORIZ SCALE: 1" = 20'
VERT SCALE: N/A

DRAWN BY: CW
CHECKED BY: ST
DATE: 3/20/09

SHEET: **6 of 11**
Contract 05A5B