

F.A.S. RTE.	SECTION	COUNTY	TOTAL SHEETS	SHEET NO.
	03-26140-00-BR 03-21117-00-BR	LIVINGSTON	28	4
STA.	TO STA.			
FED. ROAD DIST. NO. 7	ILLINOIS FED. AID PROJECT*			
CONTRACT NO. 87360				

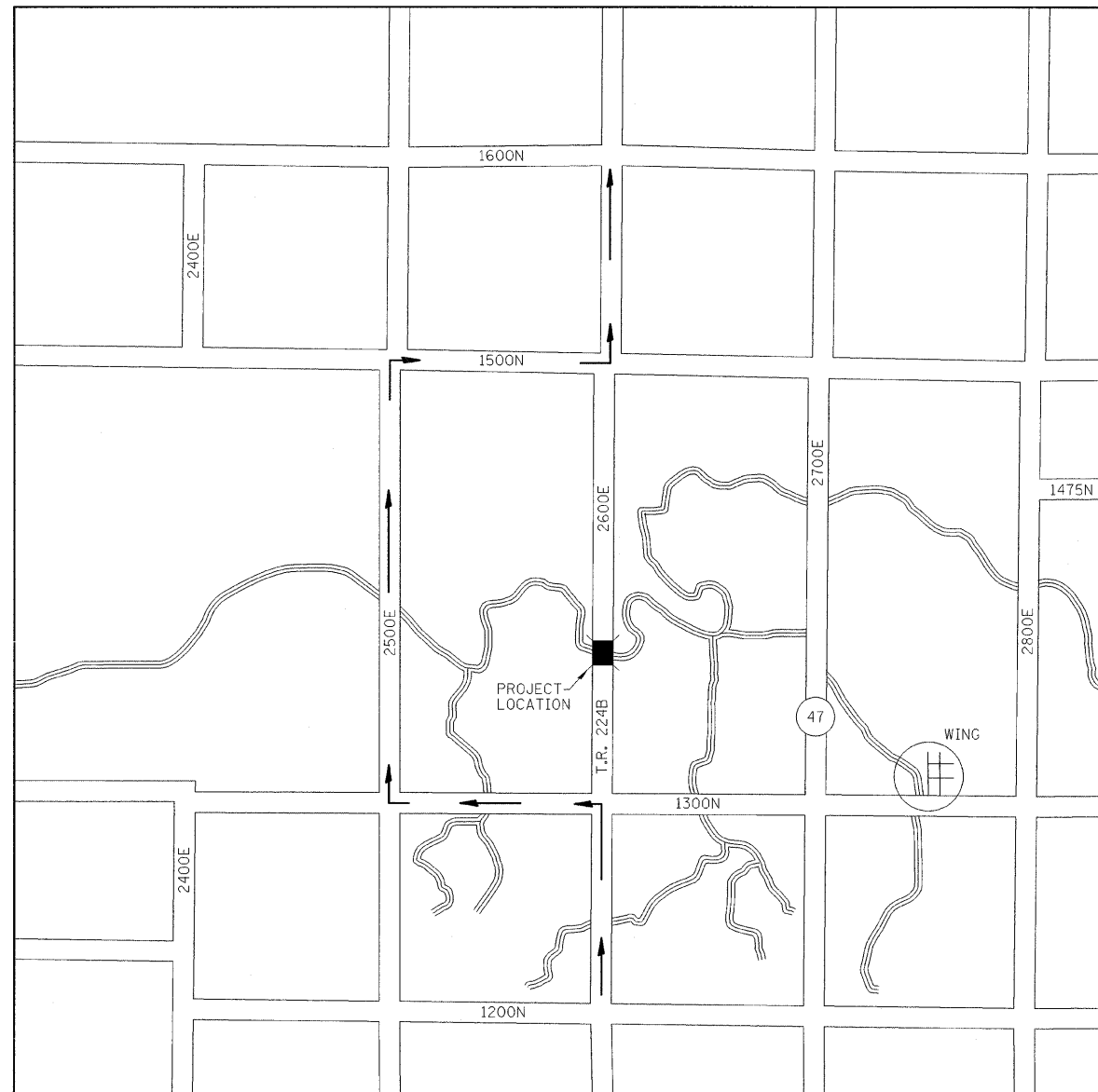

DETOUR MAP - NORTHBOUND

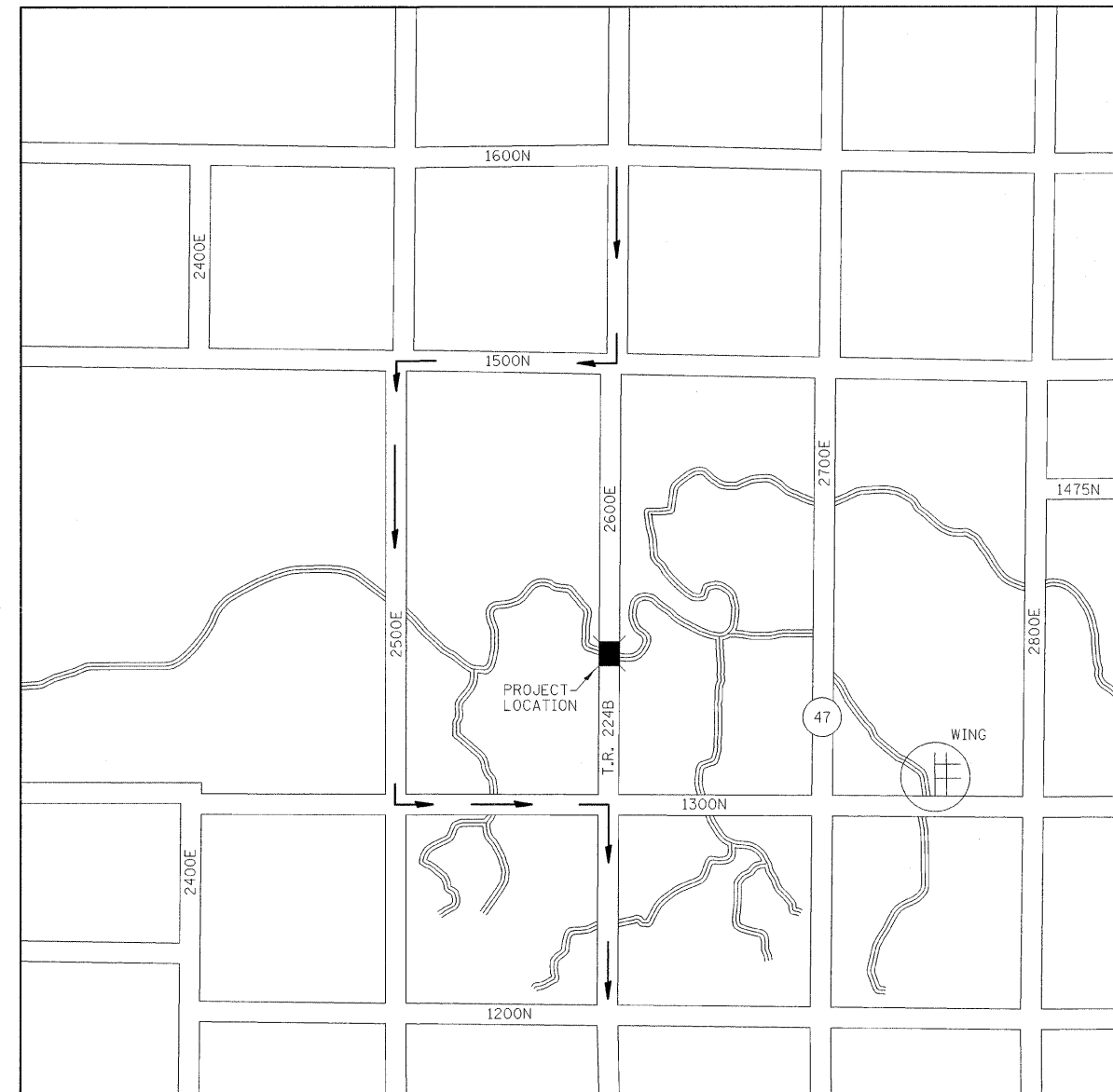

DETOUR MAP - SOUTHBOUND

NOTES:

- 1.) DETOUR SIGNS SHALL BE PLACED BY THE CONTRACTOR AS DIRECTED BY THE ENGINEER.
- 2.) CONTRACTOR TO CONTACT ALL EMERGENCY SERVICES AND MAIL ROUTES A MINIMUM OF 72 HOURS IN ADVANCE OF STARTING CONSTRUCTION.

SECTION 03-26140-00-BR
SECTION 03-21117-00-BR
LIVINGSTON COUNTY

DETOUR MAPS

DRAWN BY DRR	 2708 McGraw Drive Bloomington, Illinois 61704 309/888-6626 309/888-1871 fax	FILE NO. 24-7191
DATE 03/17/09		BOOK NO. 2606
CHECKED BY MSW		SHEET NO. 4 OF 28