

NE 1/4, SEC. 8, T27N, R7E, 3rd PM

F.A.S. RTE.	SECTION	COUNTY	TOTAL SHEETS	SHEET NO.
	03-26140-00-BR 03-21117-00-BR	LIVINGSTON	28	5
STA.	TO STA.			
FED. ROAD DIST. NO. 7	ILLINOIS FED. AID PROJECT*			
CONTRACT NO. 87360				

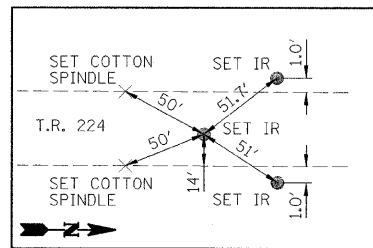
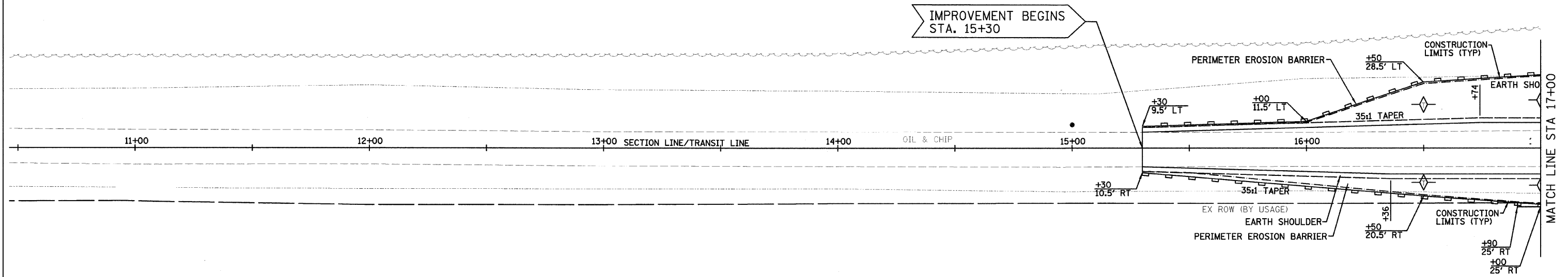

TIES TO IR
STA 9+00.12

NW 1/4, SEC. 9, T27N, R7E, 3rd PM

- BENCHMARKS:
- 1.) PK NAIL IN WOOD FENCE POST N. ONE OF TWO POST @ THE N.W. CORNER OF BRIDGE @ STA 21+30/30' LT, ELEVATION = 97.91
 - 2.) CENTER OF BRIDGE DECK @ STA 20+00, ELEVATION = 100.02

◇ = TEMPORARY DITCH CHECK

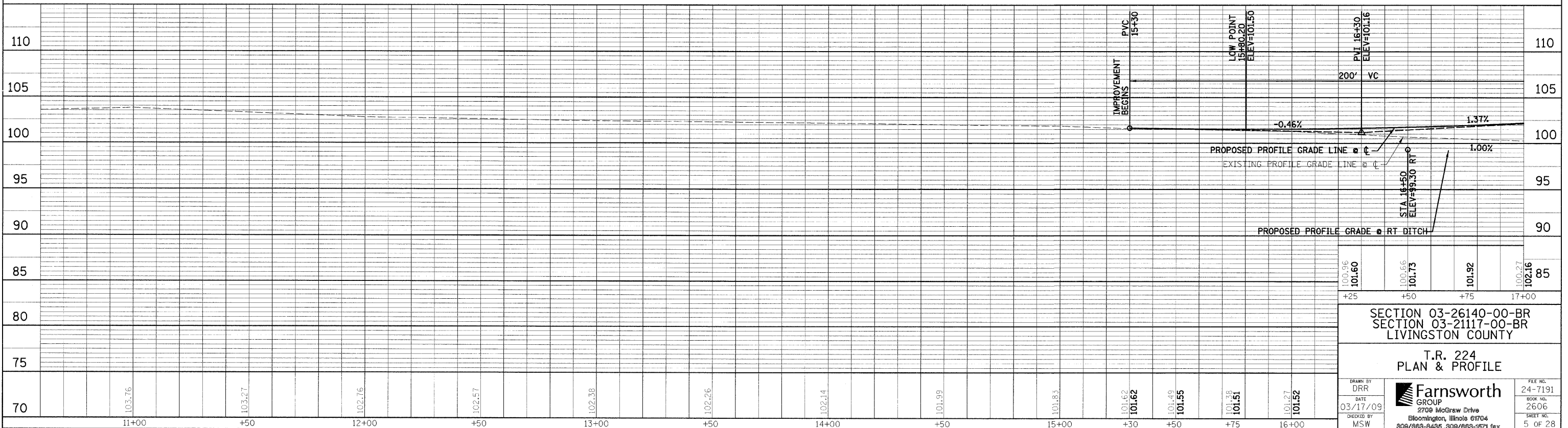
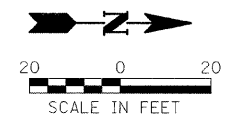

SECTION 03-26140-00-BR SECTION 03-21117-00-BR LIVINGSTON COUNTY	
T.R. 224 PLAN & PROFILE	
DRAWN BY DRR DATE 03/17/09 CHECKED BY MSW	FILE NO. 24-7191 BOOK NO. 2606 SHEET NO. 5 OF 28
Farnsworth GROUP 2709 McGraw Drive Bloomington, Illinois 61704 309/863-8435, 309/863-1671 fax	

FILE: c:\userp\dgn\papeng.dgn
 DATE: 8-Dec-96 12:10