

F.A.S. RTE.	SECTION	COUNTY	TOTAL SHEETS	SHEET NO.
	03-26140-00-BR 03-21117-00-BR	LIVINGSTON	28	7
STA.	TO STA.			
FED. ROAD DIST. NO. 7		ILLINOIS		FED. AID PROJECT*
CONTRACT NO. 87360				

NE 1/4, SEC. 8, T27N, R7E, 3rd PM

MARY V. HANLEY &
ROBERT DIEKEN TRUSTEES

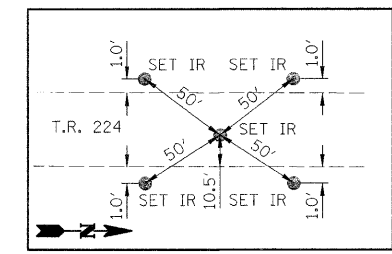
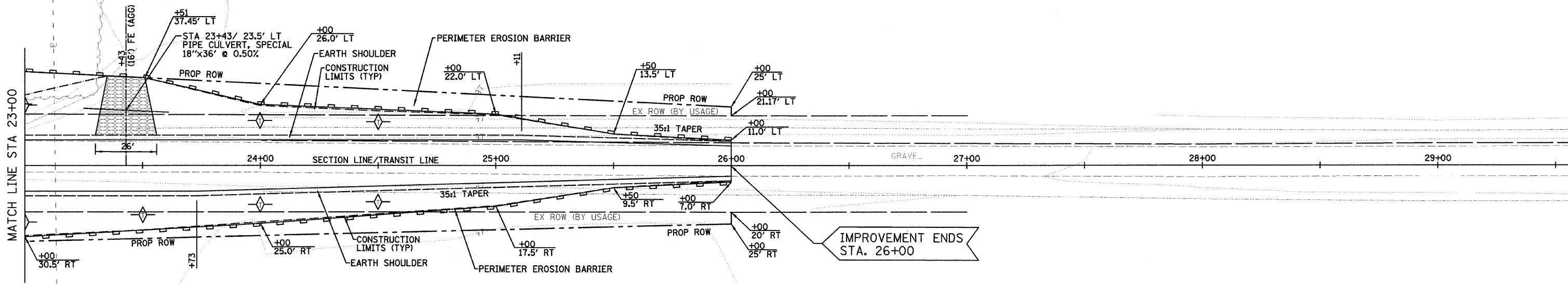

TIES TO IR
STA 30+00.00

◇ = TEMPORARY DITCH CHECK

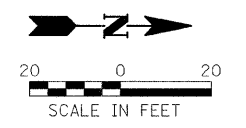

BENCHMARKS:

- 1.) PK NAIL IN WOOD FENCE POST N. ONE OF TWO POST @ THE N.W. CORNER OF BRIDGE @ STA 21+30/30' LT, ELEVATION = 97.91
- 2.) CENTER OF BRIDGE DECK @ STA 20+00, ELEVATION = 100.02

DOUGLAS W. DEININGER

NW 1/4, SEC. 9, T27N, R7E, 3rd PM

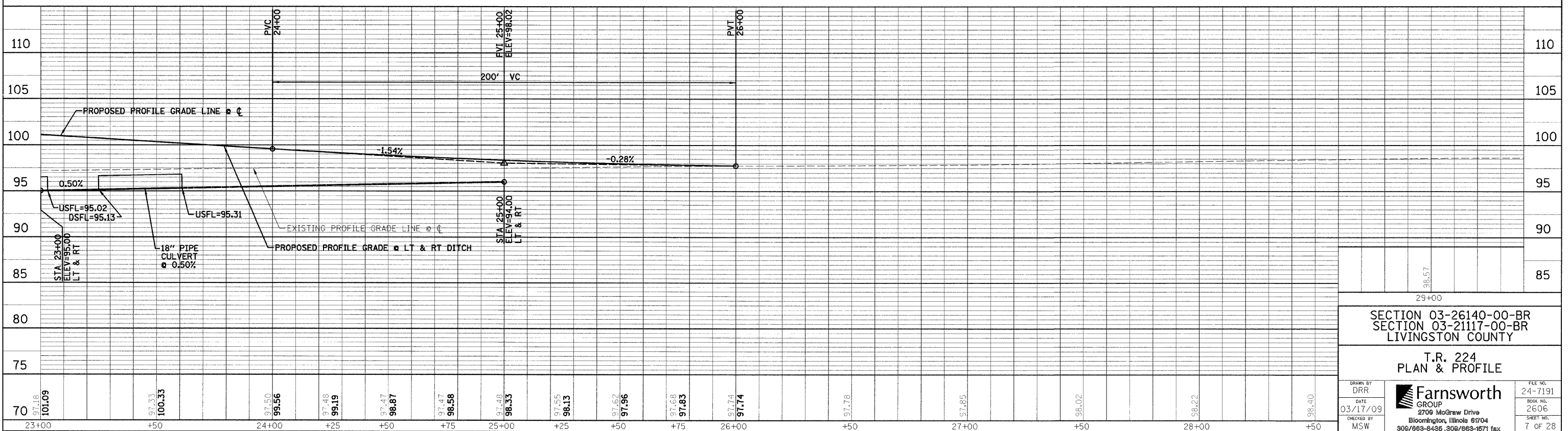

SECTION 03-26140-00-BR
SECTION 03-21117-00-BR
LIVINGSTON COUNTY

T.R. 224
PLAN & PROFILE

DRAWN BY DRR	<p>2706 McGraw Drive Bloomington, Illinois 61704 309/863-8436, 309/863-1671 fax</p>	FILE NO. 24-7191
DATE 03/17/09		BOOK NO. 2606
CHECKED BY MSW		SHEET NO. 7 OF 28

FILE: c:\userp\dgm\pdpeng.dgn
 DATE: 8-Dec-06 12:40