

**INDEX OF SHEETS**

- 1 COVER SHEET, STANDARDS, & SUMMARY OF QUANTITIES
- 2 TYPICAL CROSS-SECTIONS & STRIPING SCHEDULE

STATE OF ILLINOIS  
DEPARTMENT OF TRANSPORTATION  
LIVINGSTON COUNTY  
PLANS FOR  
PROPOSED LOCAL AGENCY IMPROVEMENT  
SURFACE TRANSPORTATION PROGRAM  
F.A.S. ROUTE 1362, CH 8, SECTION 06-00100-01-RS  
OCOYA ROAD  
PROJECT NO. RS-1362(114)  
JOB NO. C-93-034-09

ROUTE NO.	SECTION	COUNTY	TOTAL SHEETS	SHEET NO.
1362	06-00100-01-RS	LIVINGSTON	2	1

PROJECT NO. RS-1362(114)

SUMMARY OF QUANTITIES		CONST. CODE 1000	
ITEM NO.	ITEM	UNIT	QUANTITIES
* 40300100	BITUMINOUS MATERIALS (PRIME COAT)	GALLON	5,460.0
* 40300300	BITUMINOUS MATERIALS (COVER AND SEAL COATS)	GALLON	58,967.0
* 40300500	COVER COAT AGGREGATE	TON	1,309.0
* 40300600	SEAL COAT AGGREGATE	TON	683.0
67100100	MOBILIZATION	L SUM	1.0
* 70101800	TRAFFIC CONTROL AND PROTECTION, (SPECIAL)	L SUM	1.0
* 78001110	PAINT PAVEMENT MARKING - LINE 4"	FOOT	5,324.0
* LR355100	BITUMINOUS STABILIZED BASE COURSE	SQ YD	56,792.0
* LR355215	BITUMINOUS MATERIALS (BASE COURSE)	GALLON	227,168.0
* XX006047	PULVERIZATION	SQ YD	56,792.0
* Z0010800	COLD MILLING (LEVELING)	SQ YD	56,792.0

\* SEE SPECIAL PROVISIONS  
△ SPECIALTY ITEMS

**UTILITIES**

CONTACT J.U.L.I.E. 811 or 800-892-0123 BEFORE DIGGING

**STATE STANDARDS DETAILS**  
701306-02 701311-03 701901-01  
BLR 21-8 BLR 22-6 BLR 24-2

OCOYA ROAD - COLLECTOR  
POSTED SPEED = 55 MPH-RURAL  
DESIGN SPEED = 50 MPH-RURAL  
DESIGN ADT= 375/ YR 2024  
CLASS IV ROADS, 73,280# DESIGN  
15 YEAR D.P.

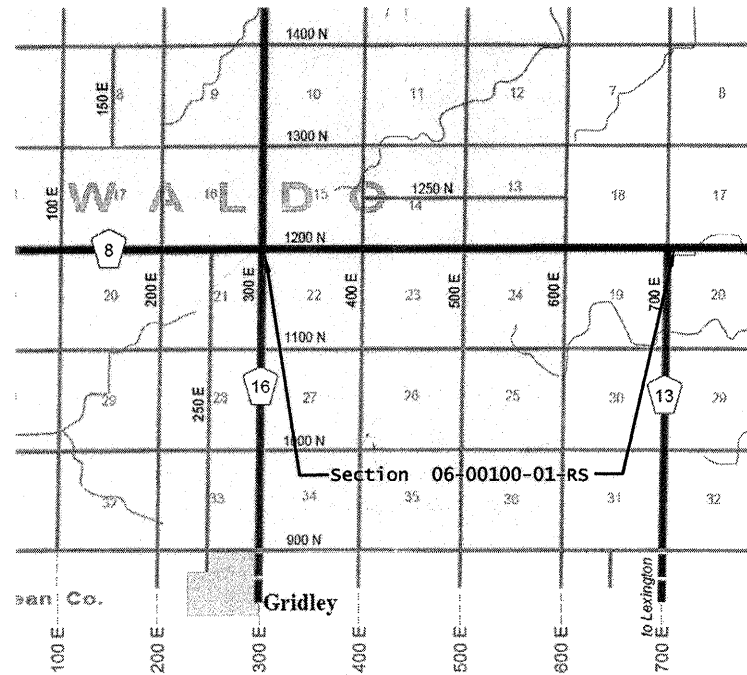

GROSS LENGTH = 21,297' = 4.03 MILES  
NET LENGTH = 21,297' = 4.03 MILES  
SCALE(MILES)

THIS PROJECT CONSISTS OF BITUMINOUS BASE STABILIZATION, 8" DEPTH, BITUMINOUS SURFACE TREATMENT CLASS "A", A-3 BEGINNING AT A POINT NEAR THE INTERSECTION OF COUNTY HIGHWAY 16 AND COUNTY HIGHWAY 8, NORTH OF GRIDLEY, ILLINOIS AND EXTENDING IN AN EASTERLY DIRECTION ALONG COUNTY HIGHWAY 8 TO THE INTERSECTION OF COUNTY HIGHWAY 13.

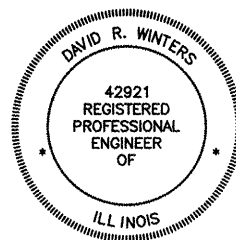

THESE PLANS WERE MADE BY ME OR BY A MEMBER OF MY STAFF WORKING UNDER MY PERSONAL SUPERVISION.  
DATE 03/25/09 COUNTY ENGINEER, P.E. NO. 42921 EXPIRATION DATE 11/30/2009

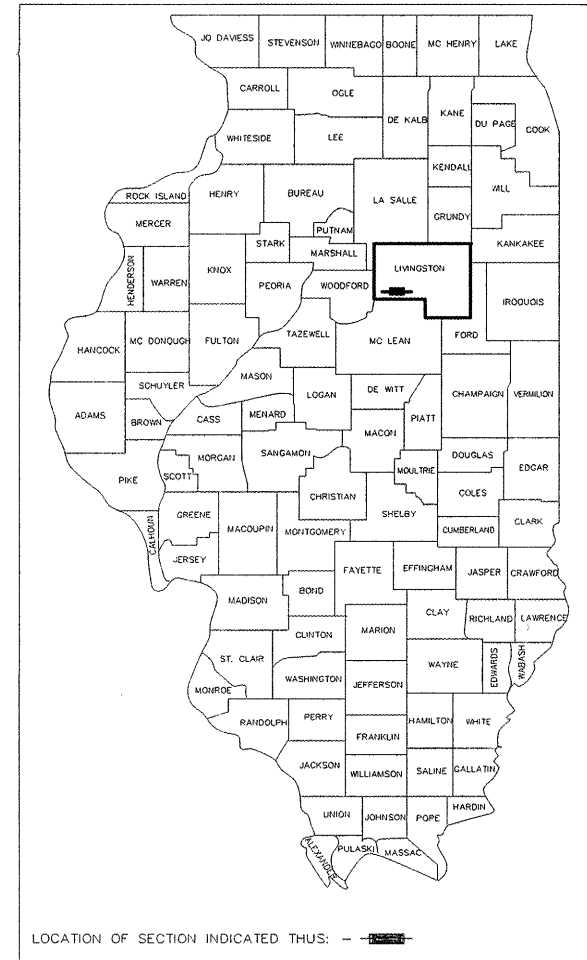

"THE ACCEPTANCE OF THIS PROJECT IS BASED ON THE MINIMUM DESIGN CRITERIA UNDER 3R GUIDELINES."

APPROVED 03/25 20 09  
*[Signature]*  
LIVINGSTON COUNTY OFFICIAL

PASSED MARCH 30 20 09  
*[Signature]*  
DISTRICT ENGINEER OF LOCAL ROADS & STREETS

APPROVED MARCH 30 20 09  
*[Signature]*  
DEPUTY DIRECTOR OF HIGHWAYS, REGIONAL ENGINEER

STATE OF ILLINOIS  
DEPARTMENT OF TRANSPORTATION

ROUTE NO.	SECTION	COUNTY	TOTAL SHEETS	SHEET NO.
1362	06-00100-01-RS	LIVINGSTON	2	2

PROJECT NO. RS-1362(114)

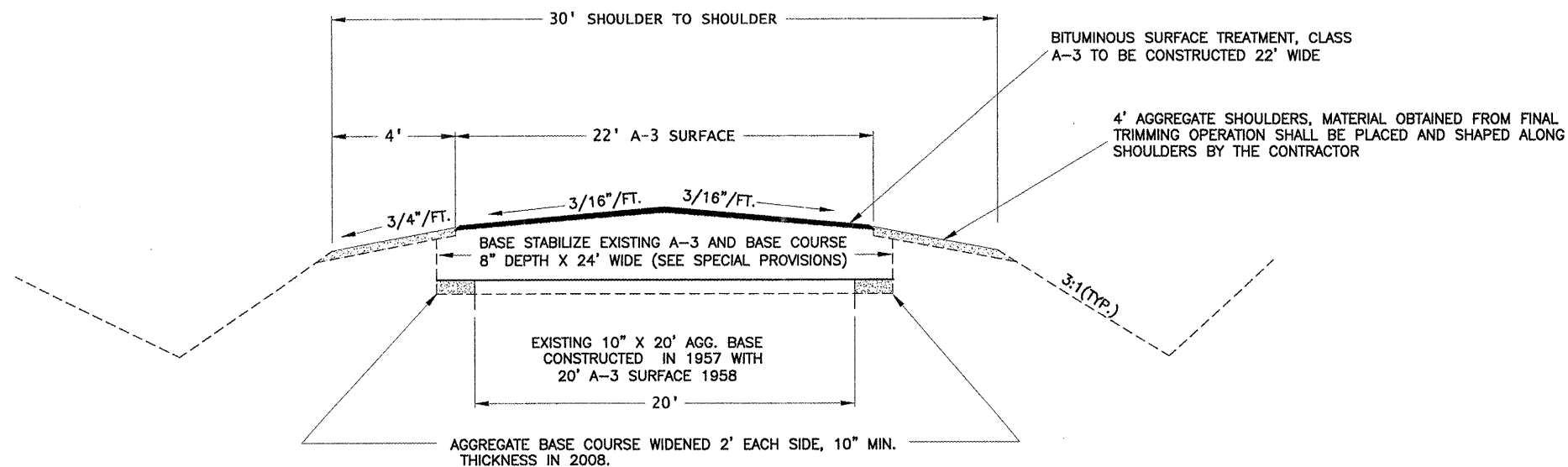

**TYPICAL CROSS SECTION**

Sta. 161+07 to 374+04(FAS RTE1362)

**SUMMARY OF BITUMINOUS A-3 QUANTITIES**

COUNTY HIGHWAY 8 - OCOYA ROAD

06-00100-01-RS

DATE REVISED: 2/27/2009

SCHEDULE OF PAINT PAVEMENT MARK 4"			
LOCATION STATION TO STATION	NO PASSING ZONE		SKIP DASH
	WBL	EBL	Ĉ
BEGIN CH 14			
161+07 to 374+04			5,324
END CH 14			
TOTALS	0	0	5,324
TOTAL PAY QUANTITY 5,324 FOOT			

LOCATION	LENGTH (Feet)	WIDTH (Feet)	AREA (Sq. Yds.)	BITUMINOUS OIL QUANTITIES			VOL. OIL (Gallons)	TYPE OF OIL	PRIME QUANTITIES				BASE PREP. (Sq. Yds.)	TONS CA-16	TONS CA-14
				APP. RATES (Gal./Sq.Yds.)		APP. RATE (Gal./Sq.Yds.)			VOL. OIL (Gallons)	APP. RATE (Gal./Sq.Yds.)	VOL. OIL (Gallons)				
				Cover Coat 5/8"	Seal Coat 3/8"							Width (Feet)			
SEALCOAT														25 #/SY	
							0								
A-3 SURFACE				First Cover 5/8"	Second Cover 5/8"	Seal Coat 3/8"								25 #/SY	24 #/SY
1 - Sta. 161+07 to 374+04	21297	22	52,059	0.35	0.38	0.35	56,224	MC-30/PG46-28	22	52,059	0.10	5,206	52,059	651	1249
2 - PE'S - 12 @ 30' x 20'	360	20	800	0.35	0.38	0.35	864	MC-30/PG46-28	20	800	0.10	80	800	10	19
3 - MBTO'S - 12 @ 36' x 2'	432	2	96	0.35	0.38	0.35	104	MC-30/PG46-28	2	96	0.10	10	96	1	2
4 - INTERSECTIONS - 8 @ 50' x 37'	400	37	1,644	0.35	0.38	0.35	1,776	MC-30/PG46-28	37	1,644	0.10	164	1,644	21	39
TOTALS							58,967	PG 46-28			MC-30	5,460	54,599	683	1,309
							GALLONS				GALLONS	SQ. YDS.	TONS	TONS	