

| | | | | |
|-----------------------|----------|-----------------|--------------|-----------|
| ROUTE NO. | SECTION | COUNTY | TOTAL SHEETS | SHEET NO. |
| CH 10 | * | IROQUOIS | 31 | 1 |
| FED. ROAD DIST. NO. 7 | ILLINOIS | PROJECT | BRS-329(105) | |
| *07-00216-01-BR | | CONTRACT #87401 | | |

**STATE OF ILLINOIS
DEPARTMENT OF TRANSPORTATION
PLANS FOR PROPOSED
HIGHWAY BRIDGE PROGRAM
IROQUOIS COUNTY**

**SECTION 07-00216-01-BR
F.A.S. 329 (CH 10) OVER FOUNTAIN CREEK TRIBUTARY
PROJECT NO. BRS-329(105)
JOB NUMBER C-93-111-09**

INDEX OF SHEETS

| SHEET NO. | DESCRIPTION |
|-----------|--|
| 1. | COVER SHEET |
| 2. | GENERAL NOTES, DETAILS, TYPICAL SECTIONS |
| 3. | SUMMARY OF QUANTITIES, SCHEDULES OF QUANTITIES |
| 4. | TRAFFIC CONTROL PLAN |
| 5. | STORMWATER POLLUTION PREVENTION PLAN |
| 6. | PLAN AND PROFILE |
| 7.-21. | STRUCTURE PLANS |
| 22.-31. | CROSS SECTIONS |

REQUIRED HIGHWAY STANDARDS

- 000001-05
- 280001-04
- 515001-03
- 542301-02
- 601101-01
- 602301-02
- 604036-02
- 630301-05
- 631032-04
- 635006-03
- 701901-01
- 780001-02
- BLR 21-8

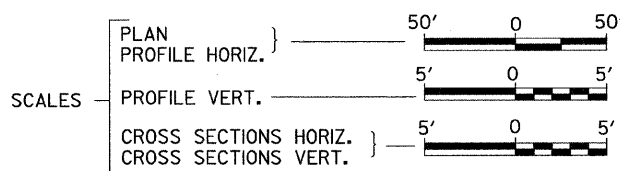
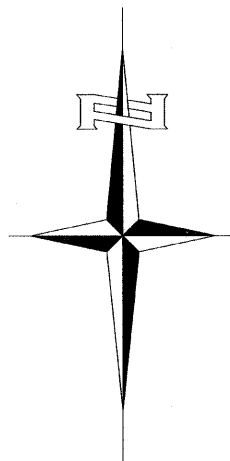

PROPOSED STRUCTURE NO. 038-4404
SINGLE SPAN CONCRETE DECK ON W30
STEEL I-BEAM SUPERSTRUCTURE ON
CONCRETE INTEGRAL ABUTMENTS,
71'-6" BK. TO BK. AND 30'-0" O. TO O.,
15° SKEW LT. AH.

SECTION 07-00216-01-BR
BEGINS
STATION 15+75.00

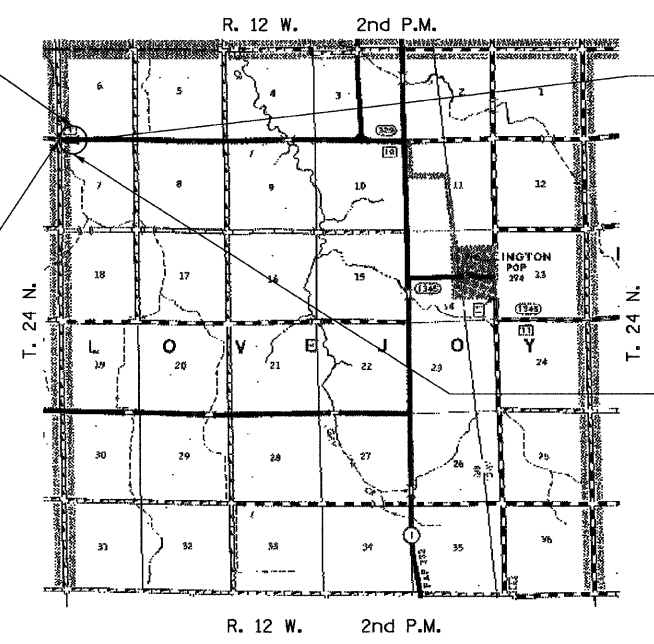

SECTION 07-00216-01-BR
ENDS
STATION 24+75.00

EXISTING STRUCTURE 038-0069
SINGLE SPAN REINFORCED CONCRETE
SLAB ON CONCRETE CLOSED ABUTMENTS
ON TIMBER PILE SUPPORTED CONCRETE FOOTINGS,
32'-6" BK. TO BK., AND 33'-6" O. TO O.,
NO SKEW (TO BE REMOVED)

R. 12 W. 2nd P.M.

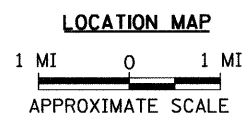

NET LENGTH OF PROJECT = 900.00 FEET = 0.170 MILES
DESIGN CLASSIFICATION: MAJOR-COLLECTOR (NON-URBAN)
DESIGN ADT = 600 (2029)
DESIGN SPEED = 50 MPH



UTILITY COMPANIES
VERIZON
BLOOMINGTON, ILLINOIS

EASTERN ILLINOIS ELECTRIC COOPERATIVE
PAXTON, ILLINOIS

CALL J.U.L.I.E.
BEFORE YOU DIG
1-800-892-0123 OR 811

CONTRACT NO. 87401

PLANS DESIGNED IN ACCORDANCE WITH BUREAU
OF LOCAL ROADS AND STREETS MANUAL GUIDELINES
FOR TWO LANE RURAL COLLECTORS - RECONSTRUCTION

APPROVED March 25, 2009
[Signature]
IROQUOIS COUNTY ENGINEER

PASSED March 30, 2009
[Signature]
DISTRICT THREE ENGINEER OF
LOCAL ROADS & STREETS

Released For
Bid Based on
Limited Review March 30, 2009

[Signature]
DEPUTY DIRECTOR OF HIGHWAYS,
REGION TWO ENGINEER
STATE OF ILLINOIS
DEPARTMENT OF TRANSPORTATION

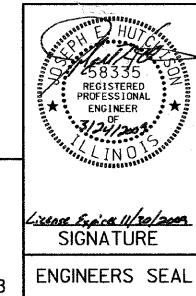

Hutchison Engineering, Inc.
JACKSONVILLE ILLINOIS
SHOREWOOD ILLINOIS
2009 JOB#2598

2598E001