

F.A.U. RTE.	SECTION	COUNTY	TOTAL SHEETS	SHEET NO.
	05-00333-00-BT	McLEAN	56	35

STA.	TO STA.
FED. ROAD DIST. NO.	ILLINOIS FED. AID PROJECT

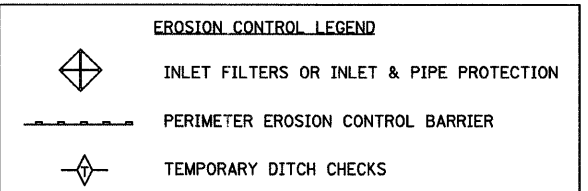

- INTENDED SEQUENCE
1. PLACE PERIMETER EROSION CONTROL BARRIER PRIOR TO THE COMMENCEMENT OF ANY WORK. SEE STANDARD 280001.
 2. PLACE INLET AND PIPE PROTECTION ON ALL INLETS OR PIPE CULVERTS REMAINING ON THE PROJECT.
 3. INSTALL TEMPORARY DITCH CHECKS IN EXISTING DITCHES.
 4. INSTALL WATERMAIN, SANITARY SEWER AND STORM SEWER.
 5. PLACE INLET AND PIPE PROTECTION ON ALL NEW INLETS OR PIPE CULVERTS.
 6. PERFORM EARTH EXCAVATION AND EMBANKMENT.
 7. PLACE TEMPORARY EROSION CONTROL SEEDING ON ALL BARE EARTH AREAS.
 8. PLACE PERMANENT EROSION CONTROL SEEDING AS SOON AS CONSTRUCTION PERMITS.

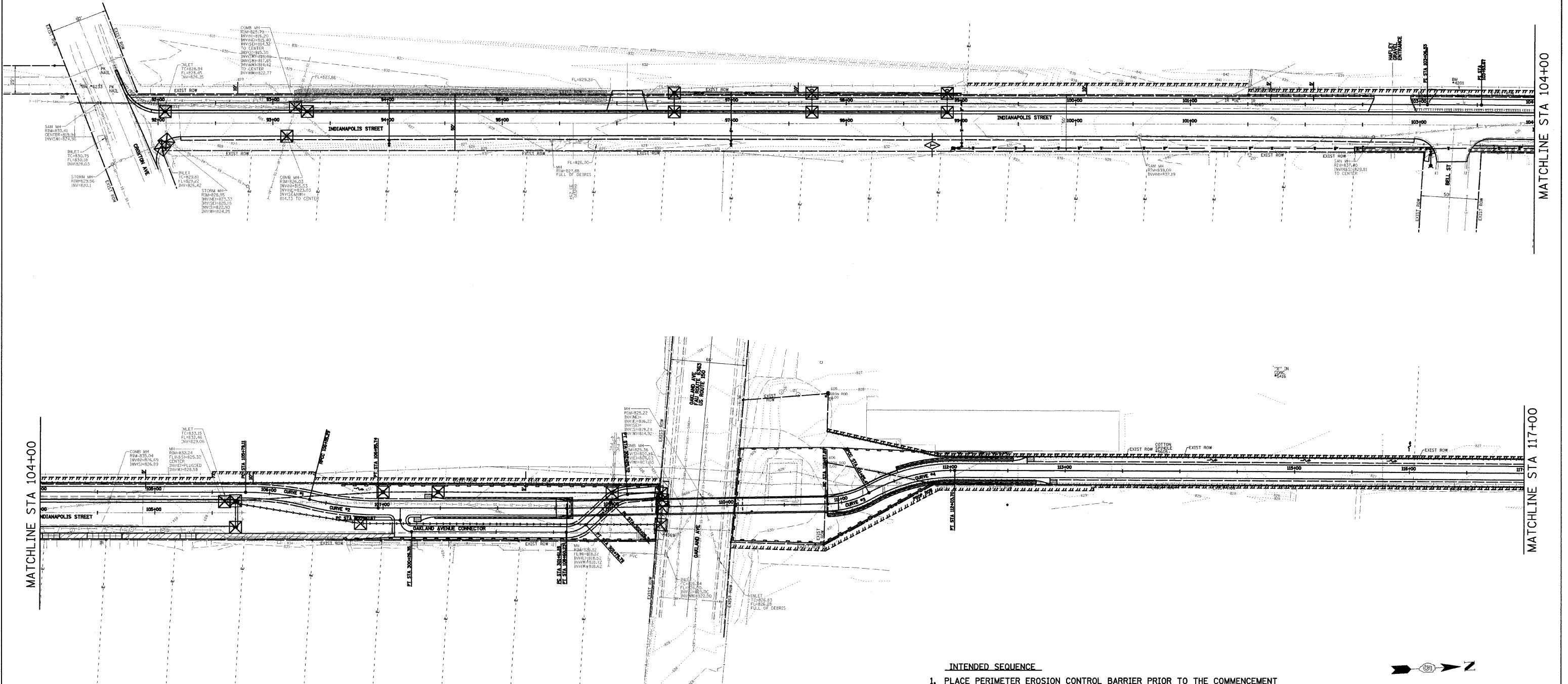
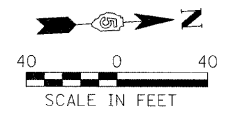

CITY OF BLOOMINGTON, ILLINOIS
MFT SECTION 05-00333-00-BT

EROSION CONTROL PLAN
"SWPPP"

DRAWN BY DRR	<p>Farnsworth GROUP 3700 McGraw Drive Bloomington, Illinois 61704 309/882-6436, 309/853-9871 fax</p>	FILE NO. 24-8173
DATE 01/30/09		BOOK NO. 2752
CHECKED BY PJM		SHEET NO. 35 OF 56

P:\City of Bloomington\2009\00333\05-00333-00-BT\05-00333-00-BT-01-30-09.dwg