

PROPOSED ϕ
FIRST STREET
CURVE DATA
P.I. STA. 103+75.02
 $\Delta = 8^\circ 49' 12''$
D = 178' 19"
T = 338.57'
R = 4390.00'
L = 675.79'
E = 13.04'
P.C. STA. 100+36.46
P.T. STA. 107+12.25
S.E. = SEE PROPOSED TYPICAL
SECTIONS AND INTERSECTION
DETAILS

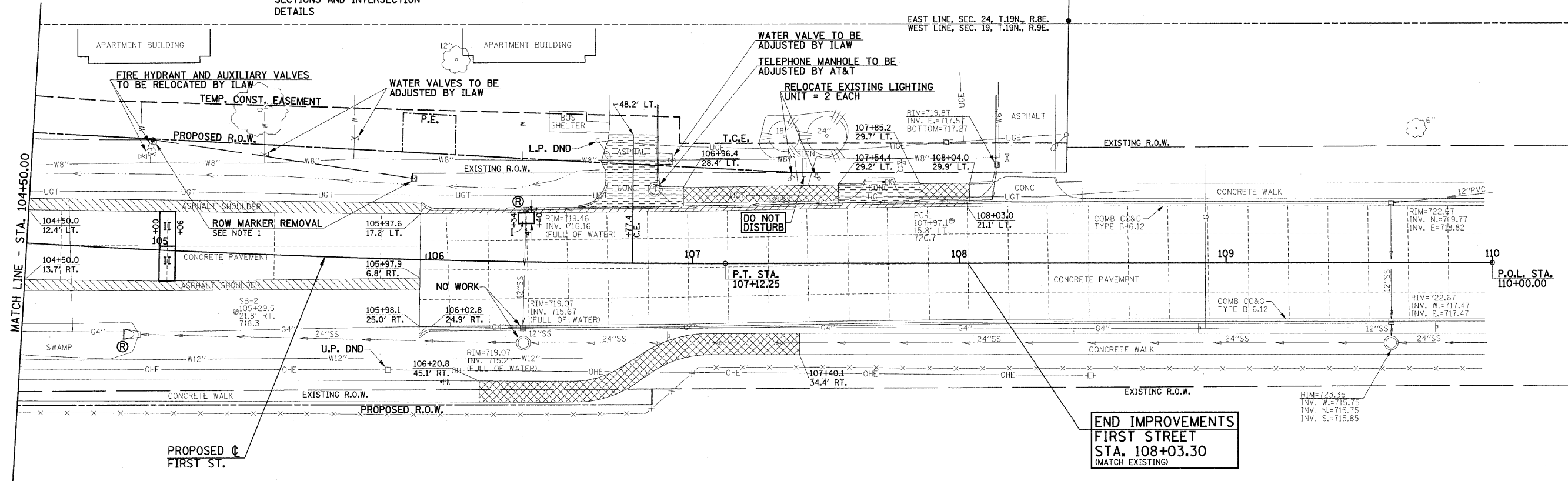

FOR PROPOSED CONSTRUCTION IN THIS AREA SEE PLAN AND PROFILE SHEET NO. 16

MAILBOXES SHALL BE RELOCATED AS DIRECTED BY THE ENGINEER IN ACCORDANCE WITH ARTICLE 107.20 OF THE STANDARD SPECIFICATIONS.

EXISTING PAVEMENTS, CURBS AND GUTTERS, AND SIDEWALKS IN WHICH THE TOP SURFACE IS TO BE JOINED TO THE PROPOSED WORK SHALL BE SO JOINED THROUGH SAW CUT JUNCTURES.

SEE THE DRAINAGE STRUCTURE AND PIPE SCHEDULES SHEET FOR STORM SEWER REMOVAL AND STRUCTURE REMOVAL AND ADJUSTMENT SCHEDULES.

SEE THE TRAFFIC SIGNAL PLANS FOR REQUIREMENTS FOR MAINTAINING AND REMOVING THE EXISTING TRAFFIC SIGNAL EQUIPMENT.

THE REMOVAL AND RELOCATION OF VARIOUS TRAFFIC SIGNS NOTED HEREON SHALL BE AS DIRECTED BY THE ENGINEER AND AS SPECIFIED IN THE STANDARD SPECIFICATIONS. THIS WORK SHALL NOT BE PAID FOR SEPARATELY AND IS CONSIDERED INCLUDED IN THE VARIOUS REMOVAL ITEMS.

PAVING REMOVAL SCHEDULE				
LOCATION	44000200 DRIVE PAVEMENT REM (SQ YD)	44000500 COMB CURB GUTTER REM (FOOT)	44000600 SIDEWALK REM (SQ FT)	44000920 BIT CONC SHLD REM (SQ YD)
106+77.4 LT.	73.7			
107+70.0 LT.	27.8			
105+97.6 LT. TO 108+03.0 LT.		205.7		
105+98.1 RT. TO 106+02.8 RT.		5.7		
106+20.8 RT. TO 107+40.1 RT.			988.2	
106+96.4 LT. TO 107+54.4 LT.			345.2	
107+85.2 LT. TO 108+04.0 LT.			111.2	
104+50.0 LT. TO 105+97.6 LT.				69.7
104+50.0 RT. TO 105+97.9 RT.				64.3
SHEET TOTAL	101.5	211.4	1444.6	134.0

NOTE: THE DRIVEWAY PAVEMENT REMOVAL SHALL INCLUDE ANY CURBS THAT HAVE BEEN CONSTRUCTED MONOLITHIC WITH THE PAVEMENT. THE COST OF REMOVING THE CURBS SHALL BE INCLUDED IN THE CONTRACT UNIT PRICE FOR DRIVEWAY PAVEMENT REMOVAL.

CLASS B PATCHES, 8"		
LOCATION	44200929 TYPE I (SQ YD)	44200934 TYPE II (SQ YD)
106+34.0 LT. TO 106+40.0 LT.	2.7	
105+00.0 LT. TO 105+06.0 LT.		8.6
105+00.0 RT. TO 105+06.0 RT.		8.6
SHEET TOTAL	2.7	17.2

- LEGEND**
- U.P. DND - UTILITY POLE DO NOT DISTURB
 - L.P. DND - LIGHT POLE DO NOT DISTURB
 - U.P. TBRBO - UTILITY POLE TO BE RELOCATED BY OTHERS
 - L.P. TBRBO - LIGHT POLE TO BE RELOCATED BY OTHERS
 - (A) - STRUCTURE TO BE ADJUSTED
 - (R) - STRUCTURE TO BE REMOVED
 - (M) - MAILBOX TO BE RELOCATED
 - OR (T) - TREE REMOVAL
 - (Hatched Box) - DRIVEWAY PAVEMENT REMOVAL
 - (Diagonal Lines) - COMBINATION CURB AND GUTTER REMOVAL
 - (Cross-hatched Box) - SIDEWALK REMOVAL
 - (Stippled Box) - BITUMINOUS CONCRETE SHOULDER REMOVAL
 - (Dashed Box) - CLASS B PATCHES, 8 INCH (TYPE SPECIFIED)
 - - PROPOSED SAWED JOINTS

NOTE 1
THE EXISTING RIGHT-OF-WAY MARKERS THAT INTERFERE WITH THE PROPOSED IMPROVEMENTS SHALL BE REMOVED AND DISPOSED OF BY THE CONTRACTOR AT THE LOCATIONS SHOWN ON THE PLANS. THE COST OF REMOVING AND DISPOSING OF THE MARKERS SHALL BE CONSIDERED AS INCLUDED IN THE COST OF THE EARTH EXCAVATION AND NO ADDITIONAL PAYMENT WILL BE ALLOWED.

FILE NAME =
p:\c0010461\plans\sheet\removals.dgn
PLOT DATE =
2/6/2009 11:05:48 AM

DESIGNED - R.L.H.
DRAWN - J.L.B.
CHECKED - J.T.P.
DATE - 2-09

REVISED -
REVISED -
REVISED -
REVISED -

STATE OF ILLINOIS
DEPARTMENT OF TRANSPORTATION

REMOVALS/RELOCATIONS PLAN

SCALE: 1"=20' SHEET NO. 14 OF 44 SHEETS STA. 104+50.00 TO STA. 110+00.00

F.A.U. RTE.	SECTION	COUNTY	TOTAL SHEETS	SHEET NO.
7170	08-00277-00-PV	CHAMPAIGN	44	14
CONTRACT NO. 91397				
FED. ROAD DIST. NO. ILLINOIS FED. AID PROJECT HD-5181 (044)				