

PROPOSED $\frac{1}{2}$
FIRST STREET
CURVE DATA
P.I. STA. 103+75.02
 $\Delta = 8^{\circ}49'12''$
D = 118'19"
T = 338.57'
R = 4390.00'
L = 675.79'
E = 13.04'
P.C. STA. 100+36.46
P.T. STA. 107+12.25
S.E. = SEE PROPOSED TYPICAL
SECTIONS AND INTERSECTION
DETAILS

THE FIRST STREET PAVEMENT CROSS SLOPE SHALL BE WARPED AS FOLLOWS:

TRANSITION FROM MATCH EXISTING AT LT. STA. 100+46.81 TO -3.0% AT
LT. STA. 101+03.55 TO -2.0% AT LT. STA. 102+50.00

THE PAVEMENT CROSS SLOPE SHALL BE -2.0% FROM LT. STA. 102+50.00 TO
LT. STA. 108+03.0

TRANSITION FROM MATCH EXISTING AT RT. STA. 100+39.27 TO -1.0% AT
RT. STA. 100+69.85 TO +1.5% AT RT. STA. 102+60.70

THE PAVEMENT CROSS SLOPE SHALL BE +1.5% FROM RT. STA. 102+60.70 TO
RT. STA. 104+78.00

TRANSITION FROM +1.5% AT RT. STA. 104+78.00 TO -1.3% AT RT. STA. 105+70.00
TO MATCH EXISTING AT RT. STA. 105+98.0

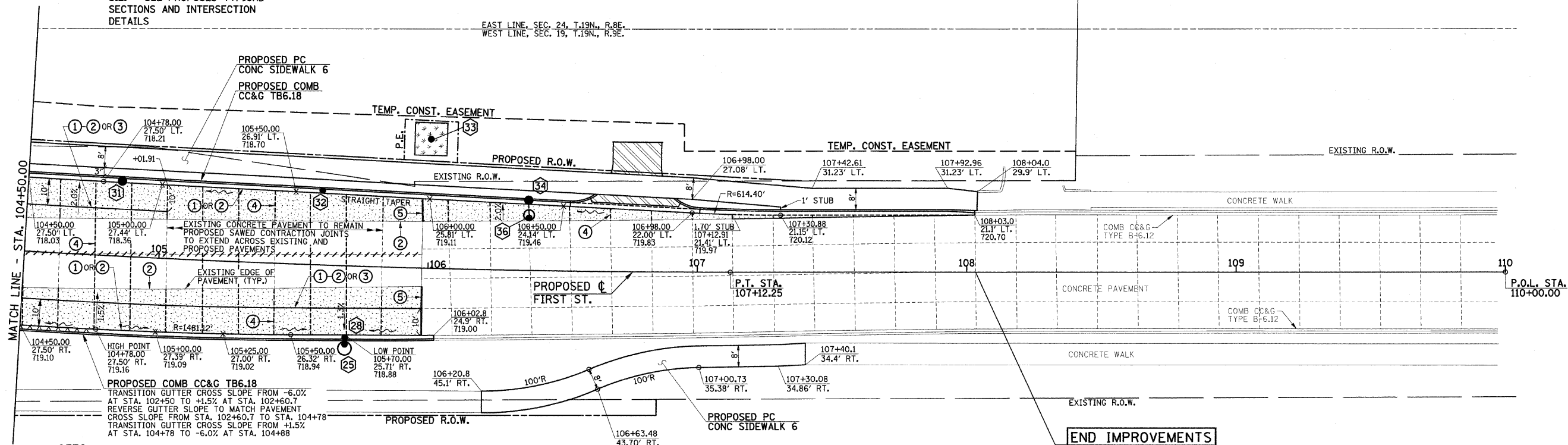
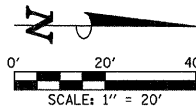

NOTES

1. THE CURB AND GUTTER SHALL NOT BE POURED MONOLITHIC WITH THE P.C. CONCRETE PAVEMENT EXCEPT AT THE STUB LOCATIONS SHOWN ON THE PLANS. TIE BARS BETWEEN THE PAVEMENT AND THE CURB AND GUTTER WILL BE REQUIRED, THE COST OF ADDITIONAL GUTTER FLAG WIDTH WILL BE PAID FOR AT THE CONTRACT UNIT PRICE PER SQUARE YARD FOR THE SPECIFIED TYPE OF P.C. CONCRETE PAVEMENT.
2. SAWED TRANSVERSE CONTRACTION JOINTS SHALL BE PLACED AT 15 FOOT CENTERS MAXIMUM IN THE P.C. CONCRETE PAVEMENT OR AS DIRECTED BY THE ENGINEER (STD. 420001). ALL DOWEL BARS 18" LONG AT 12" CENTERS SHALL BE CENTERED ACROSS THE CONTRACTION JOINTS. THE DOWEL BARS SHALL BE 1" DIAMETER FOR THE 8" THICK PAVEMENTS.
3. TRANSVERSE CONSTRUCTION JOINTS SHALL MATCH THE LOCATION OF THE SAWED TRANSVERSE CONTRACTION JOINTS OR EXPANSION JOINTS SHOWN ON THE PAVEMENT JOINTING PLANS AND SHALL BE AS SHOWN ON STANDARD 420101. TRANSVERSE CONSTRUCTION JOINTS SHALL NOT BE PLACED LESS THAN 15 FEET FROM A TRANSVERSE CONSTRUCTION OR EXPANSION JOINT. THE CONSTRUCTION JOINTS THAT COINCIDE WITH CONTRACTION JOINTS SHALL HAVE SMOOTH EPOXY COATED DOWEL BARS 1" DIAMETER, 18" LONG PLACED AT 12" SPACING'S AND CENTERED ACROSS THE JOINT. CONSTRUCTION JOINTS THAT COINCIDE WITH EXPANSION JOINTS SHALL BE DOWELED AS SHOWN ON STANDARD 420001.
4. TRANSVERSE CONSTRUCTION JOINTS SHALL BE CONSTRUCTED IN ACCORDANCE WITH THE APPLICABLE PORTIONS OF SECTION 420 OF THE STANDARD SPECIFICATIONS. THE COST OF FURNISHING AND INSTALLING THE TRANSVERSE CONSTRUCTION JOINTS, INCLUDING DRILLING AND GROUTING, WILL NOT BE PAID FOR SEPARATELY BUT SHALL BE CONSIDERED INCLUDED IN THE COST OF THE VARIOUS CURB AND GUTTER AND/OR PAVEMENT PAY ITEMS AND NO ADDITIONAL COMPENSATION WILL BE ALLOWED.
5. TRANSVERSE EXPANSION JOINTS SHALL BE CONSTRUCTED IN ACCORDANCE WITH STANDARD 420001 EXCEPT THAT THE WIDTH OF THE EXPANSION JOINTS SHALL BE 1" MAXIMUM AND THE DOWEL BARS SHALL BE 1" DIAMETER.
6. WHEN LONGITUDINAL CONSTRUCTION JOINTS ARE CONSTRUCTED IN THE PAVEMENT, THE JOINTS SHALL BE TIED WITH NO. 6 EPOXY COATED TIE BARS SPACED AT 24" CENTERS AS SHOWN ON STANDARD 420001. SEE THE PROPOSED TYPICAL SECTION KEY. WHERE THE PAVEMENT WIDTH IS 60 FEET OR GREATER ONE OF THE LONGITUDINAL JOINTS SHALL BE CONSTRUCTED WITH NO. 6 EPOXY COATED SMOOTH DOWEL BARS 24" LONG AT 24" CENTERS TO PREVENT LONGITUDINAL CRACKING. SEE THE PAVEMENT JOINTING PLANS FOR ADDITIONAL INFORMATION.
7. ALL SAWED JOINTS IN BOTH THE EXISTING AND PROPOSED P.C. CONCRETE PAVEMENTS AND THE COMBINATION CONCRETE CURB AND GUTTER SHALL BE SEALED WITH A JOINT SEALER MEETING THE REQUIREMENTS OF ARTICLES 420.02 AND 606.02 OF THE STANDARD SPECIFICATIONS.
8. SAWED CONTRACTION JOINTS 2" DEEP SHALL BE PLACED AT 15 FOOT MAXIMUM CENTERS IN THE COMBINATION CONCRETE CURB AND GUTTER, TYPE B-6.18 AND THE JOINTS SHALL BE SEALED. THIS WORK SHALL BE IN ACCORDANCE WITH ARTICLE 606.07 OF THE STANDARD SPECIFICATIONS.
9. THE SIDEWALK RAMPS SHALL BE PAID FOR AT THE CONTRACT UNIT PRICE FOR PORTLAND CEMENT CONCRETE SIDEWALK 6 INCH AND DETECTABLE WARNINGS.
10. SEE STANDARD 420111 FOR CONSTRUCTION DETAILS WHERE INLETS OR MANHOLES ARE LOCATED WITHIN THE PAVEMENT AREA.
11. ALL ELEVATIONS REFERRED TO ARE TO THE TOP OF FINISHED CONSTRUCTION.
12. SEE THE DRAINAGE STRUCTURE AND PIPE SCHEDULES SHEET FOR HORIZONTAL LOCATIONS AND VERTICAL ELEVATIONS OF DRAINAGE STRUCTURES.
13. SEE THE TRAFFIC SIGNAL PLANS FOR INFORMATION ON ADJUSTING THE ELECTRIC HANDHOLES AND FOR MAINTAINING AND REMOVING THE EXISTING TRAFFIC SIGNAL EQUIPMENT.
14. ALL STREET RADII ARE DIMENSIONED TO THE EDGE OF PAVEMENT.

PAVEMENT JOINT KEY

- 1 LONGITUDINAL CONSTRUCTION JOINT WITH NO. 6 x 30" EPOXY COATED TIE BARS AT 24" CENTERS FORMED IN PLACE (STD. 420001)
- 2 LONGITUDINAL CONSTRUCTION JOINT WITH NO. 6 x 24" EPOXY COATED TIE BARS AT 24" CENTERS DRILLED AND GROUTED IN PLACE (STD. 420001) (PREFORMED HOLES WITH GROUTED TIE BARS WILL NOT BE ALLOWED)
- 3 SAWED LONGITUDINAL JOINT WITH NO. 6 x 30" EPOXY COATED TIE BARS AT 30" CENTERS (STD. 420001)
- 4 SAWED TRANSVERSE CONTRACTION JOINT WITH 1" DIA. x 18" EPOXY COATED DOWEL BARS AT 12" CENTERS (STD. 420001)
- 5 1" EXPANSION JOINT WITH 1" DIA. x 18" EPOXY COATED DOWEL BARS AT 12" CENTERS (STD. 420001) (NOTE : EXPANSION JOINT WIDTH MODIFIED FROM STD. 420001)

LEGEND

-
-
-
-
-
-
-
-
-
-
-
-

FILE NAME =
p:\c0010461\plans\sheet\intdetails.dgn
PLOT DATE =
2/6/2009 11:05:57 AM

DESIGNED - R.L.H.	REVISED -
DRAWN - J.L.B.	REVISED -
CHECKED - J.T.P.	REVISED -
DATE - 2-09	REVISED -

STATE OF ILLINOIS
DEPARTMENT OF TRANSPORTATION

INTERSECTION DETAILS AND PAVEMENT JOINT PLANS

SCALE : 1"=20' SHEET NO. 24 OF 44 SHEETS STA. 104+50.00 TO STA. 110+00.00

F.A.I. RTE.	SECTION	COUNTY	TOTAL SHEETS	SHEET NO.
7170	08-00277-00-PV	CHAMPAIGN	44	24
CONTRACT NO. 91397				
FED. ROAD DIST. NO. ILLINOIS FED. AID PROJECT HD-5181 (044)				