

COORDINATE DATA: CENTERLINE CONSTRUCTION

P. O. T.	STA. 109+95.70	NORTH	1,221,978.85
		EAST	2,499,476.93
P. I.	STA. 162+74.58	NORTH	1,221,904.86
		EAST	2,504,755.29

COORDINATE DATA: CENTERLINE SURVEY

P. O. T.	STA. 109+95.70	NORTH	1,221,978.85
		EAST	2,499,476.93
P. I.	STA. 162+74.58	NORTH	1,221,904.86
		EAST	2,504,755.29

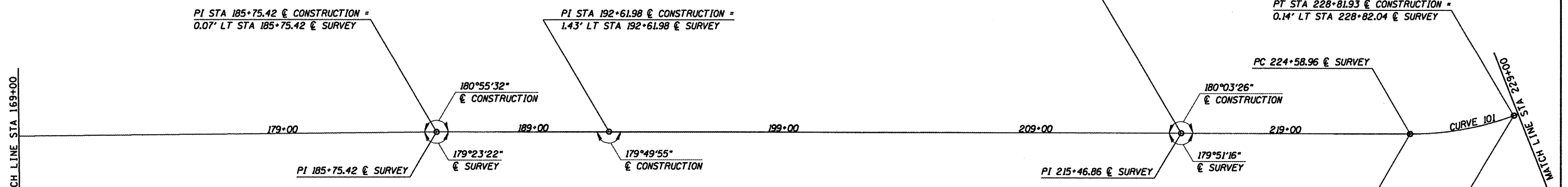
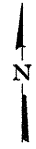

COORDINATE DATA: CENTERLINE CONSTRUCTION

P. I.	STA. 185+75.42	NORTH	1,221,929.21
		EAST	2,507,056.00
P. I.	STA. 192+61.98	NORTH	1,221,930.68
		EAST	2,507,742.55
P. I.	STA. 215+46.86	NORTH	1,221,928.86
		EAST	2,510,027.44
P. C.	STA. 224+60.71	NORTH	1,221,927.22
		EAST	2,510,941.28
P. I.	STA. 226+73.73	NORTH	1,221,926.84
		EAST	2,511,154.30
P. T.	STA. 228+81.93	NORTH	1,222,003.07
		EAST	2,511,353.21

COORDINATE DATA: CENTERLINE SURVEY

P. I.	STA. 185+75.42	NORTH	1,221,929.28
		EAST	2,507,056.00
P. I.	STA. 215+46.86	NORTH	1,221,929.15
		EAST	2,510,027.44
P. C.	STA. 224+58.96	NORTH	1,221,926.79
		EAST	2,510,939.54
P. I.	STA. 226+73.84	NORTH	1,221,926.24
		EAST	2,511,154.41
P. T.	STA. 228+83.78	NORTH	1,222,003.57
		EAST	2,511,354.89

@ SURVEY	@ CONSTRUCTION
CURVE 101	CURVE 101
Δ 21°14'28"	Δ 21°04'20"
D 5°00'00"	D 5°00'09"
T 214.88	T 213.02
R 1145.92	R 1145.32
L 424.82	L 421.23
C 422.39	C 418.86
E 19.97	E 19.64
PC 224+58.96	PC 224+60.71
PI 226+73.84	PI 226+73.73
PT 228+83.78	PT 228+81.93

SE 8.0%
 ATTAIN SE STA 228+94.21 TO STA 225+16.21
 REMOVE SE STA 228+26.43 TO STA 230+48.43

CUMMINS
 ENGINEERING
 CORPORATION

JOB = 2217	DESIGNED - NAK	REVISED -
FILE NAME = 2217align.dgn	DRAWN - AJH	REVISED -
PLOT SCALE = 100.000' / IN.	CHECKED - NAK	REVISED -
PLOT DATE = 1/28/2009	DATE - 11/03/2008	REVISED -

LOGAN COUNTY
 CH 10, TR 199A, TR 92 IMPROVEMENTS

ALIGNMENT

STA. 109+00 TO STA. 229+00

F.A.S. RTE.	SECTION	COUNTY	TOTAL SHEETS	SHEET NO.
566	05-00113-00-WR	LOGAN	63	16
CH 10, TR 199A, TR 92		CONTRACT NO.		
FED. ROAD DIST. NO.		ILLINOIS FED. AID PROJECT		

93482