

COORDINATE DATA: CENTERLINE CONSTRUCTION

| | | | |
|-------|----------------|-------|--------------|
| P. I. | STA. 480+20.31 | NORTH | 1,221,987.74 |
| | | EAST | 2,536,302.65 |
| P. I. | STA. 493+39.87 | NORTH | 1,221,984.06 |
| | | EAST | 2,537,622.20 |

COORDINATE DATA: CENTERLINE CONSTRUCTION

| | | | |
|-------|----------------|-------|--------------|
| P. I. | STA. 480+20.38 | NORTH | 1,221,987.60 |
| | | EAST | 2,536,302.65 |

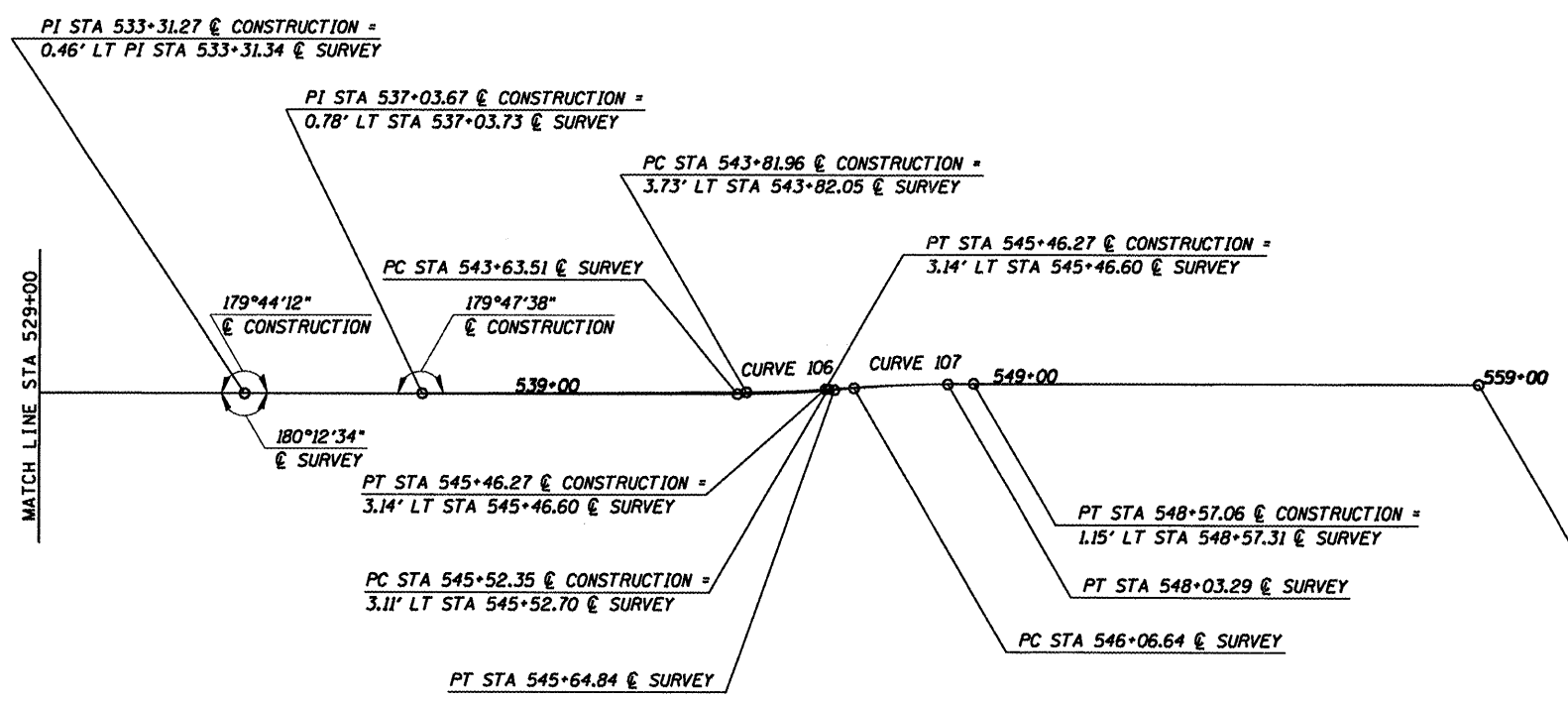
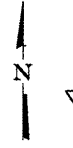

COORDINATE DATA: CENTERLINE CONSTRUCTION

| | | | |
|----------|----------------|-------|--------------|
| P. I. | STA. 533+31.27 | NORTH | 1,221,970.89 |
| | | EAST | 2,541,613.58 |
| P. I. | STA. 537+03.67 | NORTH | 1,221,971.37 |
| | | EAST | 2,541,985.97 |
| P. C. | STA. 543+81.96 | NORTH | 1,221,974.69 |
| | | EAST | 2,542,664.26 |
| P. I. | STA. 544+64.15 | NORTH | 1,221,975.09 |
| | | EAST | 2,542,746.45 |
| P. T. | STA. 545+46.27 | NORTH | 1,221,981.39 |
| | | EAST | 2,542,828.40 |
| P. C. | STA. 545+52.35 | NORTH | 1,221,981.85 |
| | | EAST | 2,542,834.46 |
| P. I. | STA. 547+04.78 | NORTH | 1,221,993.53 |
| | | EAST | 2,542,986.44 |
| P. T. | STA. 548+03.29 | NORTH | 1,221,993.60 |
| | | EAST | 2,543,138.86 |
| P. O. T. | STA. 559+13.03 | NORTH | 1,221,994.12 |
| | | EAST | 2,544,194.84 |

COORDINATE DATA: CENTERLINE SURVEY

| | | | |
|----------|----------------|-------|--------------|
| P. I. | STA. 533+31.34 | NORTH | 1,221,970.43 |
| | | EAST | 2,541,613.58 |
| P. C. | STA. 543+63.51 | NORTH | 1,221,970.87 |
| | | EAST | 2,542,645.75 |
| P. I. | STA. 544+64.24 | NORTH | 1,221,970.92 |
| | | EAST | 2,542,746.48 |
| P. T. | STA. 545+64.84 | NORTH | 1,221,979.80 |
| | | EAST | 2,542,846.82 |
| P. C. | STA. 546+06.64 | NORTH | 1,221,983.48 |
| | | EAST | 2,542,888.45 |
| P. I. | STA. 547+05.02 | NORTH | 1,221,992.15 |
| | | EAST | 2,542,986.45 |
| P. T. | STA. 548+03.29 | NORTH | 1,221,992.35 |
| | | EAST | 2,543,084.84 |
| P. O. T. | STA. 559+13.28 | NORTH | 1,221,994.55 |
| | | EAST | 2,544,194.83 |

| | @ SURVEY | @ SURVEY | @ CONSTRUCTION | @ CONSTRUCTION |
|----|-----------|--------------|----------------|----------------|
| | CURVE 106 | CURVE 107 | CURVE 106 | CURVE 107 |
| I | 5°01'59" | 4°56'39" | Δ 4°06'45" | Δ 4°21'52" |
| D | 2°30'00" | 2°30'51" | D 2°30'11" | D 1°25'57" |
| T | 100.73 | 98.39 | T 82.19 | T 152.43 |
| R | 2291.80 | R 2278.92 | R 2289.14 | R 4000.00 |
| L | 201.33 | L 196.65 | L 164.31 | L 304.70 |
| C | 201.27 | C 196.59 | C 164.28 | C 304.63 |
| E | 2.21 | E 2.12 | E 1.48 | E 2.90 |
| PC | 543+63.51 | PC 546+06.64 | PC 543+81.96 | PC 545+52.35 |
| PI | 544+64.24 | PI 547+05.02 | PI 544+64.15 | PI 547+04.78 |
| PT | 545+64.84 | PT 548+03.29 | PT 545+46.27 | PT 548+57.06 |
| | | | NORMAL CROWN | NORMAL CROWN |

CUMMINS
ENGINEERING
CORPORATION

| | | |
|-------------------------------|-------------------|-----------|
| JOB = 2217 | DESIGNED - NAK | REVISED - |
| FILE NAME = 2217align.dgn | DRAWN - AJH | REVISED - |
| PLOT SCALE = 1/200.003 1/ IN. | CHECKED - NAK | REVISED - |
| PLOT DATE = 1/20/2009 | DATE - 11/03/2008 | REVISED - |

LOGAN COUNTY
CH 10, TR 199A, TR 92 IMPROVEMENTS

| | |
|----------------------------|--|
| ALIGNMENT | |
| STA. 469+00 TO STA. 559+00 | |

| | | | | |
|-----------------------|----------------|--------|---------------------------|-----------|
| F.A.S. RTE. | SECTION | COUNTY | TOTAL SHEETS | SHEET NO. |
| 566 | 05-00113-00-WR | LOGAN | 63 | 19 |
| CH 10, TR 199A, TR 92 | | | CONTRACT NO. | |
| FED. ROAD DIST. NO. | | | ILLINOIS FED. AID PROJECT | |

93482