

PLAN	SURVEYED	BY	DATE
	PLOTTED		
	CHECKED		
	AT 1/2" = 1' CHECKED		
	NO. _____		
	PAID FILE NAME		

PROFILE	SURVEYED	BY	DATE
	PLOTTED		
	CHECKED		
	AT 1/2" = 1' CHECKED		
	NO. _____		
	STRUCTURE NOTATIONS CRD		

BEGIN NEW SIDEWALK STA. 99+99.3 AT END OF EXISTING SIDEWALK. THE WIDTH AND FISHED ELEVATION SHALL MATCH EXISTING AT THIS POINT.

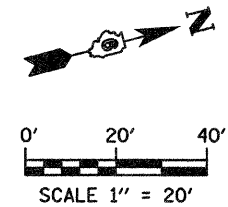
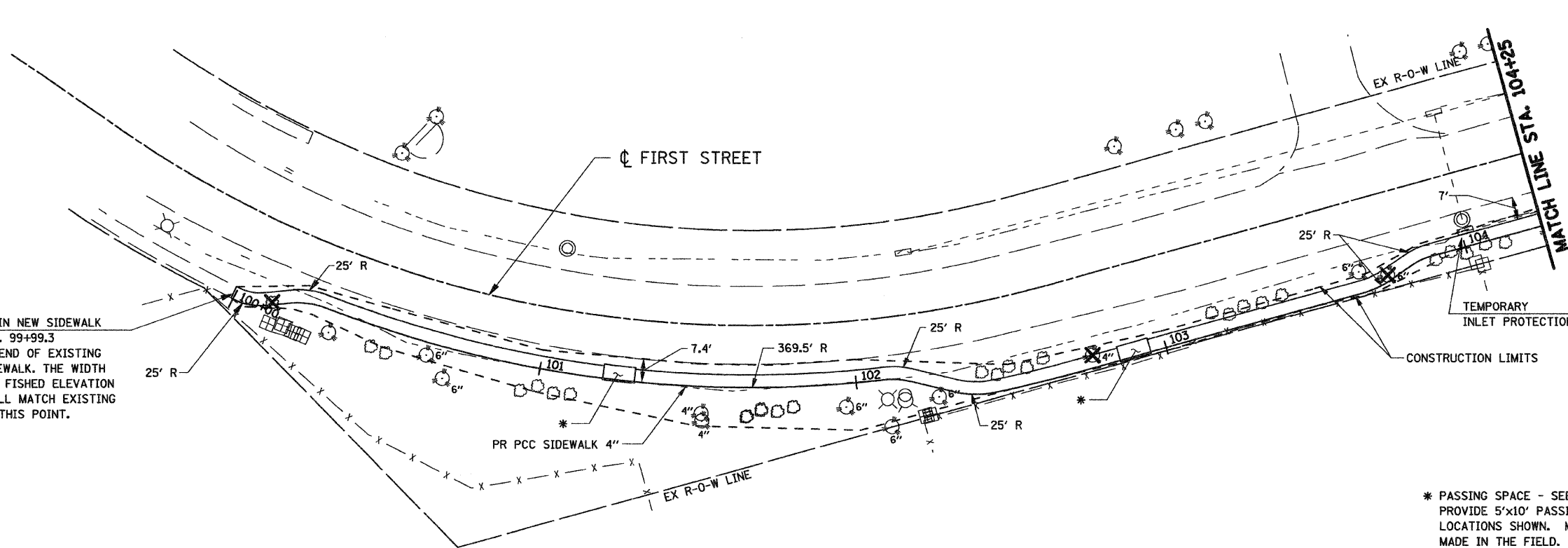

* PASSING SPACE - SEE SIDEWALK TYPICAL SECTIONS. PROVIDE 5'x10' PASSING SPACE AT APPROXIMATE LOCATIONS SHOWN. MINOR ADJUSTMENTS MAY BE MADE IN THE FIELD. 200' MAX. BETWEEN PASSING SPACES.

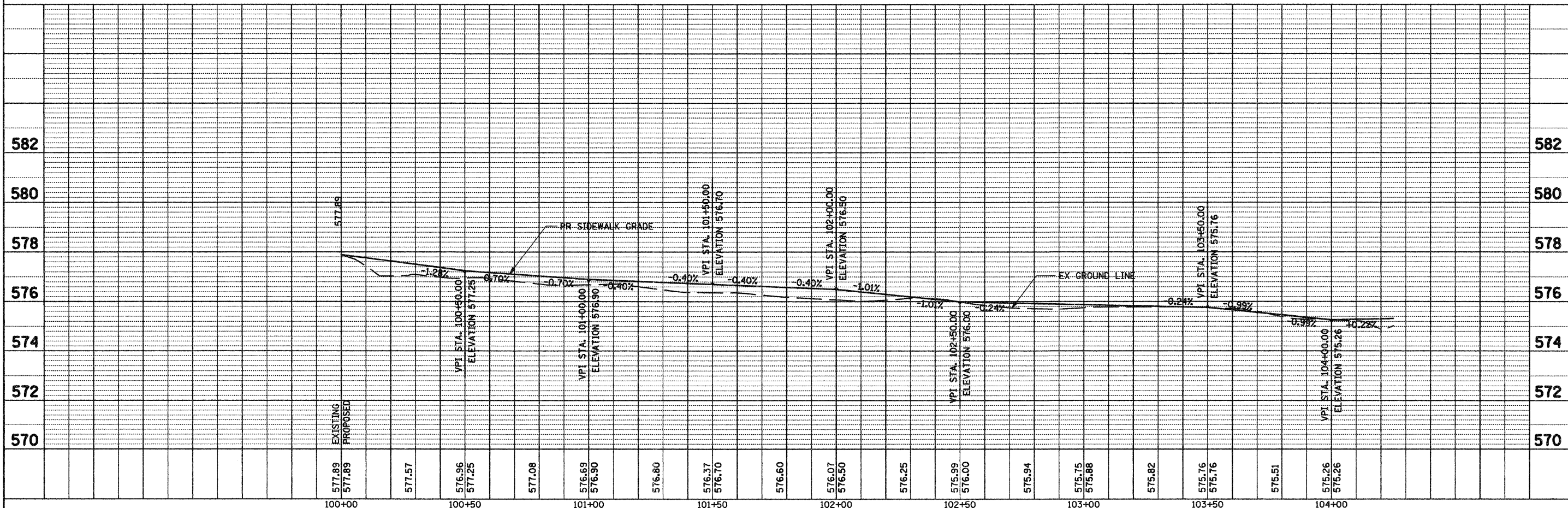

FILE NAME = G:\S07209-01\load\1st-South\7009PP01.SHT	USER NAME = IE Consultants	DESIGNED -	REVISED -	STATE OF ILLINOIS DEPARTMENT OF TRANSPORTATION	FIRST / SOUTH STREET - PLAN & PROFILE STA 99 + 99.3 TO STA 104 + 25			F.A. RTE.	SECTION	COUNTY	TOTAL SHEETS	SHEET NO.	
PLOT SCALE = 20.0000' / IN.		DRAWN -	REVISED -		SCALE:	SHEET NO.	OF	SHEETS	STA.	TO STA.	08-00014-00-SW	47	11
PLOT DATE = 2/12/2009		CHECKED -	REVISED -								CONTRACT NO. 93486		
		DATE -	REVISED -								FED. ROAD DIST. NO.	ILLINOIS	FED. AID PROJECT