

BM #20 STA. 111+94, 23' RT.  
CHISELED "4" TOP OF SW BOLT  
OF FIRE HYDRANT  
ELEV. 578.45

\* PASSING SPACE - SEE SIDEWALK TYPICAL SECTIONS.  
PROVIDE 5'x10' PASSING SPACE AT APPROXIMATE  
LOCATIONS SHOWN. MINOR ADJUSTMENTS MAY BE  
MADE IN THE FIELD. 200' MAX. BETWEEN PASSING  
SPACES.

PLAN	SURVEYED	DATE
NOTE BOOK	PLOTTED	BY
NO.	REVISIONS CHECKED	
	FILE NAME	

PROFILE	SURVEYED	DATE
NOTE BOOK	PLOTTED	BY
NO.	REVISIONS CHECKED	
	STRUCTURE NOTATIONS CHVD	

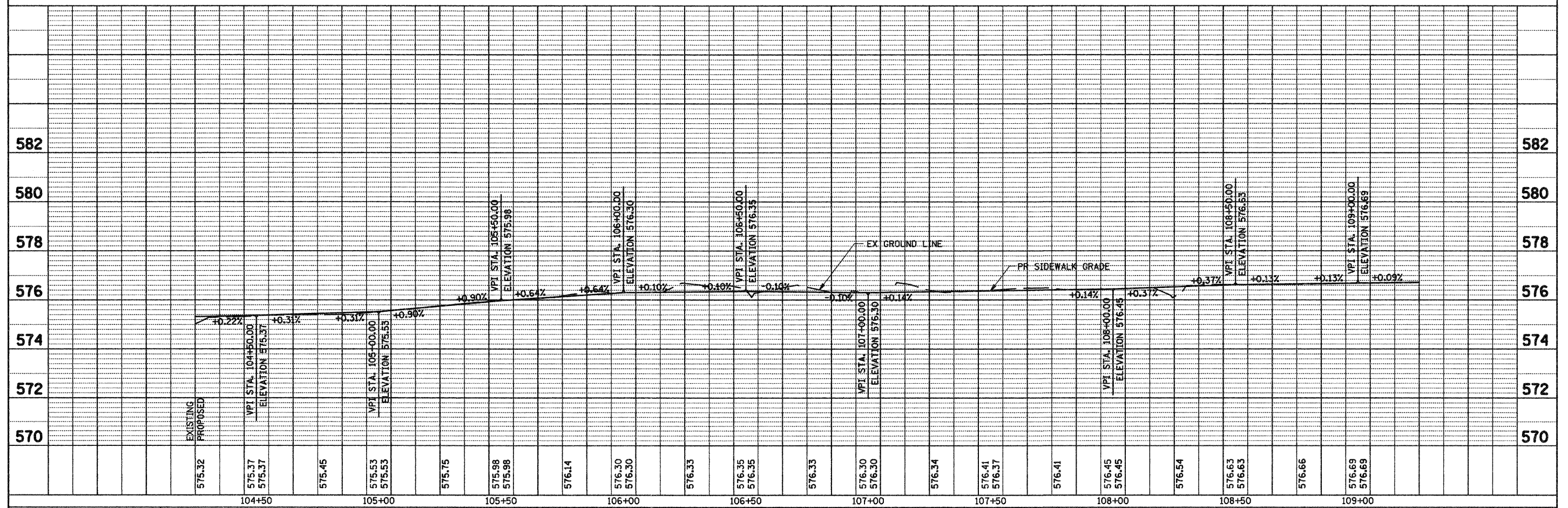

FILE NAME =	USER NAME = IE Consultants	DESIGNED -	REVISED -	<b>STATE OF ILLINOIS</b> <b>DEPARTMENT OF TRANSPORTATION</b>	<b>FIRST / SOUTH STREET - PLAN &amp; PROFILE</b> <b>STA 104 + 25 TO STA 109 + 25</b>	F.A.	SECTION	COUNTY	TOTAL	SHEET		
Gr:\S07009-01\oad\1st-South\7009PP02.SHT	PLOT SCALE = 20.0000' / IN.	DRAWN -	REVISED -			RTE.	08-00014-00-SW	SANGAMON	47	12		
	PLOT DATE = 2/12/2009	CHECKED -	REVISED -			SCALE:	SHEET NO.	OF	SHEETS	STA.	TO	STA.
		DATE	REVISED -									
						FED. ROAD DIST. NO.		ILLINOIS FED. AID PROJECT		CONTRACT NO. 93486		