

COUNTY	ROUTE	SECTION	TOTAL SHEETS	SHEET NO.
ADAMS	FAS 596	08-00208-00-RS	12	1

STATE OF ILLINOIS
DEPARTMENT OF TRANSPORTATION
DIVISION OF HIGHWAYS
PLANS FOR PROPOSED
SURFACE TRANSPORTATION/RURAL PROGRAM
LOCAL AGENCY PAVEMENT PRESERVATION

FAS 596 (CH 24) SECTION 08-00208-00-RS ADAMS COUNTY
PROJECT NO. RS-596(104) JOB NO. C-96-224-08



PROPOSED IMPROVEMENT MARKED THUS —

THESE PLANS WERE PREPARED BY ME OR BY A FULL-TIME MEMBER OF MY STAFF WORKING UNDER MY PERSONAL SUPERVISION.

SUBMITTED BY Richard A. Klump DATE 12-9-08
COUNTY ENGINEER
LICENSE NO. 062-032961
LIC. EXPIRES 11/30/2009

APPROVED	<u>December 9</u>	2008
	<u>Richard A. Klump</u>	COUNTY ENGINEER
PASSED	<u>March 31</u>	2009
	<u>Ken Anshambean</u>	DISTRICT ENGINEER OF CONSTRUCTION
PASSED	<u>MARCH 31</u>	2009
	<u>Tom Felt</u>	DISTRICT ENGINEER OF LOCAL ROADS AND STREETS
RELEASING FOR BID BASED ON LIMITED REVIEW	<u>March 31</u>	2009
	<u>Roger O. Dinkell</u>	DEPUTY DIRECTOR OF HIGHWAYS REGION FOUR ENGINEER

**STATE OF ILLINOIS
DEPARTMENT OF TRANSPORTATION**

INDEX OF SHEETS:

SHEET NO.	SHEET
1	TITLE SHEET
2	SUMMARY OF QUANTITIES
	GENERAL NOTES
3	TYPICAL CROSS SECTIONS
4-11	PLAN SHEETS
12	SIDE ROAD & ENTRANCE DETAILS
	BUTT-JOINT DETAIL
STANDARD	701001-02
STANDARD	701006-03
STANDARD	701301-03
STANDARD	701306-02
STANDARD	701901-01
STANDARD	BLR 24-2

STATION 452+00
SEC. 08-00208-00-RS
ENDS

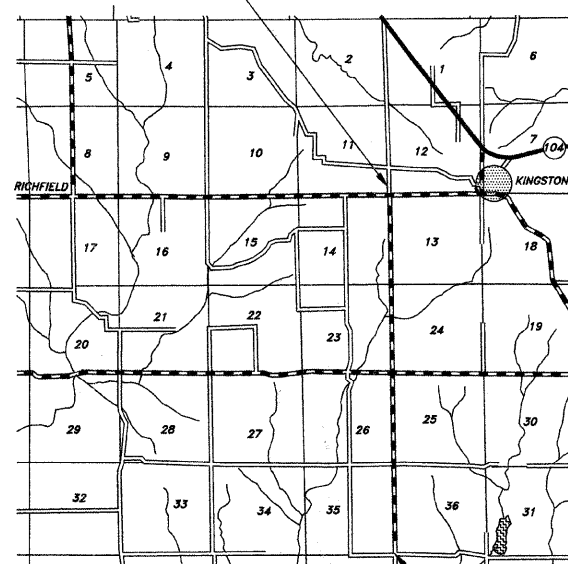

RANGE 6 WEST
4TH P.M.

RANGE 5 WEST

LOCATION MAP

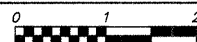

FUNCTIONAL CLASS: MAJOR COLLECTOR (NON-URBAN)
ADT=500

STATION 235+58
SEC. 08-00208-00-RS
BEGINS

PROPOSED IMPROVEMENT CONSISTS OF PLACING 1 1/2" POLYMERIZED HOT-MIX ASPHALT SURFACE COURSE, MIX "C", N50 OVER 3/4" OF LEVELING BINDER (MACHINE METHOD) N50 ON THE EXISTING 22' ROADWAY WITH OTHER MISCELLANEOUS CONSTRUCTION

UTILITIES:
J.U.L.I.E. ————— 1-800-892-0123
GENERAL TELEPHONE ————— QUINCY, IL
ADAMS RURAL ELECTRICAL CO-OP ————— CAMP POINT, IL

GROSS LENGTH:
STA. 235+58.00 TO STA. 452+00.00 = 21,642.00 FT.
NET LENGTH TO BE IMPROVED: 21,642.00 FT. = 4.099 MILES

CONTRACT NO. **93487**

COUNTY	ROUTE	SECTION	TOTAL SHEETS	SHEET NO.
ADAMS	FAS 596	08-00208-00-RS	12	2

SUMMARY OF QUANTITIES - GENERAL NOTES

PROJECT NO. RS-596(104)

GENERAL NOTES

- WHERE SECTION OR SUB-SECTION STONES, USGS BENCH MARK MONUMENTS, AND U.S. ARMY CORPS OF ENGINEERS SURVEY MARKERS ARE ENCOUNTERED, THE ENGINEER SHALL BE NOTIFIED BEFORE SUCH STONES AND MONUMENTS ARE REMOVED. THE CONTRACTOR SHALL PROTECT AND CAREFULLY PRESERVE ALL PROPERTY MARKS UNTIL AN OWNER, AN AUTHORIZED SURVEYOR OR THEIR REPRESENTATIVE HAS WITNESSED OR OTHERWISE REFERENCED THE PROPERTY MARKS LOCATION.
- ALL PRIVATELY OWNED UTILITIES, UNLESS OTHERWISE SPECIFIED, WILL BE MOVED BY THEIR RESPECTIVE OWNERS WHERE REQUIRED. THE FOLLOWING UTILITY COMPANIES HAVE FACILITIES WITHIN THE LIMITS OF CONSTRUCTION:

J.U.L.I.E.
ADAMS RURAL ELECTRICAL CO-OP
GENERAL TELEPHONE
- THE NOMINAL THICKNESS FOR THE LEVELING BINDER, SURFACE COURSES AND AGGREGATE SHOULDERS ARE SHOWN ON THE TYPICAL SECTIONS, STANDARDS, SCHEDULES OR SPECIAL DETAILS. THE CONSTRUCTED THICKNESS OF THE ABOVE ITEMS SHALL NOT BE LESS THAN 90% OF THE NOMINAL THICKNESS AT ANY LOCATION. THE THICKNESS OF THE HOT-MIX ASPHALT MIXTURE SHOWN ON THE PLANS IS THE NOMINAL THICKNESS. DEVIATIONS FROM THE NOMINAL THICKNESS WILL BE PERMITTED WHEN SUCH DEVIATIONS OCCUR DUE TO IRREGULARITIES IN THE EXISTING SURFACE OR BASE WHICH THE HOT-MIX ASPHALT MIXTURE IS PLACED.
- THE CONTRACTOR SHALL BE RESPONSIBLE FOR DETERMINING THE LOCATION AND ELEVATION OF ALL EXISTING UTILITIES AND TO NOTIFY ALL UTILITY COMPANIES PRIOR TO THE BEGINNING OF CONSTRUCTION. THIS WILL BE CONSIDERED INCIDENTAL TO THE CONTRACT.
- APPLICATION RATES SHALL BE AS FOLLOWS UNLESS OTHERWISE SPECIFIED BY THE ENGINEER:

HOT-MIX ASPHALT MIXTURES
112 LBS PER SQUARE YARD
BITUMINOUS MATERIALS (PRIME COAT)
0.05-0.10 GALLON PER SQUARE YARD ON PCC OR BITUMINOUS CONCRETE
0.25-0.35 GALLON PER SQUARE YARD ON AGGREGATE
AGGREGATE (PRIME COAT)
4 LBS PER SQUARE YARD
- PERMANENT & TEMPORARY PAVEMENT MARKING TO BE DONE BY OTHERS. SHORT TERM PAVEMENT MARKING IS INCLUDED IN THE CONTRACT. THE REMOVAL OF THE SHORT TERM PAVEMENT MARKING TAPE WILL BE DONE BY OTHERS UPON COMPLETION OF THE PERMANENT PAVEMENT MARKING.

SUMMARY OF QUANTITIES

QUANTITY	UNIT	ITEM	CODE NO.	SPECIAL PROVISIONS
5,050	GALLON	BITUMINOUS MATERIALS (PRIME COAT)	40600100	*
101	TON	AGGREGATE (PRIME COAT)	40600300	
2,121	TON	LEVELING BINDER (MACHINE METHOD), N50	40600625	*
1	EACH	CONSTRUCTING TEST STRIP	40600895	
366	SQ. YD.	HOT-MIX ASPHALT SURFACE REMOVAL - BUTT JOINT	40600982	*
42	SQ. YD.	TEMPORARY RAMP	40600990	
144	TON	HOT-MIX ASPHALT SURFACE COURSE, MIX "C", N50	40603310	*
4,334	TON	POLYMERIZED HOT-MIX ASPHALT SURFACE COURSE, MIX "C", N50	40603510	*
1	L. SUM	MOBILIZATION	67100100	
1	L. SUM	TRAFFIC CONTROL AND PROTECTION	70101700	*
1,967	FOOT	SHORT TERM PAVEMENT MARKING	70300100	*

CONSTRUCTION TYPE CODE: I000

COUNTY	ROUTE	SECTION	TOTAL SHEETS	SHEET NO.
ADAMS	FAS 596	08-00208-00-RS	12	3
TYPICAL CROSS SECTIONS				
PROJECT NO. RS-596(104)				

TYPICAL CROSS SECTIONS

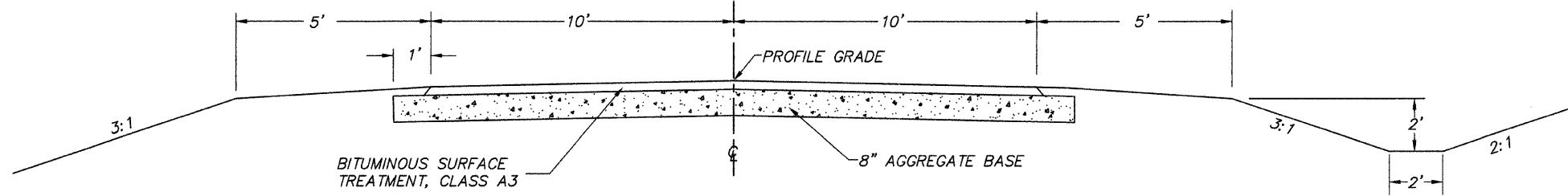

EXISTING CROSS SECTION

BUILT AS: SECTION 14 Q
STA. 235+58 TO STA. 451+35.6

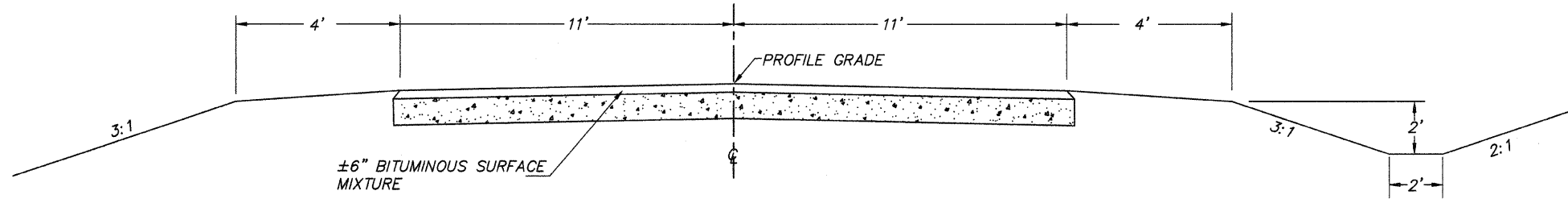

EXISTING CROSS SECTION

BUILT AS: VARIOUS COUNTY MAINT. PROJECTS
STA. 235+58 TO STA. 452+00

HOT-MIX ASPHALT MIXTURE REQUIREMENTS

ITEM	ASPHALT GRADE	AGG. COMPOSITION	VOIDS
POLY. SURFACE	SBS PG 64-28	IL-9.5 or 12.5 MIX C	4.0% @ N50
SURFACE	PG 58-22	IL-9.5 or 12.5 MIX C	4.0% @ N50
LEVELING BINDER	PG 58-22	IL-9.5	4.0% @ N50

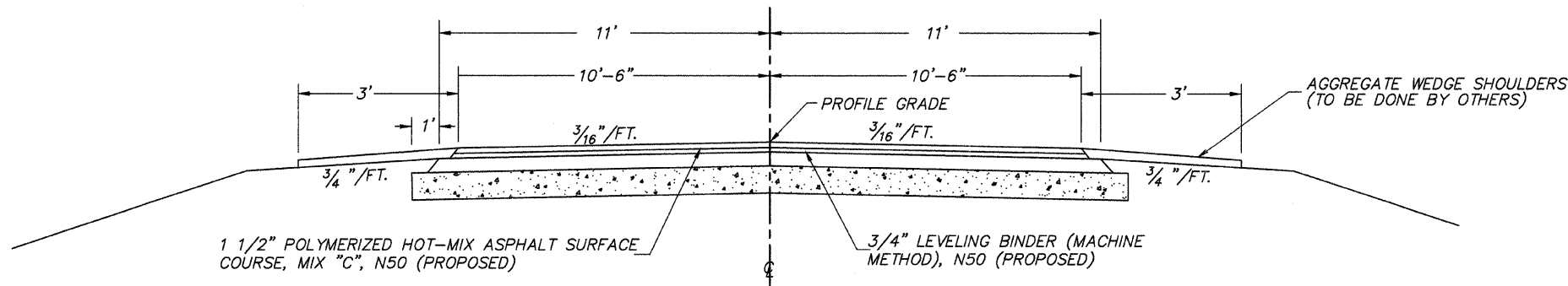

PROPOSED CROSS SECTION

COUNTY	ROUTE	SECTION	TOTAL SHEETS	SHEET NO.
ADAMS	FAS 596	08-00208-00-RS	12	4

STATION 230+00 TO STATION 260+00
PROJECT NO. RS-596(104)

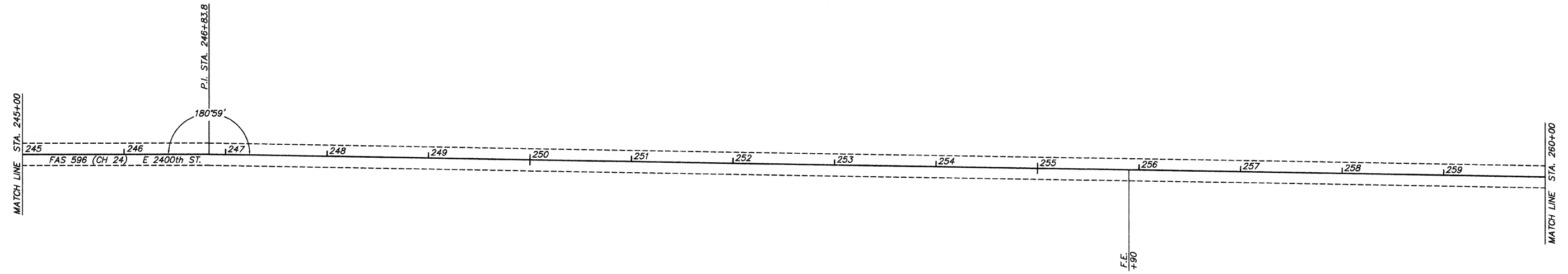
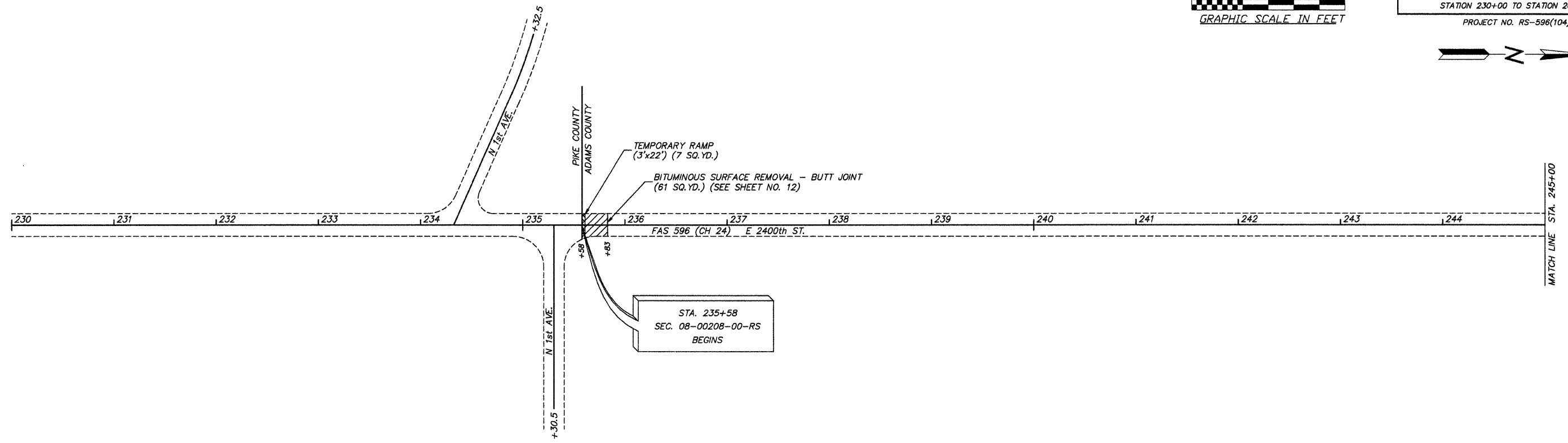
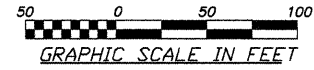

COUNTY	ROUTE	SECTION	TOTAL SHEETS	SHEET NO.
ADAMS	FAS 596	08-00208-00-RS	12	5

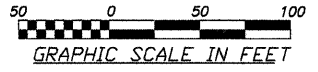

STATION 260+00 TO STATION 290+00
PROJECT NO. RS-596(104)

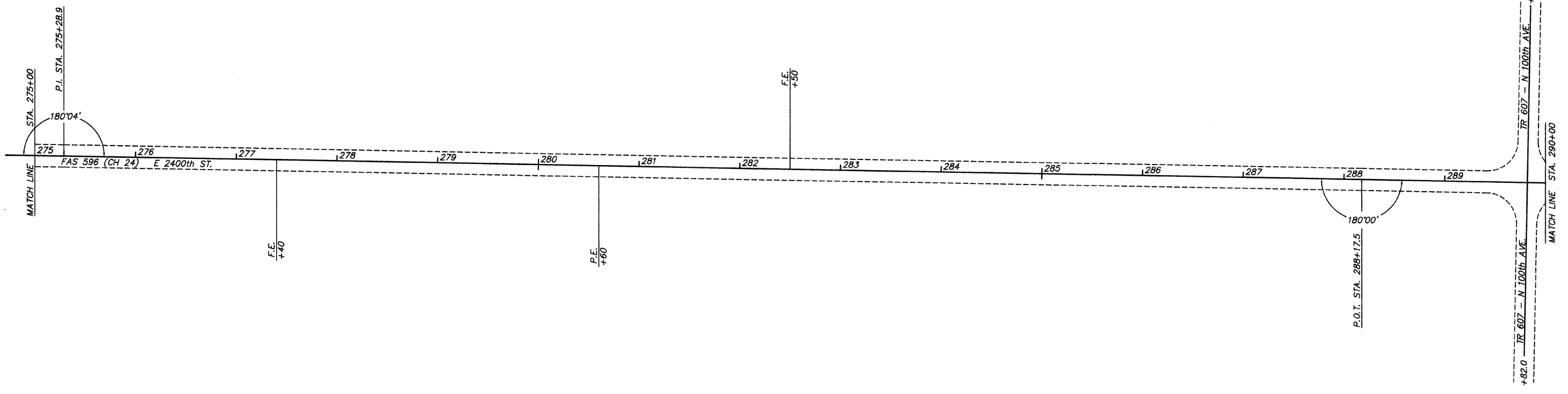
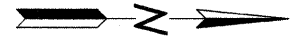
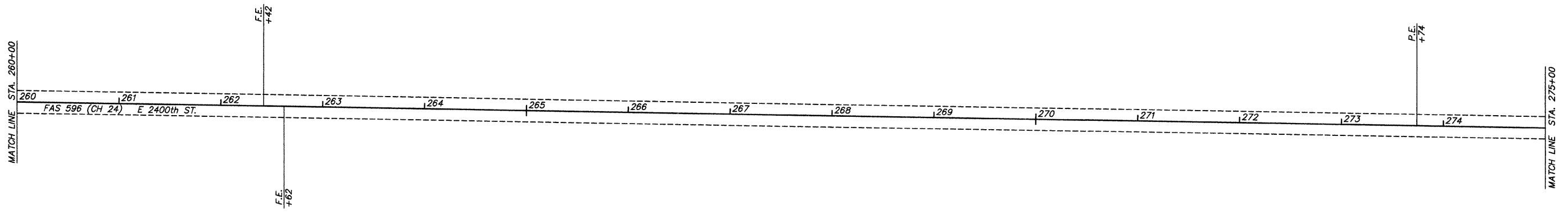
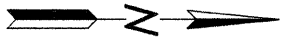

COUNTY	ROUTE	SECTION	TOTAL SHEETS	SHEET NO.
ADAMS	FAS 596	08-00208-00-RS	12	6

STATION 290+00 TO STATION 320+00
PROJECT NO. RS-596(104)

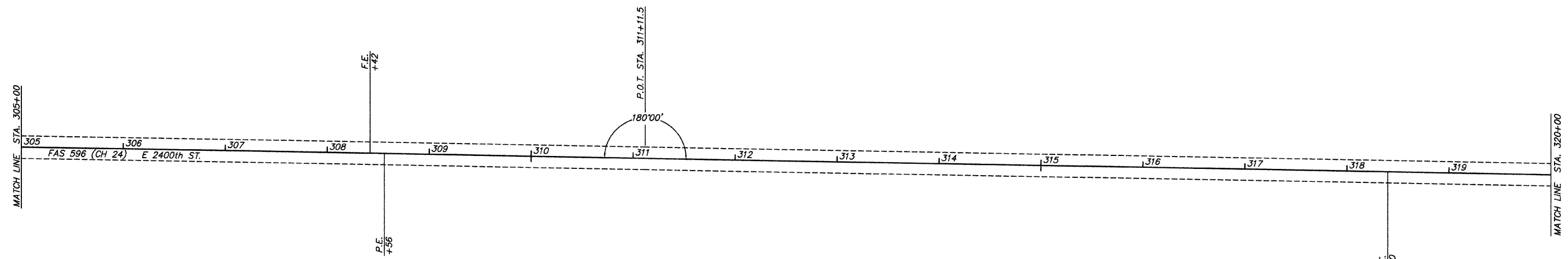
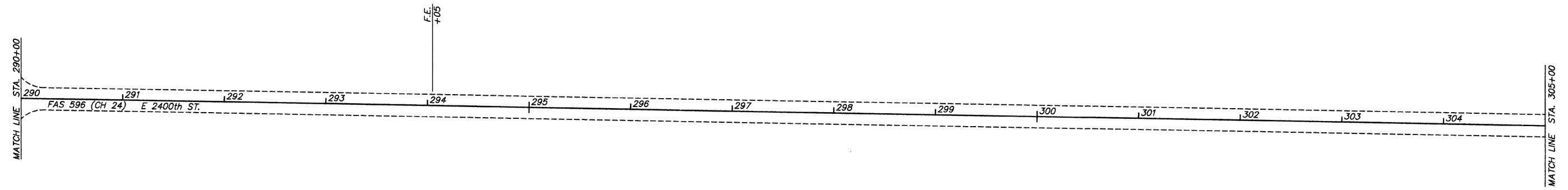
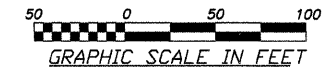

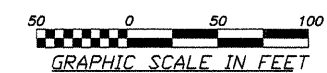

COUNTY	ROUTE	SECTION	TOTAL SHEETS	SHEET NO.
ADAMS	FAS 596	08-00208-00-RS	12	8

STATION 350+00 TO STATION 380+00

PROJECT NO. RS-596(104)

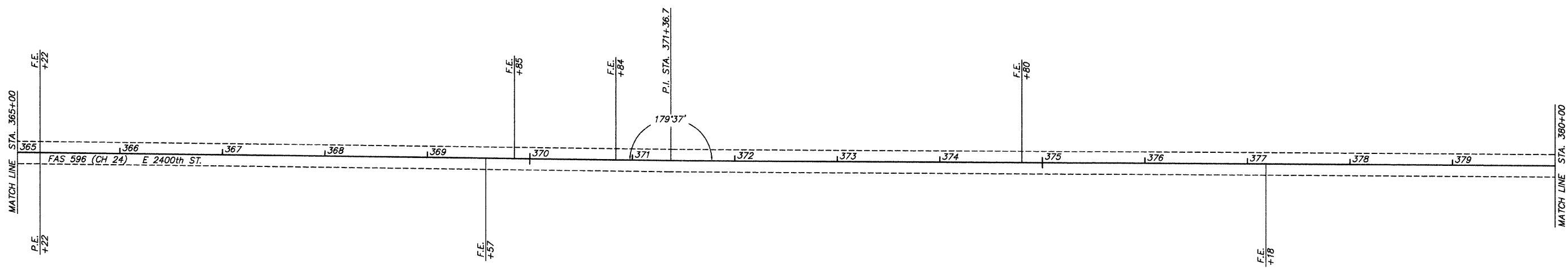
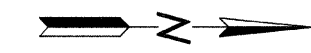
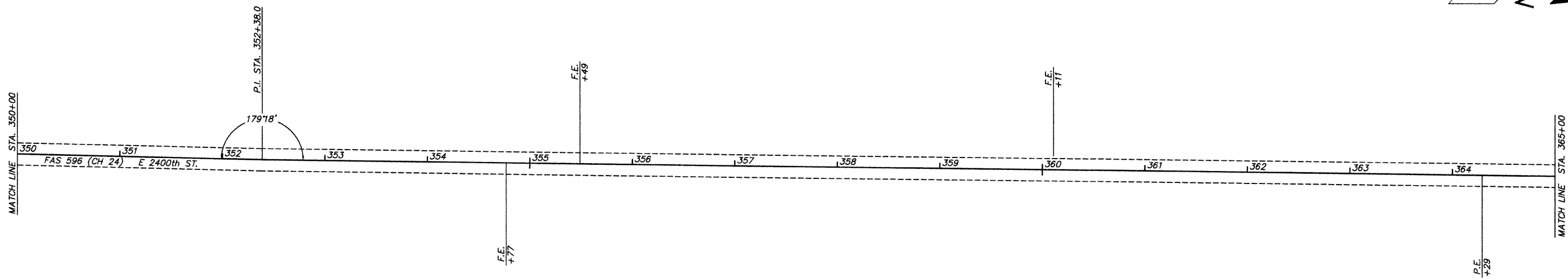
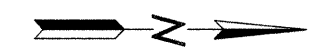

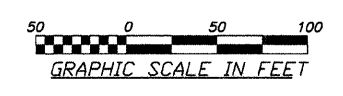

COUNTY	ROUTE	SECTION	TOTAL SHEETS	SHEET NO.
ADAMS	FAS 596	08-00208-00-RS	12	9

STATION 380+00 TO STATION 410+00
PROJECT NO. RS-596(104)

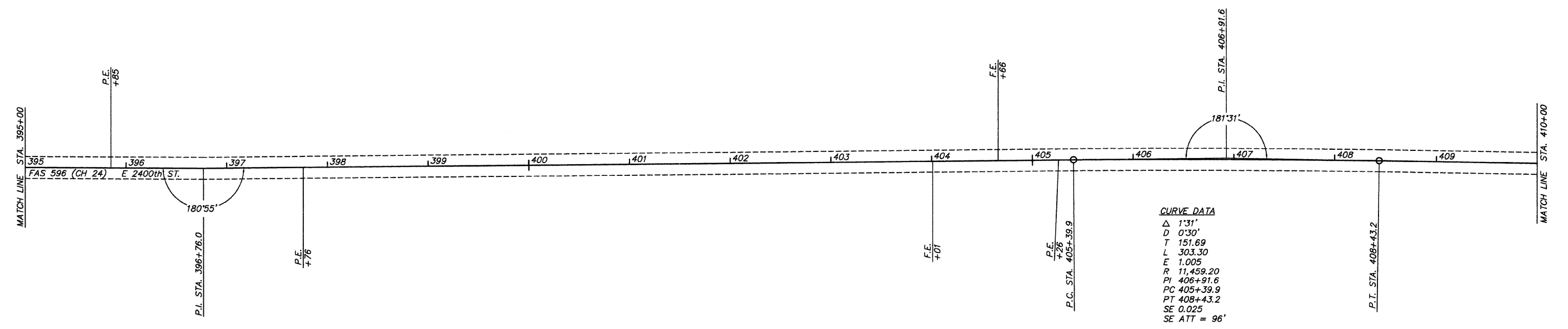
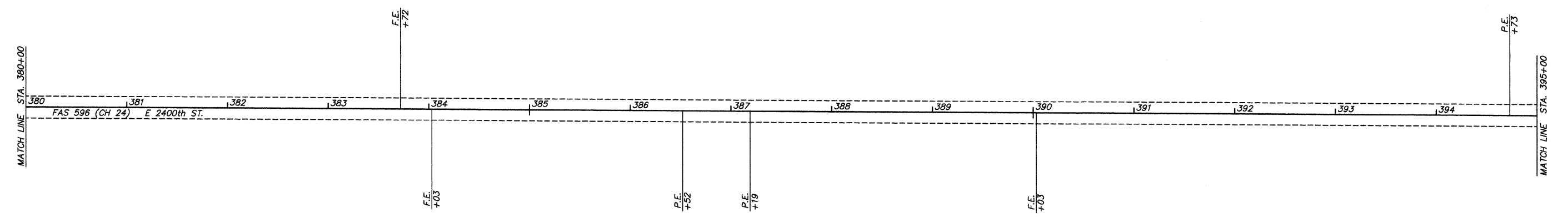
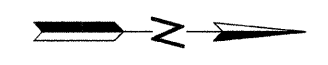

CURVE DATA
 Δ 1°31'
 D 0°30'
 T 151.69
 L 303.30
 E 1.005
 R 11,459.20
 PI 406+91.6
 PC 405+39.9
 PT 408+43.2
 SE 0.025
 SE ATT = 96'

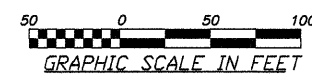

COUNTY	ROUTE	SECTION	TOTAL SHEETS	SHEET NO.
ADAMS	FAS 596	08-00208-00-RS	12	10

STATION 410+00 TO STATION 440+00
PROJECT NO. RS-596(104)

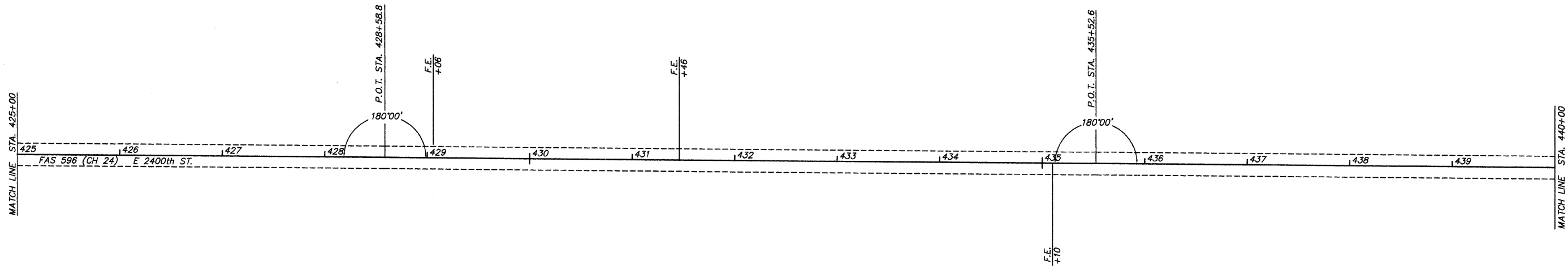
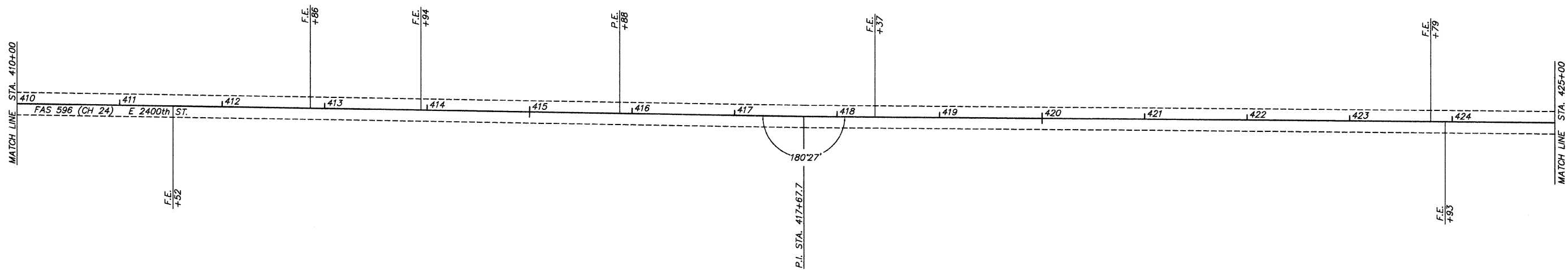
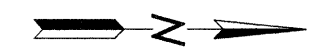

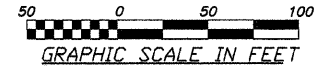

COUNTY	ROUTE	SECTION	TOTAL SHEETS	SHEET NO.
ADAMS	FAS 596	08-00208-00-RS	12	11

STATION 440+00 TO STATION 470+00
PROJECT NO. RS-598(104)

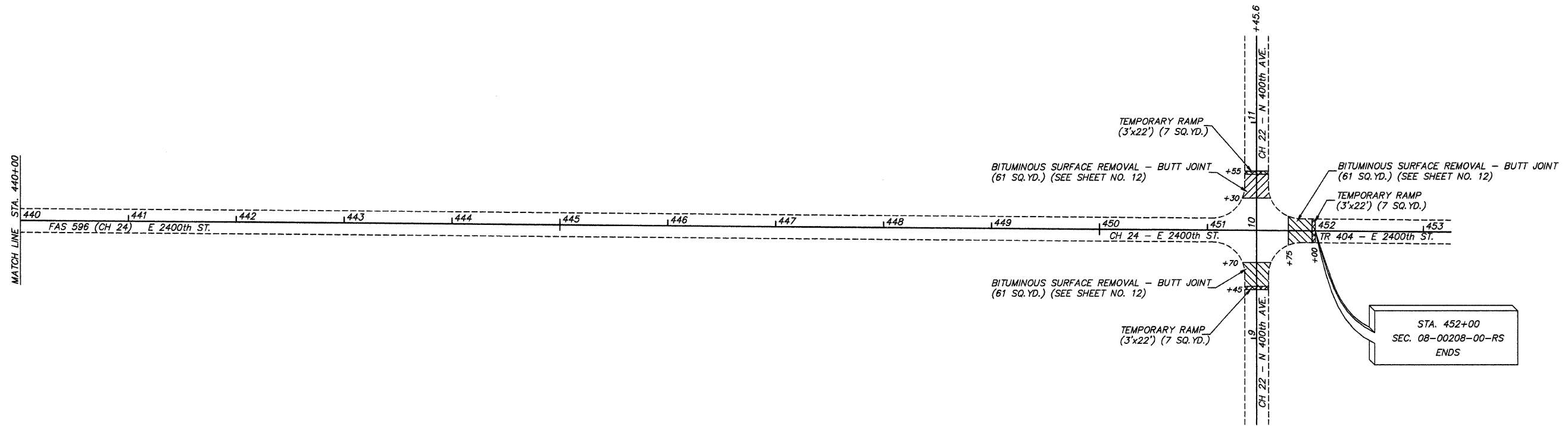
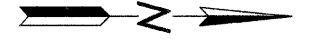

COUNTY	ROUTE	SECTION	TOTAL SHEETS	SHEET NO.
ADAMS	FAS 596	08-00208-00-RS	12	12
BUTT JOINT DETAIL				
SIDE ROAD & ENTRANCE DETAILS				
PROJECT NO. RS-596(104)				

BUTT JOINT DETAIL

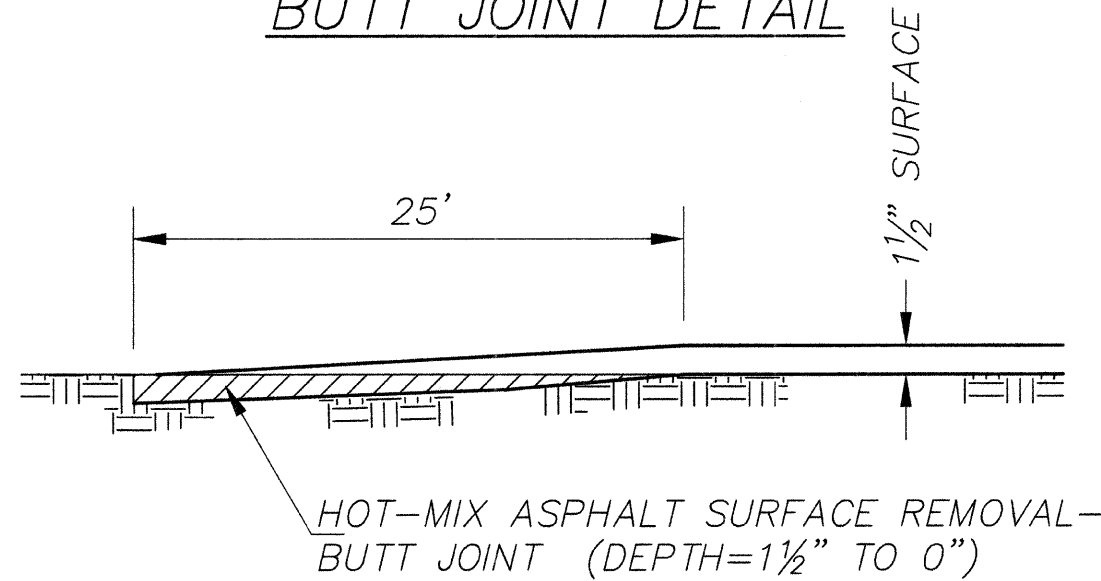

INTERSECTION DETAILS

ENTRANCE DETAILS

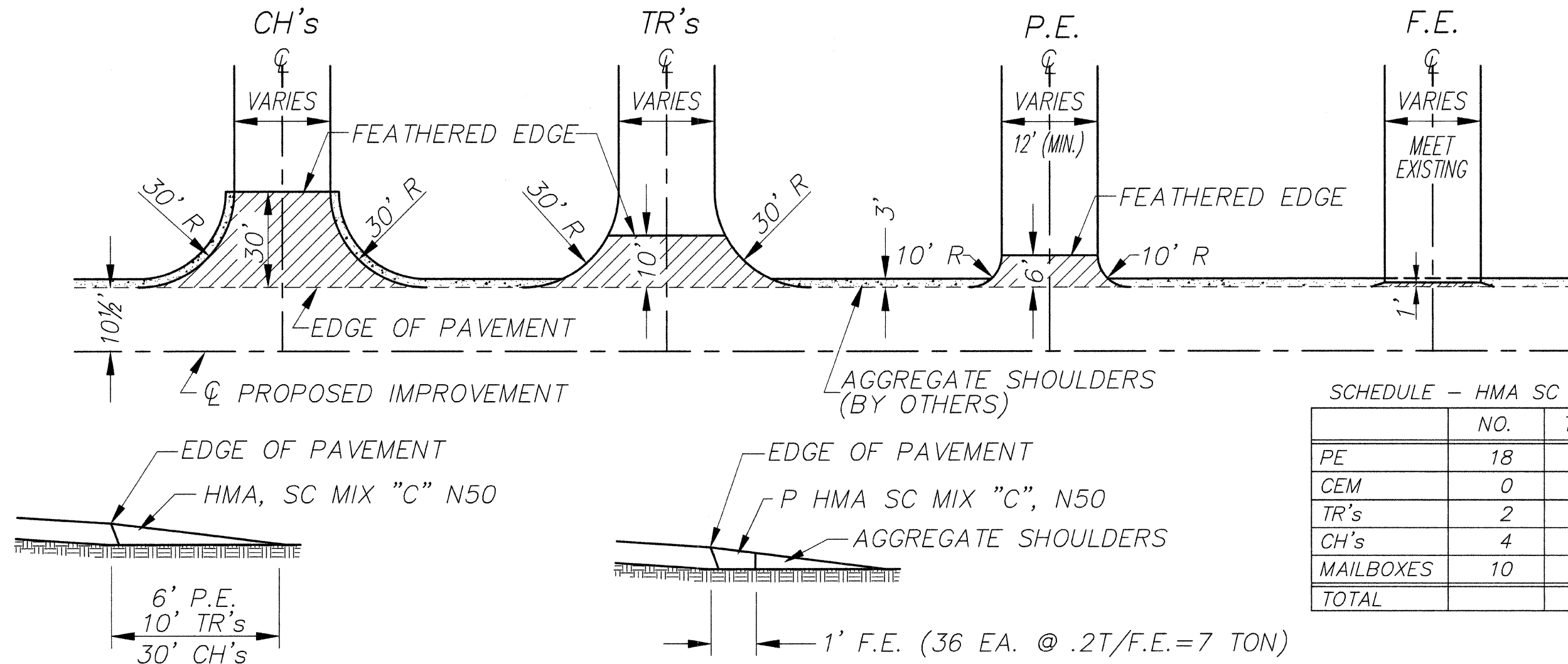

SCHEDULE - HMA SC MIX "C" N50

	NO.	TONS/	TONS
PE	18	2	36
CEM	0	2	0
TR's	2	9	18
CH's	4	15	60
MAILBOXES	10	3	30
TOTAL			144