

F.A.S. RTE.	SECTION	COUNTY	TOTAL SHEETS	SHEET NO.
642	99-00124-03-PV	COLES	97	27
STA. 390+00.00		TO STA. 394+50.00		
FED. ROAD DIST. NO.	ILLINOIS	FED. AID PROJECT		

© Copyright Hanson Professional Services Inc. 2009



DATE: _____ BY: _____
 SURVEYED: _____
 PLAN: _____
 NOTE BOOK: _____
 NO. _____

DATE: _____ BY: _____
 PROFILE: _____
 NOTE BOOK: _____
 NO. _____

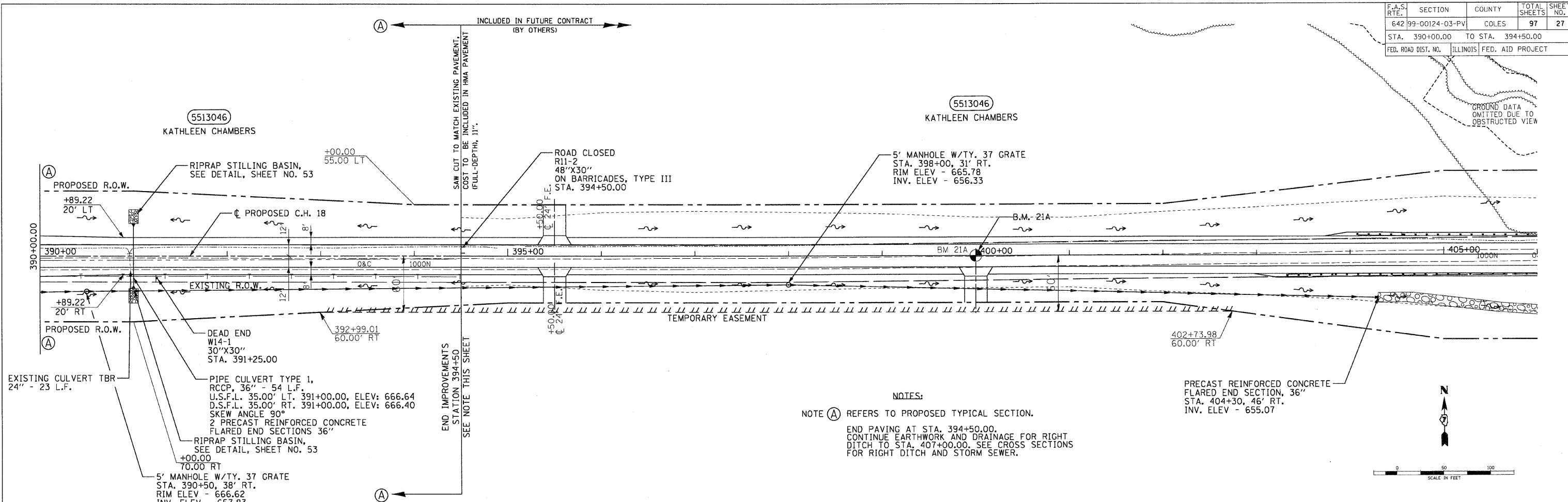

NOTES:
 NOTE (A) REFERS TO PROPOSED TYPICAL SECTION.
 END PAVING AT STA. 394+50.00.
 CONTINUE EARTHWORK AND DRAINAGE FOR RIGHT DITCH TO STA. 407+00.00. SEE CROSS SECTIONS FOR RIGHT DITCH AND STORM SEWER.

