

F.A.S. RTE.	SECTION	COUNTY	TOTAL SHEETS	SHEET NO.
642		COLES	97	36
STA.	TO STA.			
FED. ROAD DIST. NO. ILLINOIS FED. AID PROJECT				
• 99-00124-03-PV				

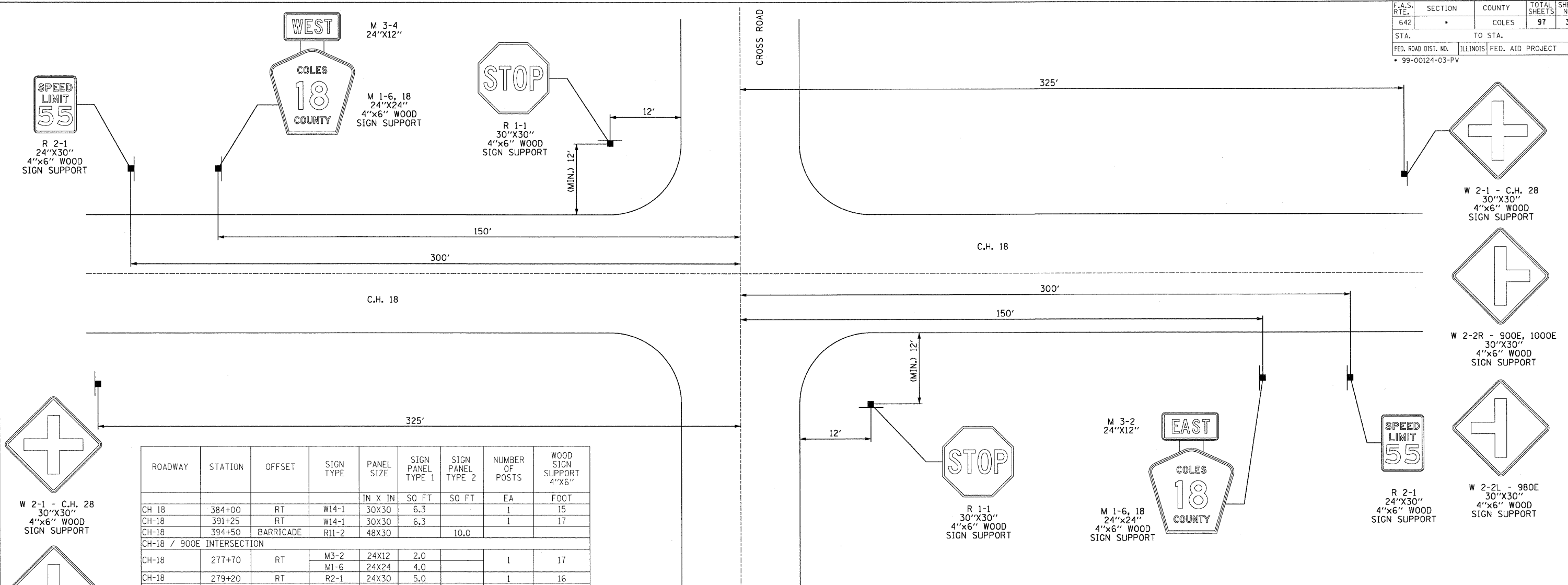

ROADWAY	STATION	OFFSET	SIGN TYPE	PANEL SIZE	SIGN PANEL TYPE 1	SIGN PANEL TYPE 2	NUMBER OF POSTS	WOOD SIGN SUPPORT 4"X6"
				IN X IN	SQ FT	SQ FT	EA	FOOT
CH-18	384+00	RT	W14-1	30X30	6.3		1	15
CH-18	391+25	RT	W14-1	30X30	6.3		1	17
CH-18	394+50	BARRICADE	R11-2	48X30		10.0		
CH-18 / 900E INTERSECTION								
CH-18	277+70	RT	M3-2	24X12	2.0		1	17
CH-18	279+20	RT	M1-6	24X24	4.0			
CH-18	279+45	LT	R2-1	24X30	5.0		1	16
CH-18	279+45	LT	W2-2R	30X30	6.3		1	16
CH-18 / 980E INTERSECTION								
CH-18	313+20	RT	W2-2R	30X30	6.3		1	15
CH-18	313+45	LT	R2-1	24X30	5.0		1	15
CH-18	314+95	LT	M3-4	24X12	2.0		1	18
CH-18	316+65	RT	M1-6	24X24	4.0			
CH-18	316+65	RT	R1-1	30X30	6.3		1	14
CH-18	319+70	LT	W2-2L	30X30	6.3		1	15
CH-18 / 1000E INTERSECTION								
CH-18	326+05	RT	W2-2L	30X30	6.3		1	16
CH-18	329+09	LT	R1-1	30X30	6.3		1	14
CH-18	330+80	RT	M3-2	24X12	2.0		1	17
CH-18	332+30	RT	M1-6	24X24	4.0			
CH-18	332+55	LT	R2-1	24X30	5.0		1	16
CH-18	332+55	LT	W2-2R	30X30	6.3		1	15
CH-18 / 1075E INTERSECTION								
CH-18	369+54	RT	R1-1	30X30	6.3		1	15
CH-18 / CH-28 INTERSECTION								
CH-18	379+04	RT	W2-1	30X30	6.3		1	14
CH-18	379+29	LT	R2-1	24X30	5.0		1	15
CH-18	380+79	LT	M3-4	24X12	2.0		1	16
CH-18	380+79	LT	M1-6	24X24	4.0			
CH-18	381+95	LT	R1-1	30X30	6.3		1	13
CH-18	382+60	RT	R1-1	30X30	6.3		1	13
CH-18	383+79	RT	M3-2	24X12	2.0		1	16
CH-18	385+29	RT	M1-6	24X24	4.0			
CH-18	385+29	RT	R2-1	24X30	5.0		1	15
CH-18	385+54	LT	W2-1	30X30	6.3		1	15
			TOTAL		143.2	10.0		368

TYPICAL SIGN PLACEMENT @ INTERSECTIONS
SEE STANDARD 720006 FOR MORE INFORMATION

NOTE: SEE PLAN AND PROFILE SHEETS 26 AND 27 FOR DEAD END AND ROAD CLOSED SIGNS AT THE END OF THE PROJECT.



REVISIONS	
NAME	DATE

ILLINOIS DEPARTMENT OF TRANSPORTATION
SIGNING PLAN
FAS 642
SEC NO. 88-00124-03-PV
COLES COUNTY, ILLINOIS
SCALE: NOT TO SCALE
DATE 03/30/2009
DRAWN BY JAP
CHECKED BY SKM

LAYOUT	JAP	01/12/04
DRAWN	JAP	01/14/04
REVIEWED	SKM	01/15/04

03/30/2009
I:\97 Jobs\95580\2009\Civil\Sheet\c-524sign.dgn