

F.A.S. RITE	SECTION	COUNTY	TOTAL SHEETS	SHEET NO.
642	99-00124-03-PV	COLES	97	44
STA. 5+00.00		TO STA. 10+00.00		
FED. ROAD DIST. NO.		ILLINOIS FED. AID PROJECT		

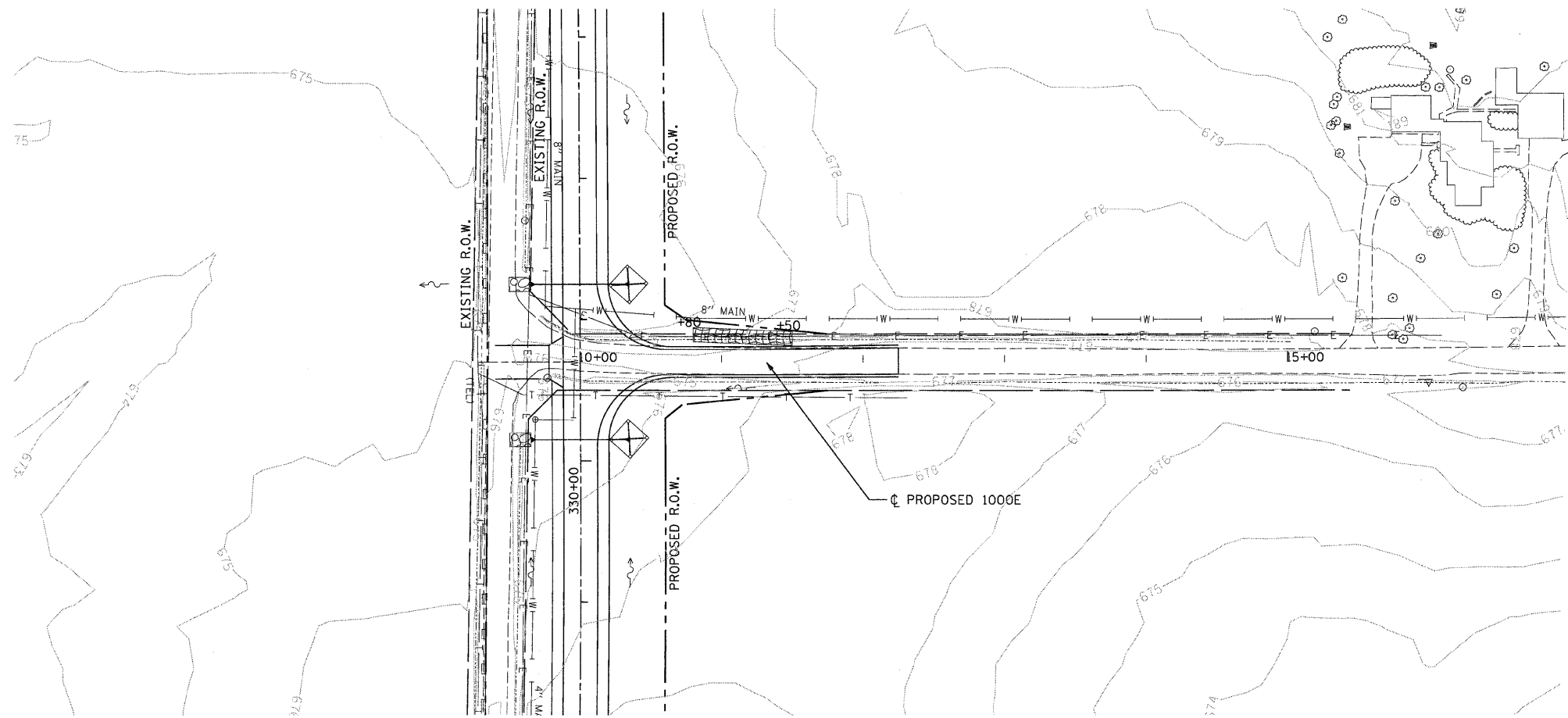

**INTENDED SEQUENCE**

1. PLACE PERIMETER EROSION CONTROL BARRIER PRIOR TO COMMENCEMENT OF ANY WORK. SEE STD. 280001.
2. CONSTRUCT EARTHWORK, INCLUDING DITCHES. (MAXIMUM 10 ACRES DISTURBED AT ONE TIME PRIOR TO SEEDING. SEE ART. 280).
3. PLACE AND MAINTAIN TEMPORARY AND PERMANENT EROSION CONTROLS AS WORK PROGRESSES, SEED EVERY 7 DAYS. SEE ART. 280.
4. FINAL SHAPE, GRADE, AND PAVE ROADWAY.
5. PLACE REMAINING PERMANENT EROSION CONTROLS.

**LEGEND**

	EA.	L.F.	SQ.YD.
	0	0'	78
	0	0'	0
	0	0'	0
	0	0'	0

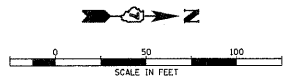

REVISIONS	
NAME	DATE

ILLINOIS DEPARTMENT OF TRANSPORTATION  
**EROSION CONTROL PLAN**  
 1000E  
 FAS 642  
 SEC NO. 99-00124-03-PV  
 COLES COUNTY, ILLINOIS

SCALE: HORIZ. 1"=50'  
 DATE: 03/30/2009  
 DRAWN BY: JAP  
 CHECKED BY: SKM

1000E STA. 10+00.00 TO STA. 12+25.00