

FINAL SURVEY	BY	DATE
PLOTTED		
NOTE BOOK		
AREAS CHECKED		
NO.		

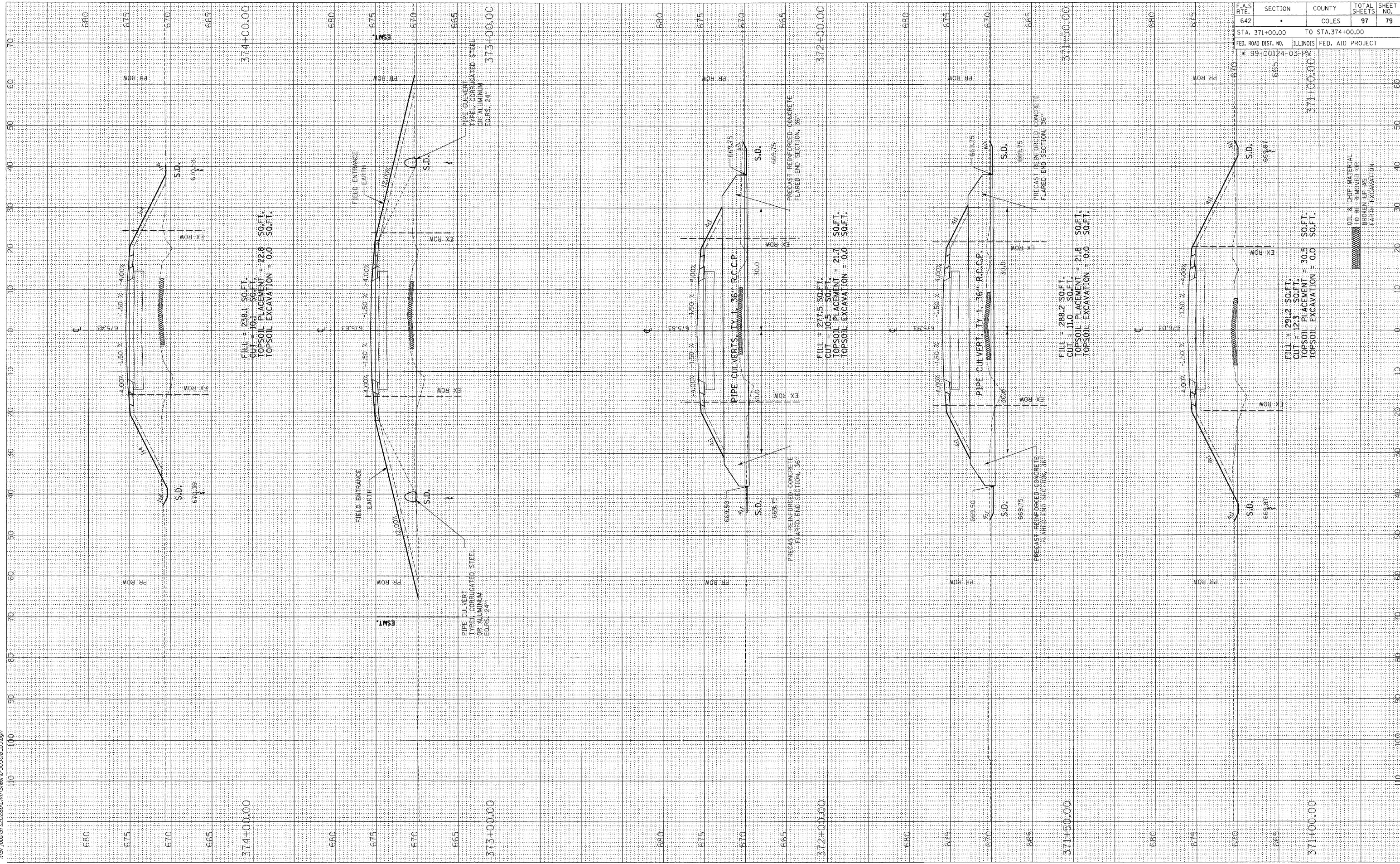

ORIGINAL SURVEY	BY	DATE
PLOTTED		
NOTE BOOK		
AREAS CHECKED		
NO.		

03/31/2009
 I:\97 Jobs\95580\Drawings\Sheet-c-3036b-03.dgn



F.A.S. RTE.	SECTION	COUNTY	TOTAL SHEETS	SHEET NO.
642		COLES	97	79
STA. 371+00.00		TO STA. 374+00.00		
FED. ROAD DIST. NO.	ILLINOIS	FED. AID PROJECT		
* 99:00124:03-PV				
			371+00.00	
			371+50.00	
			372+00.00	
			373+00.00	
			374+00.00	
			371+00.00	
			371+50.00	
			372+00.00	
			373+00.00	
			374+00.00	
			371+00.00	
			371+50.00	
			372+00.00	
			373+00.00	
			374+00.00	
			371+00.00	
			371+50.00	
			372+00.00	
			373+00.00	
			374+00.00	