

FINAL SURVEY	BY	DATE
PLOTTED		
NOTE BOOK		
AREAS CHECKED		
NO.		

ORIGINAL SURVEY	BY	DATE
PLOTTED		
NOTE BOOK		
AREAS CHECKED		
NO.		

03_30_2009

A:\97 Jobs\9520286\Ch1\Sheet-C-303e8_03.dgn

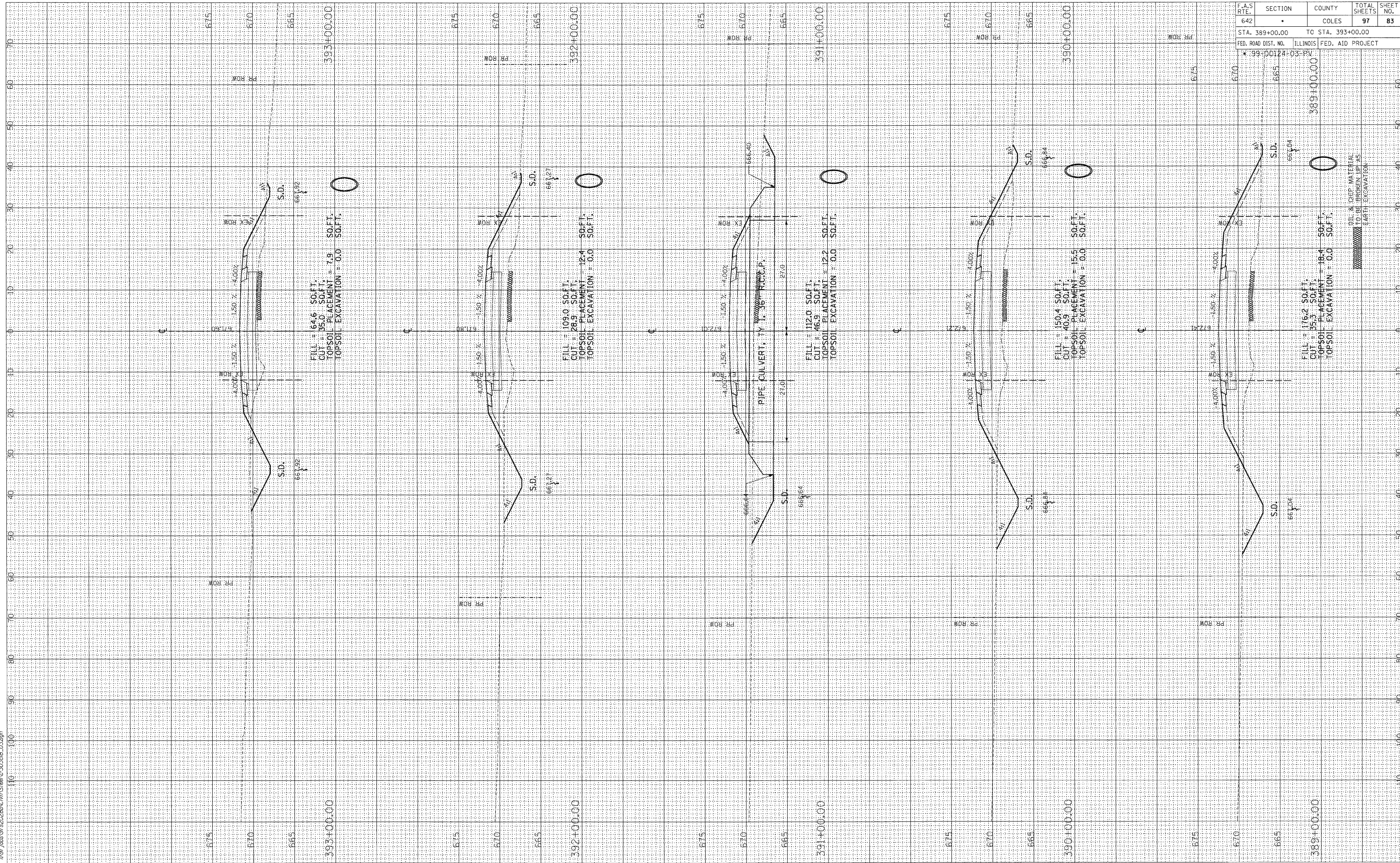

F.A.S. RTE.	SECTION	COUNTY	TOTAL SHEETS	SHEET NO.
642		COLES	97	83

FED. ROAD DIST. NO.	ILLINOIS	FED. AID PROJECT
STA. 389+00.00 TO STA. 393+00.00		