

F.A.S. RTE.	SECTION	COUNTY	TOTAL SHEETS	SHEET NO.
642		COLES	97	90
STA. 81+54.32		TO STA. 83+00.00		
FED. ROAD DIST. NO.		ILLINOIS FED. AID PROJECT		
* 99-00124-D3-PV				

FINAL SURVEY	BY	DATE
SURVEYED		
PLOTTED		
NOTE BOOK NO.		
AREAS CHECKED		



ORIGINAL SURVEY	BY	DATE
SURVEYED		
PLOTTED		
NOTE BOOK NO.		
AREAS CHECKED		

03_30_2009
 I:\97 jobs\95-00124-D3-PV\Sheetc-312c125.dgn

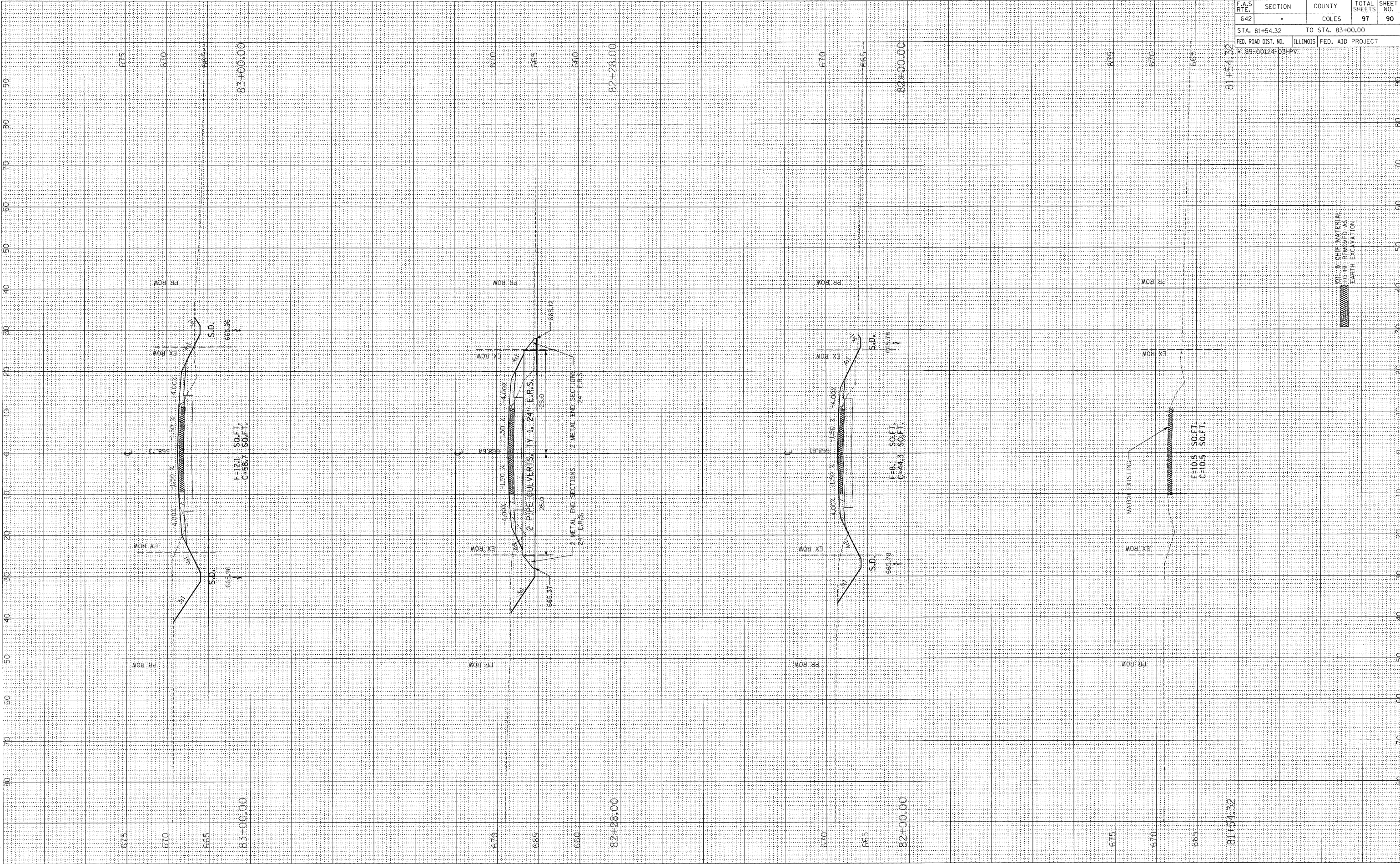

NOT TO BE REMOVED AS EARTH EXCAVATION