

STATE OF ILLINOIS
 DEPARTMENT OF TRANSPORTATION
 DIVISION OF HIGHWAYS
 PLANS FOR PROPOSED
 FEDERAL-AID HIGHWAY BRIDGE PROGRAM

LAWRENCE COUNTY
 SECTION 05-00102-00-BR
 RUSSELL ROAD DISTRICT
 STRUCTURE NO. 051-3283
 PROJECT NO. BRS-1803(101)
 JOB NO. C-97-088-09
 FAS 1803 (CH 17)

INDEX OF SHEETS

- 1 COVER SHEET
- 2 PLAN & PROFILE
- 3 CROSS SECTIONS
- 4-10 BRIDGE PLANS
- 11-12 BORINGS

- STANDARDS:
- 280001-04 - EROSION CONTROL
 - 515001-03 - NAME PLATES
 - 630301-05 - SHOULDER WIDENING
 - 635006-03 - TERMINAL MARKERS
 - 701901-01 - TRAFFIC
 - BLR 21-8 - TRAFFIC
 - BLR 22-6 - TRAFFIC
 - BLR 27-1 - TRAFFIC BAR. TERM. T5A

SUMMARY OF QUANTITIES

QTY	UNIT	ITEM	CODE NO
1393	CU YD	EARTH EXCAVATION	20200100
31	CU YD	CHANNEL EXCAVATION	20300100
0.60	ACRE	SEEDING, CLASS 2 (SPECIAL)	25001000
4	EACH	TEMPORARY DITCH CHECKS	28000300
80	FOOT	PERIMETER EROSION BARRIER	28000400
120	TON	STONE DUMPED RIPRAP, CLASS A4	28100807
808	TON	AGGREGATE BASE COURSE, TYPE B	35101400
40	TON	AGGREGATE SURFACE COURSE, TYPE B	40200800
1	EACH	REMOVAL OF EXISTING STRUCTURES	50100100
37.8	CU YD	CONCRETE STRUCTURES	50300225
4.0	CU YD	CONCRETE ENCASEMENT	50300280
1680	SQ FT	PRECAST PRESTRESSED CONCRETE DECK BEAMS (27" DEPTH)	50400505
3810	POUND	REINFORCEMENT BARS	50800105
118	FOOT	STEEL RAILING, TYPE S1	50900205 *
495	FOOT	FURNISHING STEEL PILES HP 10x42	51201400
495	FOOT	DRIVING PILES	51202305
1	EACH	TEST PILE STEEL HP 10x42	51203400
1	EACH	NAME PLATES	51500100
134	FOOT	PIPE CULVERTS, CLASS D, TYPE 1 12"	542D0217
2	EACH	TRAFFIC BARRIER TERMINAL, TYPE 5A	63100075 *
2	EACH	TRAFFIC BARRIER TERMINAL, TYPE 1 (SPECIAL) TANGENT	63100167 *
1	L SUM	MOBILIZATION	67100100
1	L SUM	TRAFFIC CONTROL AND PROTECTION	70101700
2	EACH	TERMINAL MARKER - DIRECT APPLIED	78201000 *

* SPECIALTY ITEMS

FUNCTIONAL CLASS: RURAL MAJOR COLLECTOR
 ADT = 600
 DESIGN SPEED = 50 MPH

SCALES

- PLAN 1 INCH = 50 FEET
- PROFILE HORZ. 1 INCH = 50 FEET
- PROFILE VERT. 1 INCH = 10 FEET
- CROSS SECTION 1 INCH = 5 FEET

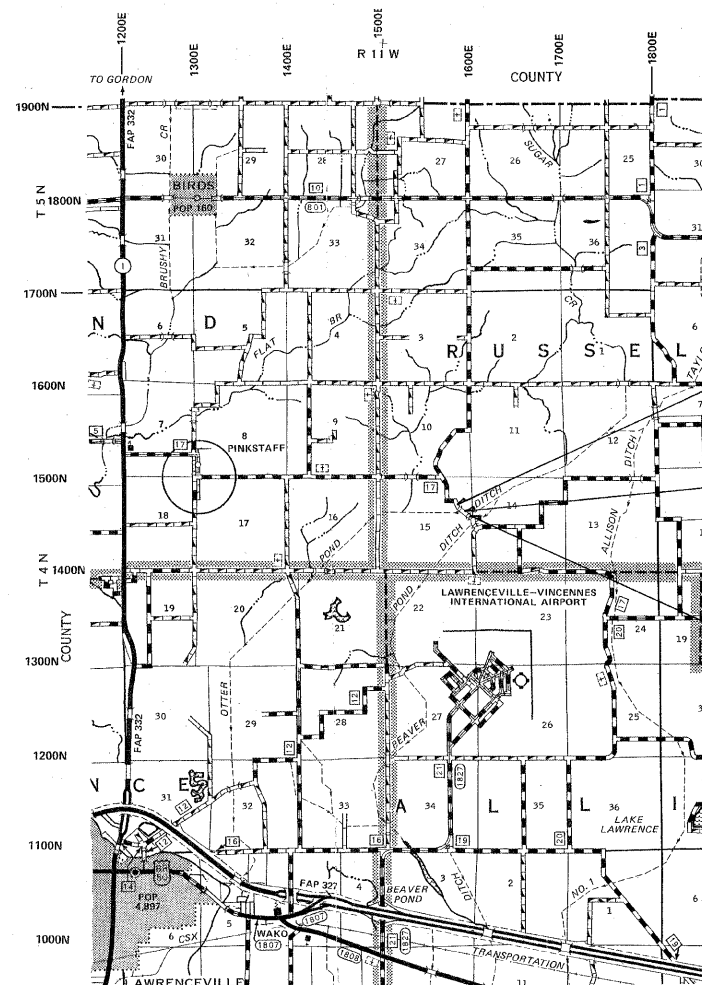

LOCATION MAP

APPROXIMATE SCALE: 1 INCH = 1 MILE
 NET LENGTH = 600.00 L.F. = 0.114 MILES

SECTION 05-00102-00-BR
 ENDS STA. 8+00

STA. 5+00 - SPECIAL BRIDGE DESIGN
 PROPOSED PRECAST PRESTRESSED CONCRETE DECK BEAM BRIDGE. 1 SPAN @ 60', 28' RDWY., SKEW = 45' L.F.
 EXISTING STR. NO. 051-3030
 PROPOSED STR. NO. 051-3283

SECTION 05-00102-00-BR
 BEGINS STA. 2+00

TOLL FREE JOINT UTILITY LOCATING
 INFORMATION FOR EXCAVATORS (J.U.L.I.E.)
 TELEPHONE NO. 1-800-892-0123

PROFESSIONAL DESIGN FIRM #184-000832



John A. Stone
 ILLINOIS REGISTERED PROFESSIONAL ENGINEER # 55102
 LICENSE EXPIRES NOVEMBER 30, 2009
 03/19/2009

ILLINOIS DEPARTMENT OF TRANSPORTATION
APPROVED: <u>MARCH 20</u> , 2009 <i>[Signature]</i> LOCAL AGENCY REPRESENTATIVE, COUNTY ENGINEER
PASSED: <u>4-1</u> , 2009 <i>Marcus L. Stone</i> DISTRICT SEVEN ENGINEER OF LOCAL ROADS & STREETS
RELEASING FOR BID BASED ON LIMITED REVIEW <u>4-1</u> , 2009 <i>Roger L. Dushell</i> DEPUTY DIRECTOR OF HIGHWAYS, REGION FOUR ENGINEER