

F.A.U. RTE.	SECTION	COUNTY	TOTAL SHEETS	SHEET NO.
7369	08-00503-00-BR	MACON	24	6
STA.		TO STA.		
FED. ROAD DIST. NO.	ILLINOIS	FED. AID PROJECT		

UTILITY LOCATION AND SITE PROTECTION PLAN

(AT GRADE)

* STAIRS SHALL BE CLOSED OFF DURING CONSTRUCTION. CONTRACTOR SHALL TAKE APPROPRIATE PRECAUTIONS TO PROTECT THE INTEGRITY OF THE STAIRWAYS. STAIRWAYS SHALL NOT BE USED AS A SUPPORT FOR FORM WORK OR EQUIPMENT. CONTRACTOR SHALL INCLUDE DETAILS OF STAIRCASE CLOSURE DEVICE ADJACENT TO THE BRIDGE SIDEWALK IN THE SITE PROTECTION PLAN. COST INCLUDED IN TEMPORARY FENCE.

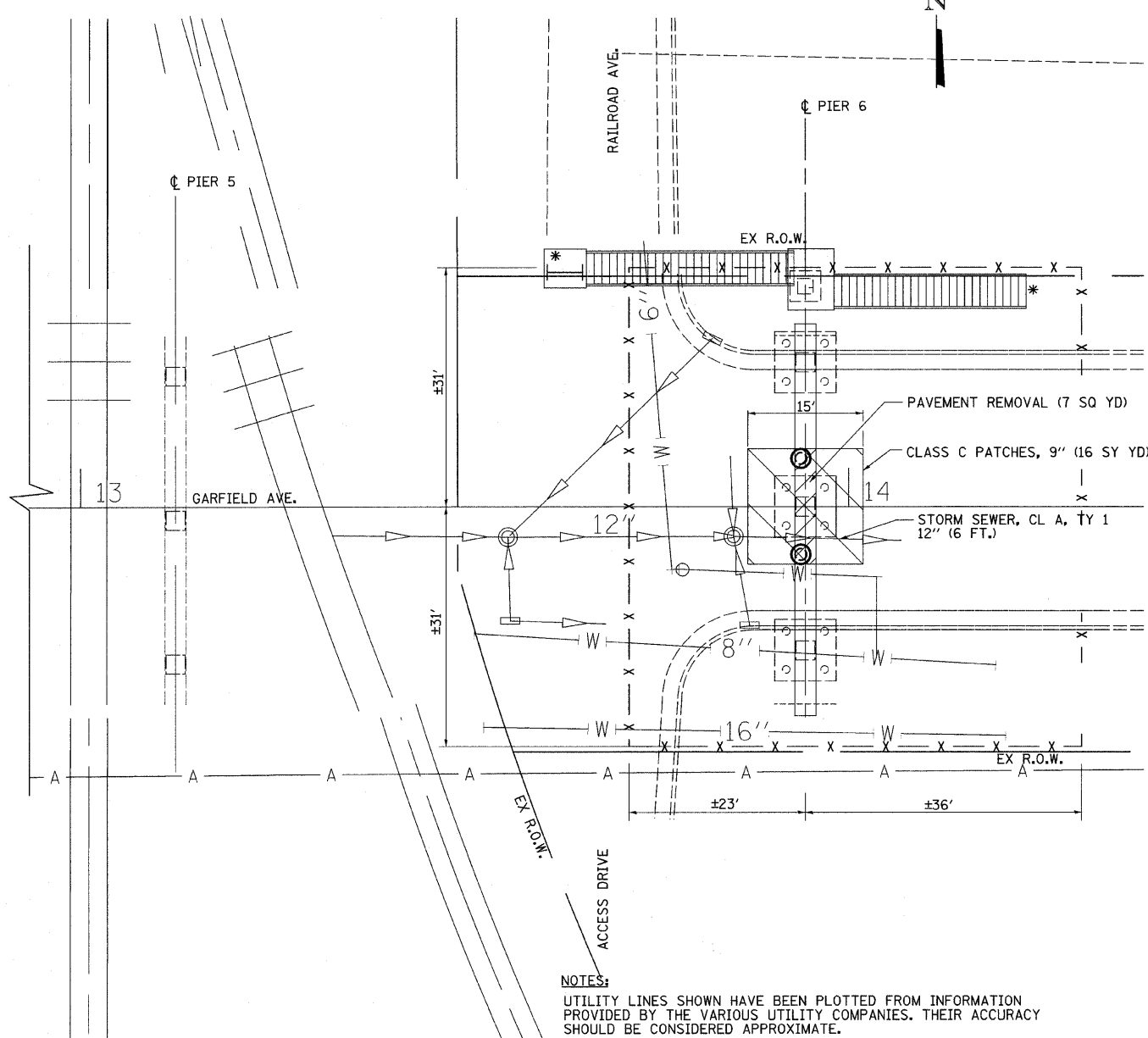
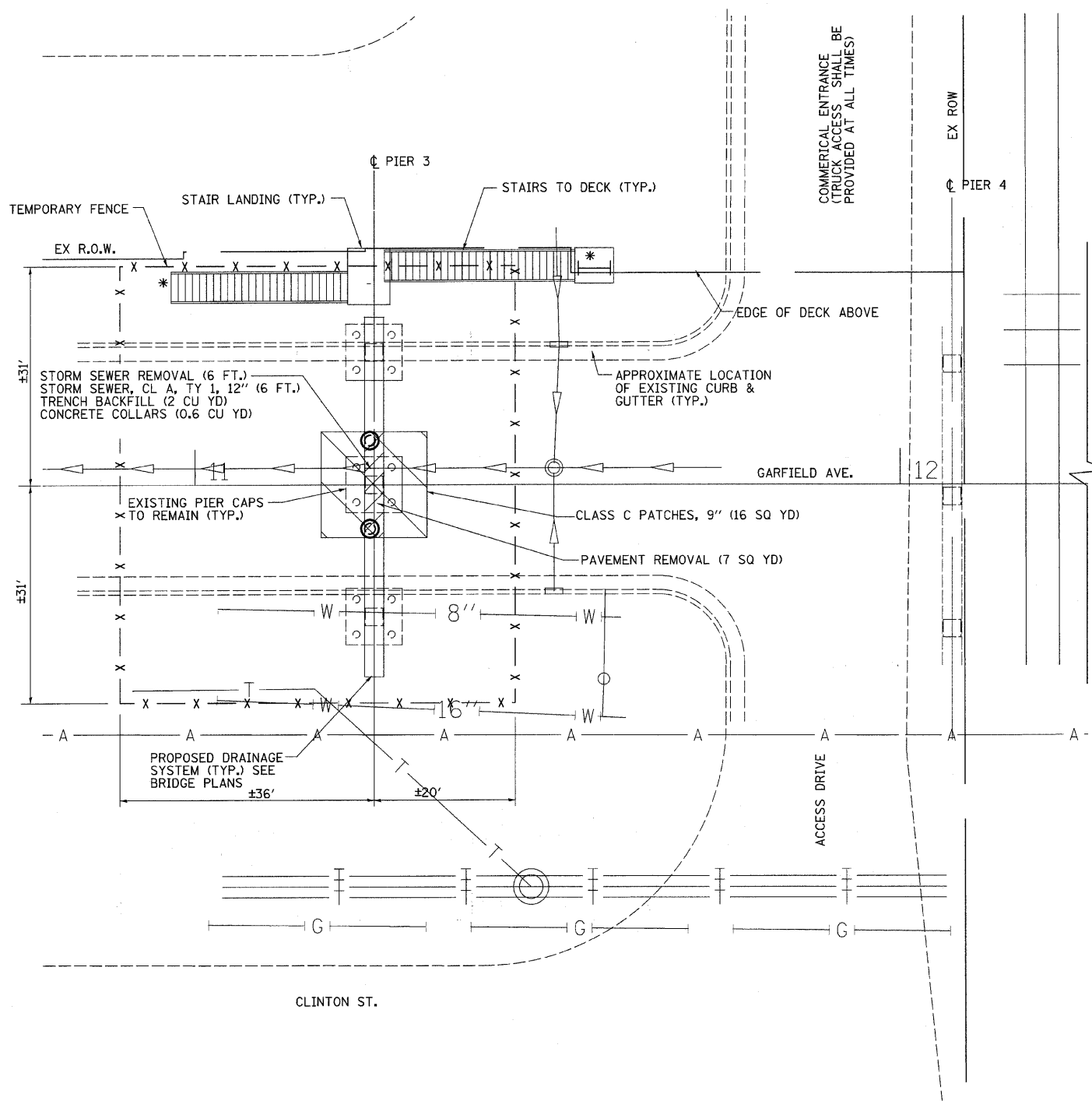
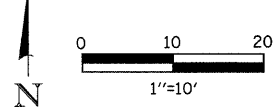

NOTES:
 UTILITY LINES SHOWN HAVE BEEN PLOTTED FROM INFORMATION PROVIDED BY THE VARIOUS UTILITY COMPANIES. THEIR ACCURACY SHOULD BE CONSIDERED APPROXIMATE.
 THE CONTRACTOR SHALL FIELD LOCATE THE UTILITIES IN THE AREA OF THE PILES FOR THE PURPOSE OF DETERMINING CONFLICTS BETWEEN THE UTILITIES AND THE CONSTRUCTION.
 STORM SEWER WORK MAY BE OMITTED IF EXISTING STORM SEWERS ARE NOT DAMAGED BY MICROPILE CONSTRUCTION.
 THE CONTRACTOR SHALL SUBMIT A SITE PROTECTION PLAN TO THE ENGINEER FOR APPROVAL PRIOR TO CONSTRUCTION. THE SITE PROTECTION PLAN SHALL INCLUDE TEMPORARY FENCE AND STAIRWELL CLOSURE.
 A MINIMUM OF A 6 FOOT HIGH TEMPORARY FENCE SHALL BE INSTALLED AROUND THE PERIMETER OF THE WORK AREA.
 PARKING OR THE STOCK PILING OF MATERIALS SHALL BE PROHIBITED ON THE ACCESS DRIVE TO THE WEST OF PIER 4 AND TO THE EAST OF PIER 5 (RAILROAD AVE.). MAINTAIN BUSINESS AND RAILROAD ACCESS.
 THE CONTRACTOR MAY USE THE AREA BELOW THE STRUCTURE FROM THE WEST ABUTMENT TO PIER 3 AND FROM PIER 6 TO THE EAST ABUTMENT FOR STAGING AND PARKING.
 ALL DISTURBED LANDSCAPED AREAS SHALL BE GRADED AND SEEDDED (CLASS 2) IN ACCORDANCE WITH SECTION 250 OF THE STANDARD SPECIFICATIONS AS DIRECTED BY THE ENGINEER. COST INCLUDED IN CONCRETE STRUCTURES.

FOR CLARITY, ONLY UTILITY WORK IS SHOWN AT PIER 6. SEE PIER 3 FOR REMAINING TYPICAL SITE NOTES.

FOR UNDERGROUND UTILITY LOCATIONS CALL J.U.L.I.E. TOLL FREE 1-800-892-0123 DECATUR TOWNSHIP