

F.A.U. RTE.	SECTION	COUNTY	TOTAL SHEETS	SHEET NO.
T369	08-00503-00-BR	MACON	24	9
STA.		TO STA.		
FED. ROAD DIST. NO.		ILLINOIS FED. AID PROJECT		

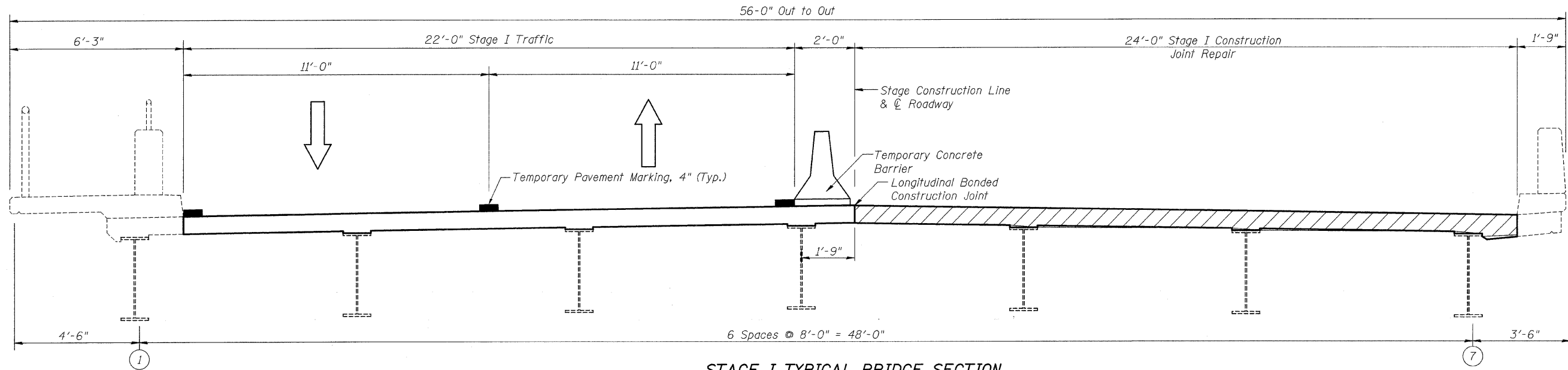

**STAGE I TYPICAL BRIDGE SECTION**  
At Pier 3 or Pier 6 (Looking East)

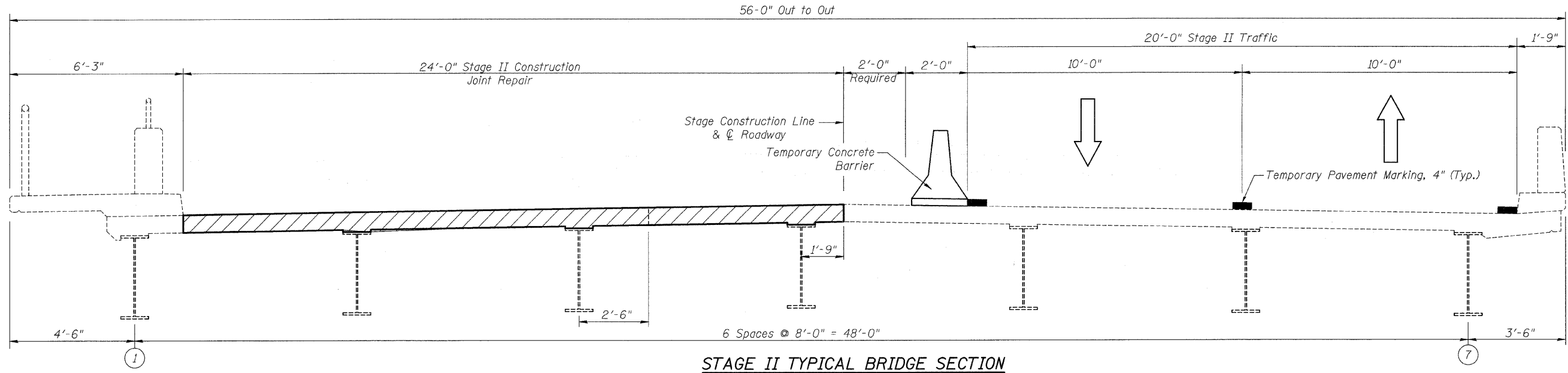

**STAGE II TYPICAL BRIDGE SECTION**  
At Pier 3 or Pier 6 (Looking East)

**NOTES:**  
For details of Temporary Concrete Barrier, See sheet 4 of 17.  
For quantities of Temporary Concrete Barrier, See Roadway Plans.  
See Suggested Traffic Control Plans for additional Staging Details.

**DECK STAGING SECTIONS**  
GARFIELD AVENUE OVER  
CANADIAN NATIONAL RAILROAD  
CITY OF DECATUR  
MACON COUNTY  
STA. 12+59.88  
STRUCTURE NUMBER 058-6000

DATE: FEB. 2009  
DRAWN BY: MLO  
CHECKED BY: PBB