

MATCH LINE STA. 12+30.05 - (SEE SHEET 51)

- (U-18) INLET, SPECIAL, TYPE 1  
STA. 131+36.31 RT.  
TP=418.69  
F.L.=415.15 W
- (U-20) INLET, SPECIAL, TYPE 1  
STA. 133+00.30 RT.  
TP=420.26  
F.L.=416.87 W
- (W-20) INLET, SPECIAL, TYPE 1  
STA. 136+00.00 RT.  
TP=423.30  
F.L.=417.71 S
- (W-19) INLET, SPECIAL, TYPE 1  
STA. 135+72.13 RT.  
TP=423.25  
F.L.=417.57 N,W
- (W-18) INLET, SPECIAL, TYPE 1  
STA. 135+71.21 LT.  
TP=423.25  
F.L.=417.39 E,N
- (W-17) INLET, SPECIAL, TYPE 1  
STA. 136+00.00 LT.  
TP=423.30  
F.L.=417.25 S,N

F.A.U. RTE.	SECTION	COUNTY	TOTAL SHEETS	SHEET NO.
9024	07-00187-02-RP	MADISON	111	42
FED. ROAD DIST. NO. 111		ILLINOIS		FED. AID PROJECT
CONTRACT NO. 97276				

BY	DATE

MATCH LINE STA. 131+20.00

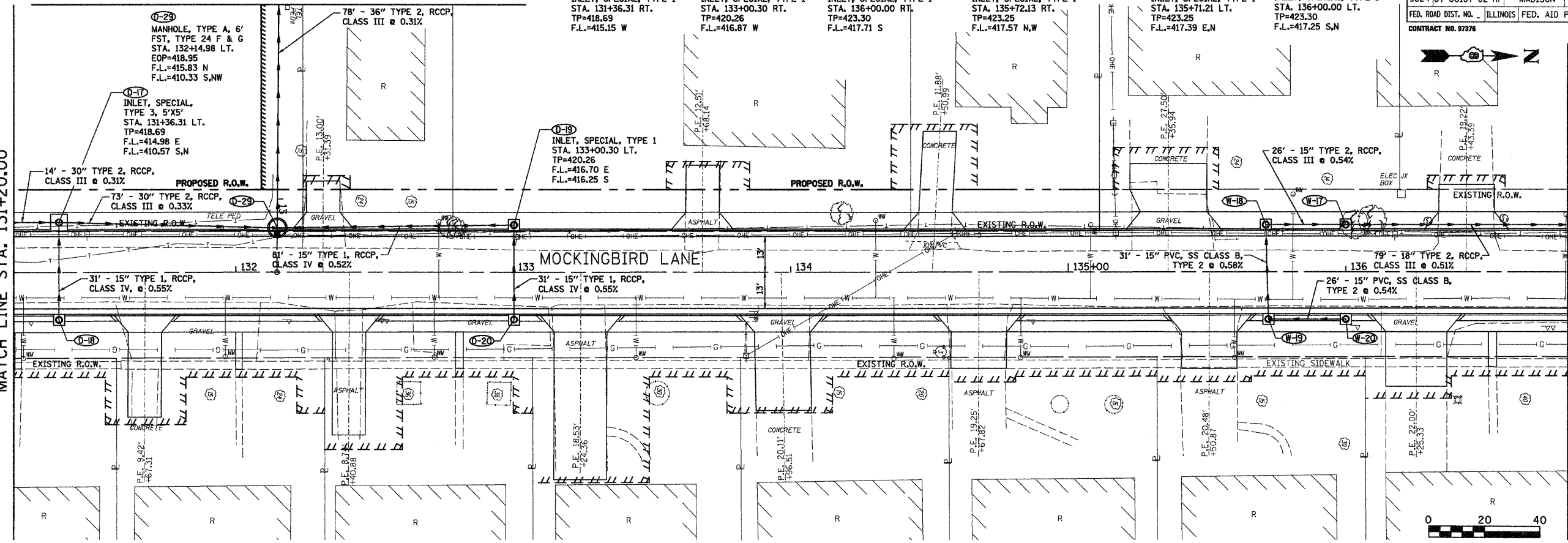

MATCH LINE STA. 136+80.00

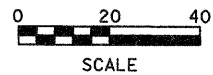

BY	DATE

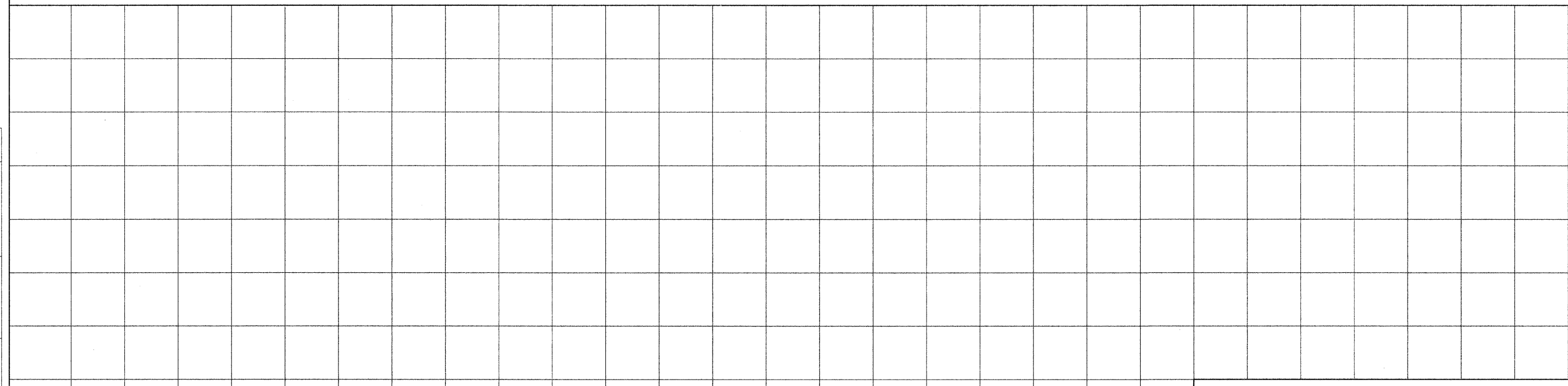

**Juneau Associates, Inc. P.C.**  
CONSULTING ENGINEERS AND LAND SURVEYORS  
2100 State Street, P.O. Box 1320 Granite City, Illinois 62040 Phone: (618) 587-4400/(618) 587-5500 Fax: (618) 452-2541  
100 North Research Drive Edwardsville, Illinois 62025 Phone: (618) 295-9900/(618) 295-9900 Fax: (618) 295-0941

**DRAINAGE PLAN**  
F.A.U. ROUTE 9024  
MOCKINGBIRD LANE  
GRANITE CITY, ILLINOIS  
SECTION NO. 07-00187-02-RP

REVISIONS			
NO.	DATE	BY	REMARKS

SCALE: 1 Inch = 20 feet	
DSN. BY: BFK	DATE: 04/03/09
DWN. BY: JDH	DATE: 04/03/09
CHK'D: BFK	DATE: 04/03/09
DWG. NO.	JOB NO. E050210 DGN. NAME: DRAIN_04 OF 111 SHTS