

F. A. U. ROUTE	SECTION	COUNTY	TOTAL SHEETS	SHEET NUMBER
9732	00-00103-00-FP	JACKSON	37	7
CITY OF CARBONDALE		PROJECT NO. M-5008(19)		
CONTRACT NO. 99182		JOB NO. C99-504-03		

FEDERAL AID PROJECT

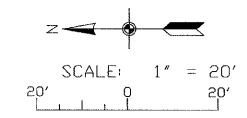

LEGEND

- - POWER POLE
- - POWER / TELEPHONE POLE
- ⊕ - POWER POLE W/ LIGHT
- - TELEPHONE POLE
- TP - TELEPHONE PEDESTAL
- - ANCHOR
- - SANITARY SEWER AND MANHOLE
- FM — - EXISTING FORCE MAIN
- FM — - PROPOSED FORCE MAIN
- CDO — - SANITARY SEWER CLEANDOUT
- S — - STORM INLET
- FH — - FIRE HYDRANT
- WV — - WATER VALVE
- WM — - WATER METER
- W — - WATER MAIN
- DE — - OVERHEAD ELECTRIC LINE
- UE — - UNDERGROUND ELECTRIC LINE
- DT — - OVERHEAD TELEPHONE LINE
- UT — - UNDERGROUND TELEPHONE LINE
- UG — - UNDERGROUND GAS LINE
- CATV — - CABLE TELEVISION
- - - - - FENCE
- - - - - TREELINE
- RCP — - REINFORCED CONCRETE PIPE
- CMP — - CORRUGATED METAL PIPE CULVERT
- CPVC — - CORRUGATED PLASTIC PIPE CULVERT
- TC — - TOP OF CASTING - TOP OF CURB
- FL — - FLOW LINE
- PL — - PROPERTY LINE
- - - - - EXISTING RIGHT-OF-WAY
- - - - - TEMPORARY CONSTRUCTION EASEMENT AND CONSTRUCTION LIMITS
- ×400.00 - PROPOSED SPOT ELEVATION
- - - - - PROPOSED BITUMINOUS CONCRETE PAVEMENT
- - - - - EXISTING SURFACE

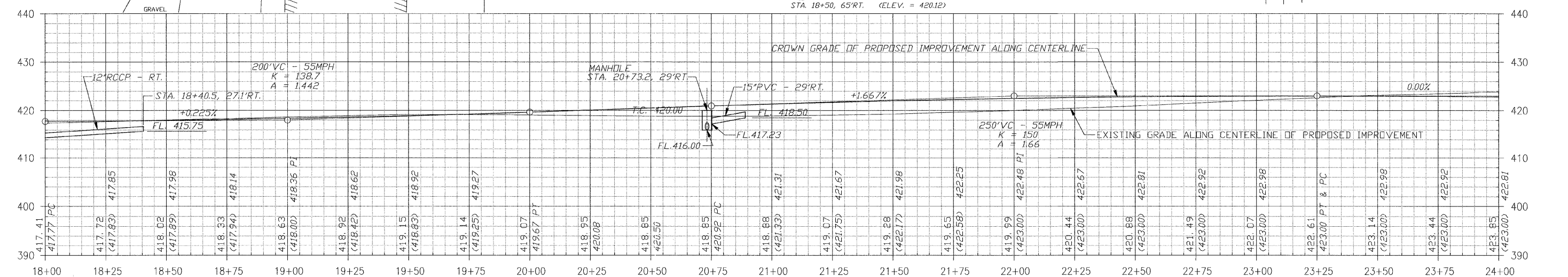
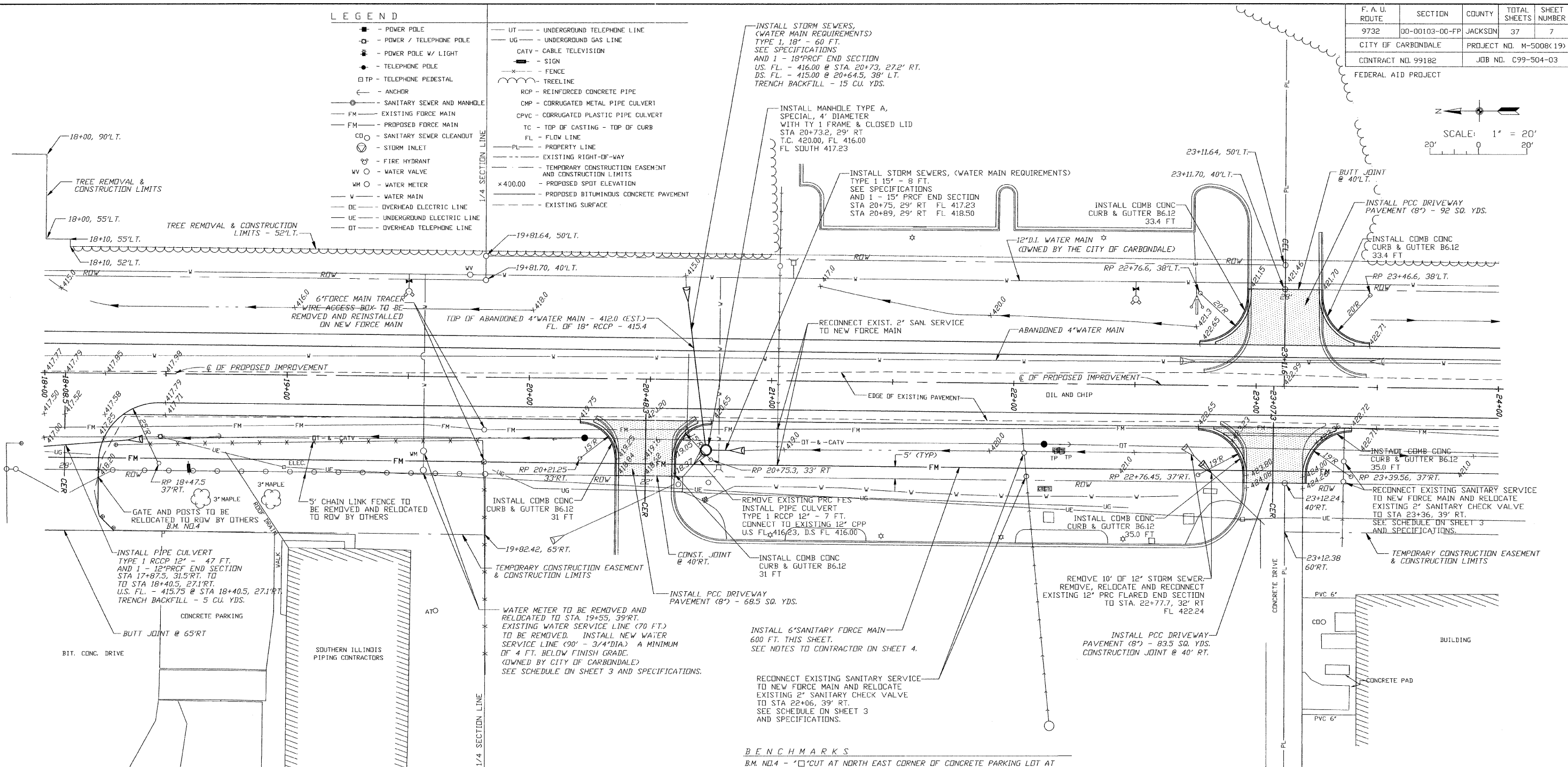

BENCHMARKS
 B.M. N14 - 'C' CUT AT NORTH EAST CORNER OF CONCRETE PARKING LOT AT STA. 18+50, 65' RT. (ELEV. = 420.12)

CIP NO. ST0102 - REED STATION ROAD
PLAN AND PROFILE
STA. 18+00 TO STA. 24+00