

F. A. U. ROUTE	SECTION	COUNTY	TOTAL SHEETS	SHEET NUMBER
9732	00-00103-00-FP	JACKSON	37	11
CITY OF CARBONDALE		PROJECT NO. M-5008(19)		
CONTRACT NO. 99182		JOB NO. C99-504-03		
FEDERAL AID PROJECT				

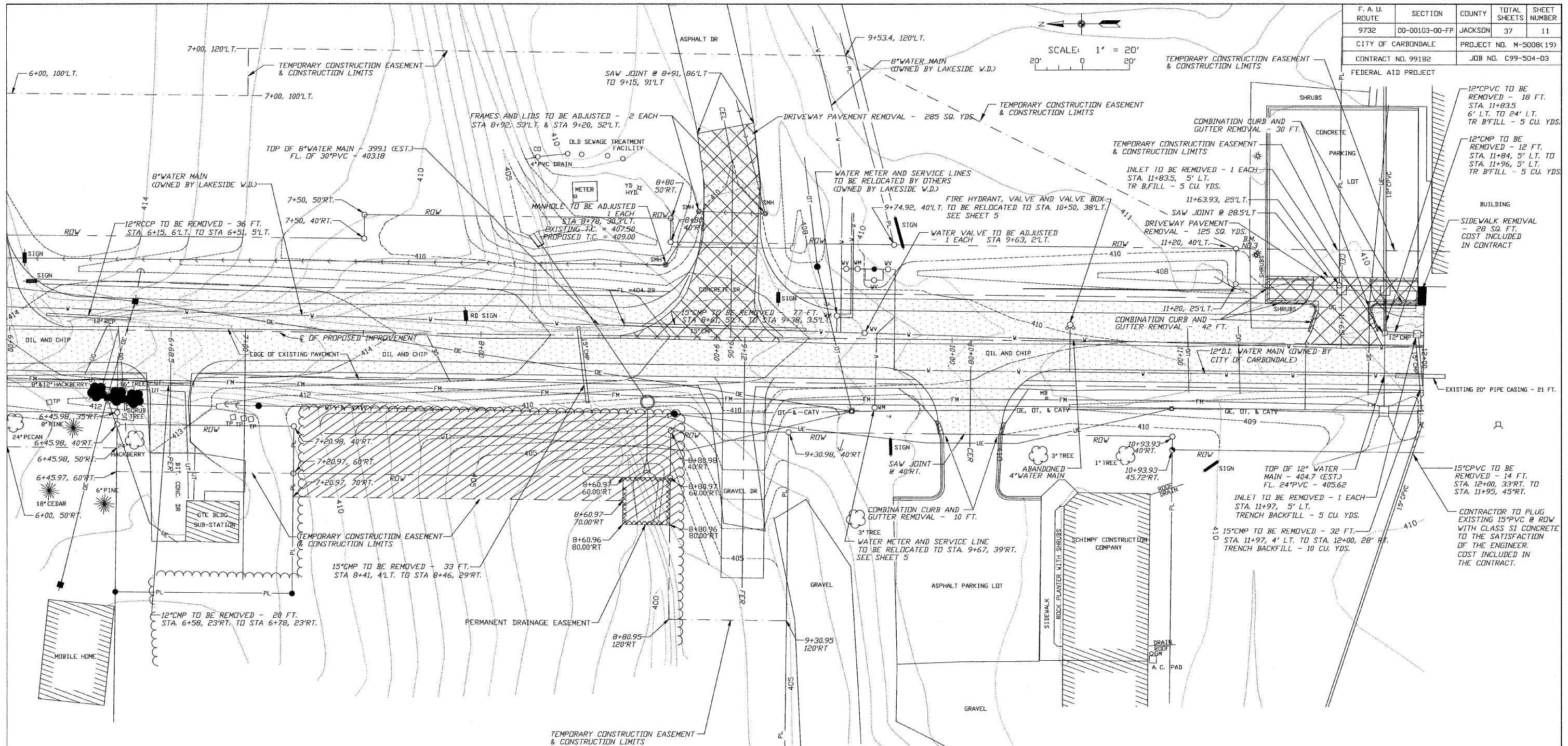
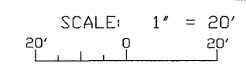

LEGEND

■ - POWER POLE	--- - FENCE
□ - POWER / TELEPHONE POLE	--- - TREELINE
⊕ - POWER POLE W/ LIGHT	--- - RCP - REINFORCED CONCRETE PIPE
● - TELEPHONE POLE	--- - CMP - CORRUGATED METAL PIPE CULVERT
□ TP - TELEPHONE PEDESTAL	--- - CPVC - CORRUGATED PLASTIC PIPE CULVERT
⊕ - ANCHOR	--- - TC - TOP OF CASTING - TOP OF CURB
○ - SANITARY SEWER AND MANHOLE	--- - FL - FLOW LINE
FM - FORCE MAIN	--- - PL - PROPERTY LINE
CO - SANITARY SEWER CLEANDUT	--- - EXISTING RIGHT-OF-WAY
⊕ - STORM INLET	--- - TEMPORARY CONSTRUCTION EASEMENT AND CONSTRUCTION LIMITS
⊕ - FIRE HYDRANT	--- - EXISTING CONTOUR
⊕ - WATER VALVE	--- - PROPOSED CONTOUR
WM - WATER METER	--- - TREE REMOVAL, ACRES
W - WATER MAIN	--- - TREE REMOVAL, UNITS
DE - OVERHEAD ELECTRIC LINE	--- - DRIVEWAY PAVEMENT REMOVAL
UE - UNDERGROUND ELECTRIC LINE	--- - PROPOSED BITUMINOUS CONCRETE PAVEMENT
OT - OVERHEAD TELEPHONE LINE	--- - PROPOSED EARTH SHOULDER
UT - UNDERGROUND TELEPHONE LINE	--- - PROPOSED AGGREGATE SURFACE
UG - UNDERGROUND GAS LINE	
CATV - CABLE TELEVISION	
■ - SIGN	

BENCHMARKS
 B.M. NO.3 - 1" CUT ON NORTH SIDE OF CONCRETE BASE TO LIGHT POLE AT STA. 11+30, 40'L.T. (ELEV. = 412.09)

CIP NO. ST0102 - REED STATION ROAD
GRADING AND ITEM REMOVAL PLAN
STA. 6+00 TO STA. 12+00