

FAS	SECTION	COUNTY	TOTAL SHEETS	SHEET NO.
881	05-00094-00-FP	HAMILTON	32	8
FED. ROAD DIST. NO. 9 ILLINOIS		CORNERVILLE ROAD		
PROJECT # RS-881(1)G		CONTRACT # 99340		
LEC JOB # H061022HM				

323 W. 3RD ST.  
P.O. BOX 160  
MT. CARMEL, IL  
62863  
PHONE:  
(618)-262-8651  
FAX:  
(618)-263-3327

405 W. STATE ST.  
SUITE 1  
PRINCETON, IN  
47670  
PHONE:  
(812)-386-7611  
FAX:  
(812)-385-2812



PROFESSIONAL DESIGN FIRM  
LAND SURVEY & PROFESSIONAL ENGINEERING CORPORATION  
184-000887  
(62-032435)(35-002769)



AARON M. MEFFORD  
NAME  
*[Signature]*  
SIGNATURE  
3-17-09  
DATE  
11-30-09  
EXPIRES

F.A.S. 881 (CH 6)  
CORNERVILLE ROAD  
SECTION 05-00094-00-FP  
HAMILTON COUNTY, ILLINOIS

SHEET TITLE:

PLAN & PROFILE

SCALE:	VARES
BY:	AMM
DATE:	3/7/09
REV:	

8 OF 32 SHEETS

SHEET NO.  
8

P.I. STA= 26+00.00  
Δ= 00°15'42" LT

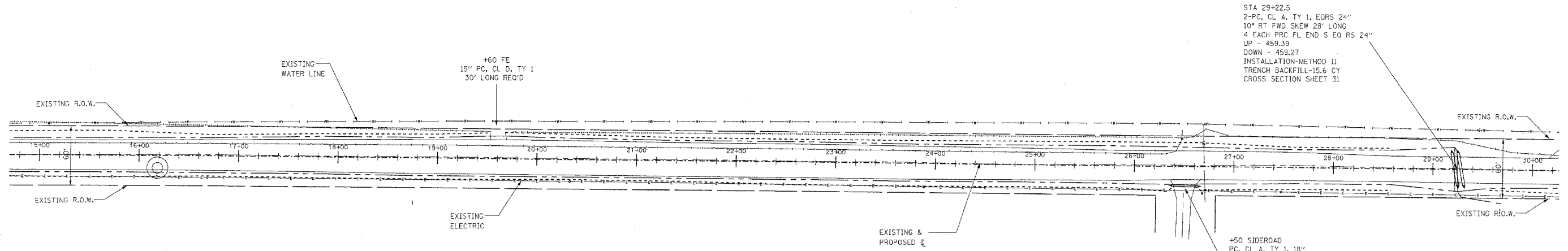

STA 29+22.5  
2-PC, CL A, TY 1, EORS 24"  
10° RT FWD SKEW 28' LONG  
4 EACH PRC FL END S EQ RS 24"  
UP - 459.39  
DOWN - 459.27  
INSTALLATION-METHOD II  
TRENCH BACKFILL-15.6 CY  
CROSS SECTION SHEET 31

+50 SIDEROAD  
PC, CL A, TY 1, 18"  
0° SKEW 24' LONG  
2 EACH PRC FL END S 18"  
UP - 462.85  
DOWN - 462.75  
INSTALLATION-METHOD II  
TRENCH BACKFILL- CY  
CROSS SECTION SHEET 32

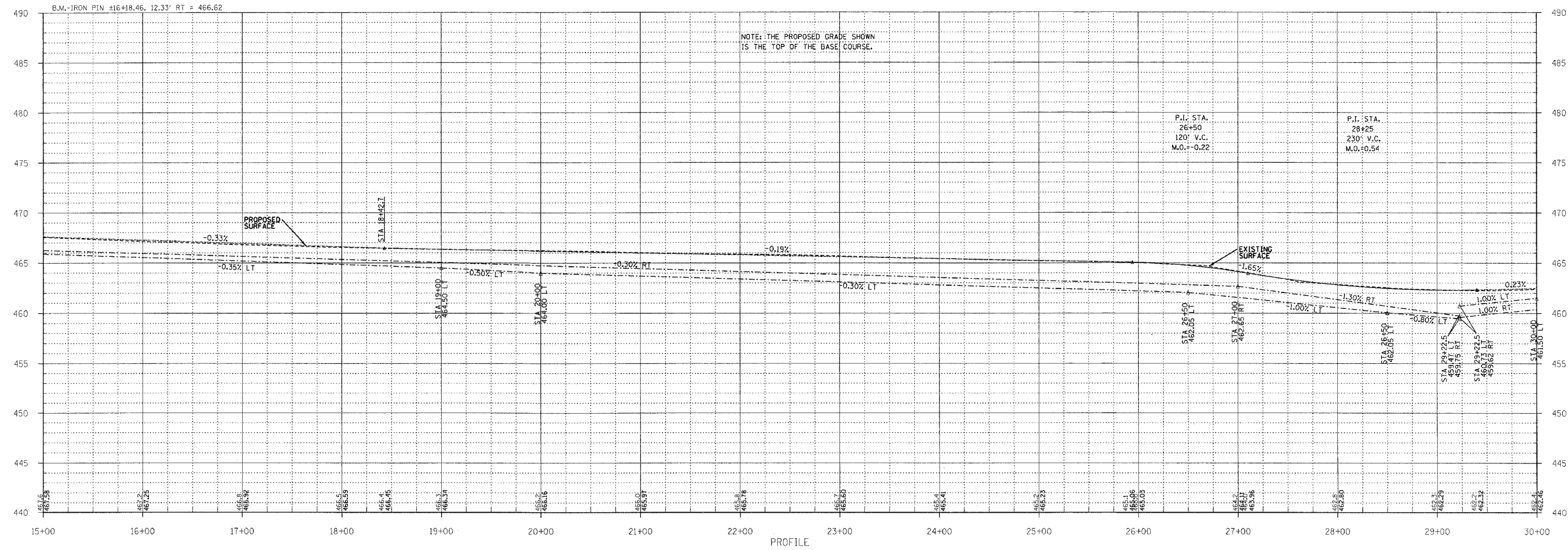

PROFILE