

FAS	SECTION	COUNTY	TOTAL SHEETS	SHEET NO.
BB1	05-00094-00-FP	HAMILTON	32	9
FED. ROAD DIST. NO. 9 ILLINOIS		CORNERVILLE ROAD		323 W. 3RD ST. P.O. BOX 160 MT. CARMEL, IL 62863
PROJECT # RS-88101G1		CONTRACT # 49340		PHONE: (618)-262-8661 FAX: (618)-263-3327
LEC JOB # H051022HM				

P.I. STA= 32+00.00
Δ= 00°11'14" LT

P.I. STA= 40+00.00
Δ= 00°06'22" RT

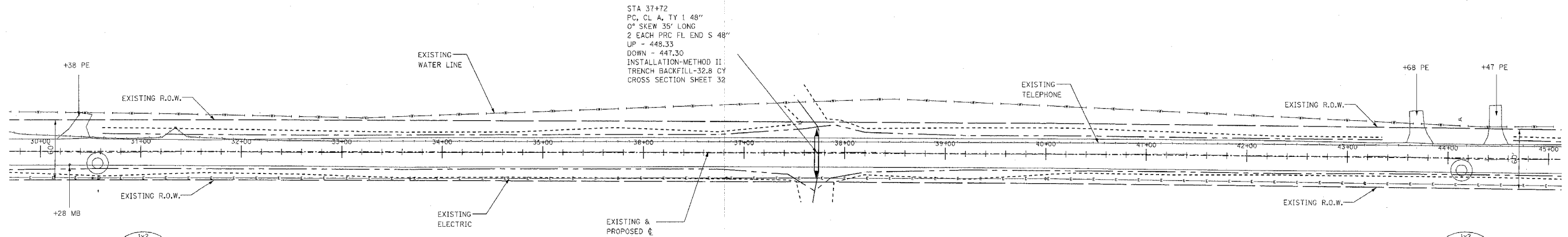

PROFESSIONAL DESIGN FIRM
LAND SURVEY & PROFESSIONAL ENGINEERING CORPORATION
184-000887
(62-032435)(35-002769)

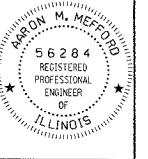

AARON M. MEFFORD
NAME
Aaron Mefford
SIGNATURE
3-17-09
DATE
11-30-09
EXPIRES

F.A.S. 881 (CH 6)
CORNERVILLE ROAD
SECTION 05-00094-00-FP
HAMILTON COUNTY, ILLINOIS

SHEET TITLE:

PLAN & PROFILE

SCALE	VARIES
BY:	AMM
DATE:	2/10/09
REV:	

9 OF 32
SHEETS

SHEET NO.
9

