

4+50

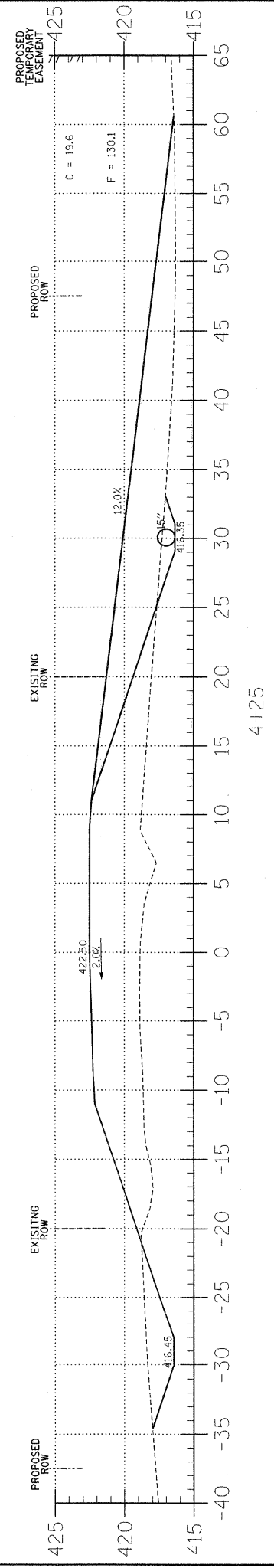

4+25

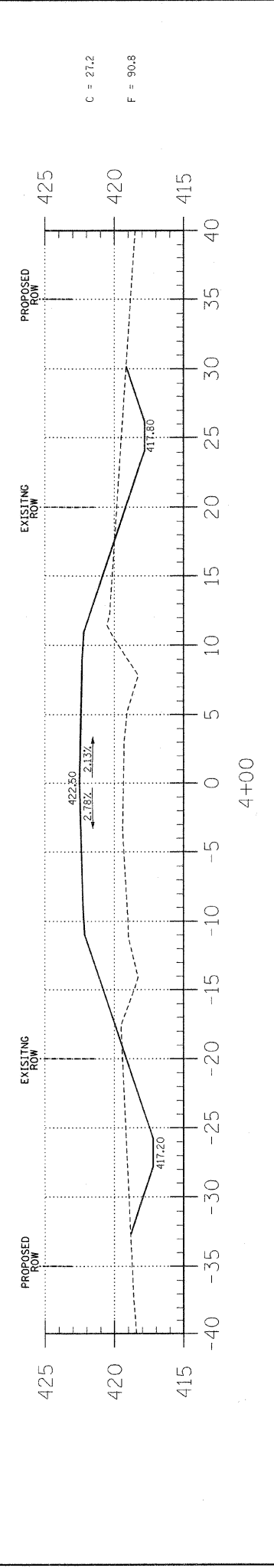

4+00

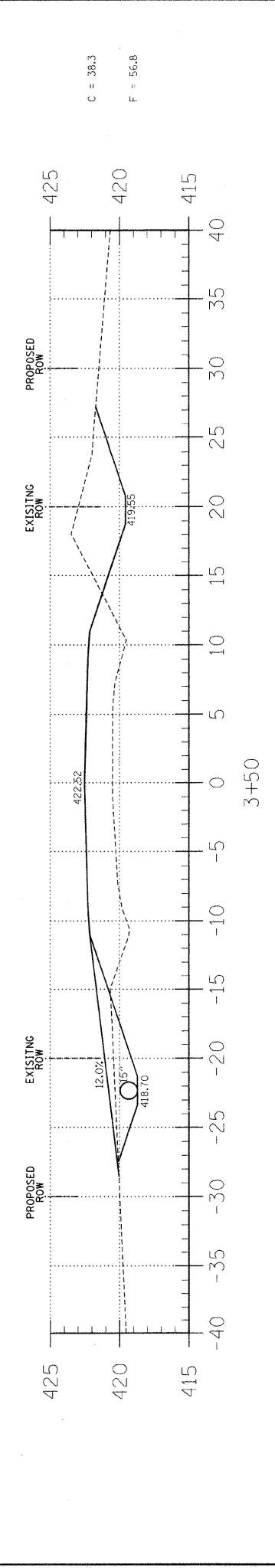

3+50

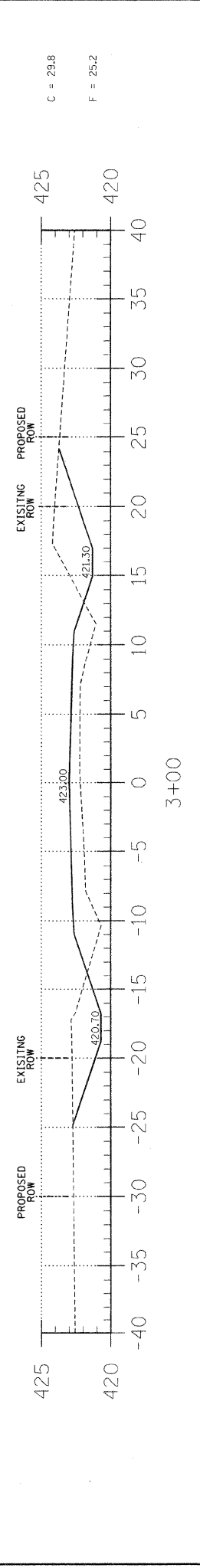

3+00

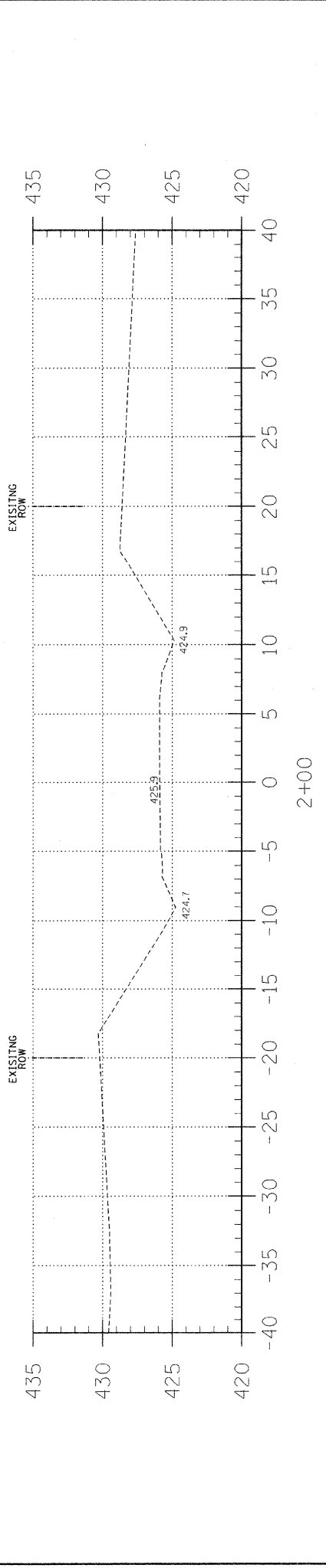

2+00

EARTHWORK SCHEDULE

LOCATION	EARTH EXCAVATION	CHANNEL EXCAVATION	ESTIMATED UNSUITABLE MATERIAL	SUITABLE MATERIAL ADJUSTED FOR SHRINKAGE	EMBANKMENT	EARTHWORK BALANCE WASTE (+) OR SHORTAGE (-)
	CUBIC YARD	CUBIC YARD	CUBIC YARD	CUBIC YARD	CUBIC YARD	CUBIC YARD
STA 0+00 TO 4+59.3	256.1	0.0	0.0	192.1	487.0	-294.9
STA 4+59.3 TO 5+40.7	0.0	333.1	166.5	124.9	0.0	124.9
STA 5+40.7 TO 10+00	196.0	0.0	0.0	147.0	2309.1	-2162.1
2 FIELD ENTRANCES	0.0	0.0	0.0	0.0	127.7	-127.1
TOTAL	452.1	333.1	166.5	464.0	2923.8	-2459.8

T.R.	SECTION	COUNTY	TOTAL SHEETS	SHEET NO.
200	07-08126-00-BR	HAMILTON	13	3

323 W. 3RD ST.
PO BOX 150
MT. CARMEL, IL
62863
PHONE:
(618)-262-8661
FAX:
(618)-263-3327

405 W. STATE ST.
SUITE
PRINCETON, IN
47670
PHONE:
(812)-386-7611
FAX:
(812)-385-2812



PROFESSIONAL DESIGN FIRM
LAND SURVEY &
PROFESSIONAL ENGINEERING CORPORATION
184-00887
(62-032435)(35-002768)



AARON M. MEFFORD
NAME
Aaron Mefford
SIGNATURE
1-20-09
DATE
11-30-08
EXPIRES

TOWNSHIP ROUTE 200
OVER TEN MILE CREEK
HAMILTON COUNTY, ILLINOIS

SHEET TITLE:
CROSS-SECTIONS
SCALE: 1" = 5'
BY: AMM
DATE: 12/08
REV:
3 OF 13 SHEETS
SHEET NO. 3