

NOTE: ELEVATIONS PROVIDED AT LOCATIONS THAT MATCH EXISTING PAVEMENTS OR BUILDING FLOORS ARE FOR REFERENCE ONLY. THE CONTRACTOR SHALL CONSTRUCT THE PROPOSED JOINTS FLUSH WITH EXISTING OR AS DETAILED. CONTRACTOR IS RESPONSIBLE FOR VERIFYING EXISTING ELEVATIONS AT MATCH POINTS.

LEGEND

- EXISTING BUILDINGS
- EXISTING PAVEMENT
- PROPOSED PAVEMENT
- PROPOSED SPOT ELEVATION

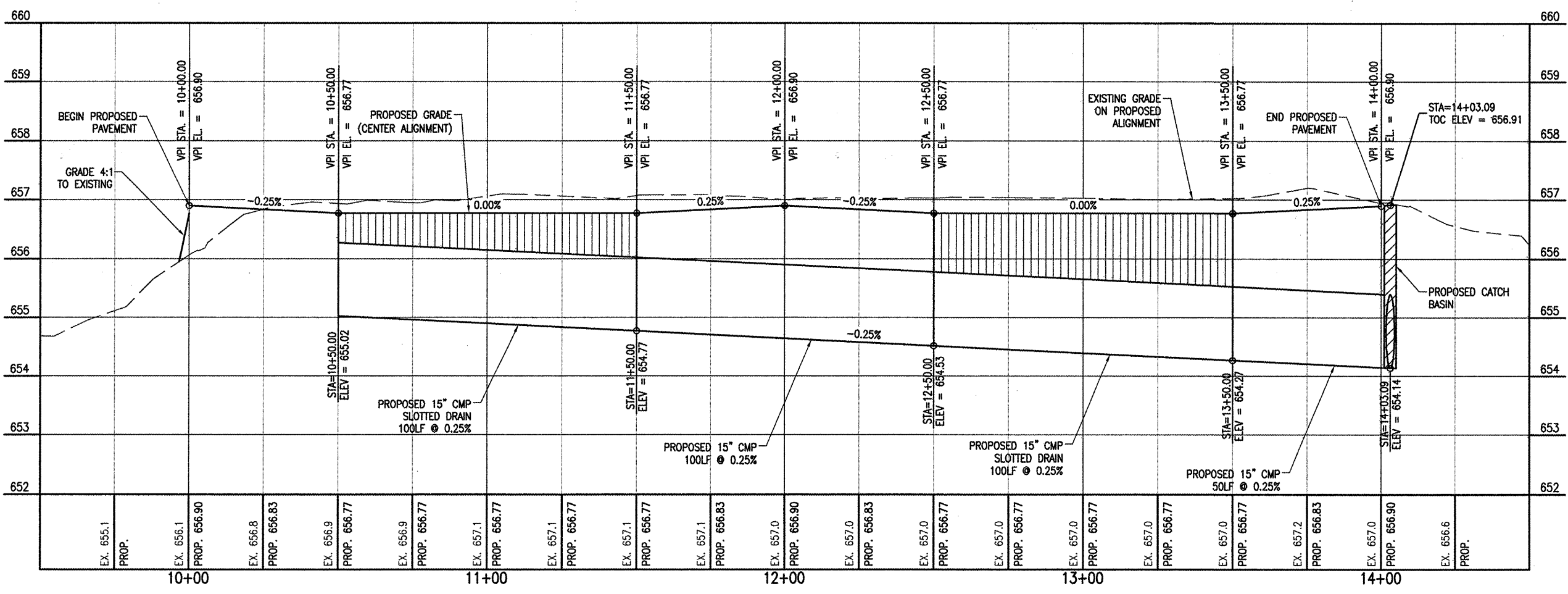
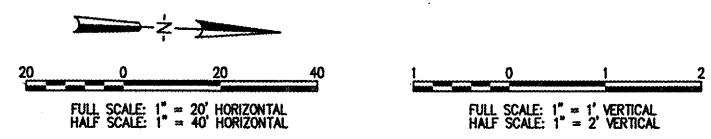

DATE	REVISION	BY

EDGAR COUNTY AIRPORT
PARIS, ILLINOIS

IL PROJ.: PRG-3889 A.I.P. PROJ.: 3-17-0077-811

REL. Project No. 0840209_0800	FILED
Filename: Z02PNC.DWG	Scale: 1"=20'H, 1"=1'V
Date: 04/17/09	DATE
LAYOUT	DAK 03/05/09
DRAWN	DAK 03/06/09
REVIEWED	JOW 03/18/09

HANSON
 Copyright Hanson Professional Services Inc. 2009
 Hanson Professional Services Inc.
 1525 South Sixth Street
 Springfield, Illinois 62703-2886
 www.hanson-inc.com
 Offices Nationwide

REMOVE AND RECONSTRUCT
T-HANGAR TAXIWAYS
 PROPOSED
PLAN AND PROFILE
CENTER ALIGNMENT

APR 13, 2009 5:05 PM HARR01115
 I:\0840209\0840209_PRG CAD\AIRPORT\PROJECT\Z02PNC.DWG