

CONSTRUCTION PLANS
 FOR
PINCKNEYVILLE-DUQUOIN AIRPORT
 PERRY COUNTY, ILLINOIS

ILLINOIS PROJECT PJY-3373
 A. I. P. PROJECT 3-17-0037-B6

CONSTRUCTION OF SITEWORK FOR A 10 UNIT T-HANGAR
 INCLUDING T-HANGAR TAXIWAYS; CONSTRUCTION OF PARKING
 LOT EXTENSION INCLUDING DRAINAGE AND PAVEMENT MARKING

APRIL 17, 2009

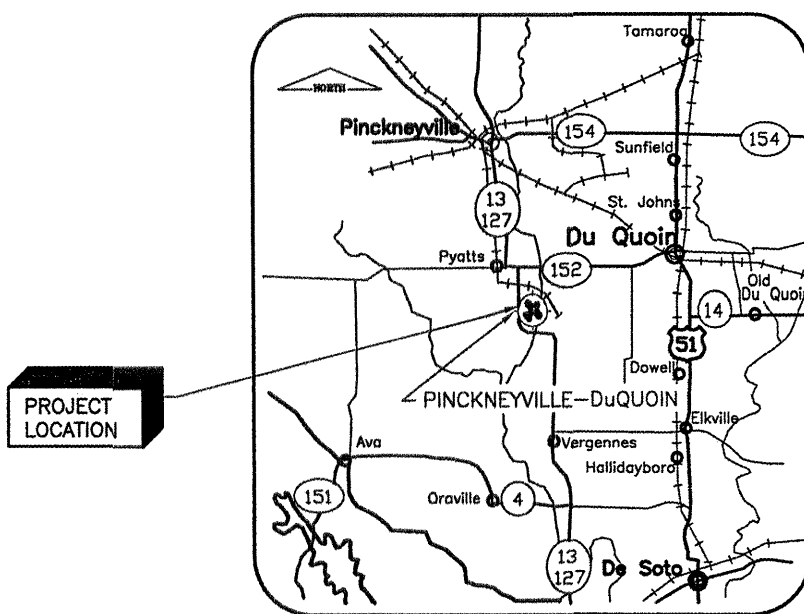

LOCATION MAP

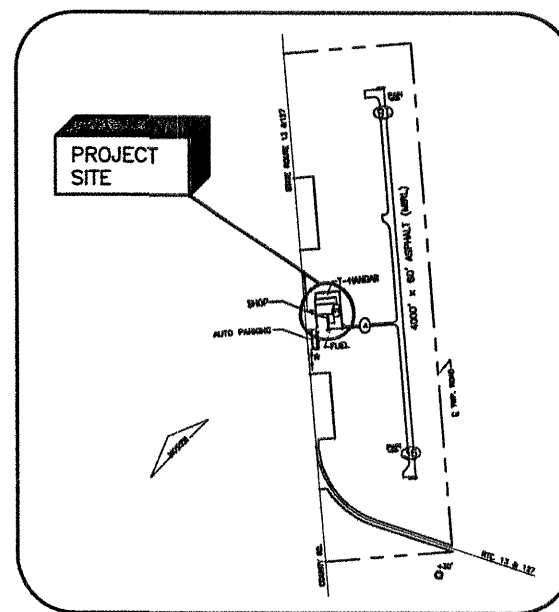

SITE PLAN



Handwritten signature and date:
 4-17-09
 EXP 11/30/09

GEOMETRIC DESIGN DATA	
DESIGN GROUP - 1	
WING SPAN - UP TO 33.3 FEET	
DESIGN APPROACH CATEGORY - A	
STRUCTURAL DESIGN DATA	
AIRCRAFT GROSS WEIGHT - 12,500 LBS.	
SINGLE WHEEL AIRCRAFT	

CALL J.U.L.I.E. BEFORE EXCAVATING 1-800-892-0123 PINCKNEYVILLE-DUQUOIN AIRPORT	
TOWNSHIP: 6 SOUTH	
RANGE: 2 WEST	
COUNTY: PERRY	
TOWNSHIP: PINCKNEYVILLE	
LOCATION: (7) MILES SOUTH OF PINCKNEYVILLE	
SECTION EAST SIDE OF ILLINOIS ROUTES 13 & 127	

UNICOM FREQUENCY 122.8

MAXIMUM EQUIPMENT HEIGHT
 35 FEET

PINCKNEYVILLE-DUQUOIN AIRPORT
 AIRPORT COMMITTEE
 PERRY COUNTY, ILLINOIS
 APPROVED *[Signature]*
 AIRPORT BOARD MEMBER
 DATE 4/16/2009

CMT
 CRAWFORD MURPHY & TILLY, INC.
 CONSULTING ENGINEERS
 ■ SPRINGFIELD, IL ■ AURORA, IL ■ ST. LOUIS, MO
 SUBMITTED BY *[Signature]*
 DATE 4/17/09
 CMT JOB NUMBER 07062-03-00