

EARTHWORK SUMMARY

T-HANGAR SITEWORK		
STATION	EXCAVATE END AREA (S.F.)	EMBANK END AREA (S.F.)
9+83.97	15.87	90.23
10+00	21.93	91.61
10+50	25.51	87.50
11+00	26.29	128.57
11+50	24.02	169.15
12+00	21.76	228.42
12+54.97	8.83	210.75
13+00	0.00	0.00

ENTRANCE ROAD		
STATION	EXCAVATE END AREA (S.F.)	EMBANK END AREA (S.F.)
3+48	4.04	21.20
4+00	2.87	39.90
4+50	0.38	52.30
5+00	0.00	37.77
5+58	2.27	12.64
6+00	3.96	10.12

NOTES:

- TURFING LIMITS SHOWN ARE APPROXIMATE. ACTUAL TURFING LIMITS SHALL BE DETERMINED BY THE RESIDENT ENGINEER.
- AN ADDITIONAL 2000 SY OF EXCELSIOR BLANKET HAS BEEN INCLUDED IN THE QUANTITIES FOR ADDITIONAL DISTURBED AREAS AS REQUIRED BY THE ENGINEER.
- RESTORATION AND TURFING OF DISTURBED AREAS BEYOND THE LIMITS SHOWN (SUCH AS EDGE LIGHTING, CABLING, SIGNAGE, ACCESS, STAGING, ETC.) SHALL BE INCIDENTAL TO THE PROJECT.

LEGEND

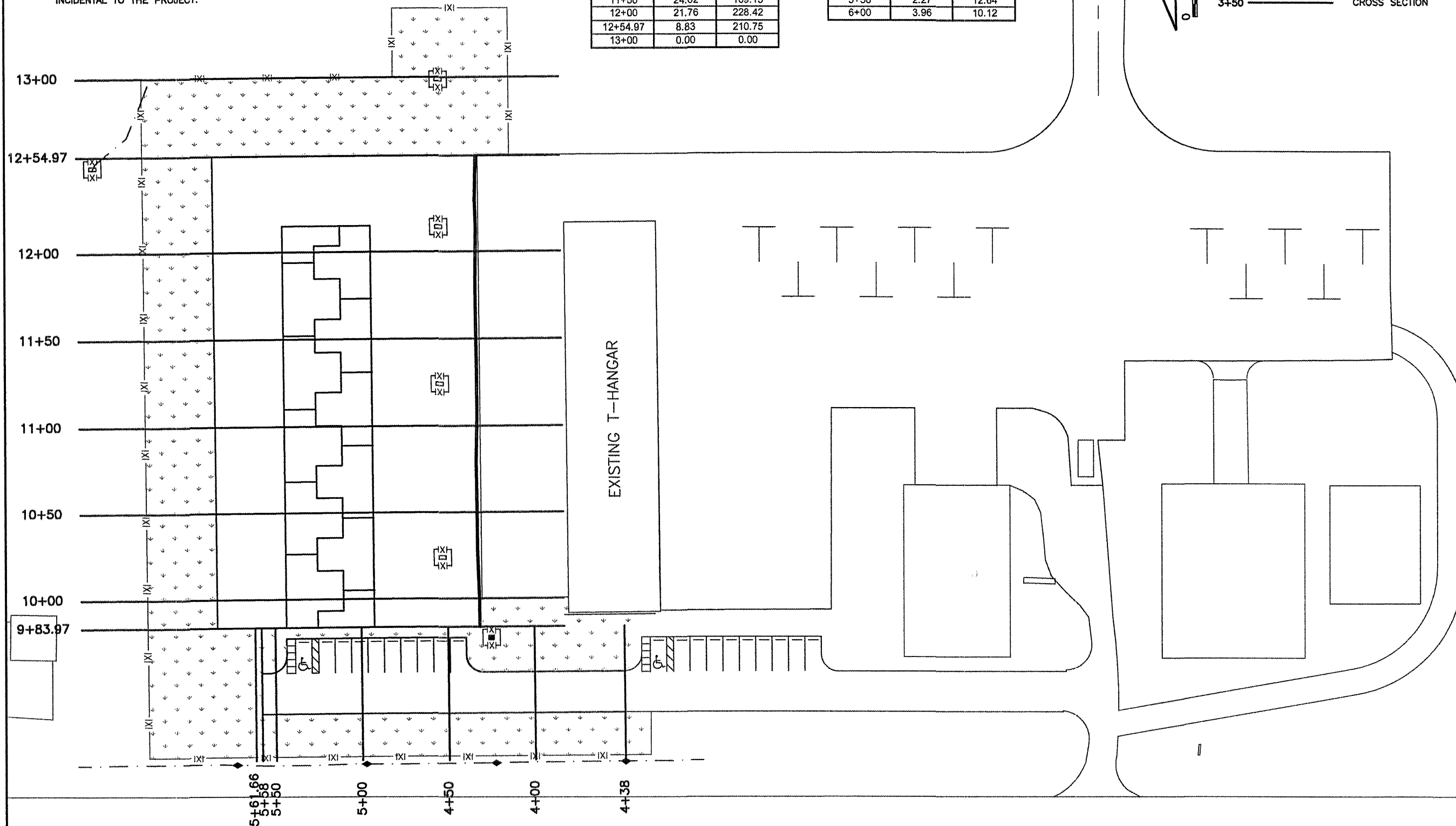
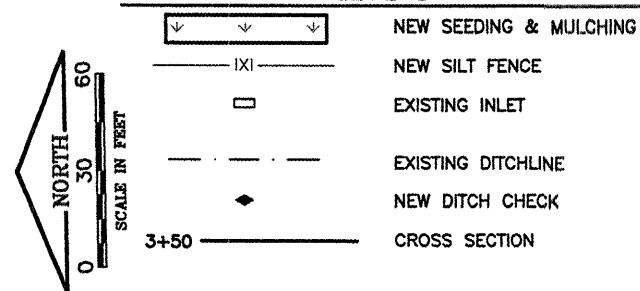

K:\Pinckneyville\AP\0706203 SITE WORK HGR\Draw\Site
 FILE: EROS01.dwg
 UPDATE BY: Dale Draughan
 PLOT DATE: 4/17/2009 1:45 PM
 PROJ - GEO
 BASE - EXISTOPO
 ALP1A
 TOP01A
 ALP3A
 BASE_PROPTURF
 BASE_PROPDRAIN

REVISIONS

NUMBER	BY	DATE

0 1 2
 THIS BAR IS EQUAL TO 2' AT FULL SCALE (34x22).

PINCKNEYVILLE-DUQUOIN AIRPORT
 PERRY COUNTY, ILLINOIS
 T-HANGAR SITE WORK
 EROSION CONTROL PLAN
 &
 EARTHWORK SUMMARY

© Copyright CMT, Inc.
CMT
 CRAWFORD, MURPHY & TILLY, INC.
 CONSULTING ENGINEERS
 License No. BA-000813

DESIGN BY: KLB
 DRAWN BY: CMT
 CHECKED BY: JEF
 APPROVED BY: JEF
 DATE: 4/17/2009
 JOB No: 07062-03-00
 IL PROJECT NO. PJY-3373
 A.I.P. PROJECT NO. 3-17-0037-B6
 SHEET 14 OF 17 SHEETS