

CONSTRUCTION PLANS
 FOR
PINCKNEYVILLE-DUQUOIN AIRPORT
 PERRY COUNTY, ILLINOIS

ILLINOIS PROJECT PJY-3373
 A. I. P. PROJECT 3-17-0037-B6

CONSTRUCTION OF SITEWORK FOR A 10 UNIT T-HANGAR
 INCLUDING T-HANGAR TAXIWAYS; CONSTRUCTION OF PARKING
 LOT EXTENSION INCLUDING DRAINAGE AND PAVEMENT MARKING

APRIL 17, 2009

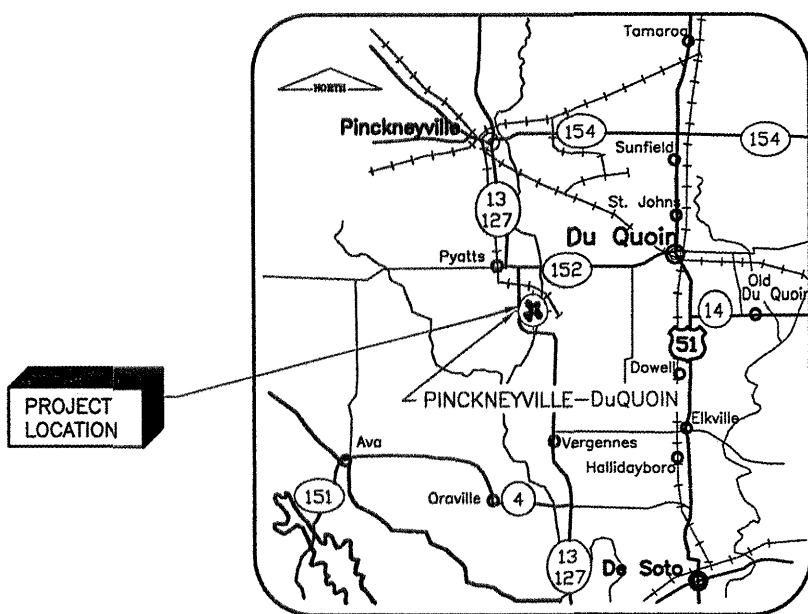

LOCATION MAP

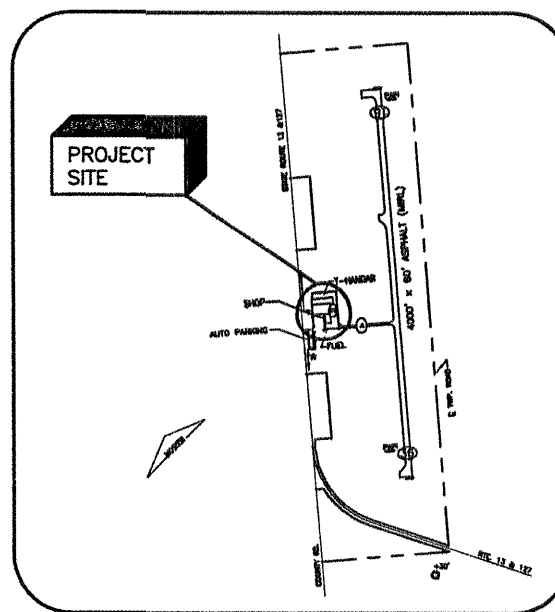

SITE PLAN



J. E. Frank
 EXP 11/30/09

GEOMETRIC DESIGN DATA	
DESIGN GROUP - 1	
WING SPAN - UP TO 33.3 FEET	
DESIGN APPROACH CATEGORY - A	
STRUCTURAL DESIGN DATA	
AIRCRAFT GROSS WEIGHT - 12,500 LBS.	
SINGLE WHEEL AIRCRAFT	

CALL J.U.L.I.E. BEFORE EXCAVATING 1-800-892-0123 PINCKNEYVILLE-DUQUOIN AIRPORT	
TOWNSHIP: 6 SOUTH	
RANGE: 2 WEST	
COUNTY: PERRY	
TOWNSHIP: PINCKNEYVILLE	
LOCATION: (7) MILES SOUTH OF PINCKNEYVILLE	
SECTION EAST SIDE OF ILLINOIS ROUTES 13 & 127	

UNICOM FREQUENCY 122.8

MAXIMUM EQUIPMENT HEIGHT
 35 FEET

PINCKNEYVILLE-DUQUOIN AIRPORT
 AIRPORT COMMITTEE
 PERRY COUNTY, ILLINOIS
 APPROVED *[Signature]*
 AIRPORT BOARD MEMBER
 DATE 4/16/2009

CMT
CRAWFORD MURPHY & TILLY, INC.
 CONSULTING ENGINEERS
 ■ SPRINGFIELD, IL ■ AURORA, IL ■ ST. LOUIS, MO
 SUBMITTED BY *[Signature]*
 DATE 4/17/09
 CMT JOB NUMBER 07062-03-00

REVISIONS		
NUMBER	BY	DATE

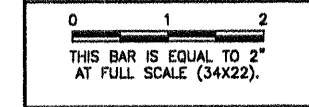

PINCKNEYVILLE-DUQUOIN AIRPORT
PERRY COUNTY, ILLINOIS
T-HANGAR SITE WORK
INDEX TO SHEETS AND SUMMARY OF QUANTITIES

© Copyright CMT, Inc.



CMT
 CRAWFORD, MURPHY & TILLY, INC.
 CONSULTING ENGINEERS
 License No. 84-000613

DESIGN BY: TJH/KLB
 DRAWN BY: CMT
 CHECKED BY: JEF
 APPROVED BY: JEF
 DATE: 4/17/2009
 JOB No: 07062-03-00
 IL PROJECT NO. PJY-3373
 A.I.P. PROJECT NO. 3-17-0037-B6
 SHEET 02 OF 17 SHEETS

INDEX TO SHEETS	
SHEET	TITLE
01	COVER SHEET
02	INDEX TO SHEETS AND SUMMARY OF QUANTITIES
03	SITE PLAN
04	SEQUENCE OF CONSTRUCTION
05	EXISTING CONDITIONS & REMOVALS
06	PROPOSED IMPROVEMENTS
07	TYPICAL SECTIONS
08	STAKING & GRADING PLAN
09	DRAINAGE PLAN
10	DRAINAGE DETAILS
11	MARKING PLAN & DETAILS
12	FENCING PLAN
13	FENCING DETAILS
14	EROSION CONTROL & EARTHWORK SUMMARY
15	EROSION CONTROL DETAILS
16	T-HANGAR CROSS SECTIONS STA. 9+83.97 TO STA. 13+00
17	ENTRANCE ROAD CROSS SECTIONS STA. 3+48 TO STA. 5+61.66

SUMMARY OF QUANTITIES					
ITEM NO.	ITEM DESCRIPTION	UNIT	FEDERAL/STATE/ LOCAL	STATE/LOCAL	TOTAL PROJECT
AR150510	ENGINEER'S FIELD OFFICE	L.S.	1	0	1
AR152442	OFFSITE BORROW EXCAVATION	C.Y.	1740	310	2050
AR155540	BY-PRODUCT LIME	TON	80	0	80
AR155612	SOIL PROCESSING-12"	S.Y.	3250	0	3250
AR156510	SILT FENCE	L.F.	800	400	1200
AR156511	DITCH CHECK	EACH	0	4	4
AR162504	CLASS E FENCE 4'	L.F.	170	0	170
AR162604	CLASS E GATE-4'	EACH	1	0	1
AR162620	CLASS E GATE-20'	EACH	1	0	1
AR162900	REMOVE CLASS E FENCE	L.F.	245	0	245
AR162910	REMOVE CLASS E GATE	EACH	1	0	1
AR209510	CRUSHED AGGREGATE BASE COURSE	TON	1500	390	1890
AR401610	BITUMINOUS SURFACE COURSE	TON	770	190	960
AR602510	BITUMINOUS PRIME COAT	GAL.	1335	330	1665
AR603510	BITUMINOUS TACK COAT	GAL.	250	65	315
AR620510	PAVEMENT MARKING	S.F.	0	205	205
AR701512	12" RCP, CLASS IV	L.F.	0	55	55
AR751410	INLET	EACH	0	1	1
AR751940	ADJUST INLET	EACH	2	0	2
AR800223	RELOCATE SANITARY SEPTIC FIELD	L.S.	1	0	1
AR901510	SEEDING	ACRE	0.7	0.3	1
AR908510	MULCHING	ACRE	0.7	0.3	1
AR908520	EXCELSIOR BLANKET	S.Y.	2000	0	2000
AR910230	HANDICAP SIGN	EACH	0	1	1
AR910410	PARKING BLOCK	EACH	0	10	10

GENERAL NOTES

- 1.) ALL RUNWAYS, TAXIWAYS AND APRONS SHALL BE KEPT OPEN TO AIRCRAFT TRAFFIC DURING CONSTRUCTION EXCEPT AS NOTED IN THE CONSTRUCTION ACTIVITY PLANS OR AS DIRECTED BY THE AIRPORT MANAGER.
- 2.) ALL CONSTRUCTION TRAFFIC OPERATING ON OR CROSSING ACTIVE RUNWAYS, TAXIWAYS AND APRONS SHALL BE UNDER CONTROL OF A FLAGMAN IN RADIO CONTACT WITH OTHER AIRCRAFT OPERATING NEAR THE AIRPORT BY MONITORING UNICOM FREQUENCY AT ALL TIMES. THE CONTRACTOR SHALL PROVIDE HIS OWN RADIOS.
- 3.) WHEN CONFLICTS ARISE BETWEEN CONSTRUCTION ACTIVITIES AND AIRCRAFT OPERATIONS AND SAFETY, AIRCRAFT OPERATIONS AND SAFETY SHALL TAKE PRECEDENCE AND SHALL GOVERN. FINAL AUTHORITY IN THE APPROVAL OF CLOSING AND OPENING PAVEMENTS AND CONSTRUCTION SEQUENCING LIES WITH THE AIRPORT MANAGER.
- 4.) THE CONTRACTOR SHALL STORE EQUIPMENT AND MATERIALS AT THE LOCATION SHOWN FOR THE CONTRACTOR'S STAGING, STORAGE LAND, PARKING SITE.
- 5.) BROKEN OR WASTE CONCRETE SHALL BE DISPOSED OF BY THE CONTRACTOR OFF AIRPORT PROPERTY, UNLESS DIRECTED BY THE AIRPORT MANAGER.
- 6.) VEHICLES AND EQUIPMENT SHALL NOT BE ALLOWED WITHIN AREAS 80' FROM THE CENTERLINE OF ACTIVE TAXIWAYS OR 200' FROM THE CENTERLINE OF ACTIVE RUNWAYS.
- 7.) ALL PAVEMENTS, DRIVES AND OTHER AREAS USED BY THE CONTRACTOR FOR HAUL ROADS AND STORAGE AREAS SHALL BE MAINTAINED AND REPAIRED IN KIND BY THE CONTRACTOR TO THE SATISFACTION OF AIRPORT MANAGER. NO ADDITIONAL COMPENSATION SHALL BE MADE TO THE CONTRACTOR FOR THIS WORK.
- 8.) EXISTING TURF & AGRICULTURAL AREAS DISTURBED BY THE CONTRACTOR'S OPERATIONS SHALL BE COMPLETELY RESTORED BY HIM AT HIS EXPENSE TO THE SATISFACTION OF THE AIRPORT MANAGER.
- 9.) THE CONTRACTOR SHALL THOROUGHLY CLEAN ALL CONSTRUCTION AREAS PRIOR TO OPENING TO AIR TRAFFIC.
- 10.) REFER TO THE CONSTRUCTION ACTIVITY PLANS AND THE SPECIFICATIONS FOR REQUIREMENTS CONCERNING COORDINATION OF CONSTRUCTION ACTIVITIES.
- 11.) EMERGENCY FIRE/CRASH/RESCUE VEHICLES SHALL HAVE COMPLETE ACCESS TO THE ENTIRE AIRFIELD INCLUDING THE CLOSURE AREAS.
- 12.) THE CONTRACTOR IS REQUIRED TO GIVE TEN FULL WORKING DAYS NOTICE TO THE AIRPORT MANAGER PRIOR TO CLOSING WORK AREAS TO AIRCRAFT.
- 13.) AT THE PRECONSTRUCTION MEETING, CONTRACTOR SHALL SUPPLY THE AIRPORT MANAGER WITH PROPOSED CLOSURE AND PHASING DATES FOR HIS REVIEW AND APPROVAL. THE RESIDENT ENGINEER SHALL KEEP THE AIRPORT MANAGER ADVISED OF ANY PROPOSED CHANGES IN CLOSURE AND PHASING DATES.
- 14.) ALL CONTRACTOR'S VEHICLES AND EQUIPMENT SHALL DISPLAY AN ORANGE AND WHITE CHECKERED AVIATION FLAG, EXCEPT HAUL VEHICLES.
- 15.) ANY VEHICLE OPERATING WITHIN A MOVEMENT AREA DURING THE HOURS OF DARKNESS SHOULD BE EQUIPPED WITH AN AMBER REVOLVING OR FLASHING DOME-TYPE LIGHT AS SPECIFIED IN THE SPECIAL PROVISIONS.
- 16.) IF, DURING CONSTRUCTION, AN EMERGENCY IS DECLARED BY THE AIRPORT, THE CONTRACTOR SHALL IMMEDIATELY CLEAR THE PAVEMENT OF ALL VEHICLES, MEN AND EQUIPMENT.

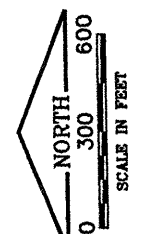

K:\Pinckneyville\0706203 SITE WORK HGR\Draw\Site
 FILE: SITE PLAN.dwg
 UPDATE BY: Dale Draughan
 PLOT DATE: 4/17/2009 1:15 PM
 TOP01A
 ALP1A
 PROP-GEO
 surveytopo
 ALP3A

REVISIONS		
NUMBER	BY	DATE

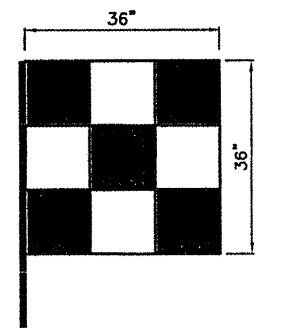
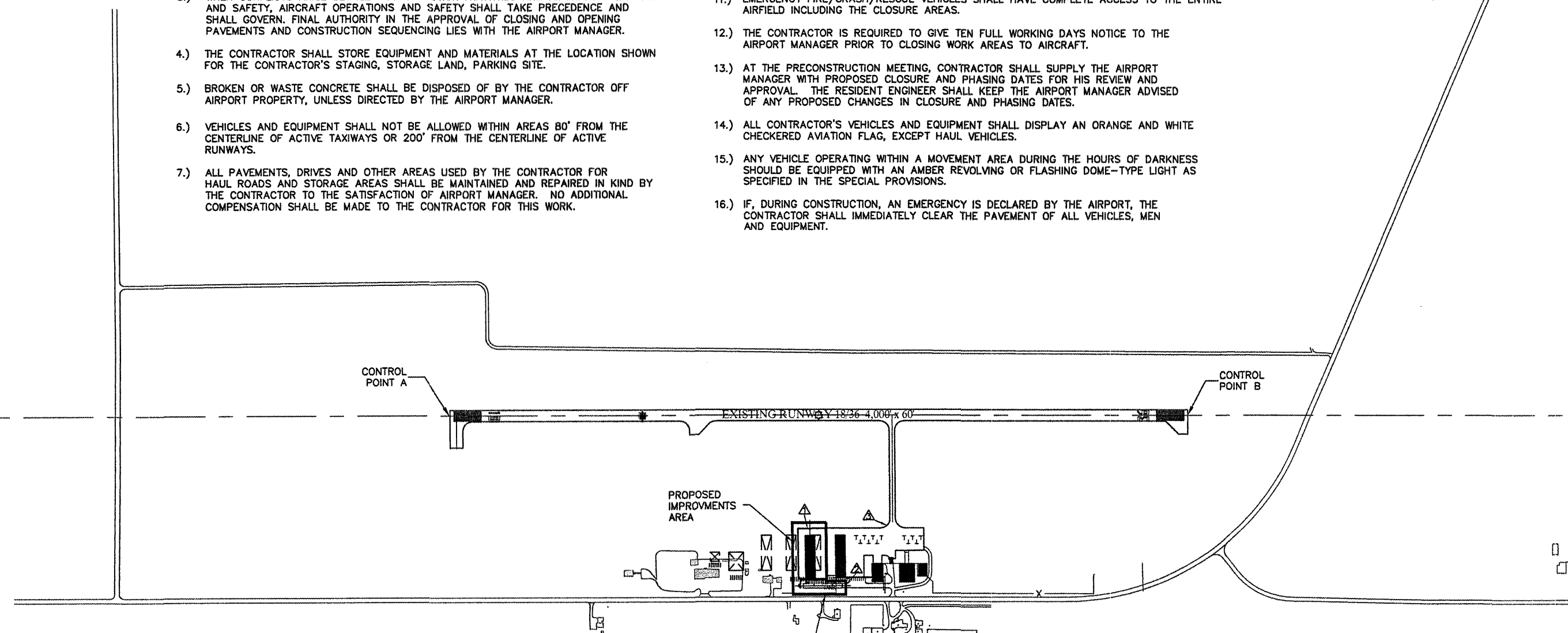
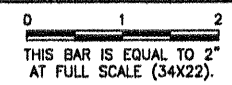

VEHICLE SIGNAL FLAG
 (ORANGE / WHITE)
 N.T.S.

CRITICAL POINTS			
POINT	LATITUDE	LONGITUDE	ELEVATION
A	37° 59' 00.18"	89° 21' 37.03"	400.0'
B	37° 58' 20.65"	89° 21' 38.17"	394.0'

SURVEY CONTROL POINTS				
POINT NUMBER	DESCRIPTION	NORTHING	EASTING	ELEVATION
△	IRON PIN	478491.55	2528354.55	389.00
△	P.K. NAIL	478290.53	2528044.68	394.16
△	P.K. NAIL	478060.48	2528364.72	393.48

CONTRACTOR'S RESPONSIBILITY FOR UTILITY SERVICE

THE LOCATION OF UNDERGROUND UTILITIES AS INDICATED ON THE PLANS HAS BEEN OBTAINED FROM EXISTING RECORDS. NEITHER THE OWNER NOR THE ENGINEER ASSUMES ANY RESPONSIBILITY WHATEVER IN RESPECT TO THE ACCURACY, COMPLETENESS, OR SUFFICIENCY OF THE INFORMATION. THERE IS NO GUARANTEE, EITHER EXPRESSED OR IMPLIED, THAT THE LOCATIONS, SIZE AND TYPE OF MATERIAL OF EXISTING UNDERGROUND UTILITIES INDICATED ARE REPRESENTATIVE OF THOSE TO BE ENCOUNTERED IN THE CONSTRUCTION.

IT SHALL BE THE CONTRACTOR'S RESPONSIBILITY TO DETERMINE THE ACTUAL LOCATION OF ALL SUCH FACILITIES, INCLUDING SERVICE CONNECTIONS TO UNDERGROUND UTILITIES. PRIOR TO CONSTRUCTION, THE CONTRACTOR SHALL NOTIFY THE UTILITY COMPANY OF HIS OPERATIONAL PLANS. THE CONTRACTOR SHALL MAKE ARRANGEMENTS FOR DETAILED INFORMATION AND ASSISTANCE IN LOCATING UTILITIES. IN THE EVENT AN UNEXPECTED UTILITY INTERFERENCE IS ENCOUNTERED DURING CONSTRUCTION, THE CONTRACTOR SHALL IMMEDIATELY NOTIFY THE UTILITY COMPANY, THE OWNER AND THE ENGINEER. ANY SUCH MAINS AND/OR SERVICES DISTURBED BY THE CONTRACTOR'S OPERATIONS SHALL BE RESTORED IMMEDIATELY AT HIS EXPENSE TO THE SATISFACTION OF THE OWNER AND THE ENGINEER.

PINCKNEYVILLE-DUQUOIN AIRPORT
PERRY COUNTY, ILLINOIS
T-HANGAR SITE WORK
SITE PLAN

© Copyright CMT, Inc.
CMT
 CRAWFORD, MURPHY & TILLY, INC.
 CONSULTING ENGINEERS
 License No. 184-000513

DESIGN BY: TJH/KLB
 DRAWN BY: CMT
 CHECKED BY: JEF
 APPROVED BY: JEF
 DATE: 4/17/2009
 JOB No: 07062-03-00
 IL PROJECT NO. PJY-3373
 A.I.P. PROJECT NO. 3-17-0037-B6
 SHEET 03 OF 17 SHEETS

K:\Pinckneyville\0706203 SITE WORK HGR\Draw\Seq
 FILE: SEQUENCE OF CONSTRUCTION.dwg
 UPDATE BY: Dale Draughan
 PLOT DATE: 4/17/2008 1:16 PM
 Q0-QQ-QQ
 ALP1A
 PROP-GEO
 surveytopo
 TOP01A

LEGEND

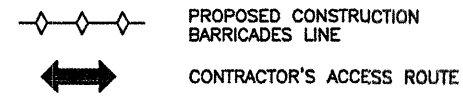

REVISIONS

NUMBER	BY	DATE

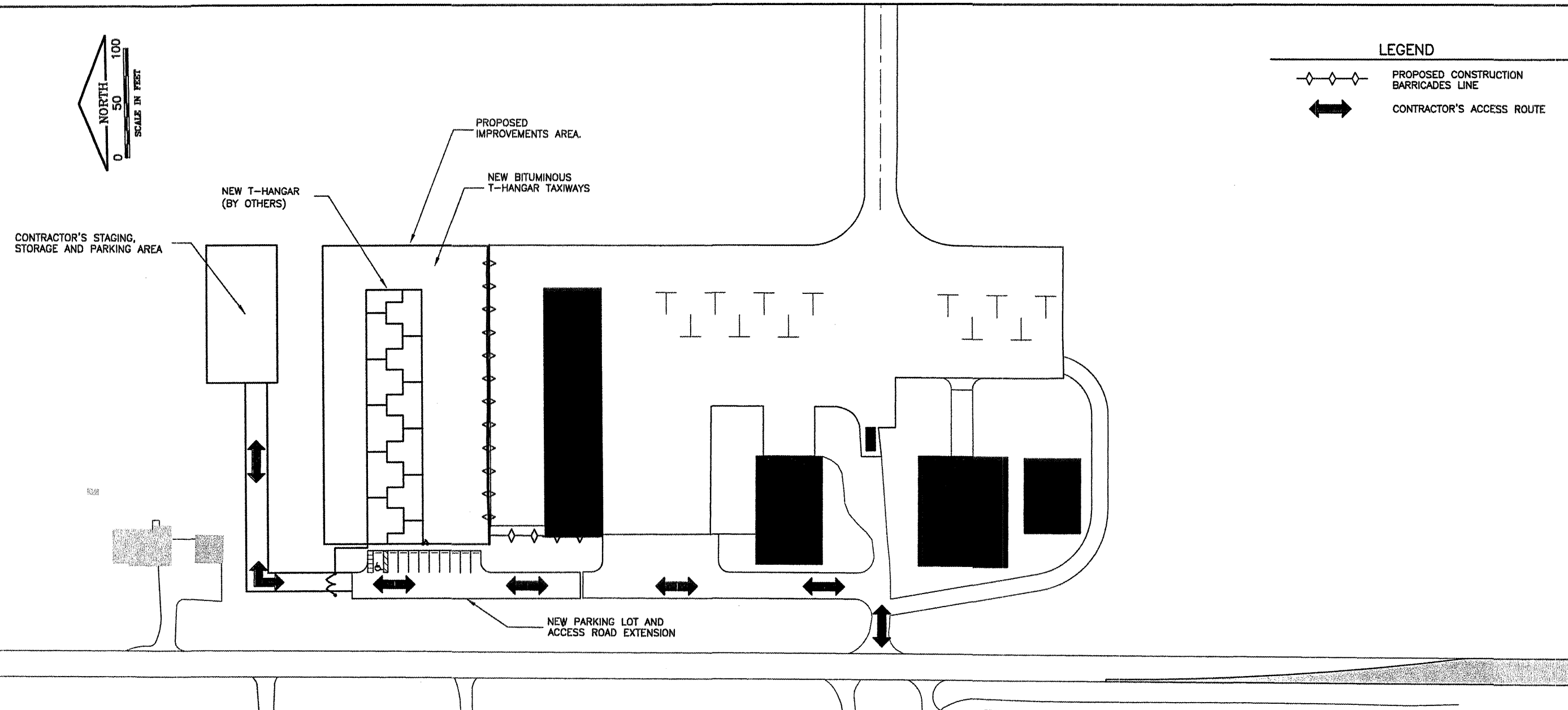
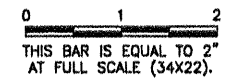

PINCKNEYVILLE-DUQUOIN AIRPORT
PERRY COUNTY, ILLINOIS
T-HANGAR SITE WORK
SEQUENCE OF CONSTRUCTION

SEQUENCE OF CONSTRUCTION NOTES

- THE CONTRACTOR SHALL PLACE ALL BARRICADES AS SHOWN PRIOR TO STARTING WORK.
- THE CONTRACTOR SHALL ALLOW ANY AIRCRAFT THAT NEEDS TO ACCESS THE NORTH SIDE OF EXISTING HANGAR DURING NON-WORKING HOURS.
- ALL CONSTRUCTION TRAFFIC OPERATING ON OR CROSSING RUNWAYS, TAXIWAYS AND APRONS OPEN TO AIRCRAFT TRAFFIC SHALL BE UNDER CONTROL OF A FLAGMAN. THE FLAGMAN SHALL BE IN CONTACT WITH AIR FIELD TRAFFIC AT ALL TIMES.
- THE CONTRACTOR WILL BE PERMITTED TO MAINTAIN AND STORE EQUIPMENT AND MATERIALS IN THE LOCATION SHOWN.
- VEHICLES AND EQUIPMENT SHALL NOT BE ALLOWED WITHIN AREAS 80 FEET FROM THE CENTERLINE ACTIVE TAXIWAYS OR 200 FEET FROM THE CENTERLINE OF ACTIVE RUNWAYS.
- ALL PAVEMENT DRIVES OR ANY OTHER AREA UTILIZED BY THE CONTRACTOR FOR HAUL ROADS ON STORAGE AREAS SHALL BE MAINTAINED AND REPAIRED IN KIND BY THE CONTRACTOR TO THE SATISFACTION OF THE RESIDENT ENGINEER AND AIRPORT MANAGER. NO ADDITIONAL COMPENSATION WILL BE MADE FOR THIS WORK. THE CONTRACTOR SHALL CONTINUOUSLY CLEAN ALL TAXIWAYS AND AIRPORT APRONS, DRIVES, OR ANY OTHER PAVED HAUL ROAD USED BY THE CONTRACTOR.
- EXISTING SURFACES DISTRIBUTED BY THE CONTRACTOR'S OPERATIONS SHALL BE RESTORED BY THE CONTRACTOR AT HIS EXPENSE AND TO THE SATISFACTION OF THE THE RESIDENT ENGINEER AND AIRPORT MANAGER.
- THE CONTRACTOR'S ACCESS WILL BE AS SHOWN.
- THE CONTRACTOR SHALL CLOSE THE ACCESS GATE UPON LEAVING THE SITE.
- THE CONTRACTOR SHALL STORE EQUIPMENT AND MATERIALS IN SUCH A WAY NOT TO VIOLATE AIRPORT PART 77 SURFACES, OR RUNWAY AND TAXIWAY SAFETY AREAS.
- MAXIMUM EQUIPMENT HEIGHT SHALL BE 35 FEET.
- THE SITE WORK CONTRACTOR WILL COORDINATE THEIR SCHEDULE OF WORK WITH THE T-HANGAR CONTRACTOR. THE COORDINATED WORK INCLUDES BUT IS NOT LIMITED TO THE SITE WORK CONTRACTOR'S EARTHWORK, AGGREGATE BASE COURSE, AND BITUMINOUS PAVING OPERATIONS WITH THE T-HANGAR CONTRACTOR'S FOUNDATION/FLOOR PLACEMENT AND STEEL ERECTION. COORDINATION OF SCHEDULE OF WORK WITH T-HANGAR CONTRACTOR WILL BE INCIDENTAL TO THE CONTRACT.

BEAM BARRICADE NOTES

- BARRICADES TO BE CONCRETE BUMPER BLOCKS OR WHEEL STOPS, PAINTED RED. OTHER MATERIALS MAY BE USED, PROVIDED THE BARRICADES ARE HEAVY ENOUGH TO PREVENT DISPLACEMENT WITHOUT BEING ANCHORED TO THE PAVEMENT.
- STEADY BURNING LIGHTS SHALL BE RED IN COLOR.
- BARRICADES TO BE PLACED 15' ON CENTER TO COMPLETELY BLOCK ACCESS BY AIRCRAFT.
- NO SEPARATE PAYMENT WILL BE MADE FOR THIS ITEM. COSTS SHALL BE CONSIDERED INCIDENTAL TO THE PROJECT.

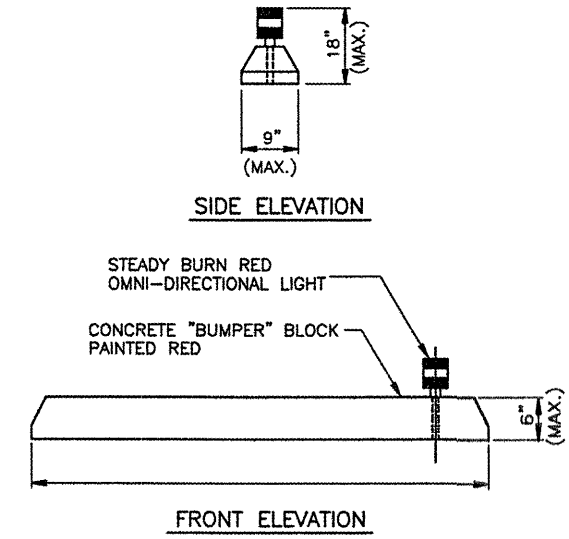

BEAM BARRICADE DETAILS
N.T.S.

MAXIMUM EQUIPMENT HEIGHT 35 FT.
RADIO CONTROL FREQUENCY 122.8 MHZ

© Copyright, CMT, Inc.
CMT
 DRAWFORD, MURPHY & TILLY, INC.
 CONSULTING ENGINEERS
 License No. 184-000613

DESIGN BY:	TJH/KLB
DRAWN BY:	CMT
CHECKED BY:	JEF
APPROVED BY:	JEF
DATE:	4/17/2009
JOB No:	07062-03-00
IL PROJECT NO. PJY-3373	
A.I.P. PROJECT NO. 3-17-0037-B6	
SHEET 04 OF 17 SHEETS	

NOTE:

1. THE CONTRACTOR MUST COORDINATE WITH LOCAL UTILITY TO RELOCATE EXISTING POWER POLE. COST SHALL BE INCIDENTAL TO THE CONTRACT.
2. THE CONTRACTOR MUST COORDINATE WITH LOCAL UTILITY TO ADJUST EXISTING WATER METER. COST SHALL BE INCIDENTAL TO THE CONTRACT.
3. THE CONTRACTOR SHALL LOCATE EXISTING SANITARY LATERAL PRIOR TO RELOCATION.

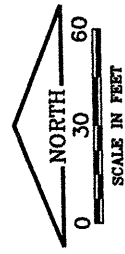

LEGEND

	EXISTING DITCHLINE
	EXISTING FENCE
	EXISTING GATE
	EXISTING CONTOUR
	EXISTING STORM SEWER
	EXISTING INLET
	EXISTING END SECTION
	EXISTING ELECTRICAL MANHOLE
	EXISTING LIGHT POLE
	EXISTING POWER POLE
	EXISTING GATE POST
	EXISTING TELEPHONE PEDESTAL
	EXISTING BUILDING
	EXISTING CROP LIMITS
	RELOCATE
	ADJUST

K:\Pinckneyville\AP\0706203 SITE WORK HGR\Draw\Site
 FILE: EXCON01.dwg
 UPDATE BY: Dale Draughan
 PLOT DATE: 4/17/2009 1:16 PM
 PROP-GEO
 surveytopo
 TOP01A

REVISIONS

NUMBER	BY	DATE

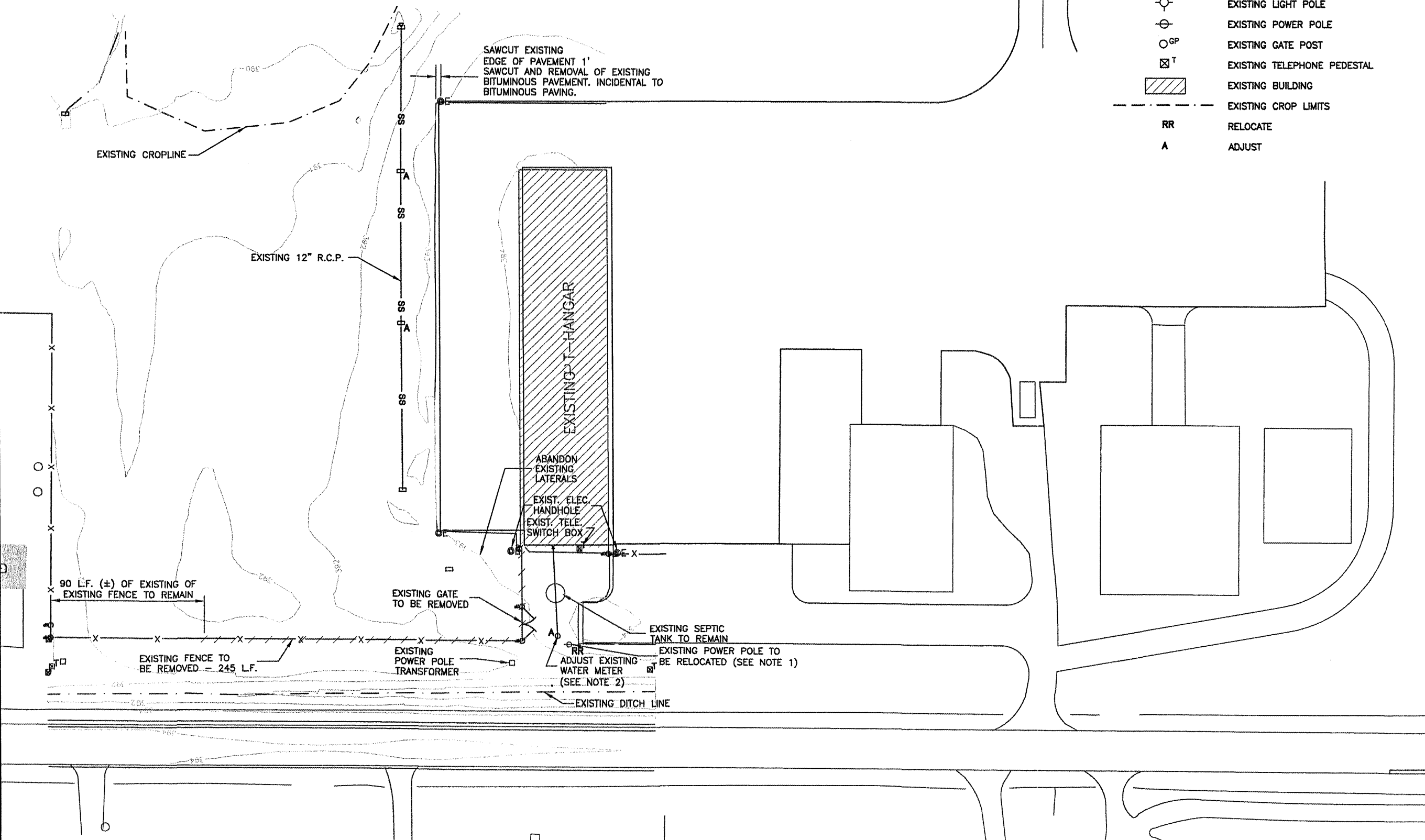
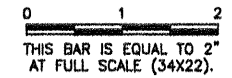

PINCKNEYVILLE-DUQUOIN AIRPORT
 PERRY COUNTY, ILLINOIS
 T-HANGAR SITE WORK
 EXISTING CONDITIONS
 &
 REMOVALS





© Copyright CMT, Inc.

CMT
 CRAWFORD, MURPHY & TILLY, INC.
 CONSULTING ENGINEERS
 License No. 84-000513

DESIGN BY:	KLB
DRAWN BY:	CMT
CHECKED BY:	JEF
APPROVED BY:	JEF
DATE:	4/17/2009
JOB No:	07062-03-00
IL PROJECT NO.	PJY-3373
A.I.P. PROJECT NO.	3-17-0037-B6
SHEET	05 OF 17 SHEETS

POINT NO.	NORTHING	EASTING	DESCRIPTION
A	478544.84	2528084.66	CORNER OF NEW TAXILANE PAVEMENT
B	478543.01	2528355.66	CORNER OF NEW TAXILANE PAVEMENT
C	478390.33±	2528354.64	CORNER OF NEW TAXILANE PAVEMENT
D	478392.42±	2528083.64	CORNER OF NEW TAXILANE PAVEMENT
E	478519.47	2528058.22	CORNER OF NEW PARKING LOT
F	478309.48	2528056.81	CORNER OF NEW PARKING LOT
G	478309.64	2528032.81	CORNER OF NEW PARKING LOT
H	478519.64	2528034.22	CORNER OF NEW PARKING LOT

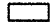
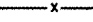
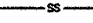
LEGEND

-  NEW 4" BITUMINOUS SURFACE (401)
NEW 8" CRUSHED AGGREGATE (209)
-  NEW ACCESS ROAD AND PARKING EXTENSION
-  EXISTING INLET
-  EXISTING FENCE
-  EXISTING STORM SEWER
-  GEOMETRY POINT AND NO.

- NOTE:**
1. LOCATION OF RELOCATED SEPTIC LATERAL SHALL BE APPROVED BY THE AIRPORT, THE LOCAL PUBLIC HEALTH DEPARTMENT AND RESIDENT ENGINEER PRIOR TO CONSTRUCTION.
 2. COORDINATION OF APPROVALS SHALL BE INCIDENTAL TO THE RELOCATION OF THE SANITARY SEPTIC FIELD.

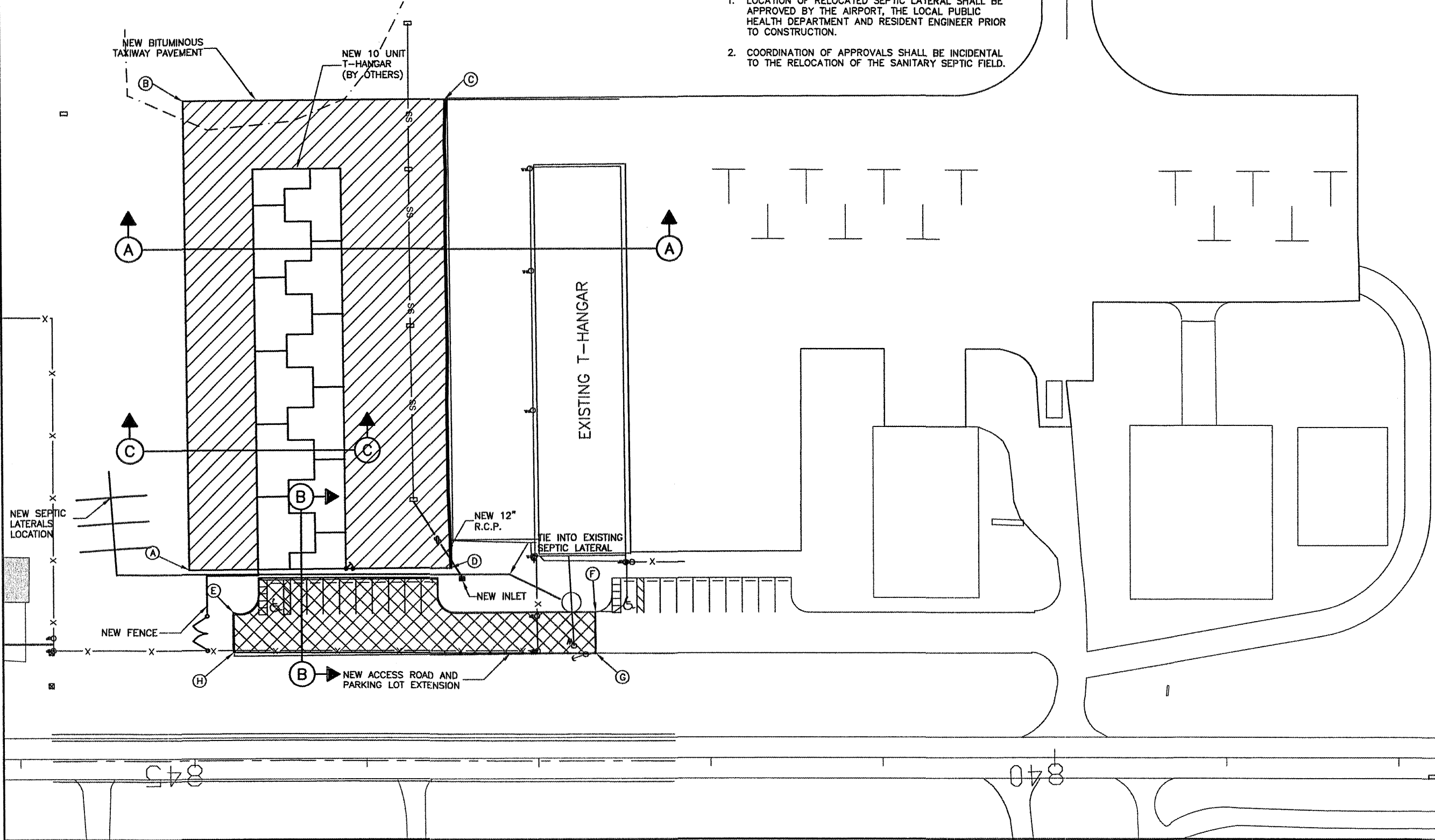
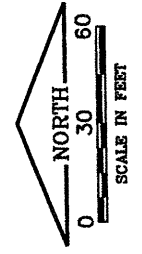

K:\Pinckneyville\AP\0706203 SITE WORK HGR\Draw\SI
FILE: PROPOSED IMPROVEMENTS.dwg
UPDATE BY: Dale Draughan
PLOT DATE: 4/17/2009 1:41 PM
TOPO1A
ALP1A
BASE_EXISTTOPO
PROP-GEO

REVISIONS		
NUMBER	BY	DATE

0 1 2
THIS BAR IS EQUAL TO 2" AT FULL SCALE (34X22).

PINCKNEYVILLE-DUQUOIN AIRPORT
PERRY COUNTY, ILLINOIS
T-HANGAR SITE WORK
PROPOSED IMPROVEMENTS

© Copyright CMT, Inc.
CMT
CRAWFORD, MURPHY & TILLY, INC.
CONSULTING ENGINEERS
License No. 84-00053

DESIGN BY:	TJH/KLB
DRAWN BY:	CMT
CHECKED BY:	JEF
APPROVED BY:	JEF
DATE:	4/17/2009
JOB No:	07062-03-00
IL PROJECT NO.	PJY-3373
A.I.P. PROJECT NO.	3-17-0037-B6
SHEET 06 OF 17 SHEETS	

REVISIONS		
NUMBER	BY	DATE

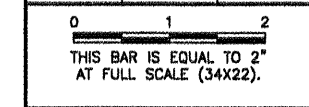

PINCKNEYVILLE-DUQUOIN AIRPORT
 PERRY COUNTY, ILLINOIS
 T-HANGAR SITE WORK
 TYPICAL SECTIONS

© Copyright CMT, Inc.
CMT
 CRAWFORD, MURPHY & TILLY, INC.
 CONSULTING ENGINEERS
 License No. 184-000613

DESIGN BY:	TJH
DRAWN BY:	CMT
CHECKED BY:	JEF
APPROVED BY:	JEF
DATE:	4/17/2009
JOB No:	07062-03-00
IL PROJECT NO. PJY-3373 A.I.P. PROJECT NO. 3-17-0037-B6	
SHEET 07 OF 17 SHEETS	

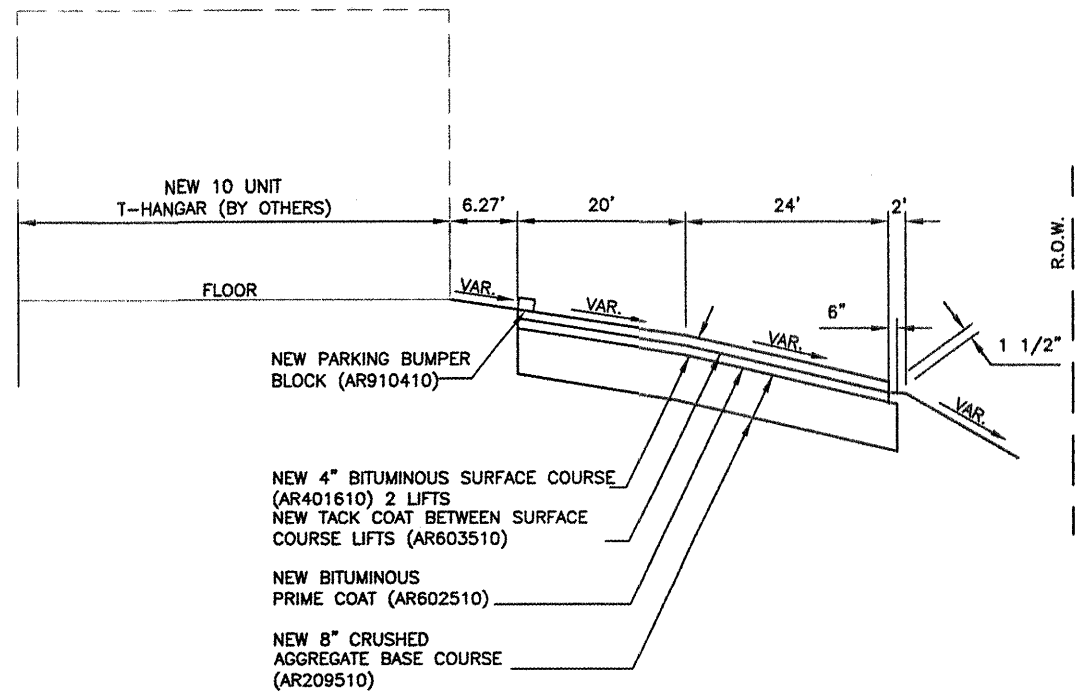

ROADWAY SECTION B-B
 N.T.S.

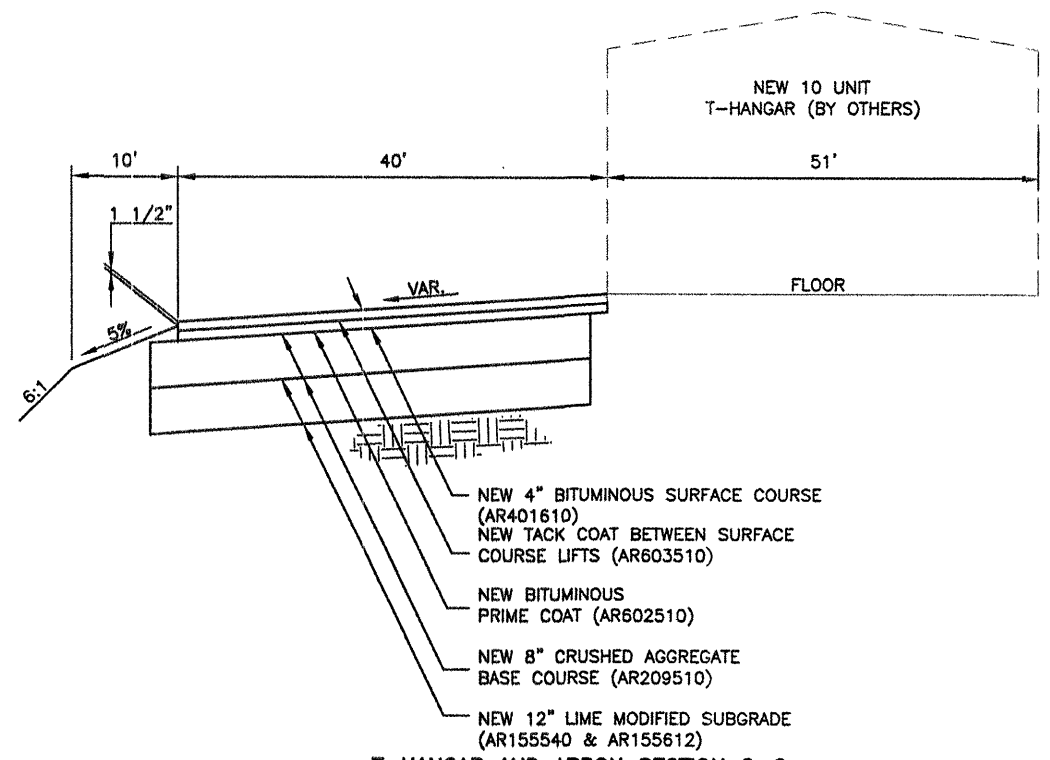

T-HANGAR AND APRON SECTION C-C
 N.T.S.

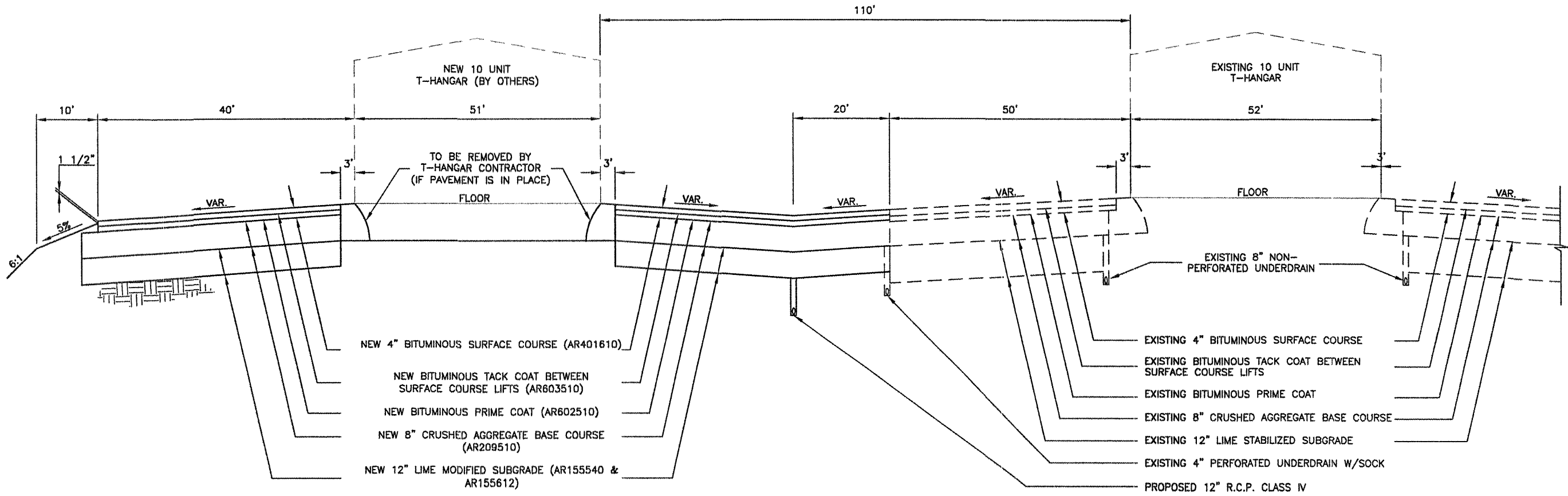

T-HANGAR AND TAXILANE SECTION A-A
 N.T.S.

K:\Pinckneyville\0706203 SITE WORK HGR\Draw\Site
 FILE: UNDERDRAIN AND FENCING PLAN.c
 UPDATE BY: Dale Draughan
 PLOT DATE: 4/17/2009 1:29 PM
 PROP-GEO
 BASE_PROPDRAIN
 BASE_EXISTOPO
 ALP1A
 TOPD1A
 ALP3A

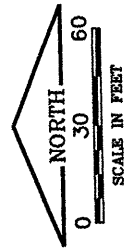

LEGEND

- SS — EXISTING STORM SEWER
- EXISTING INLET
- NEW INLET
- ▽ EXISTING F.E.S.
- - - EXISTING DITCHLINE

REVISIONS		
NUMBER	BY	DATE

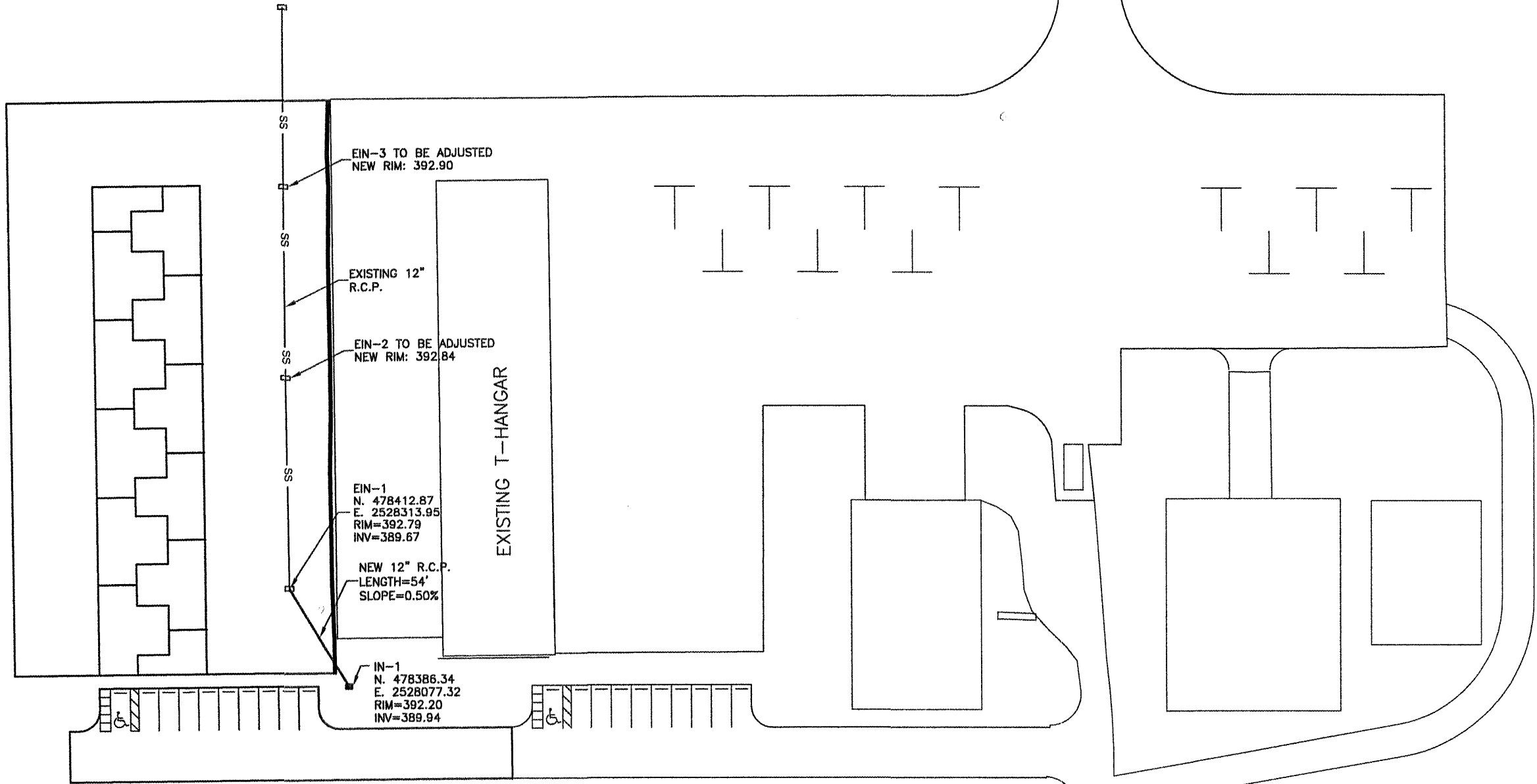
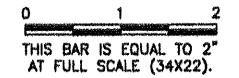

PINCKNEYVILLE-DUQUOIN AIRPORT
 PERRY COUNTY, ILLINOIS
 T-HANGAR SITE WORK
 DRAINAGE PLAN

© Copyright CMT, Inc.
CMT
 CRAWFORD, MURPHY & TILLY, INC.
 CONSULTING ENGINEERS
 License No. 184-000613

DESIGN BY:	TJH
DRAWN BY:	CMT
CHECKED BY:	JEF
APPROVED BY:	JEF
DATE:	4/17/2009
JOB No:	07062-03-00
IL PROJECT NO.	PJY-3373
A.I.P. PROJECT NO.	3-17-0037-B6
SHEET	09 OF 17 SHEETS

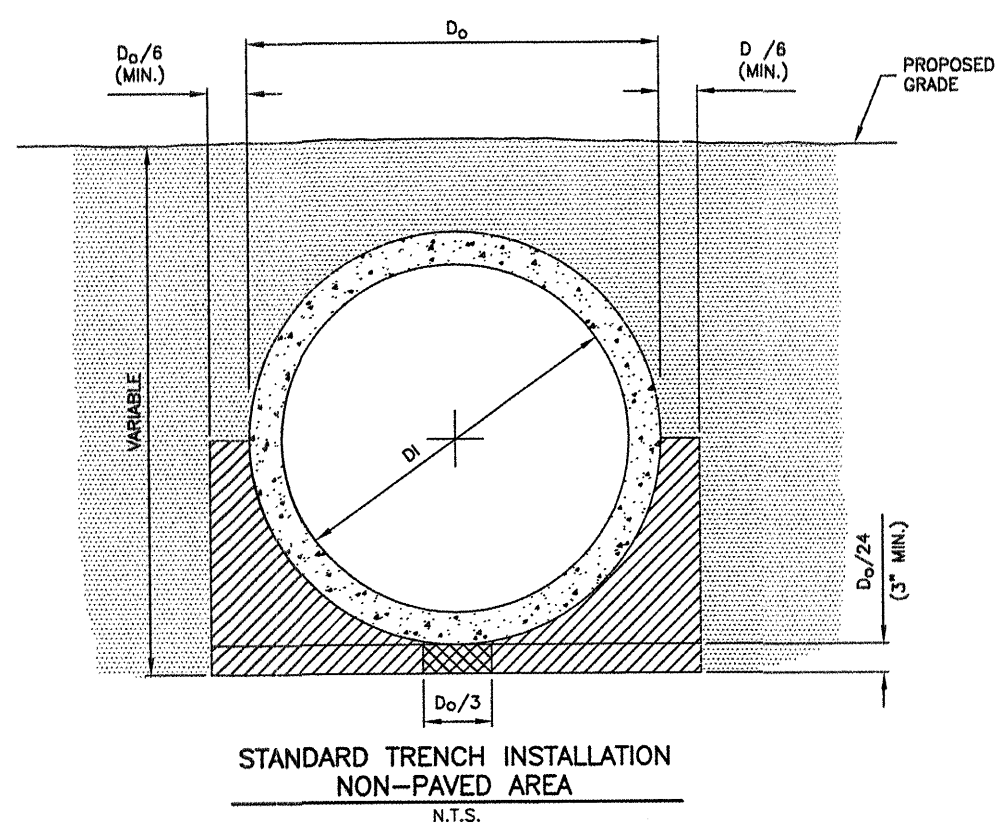

STANDARD TRENCH INSTALLATION
 NON-PAVED AREA
 N.T.S.

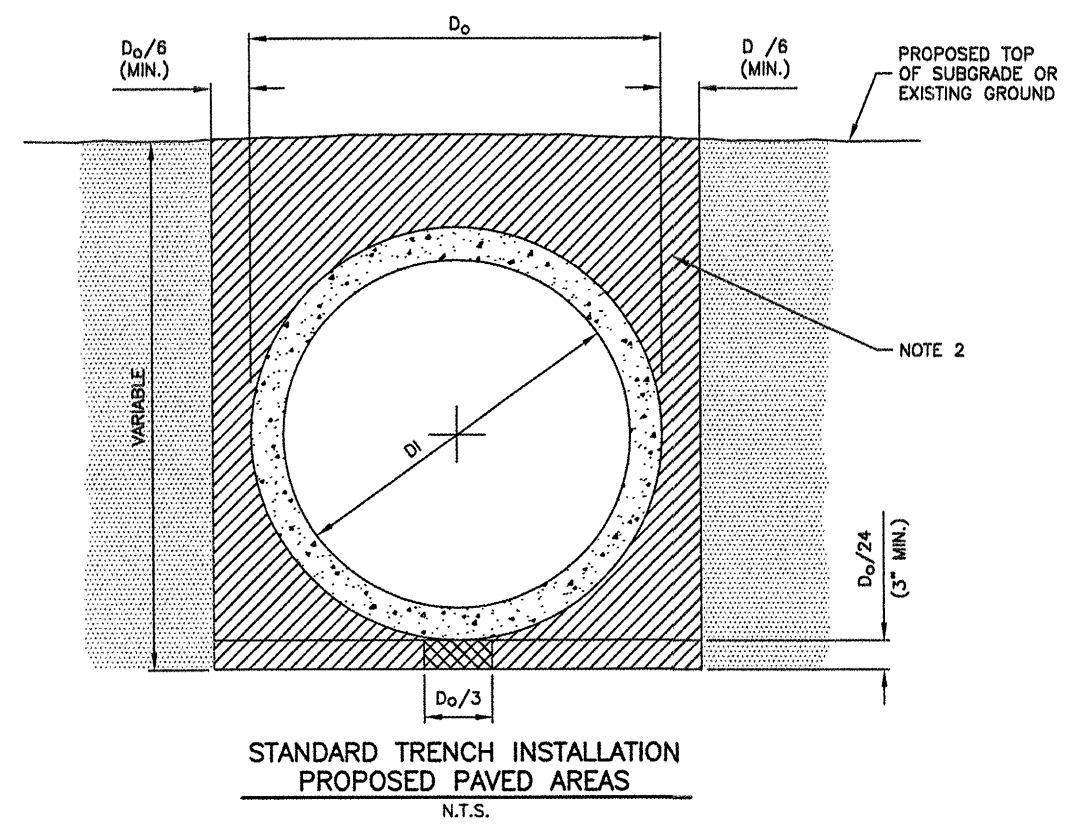

STANDARD TRENCH INSTALLATION
 PROPOSED PAVED AREAS
 N.T.S.

LEGEND

- DRAINAGE CONDUIT MATERIAL-CONCRETE
- MIDDLE BEDDING LOOSELY PLACED UNCOMPACTED BEDDING
- HAUNCH AND OUTER BEDDING COMPACTION- TO ENGINEER'S SATISFACTION OR 95% STANDARD PROCTOR
- LOWER SIDE AND OVERFILL COMPACTION- SAME AS EMBANKMENT REQUIREMENTS

D_o PIPE OUTSIDE DIAMETER
 D_i PIPE INSIDE DIAMETER

- NOTES**
- BEDDING SHOWN IS IN ACCORDANCE WITH "STANDARD EMBANKMENT INSTALLATIONS", STANDARD INSTALLATION & BEDDING FACTORS FOR THE INDIRECT DESIGN METHOD (DESIGN DATA 40), AMERICAN CONCRETE PIPE ASSOCIATION.
 - BACKFILL TO EXTEND 3' BEYOND EDGES OF PROPOSED PAVEMENT.

REVISIONS

NUMBER	BY	DATE

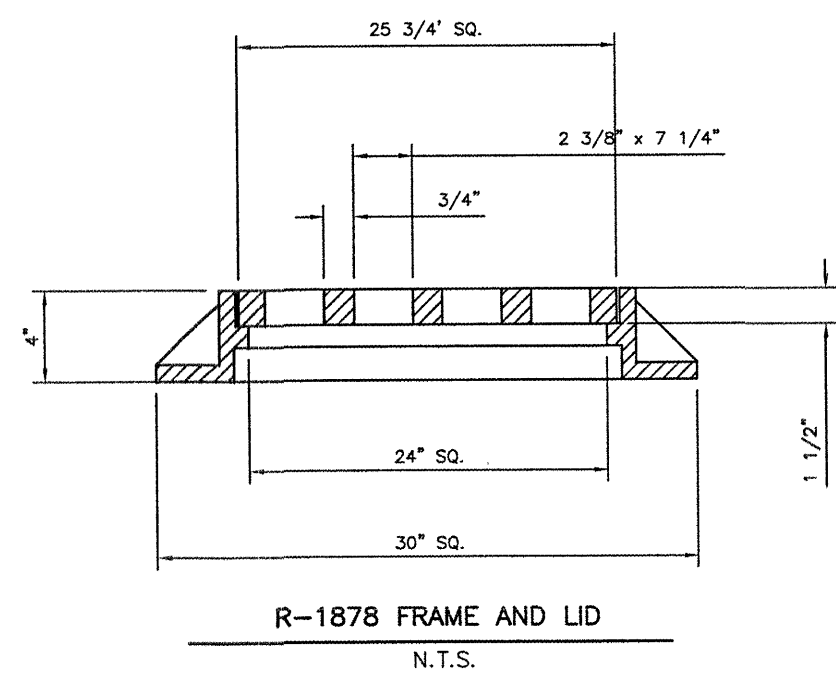
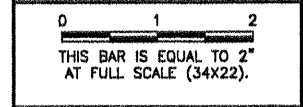

R-1878 FRAME AND LID
 N.T.S.

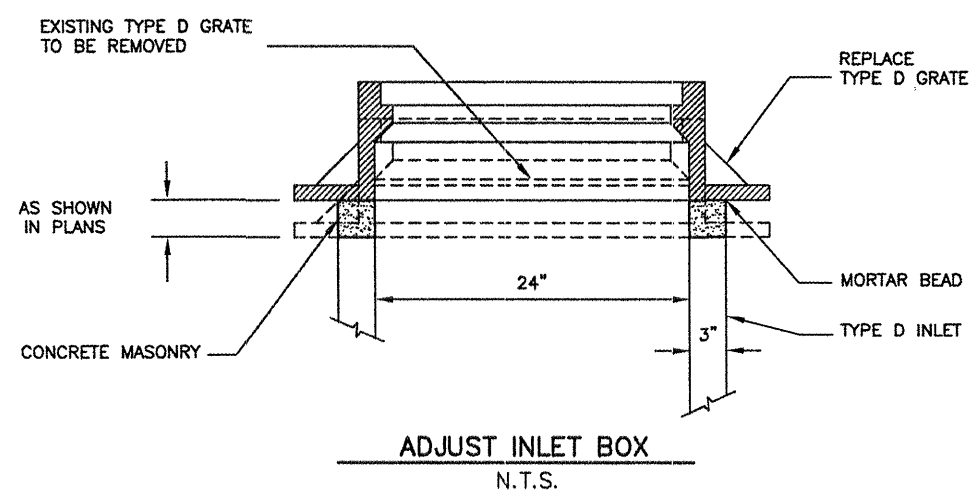

ADJUST INLET BOX
 N.T.S.

PINCKNEYVILLE-DUQUOIN AIRPORT
PERRY COUNTY, ILLINOIS
T-HANGAR SITE WORK
DRAINAGE DETAILS

© Copyright CMT, Inc.
CMT
 CRAWFORD, MURPHY & TILLY, INC.
 CONSULTING ENGINEERS
 License No. 184-000613

DESIGN BY:	KLB
DRAWN BY:	CMT
CHECKED BY:	JEF
APPROVED BY:	JEF
DATE:	4/17/2009
JOB No:	07062-03-00

REVISIONS		
NUMBER	BY	DATE

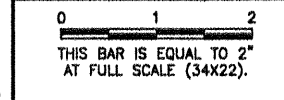

PINCKNEYVILLE-DUQUOIN AIRPORT
 PERRY COUNTY, ILLINOIS

T-HANGAR SITE WORK
 MARKING PLAN
 &
 DETAILS

© Copyright CMT, Inc.
CMT
 CRAWFORD, MURPHY & TILLY, INC.
 CONSULTING ENGINEERS
 License No. 84-000618

DESIGN BY:	KLB
DRAWN BY:	CMT
CHECKED BY:	JEF
APPROVED BY:	JEF
DATE:	4/17/2009
JOB No:	07062-03-00
IL PROJECT NO. PLY-3373	
A.I.P. PROJECT NO. 3-17-0037-B6	
SHEET 11 OF 17 SHEETS	

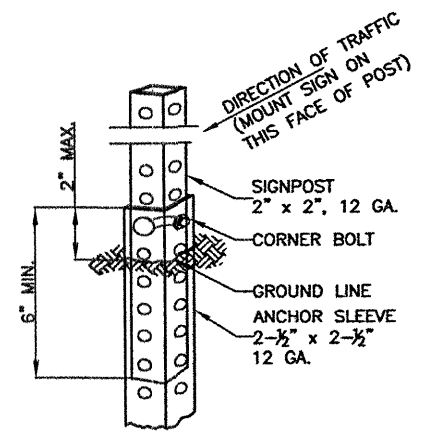
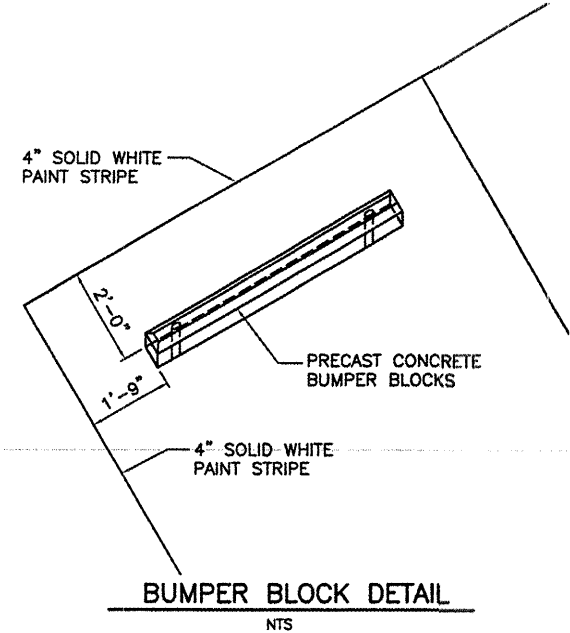
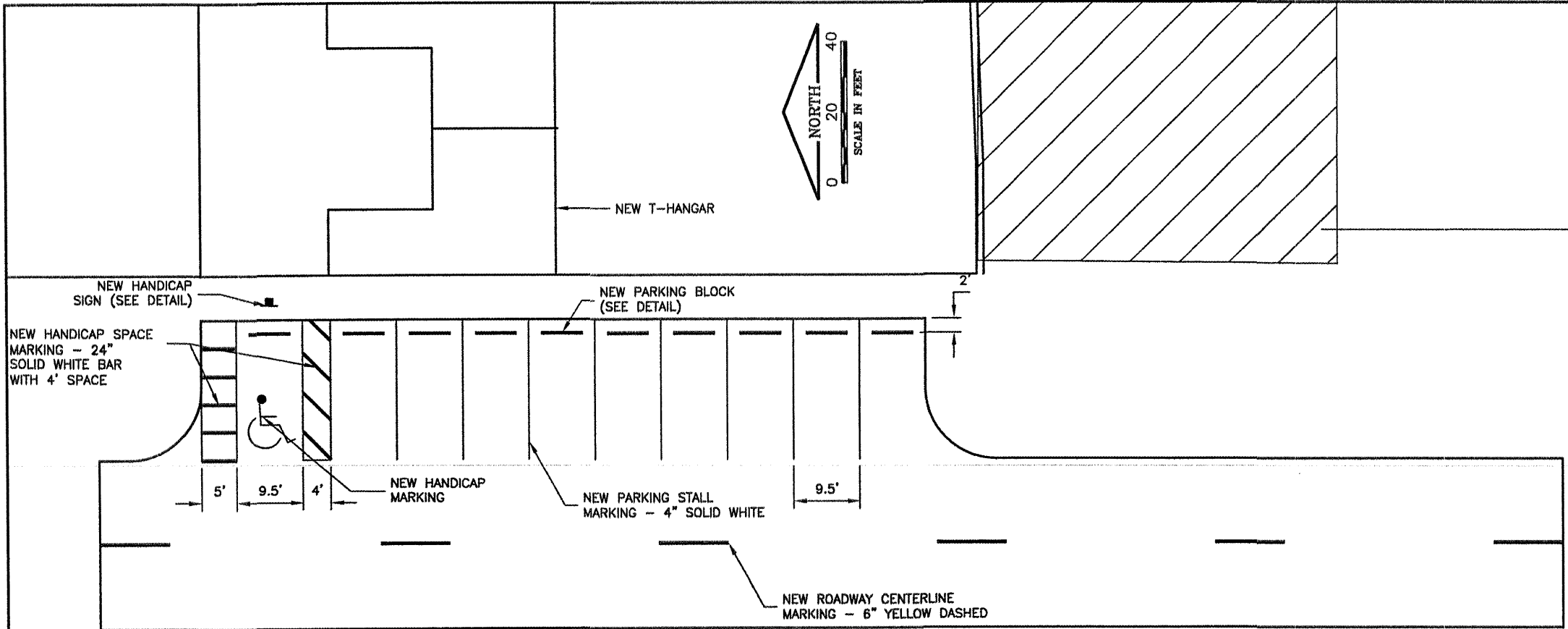

THE SIGNPOST IS ATTACHED TO THE ANCHOR SLEEVE WITH THE CORNER BOLT PER MANUFACTURER'S SPECIFICATION.

POST TYPE
 N.T.S.

SIGN AREA (SQ.FT.)	PERFORATED SQUARE STEEL TUBE POST DETAIL		
	U-CHANNEL	WOOD	PERFORATED SQUARE STEEL TUBING
* 10	1 - 3.0 LB./FT.*	1 - 4" X 4"*	1 - 2" 12 GA.*
* 10 * 16	2 - 3.0 LB./FT.	2 - 4" X 4" * 1 - 4" X 6"*	2 - 2" 12 GA.
* 16 * 24	2 - 3.0 LB./FT.	2 - 4" X 6"	3 - 2" 12 GA.**
* 24 * 30	3 - 3.0 LB./FT.	2 - 4" X 6"	N/A
* 30 * 50	N/A	2 - 6" X 6"	N/A

* SIGNS GREATER THAN 4 FEET IN WIDTH, EXCEPT DIAMOND SHAPE SIGNS, REQUIRE TWO POSTS.
 ** REQUIRES SLIP BASE PER MANUFACTURER'S RECOMMENDATION.
 ALL POSTS SHALL BE IMBEDDED A MINIMUM OF 3 FEET.
POST SIZE REQUIREMENTS
 N.T.S.

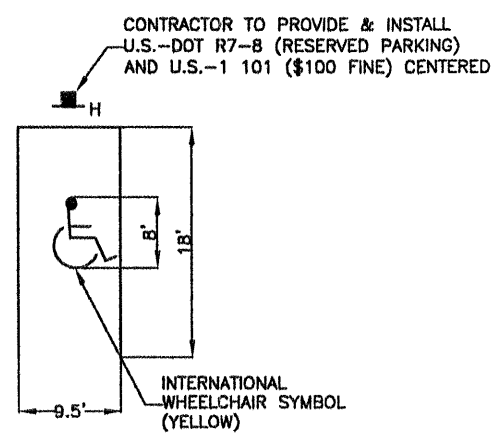

HANDICAP PARKING SPACE
 N.T.S.

NOTE:
 1. ALL MARKING SHALL CONSIST OF 4" WIDE YELLOW STRIPES.

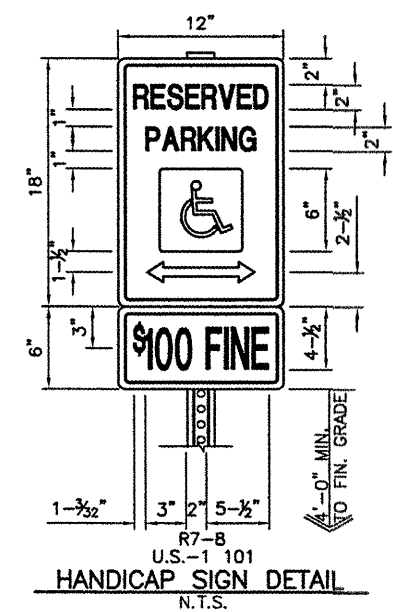

HANDICAP SIGN DETAIL
 N.T.S.

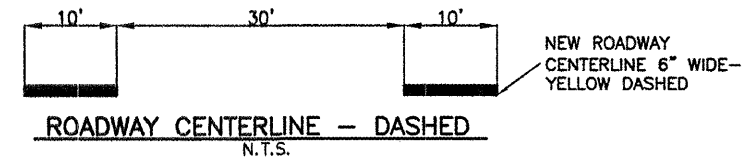

ROADWAY CENTERLINE - DASHED
 N.T.S.

POINT NO.	NORTHING	EASTING	DESCRIPTION
A	478535.14	2528037.79	NEW GATE POST
B	478535.01	2528057.79	NEW GATE POST
C	478534.86	2528081.04	NEW FENCE CORNER
D	478504.86	2528080.84	NEW FENCE CORNER
E	478504.84	2528084.39	CORNER OF T-HANGAR
F	478453.84	2528084.05	NEW PEDESTRIAN GATE POST
G	478449.84	2528084.02	NEW PEDESTRIAN GATE POST
H	478343.03	2528083.25	NEW FENCE CORNER

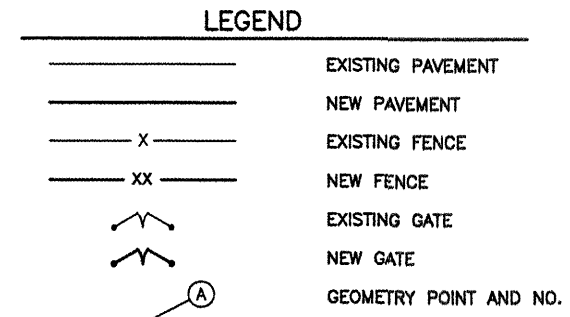

- NOTES**
- ALIGNMENT OF NEW FENCE SHALL BE APPROVED BY AIRPORT PRIOR TO PLACEMENT OF FENCE POSTS.
 - EXISTING FENCE MUST REMAIN IN PLACE UNTIL NEW FENCE IS INSTALLED.

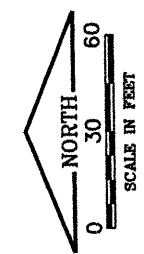

REVISIONS

NUMBER	BY	DATE

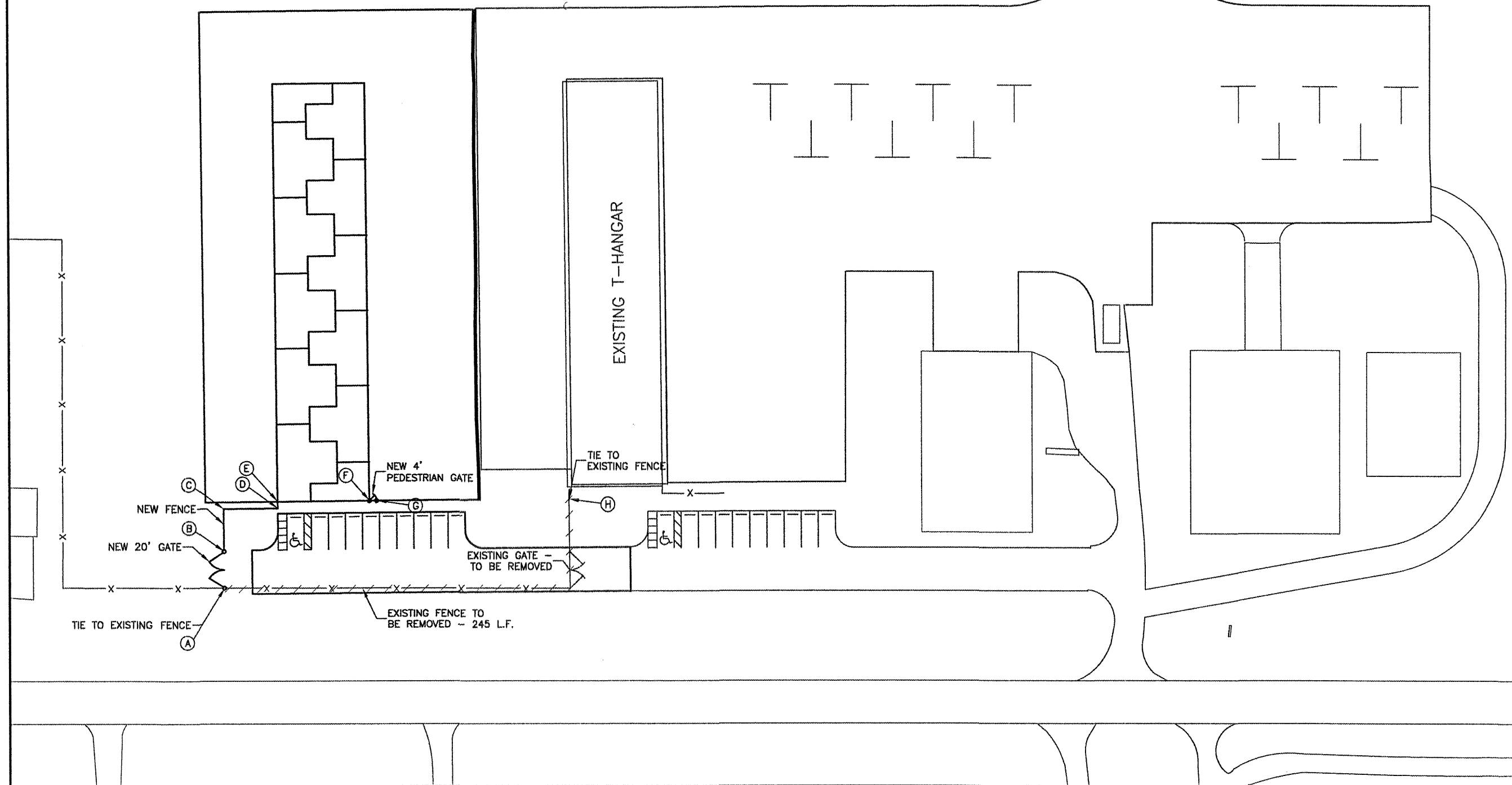
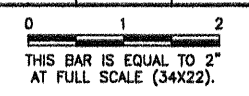

PINCKNEYVILLE-DUQUOIN AIRPORT
 PERRY COUNTY, ILLINOIS
 T-HANGAR SITE WORK
 FENCING PLAN

© Copyright CMT, Inc.
CMT
 CRAWFORD, MURPHY & TILLY, INC.
 CONSULTING ENGINEERS
 License No. 84-000613

DESIGN BY:	KLB
DRAWN BY:	CMT
CHECKED BY:	JEF
APPROVED BY:	JEF
DATE:	4/17/2009
JOB No:	07062-03-00
IL PROJECT NO.	PJY-3373
A.I.P. PROJECT NO.	3-17-0037-B6
SHEET	12 OF 17 SHEETS

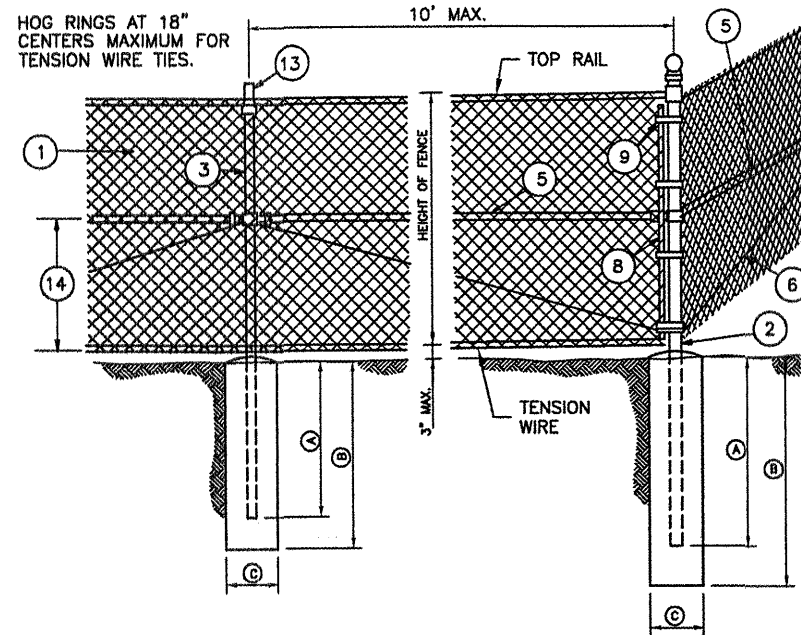

FENCE DETAIL
N.T.S.

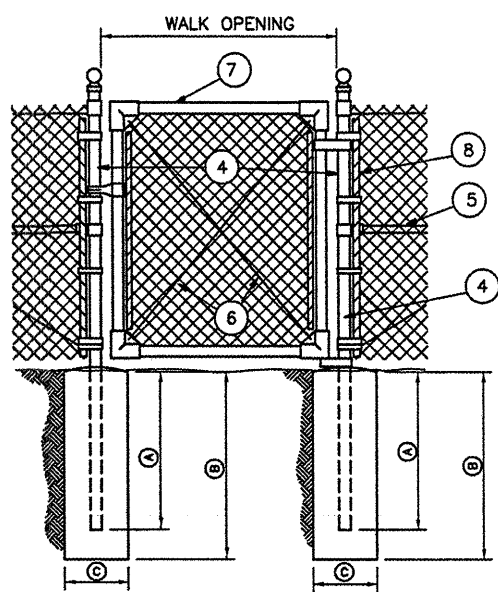

PEDESTRIAN GATE DETAIL
N.T.S.

- LEGEND**
- ① FABRIC
 - ② END, CORNER OR PULL POST
 - ③ LINE POST
 - ④ GATE POST
 - ⑤ BRACE
 - ⑥ TRUSS ROD
 - ⑦ GATE FRAME
 - ⑧ STRETCHER BAR
1/4" X 3/4" PLATE
 - ⑨ STRETCHER BAR BAND
 - ⑩ END OR CORNER CLAMP
 - ⑪ POST TOPS
(OTHER THAN LINE POSTS)
 - ⑫ FABRIC TIES
 - ⑬ LINE POST TOPS
 - ⑭ ONE-HALF FABRIC HEIGHT
OR AS RECOMMENDED BY
MANUFACTURER

REVISIONS

NUMBER	BY	DATE

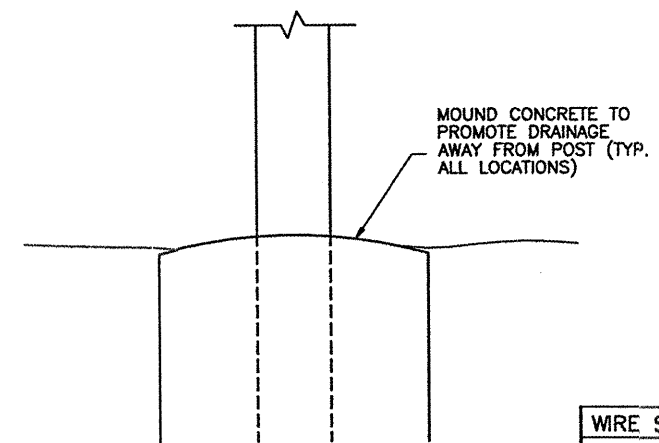
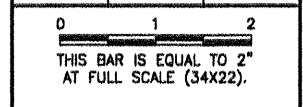

CONCRETE DETAIL
N.T.S.

WIRE SIZE AND HEIGHT OF FABRIC

INCHES	SPECIFIED DIAMETER		HEIGHT OF FABRIC INCHES
	GAGE	MESH INCHES	
0.120	11	2	36, 42
0.148	9	2	48, 60
0.192	6	2	72, 84

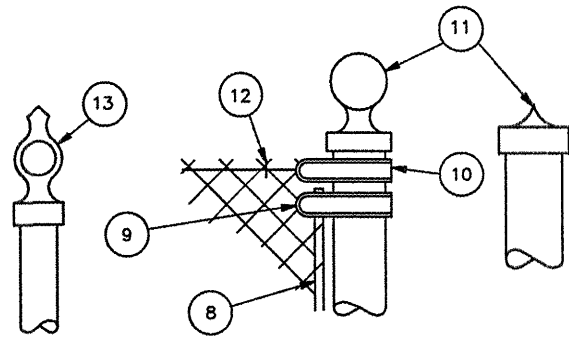

POST TOPS TO BE PRESSURE FITTED OR SCREWED. POST TOPS MAY BE ELIMINATED FOR ALL POSTS EXCEPT PIPE POSTS. IF POST TOPS ARE ELIMINATED, POST LENGTH SHALL BE INCREASED 3".

POST TOPS
N.T.S.

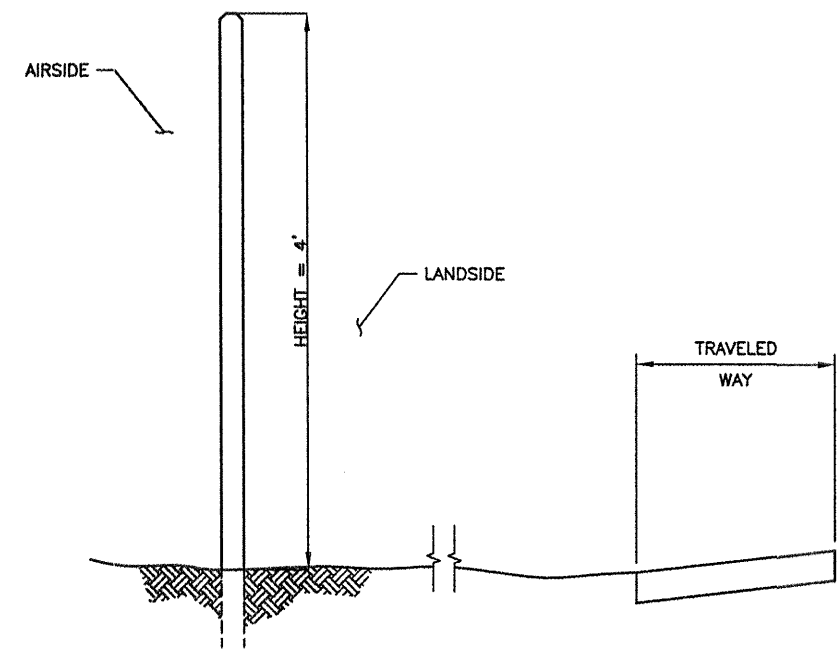

BARBED WIRE EXTENSION BRACKET
N.T.S.

FENCE NOTES

- WEIGHTS OF MATERIALS SHOWN IN TABLE ARE FOR ASTM F 1043, GROUP 1A. SIZES SHOWN ARE FOR STEEL AND ALUMINUM. EQUIVALENT ASTM F 1043 ALTERNATIVES MAY BE USED.
- PULL POSTS SHALL BE USED AT SHARP BREAKS IN VERTICAL GRADE OR AT APPROXIMATE 500' CENTERS ON STRAIGHT RUNS OR AS DIRECTED BY THE ENGINEER.
- DRILLED HOLES C IN SOLID ROCK SHALL PROVIDE A DIAMETER OF NOT LESS THAN 2" GREATER THAN THE MAXIMUM TRANSVERSE DIMENSION OF THE POST SECTION.
- ALL POSTS SHOWN HAVE PROVISIONS TO SECURELY HOLD THE TOP TENSION WIRE IN POSITION AND ALLOW FOR REMOVAL AND REPLACEMENT OF A POST WITHOUT DAMAGING THE TOP TENSION WIRE.

GENERAL NOTE

LOCATIONS, DETAILS AND CHARACTER OF EQUIPMENT SHOWN ON THIS SHEET ARE GENERIC. EQUIPMENT LOCATIONS SHALL BE AS RECOMMENDED BY THE EQUIPMENT MANUFACTURER.

DESCRIPTION	HEIGHT OF FENCE				
	48"	60"	72"	96"	
	SIZE (IN.)	SIZE (IN.)	SIZE (IN.)	SIZE (IN.)	
② END CORNER & PULLPOST	(A)	30"	36"	36"	42"
	(B)	36"	42"	42"	48"
	(C)	10"	12"	12"	14"
③ LINE POST	(A)	24"	27"	36"	36"
	(B)	30"	36"	42"	42"
	(C)	10"	12"	12"	12"
④ GATE POST	(A)	30"	36"	36"	42"
	(B)	36"	42"	42"	48"
	(C)	10"	12"	12"	14"

	WIDTH	SIZE (IN.)	LBS./FT.
② END CORNER OR PULL POST	N/A	2 1/2" DIA.	5.79
③ LINE POST	N/A	2" DIA.	3.65
	* 6'	2 1/2" DIA.	5.79
	* 13'	3 1/2" DIA.	9.10
④ GATE POST (SINGLE GATE OR 1 LEAF OF DOUBLE)	* 6'	6" DIA.	18.97
	* 18'	8" DIA.	24.70
⑤ BRACE	N/A	1 1/2" DIA.	2.27
⑥ TRUSS ROD	N/A	3/8"	-
⑦ GATE FRAME	N/A	1 1/2" DIA.	2.72

PINCKNEYVILLE-DUQUOIN AIRPORT
 PERRY COUNTY, ILLINOIS
 T-HANGAR SITE WORK
 FENCING DETAILS

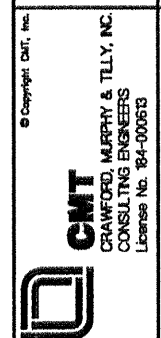

DESIGN BY: TJH
 DRAWN BY: CMT
 CHECKED BY: JEF
 APPROVED BY: JEF
 DATE: 4/17/2009
 JOB No: 07062-03-00
 IL PROJECT NO. PJY-3373
 A.I.P. PROJECT NO. 3-17-0037-B6
 SHEET 13 OF 17 SHEETS

EARTHWORK SUMMARY

T-HANGAR SITEWORK		
STATION	EXCAVATE END AREA (S.F.)	EMBANK END AREA (S.F.)
9+83.97	15.87	90.23
10+00	21.93	91.61
10+50	25.51	87.50
11+00	26.29	128.57
11+50	24.02	169.15
12+00	21.76	228.42
12+54.97	8.83	210.75
13+00	0.00	0.00

ENTRANCE ROAD		
STATION	EXCAVATE END AREA (S.F.)	EMBANK END AREA (S.F.)
3+48	4.04	21.20
4+00	2.87	39.90
4+50	0.36	52.30
5+00	0.00	37.77
5+58	2.27	12.64
6+00	3.96	10.12

NOTES:

- TURFING LIMITS SHOWN ARE APPROXIMATE. ACTUAL TURFING LIMITS SHALL BE DETERMINED BY THE RESIDENT ENGINEER.
- AN ADDITIONAL 2000 SY OF EXCELSIOR BLANKET HAS BEEN INCLUDED IN THE QUANTITIES FOR ADDITIONAL DISTURBED AREAS AS REQUIRED BY THE ENGINEER.
- RESTORATION AND TURFING OF DISTURBED AREAS BEYOND THE LIMITS SHOWN (SUCH AS EDGE LIGHTING, CABLING, SIGNAGE, ACCESS, STAGING, ETC.) SHALL BE INCIDENTAL TO THE PROJECT.

LEGEND

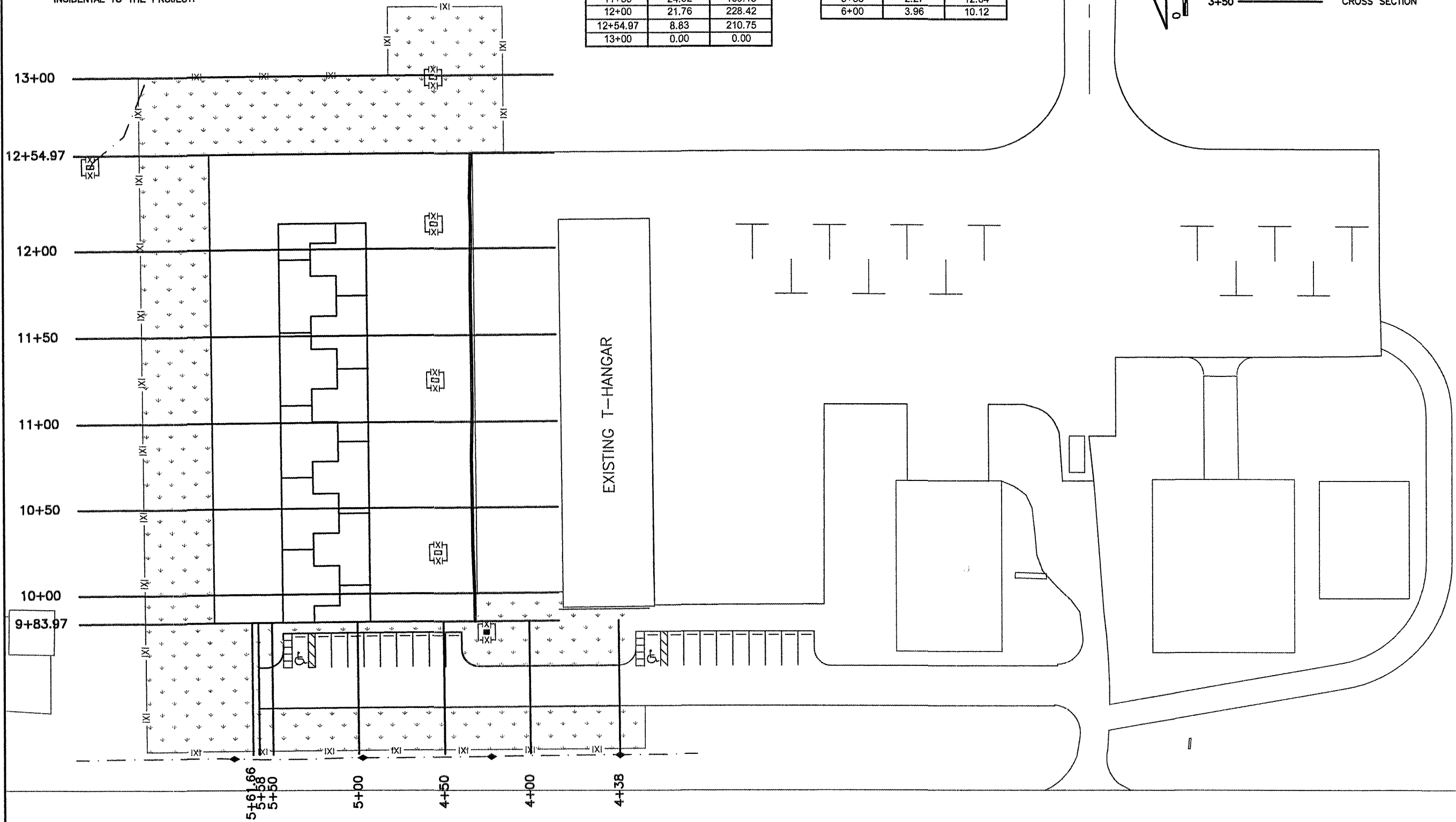
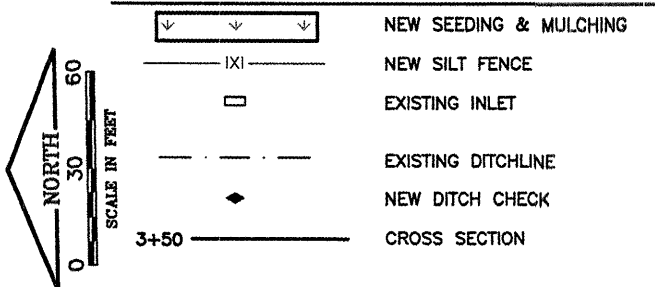

K:\Pinckneyville\AP\0706203 SITE WORK HGR\Draw\Site
 FILE: EROS01.dwg
 UPDATE BY: Dale Draughan
 PLOT DATE: 4/17/2009 1:45 PM
 PROP-GEO
 BASE_EXISTOPO
 ALP1A
 TOP01A
 ALP3A
 BASE_PROPTURF
 BASE_PROPDRAIN

REVISIONS

NUMBER	BY	DATE

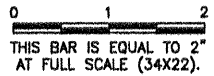

PINCKNEYVILLE-DUQUOIN AIRPORT

PERRY COUNTY, ILLINOIS

T-HANGAR SITE WORK
 EROSION CONTROL PLAN
 &
 EARTHWORK SUMMARY

© Copyright CMT, Inc.
CMT
 CRAWFORD, MURPHY & TILLY, INC.
 CONSULTING ENGINEERS
 License No. BA-000613

DESIGN BY: KLB
 DRAWN BY: CMT
 CHECKED BY: JEF
 APPROVED BY: JEF
 DATE: 4/17/2009
 JOB No: 07062-03-00
 IL PROJECT NO. PJY-3373
 A.I.P. PROJECT NO. 3-17-0037-B6
 SHEET 14 OF 17 SHEETS

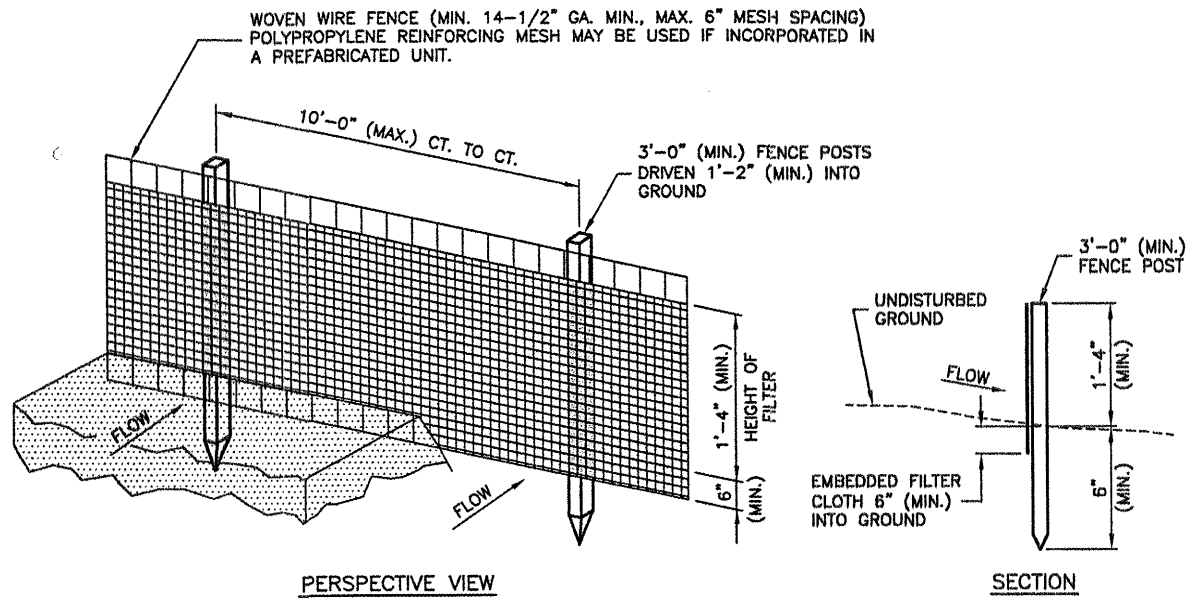

EROSION CONTROL FABRIC FENCE DETAIL
N.T.S.

NOTES

- WOVEN WIRE FENCE TO BE FASTENED SECURELY TO FENCE POSTS WITH WIRE TIES OR STAPLES.
 - FILTER CLOTH TO BE FASTENED SECURELY TO WOVEN WIRE FENCE WITH TIES SPACED EVERY 2'-0" AT TOP AND MID SECTION.
 - WHEN TWO SECTIONS OF FILTER CLOTH ADJOIN EACH OTHER THEY SHALL BE OVERLAPPED BY 6" MINIMUM AND FOLDED.
 - MAINTENANCE SHALL BE PERFORMED AS NEEDED AND MATERIAL REMOVED WHEN "BULGES" DEVELOP IN THE SILT FENCE. MAINTENANCE, WHICH INCLUDES THE REPLACEMENT OF DAMAGED FENCE SHALL BE CONSIDERED INCIDENTAL TO THE COST OF THE EROSION CONTROL FENCE.
- POSTS: STEEL EITHER T OR U TYPE OR 2" HARDWOOD.
- FENCE: WOVEN WIRE, 14-1/2" GA. 6" MAX. MESH OPENING POLYPROPYLENE MESH, IF INCORPORATED IN PREFAB UNIT.
- FILTER CLOTH: FILTER X, MIRAF1100X, STABILINKA T140N OR EQUAL.
- PREFABRICATED UNIT: GEOFAB ENVIRONFENCE, GSI SILT FENCE WITH REINFORCING MEAH OR EQUAL.

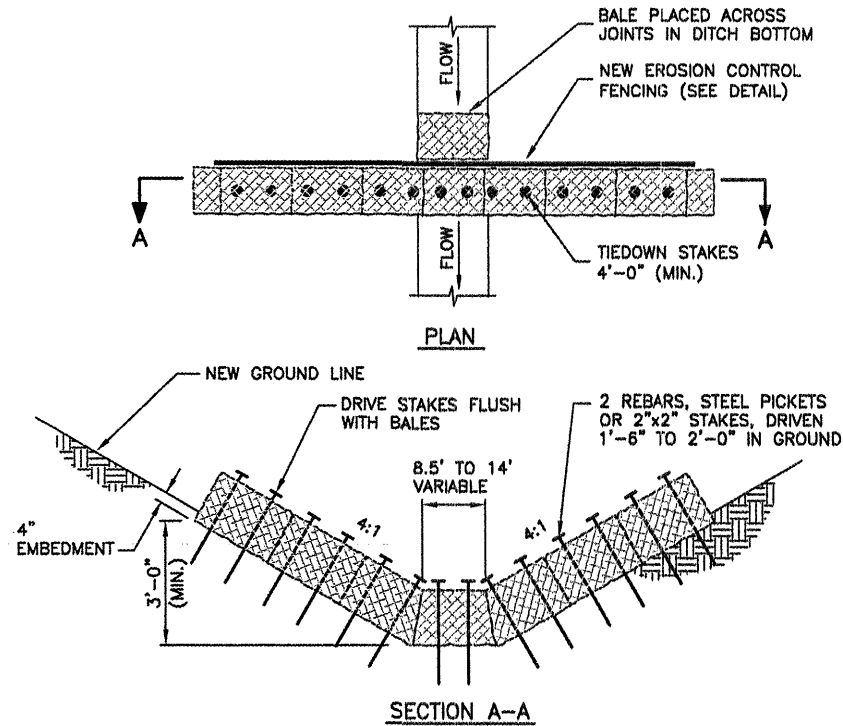

TEMPORARY DITCH CHECK
N.T.S.

NOTES

- BALES SHALL BE PLACED AT THE TOE OF SLOPE OR AS DIRECTED BY THE ENGINEER, AND IN A ROW WITH ENDS TIGHTLY ABUTTING THE ADJACENT BALES.
 - EACH BALE SHALL BE EMBEDDED IN THE SOIL A MINIMUM OF 4", AND PLACED SO THE BINDINGS ARE HORIZONTAL.
 - BALES SHALL BE SECURELY ANCHORED IN PLACE BY EITHER TWO STAKES OR REBARS DRIVEN THROUGH THE BALE. THE FIRST STAKE IN EACH BALE SHALL BE DRIVEN TOWARD THE PREVIOUSLY LAID BALE AT AN ANGLE TO FORCE THE BALES TOGETHER. STAKES SHALL BE DRIVEN FLUSH WITH THE BALE.
 - INSPECTION SHALL BE FREQUENT AND REPAIR / REPLACEMENT SHALL BE MADE PROMPTLY AS NEEDED.
- BALES SHALL BE REMOVED WHEN THEY HAVE SERVED THEIR USEFULNESS SO AS NOT TO BLOCK OR IMPEDE STORM FLOW OR DRAINAGE. COST OF REMOVAL / REPLACEMENT TO BE INCLUDED IN UNIT PRICE FOR HAY BALES.

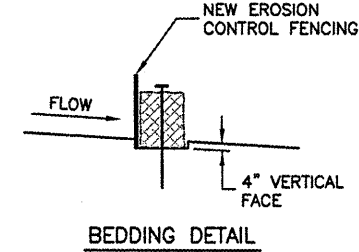

BEDDING DETAIL

K:\Pinckneyville\AP\0706203 SITE WORK HGR\Draw\Sheet
FILE: EROSDETO1.dwg
UPDATE BY: Dale Draughan
PLOT DATE: 4/17/2009 1:45 PM

REVISIONS

NUMBER	BY	DATE

0 1 2
THIS BAR IS EQUAL TO 2" AT FULL SCALE (34X22).

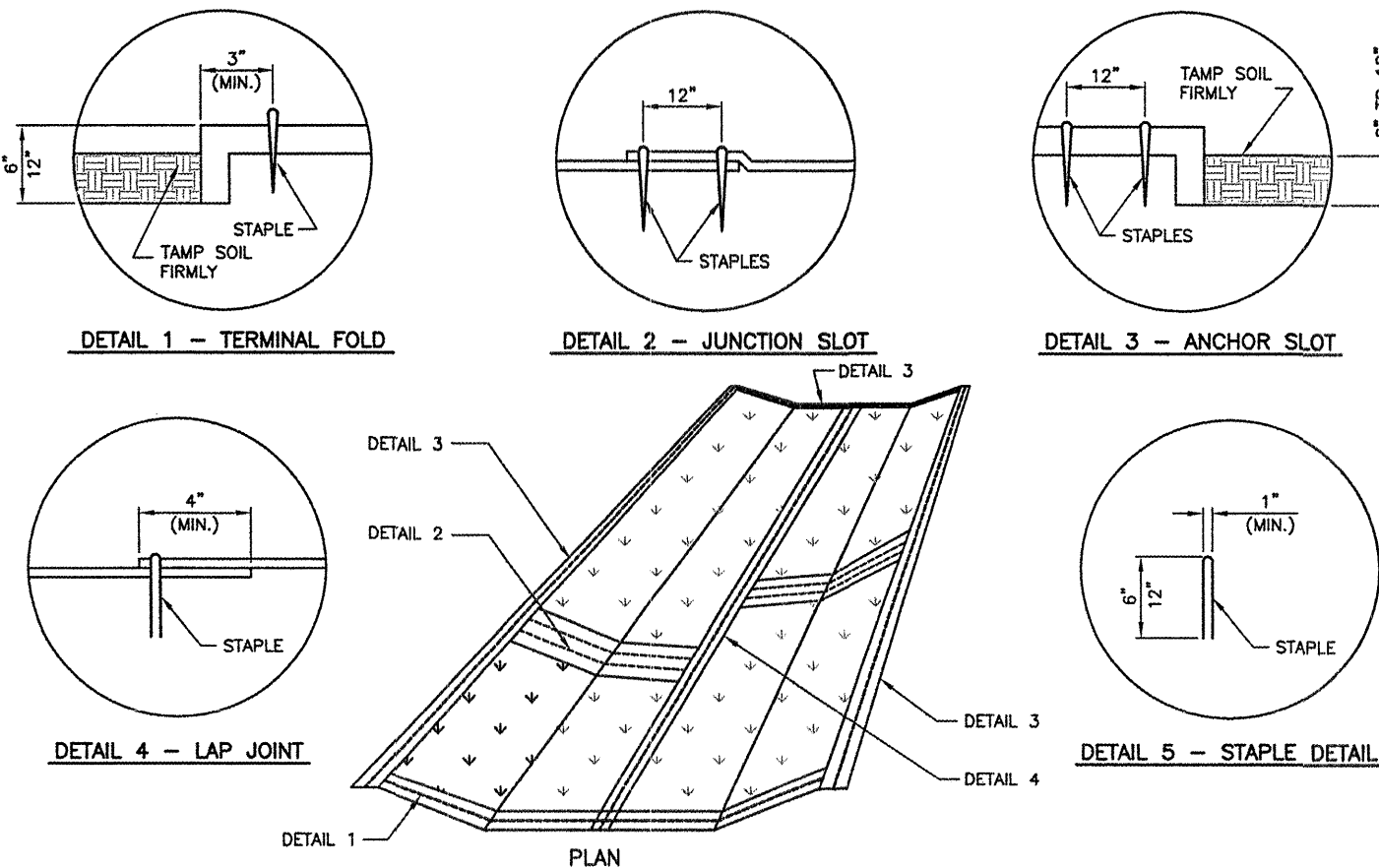

EXCELSIOR BLANKET DETAILS
N.T.S.

NOTES

- STAPLES TO BE PLACED ALTERNATELY, IN COLUMNS APPROXIMATELY 2' APART AND IN ROWS APPROXIMATELY 3' APART.
- EROSION CONTROL MATERIAL SHALL BE PLACED LOOSELY OVER GROUND SURFACE. DO NOT STRETCH.
- ALL TERMINALS ENDS AND TRANSVERSE LAPS SHALL BE STAPLED AT APPROXIMATELY 12" INTERVALS.

PINCKNEYVILLE-DUQUOIN AIRPORT
PERRY COUNTY, ILLINOIS
T-HANGAR SITE WORK
EROSION CONTROL DETAILS

© Copyright, CMT, Inc.
CMT
CRAWFORD, MURPHY & TILLY, INC.
CONSULTING ENGINEERS
License No. 184-000673

DESIGN BY: TJH
DRAWN BY: CMT
CHECKED BY: JEF
APPROVED BY: JEF
DATE: 4/17/2009
JOB No: 07062-03-00
IL PROJECT NO. PJY-3373
A.I.P. PROJECT NO. 3-17-0037-B6
SHEET 15 OF 17 SHEETS

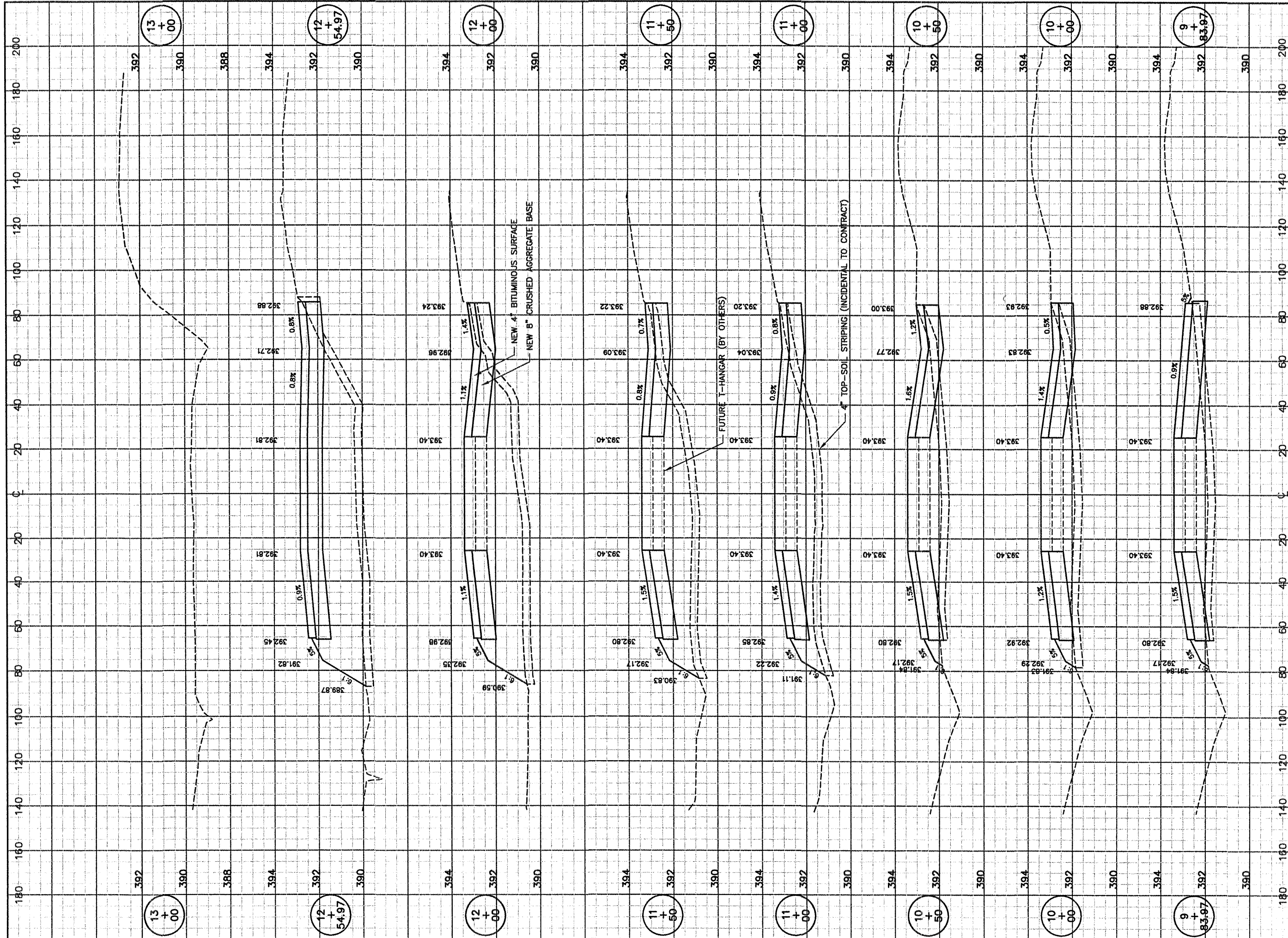

K:\Pinckneyville\0706203 SITE WORK HGR\Draw\Sheet
 FILE: XSEC01.dwg
 UPDATE BY: Dale Draughon
 PLOT DATE: 4/17/2009 1:45 PM
 rc001004

REVISIONS		
NUMBER	BY	DATE

THIS BAR IS EQUAL TO 2'
AT FULL SCALE (34X22).

PINCKNEYVILLE-DUQUOIN AIRPORT
 PERRY COUNTY, ILLINOIS

T-HANGAR SITE WORK
T-HANGAR CROSS SECTIONS
STA. 9+83.97 TO STA. 13+00

CMT
 CRAWFORD, MURPHY & TILLY, INC.
 CONSULTING ENGINEERS
 License No. 194-000613

DESIGN BY:	TJH
DRAWN BY:	CMT
CHECKED BY:	JEF
APPROVED BY:	JEF
DATE:	4/17/2009
JOB No:	07062-03-00
IL PROJECT NO.	PJY-3373
A.I.P. PROJECT NO.	3-17-0037-B6

SHEET 16 OF 17 SHEETS

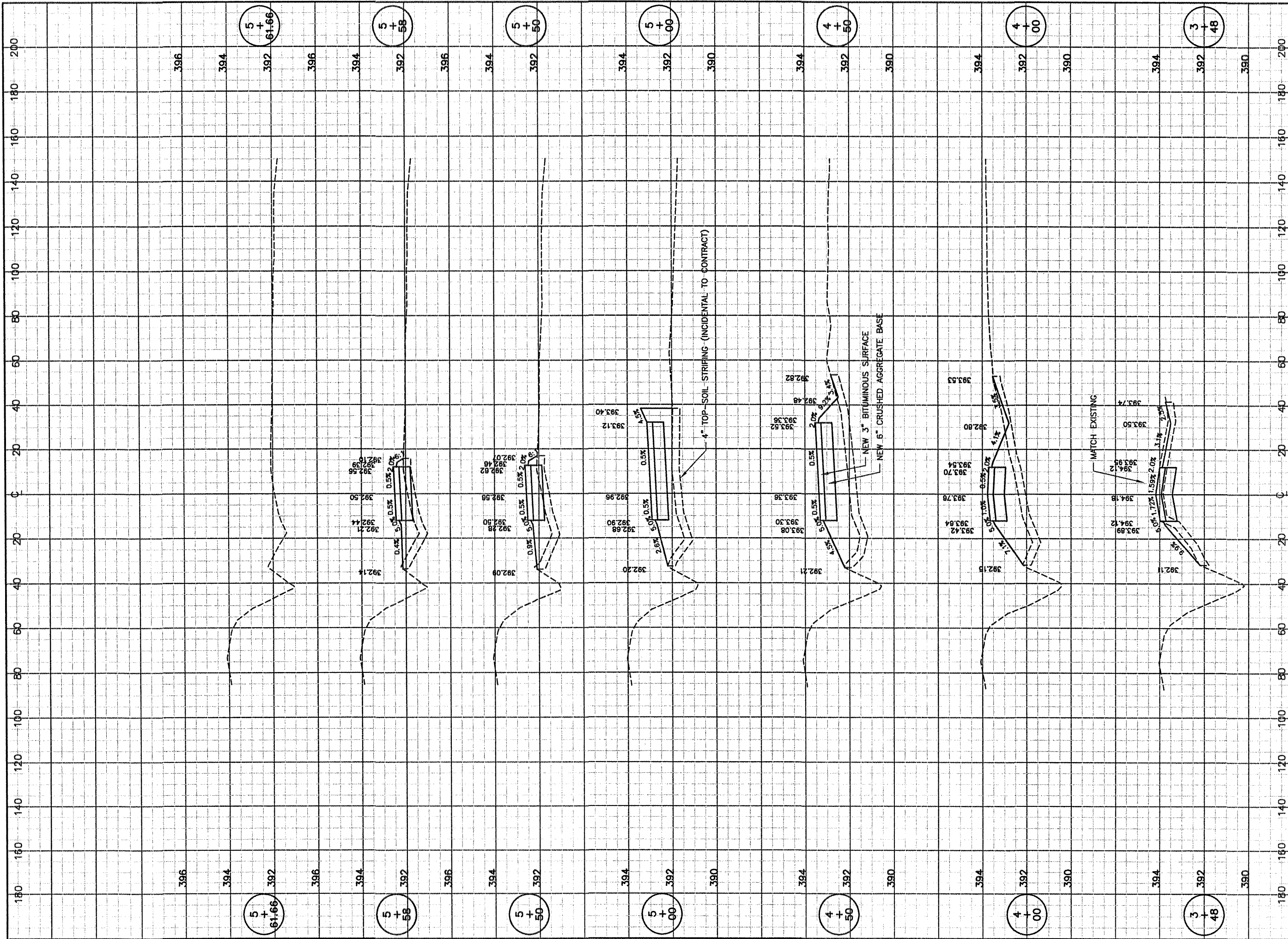

K:\Pinckneyville\AP\0706203 SITE WORK HGR\Draw\Sheet
 FILE: XSEC02.dwg
 UPDATE BY: Dale Draughan
 PLOT DATE: 4/17/2009 1:45 PM
 r001001

REVISIONS		
NUMBER	BY	DATE

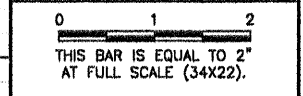

PINCKNEYVILLE-DUQUOIN AIRPORT
 PERRY COUNTY, ILLINOIS
T-HANGAR SITE WORK
ENTRANCE ROAD CROSS SECTIONS
STA. 3+48 TO STA. 5+61.66

© Copyright CMT, Inc.
CMT
 CRAWFORD, MURPHY & TILLY, INC.
 CONSULTING ENGINEERS
 License No. 84-00673

DESIGN BY:	TJH
DRAWN BY:	CMT
CHECKED BY:	JEF
APPROVED BY:	JEF
DATE:	4/17/2009
JOB No:	07062-03-00
IL PROJECT NO. PJY-3373	
A.I.P. PROJECT NO. 3-17-0037-B6	
SHEET 17 OF 17 SHEETS	