

DATE: Monday, May 11, 2009 3:58:18 PM
 FILE: K:\Rockford\09252604_Rehab_Twy_B_South_Phase\Drawings\17-APP1.dwg
 UPDATE BY: Jeremy Linke
 LAYOUT: 17-APP1

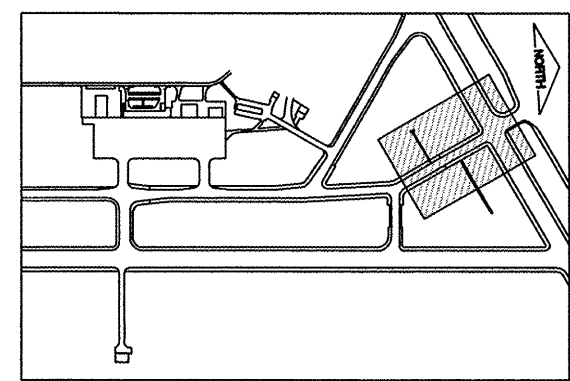

- LEGEND**
- NEW 18" PCC PAVEMENT, 8" AGGREGATE BASE AND FULL DEPTH PAVEMENT MILLING REMOVAL
 - NEW 15" PCC PAVEMENT INLAY AND 3" BITUMINOUS PAVEMENT MILLING REMOVAL
 - NEW BITUMINOUS SHOULDER PAVEMENT (4" BITUMINOUS/8"-11" AGGREGATE BASE)
 - NEW VARIABLE DEPTH BITUMINOUS TRANSITION
 - NEW LANDSCAPING (SEEDING/SOILGUARD)
 - UD -- NEW 4" UNDERDRAIN

RO017
5A

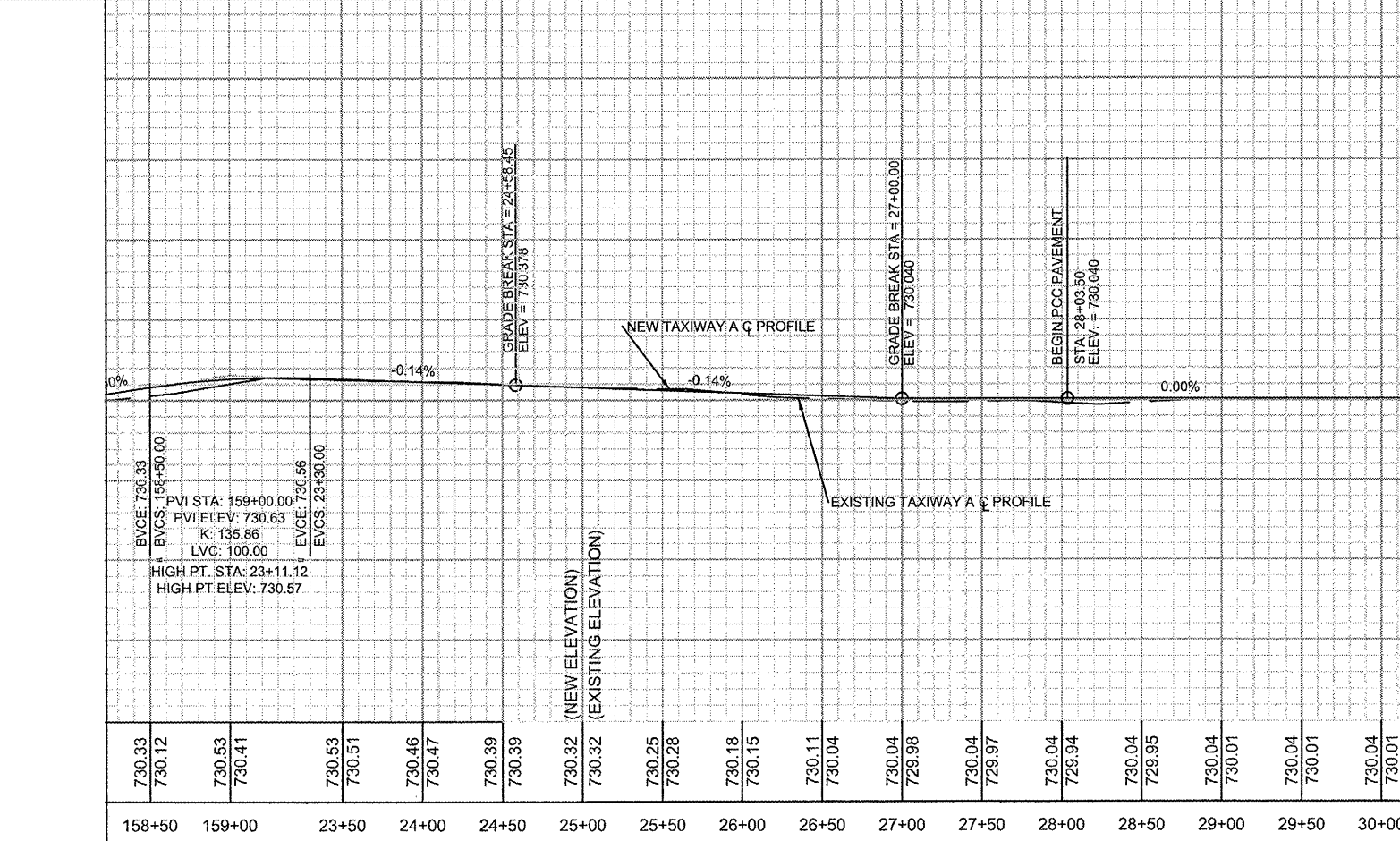
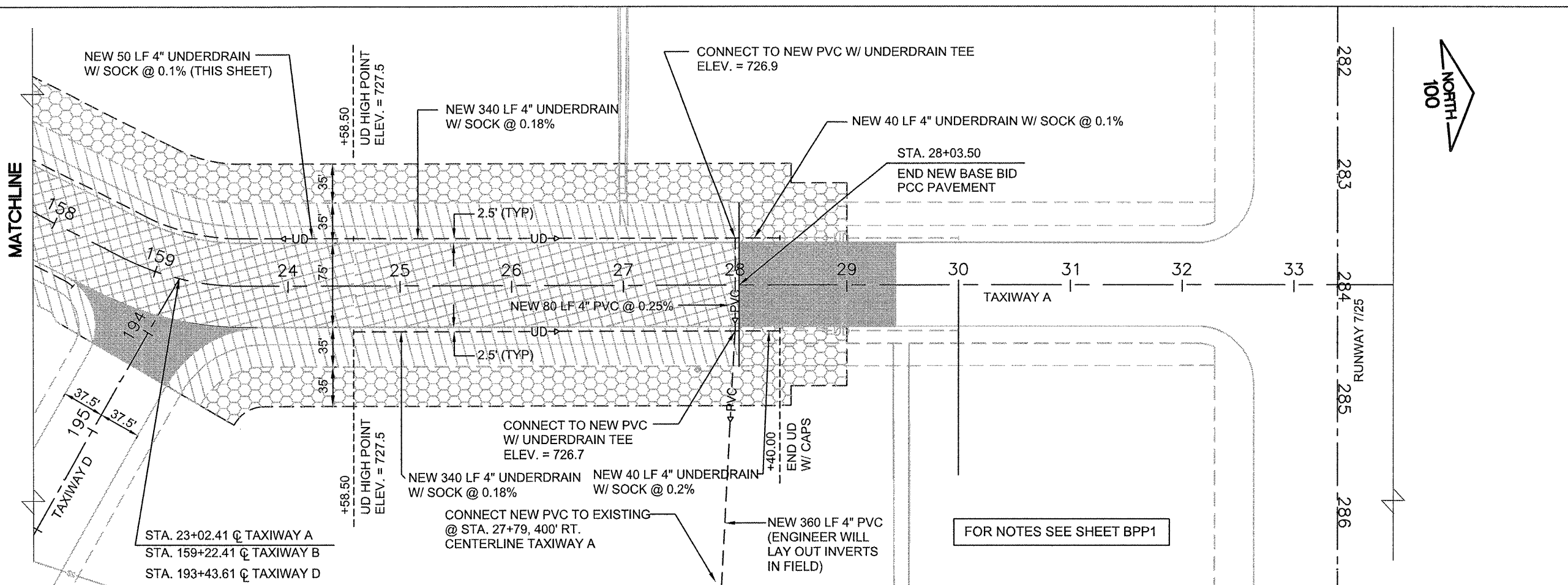

Chicago Rockford International Airport



ROCKFORD, ILLINOIS
 GREATER ROCKFORD AIRPORT AUTHORITY
 3-17-0088-XX
 RFD-3909

REHAB. TWY B SOUTH
 PHASE 2

Revisions

Date	Description

0 1
 THIS BAR IS EQUAL TO 1" AT FULL SCALE (17 X 11).

DESIGN BY: CMT-ARR
 DRAWN BY: CMT-ARR
 CHECKED BY: CMT-ARR
 APPROVED BY: CMT-RFD
 DATE: 5/8/2009
 JOB No: 09258-04-00

**TAXIWAY A
 PLAN - PROFILE
 (APP1)**